

LOS ANGELES COUNTY
DEPARTMENT OF PUBLIC WORKS
BENCH MARK LIST



RIVERA QUAD

2005 ADJUSTMENT
2005 BASELINE
NAVD 88 DATUM

PREFACE

The Department of Public Works level net is composed of more than 1,700 miles or 2720 kilometers of levels supporting in excess of 9,000 bench marks. Previously when a major readjustment of the net was undertaken, to emphasize the complete break with previous elevations, the CY, CG, & CL, series bench marks were re-labeled DY, DG, & DL, respectively. Beginning in 1993 the baseline readjustment year will be indicated on baseline BM, s only indicated below (*). Henceforth all BM numbers will be labeled as a Y, G, or L, series that will no longer indicate the major adjustment year.

To facilitate the adjustment, indexing and distribution of adjusted values of the net, the county territory was divided into 33 quads or areas. For the identification purposes each quad was given a name, viz., "Rosemead," "La Mirada," "Santa Fe," etc. When bench marks and elevations in these quads are used, the name must be included in the bench mark description, e.g.,

* BASELINE 90.057 L&BR IN CTR OF CB RET @ NE COR Y 9191
(1990) 295.461 LA HABRA BLVD & VALLEY HOME AVE
10.7M N & 10.7M E/O C/L INT

It is expected that this general adjustment will for the most part remain sound for 8 to 12 years. Updating constrained adjustments will continue in the future. When a quad is readjusted, new elevations will be published and the date of readjustment will be noted in the bench mark description. Two bench marks with different adjustment dates will not normally agree with each other.

The basic accuracy of the net is reflected by an indicated field probable error of plus or minus 4mm per kilometer of leveling as determined from the conditions of closure. However, many years of experience in vertical control in the greater Los Angeles basin and Antelope Valley indicate that because of varying degrees of subsidence and heaving, the true datum is recovered only by obtaining substantial agreement of a number of bench marks.

The users of this net are invited to assist in its maintenance by notifying this department of cases of obliteration, apparent mistakes in description or elevations, and proven disturbance of bench marks.

DATUM: North American Vertical Datum of 1988 (NAVD88)

Note: NAVD 1988 minus approximately 700mm (2.3ft) equals
Previous NGVD 1929 Datums. For more accurate equations
At individual bench marks refer to previous publications

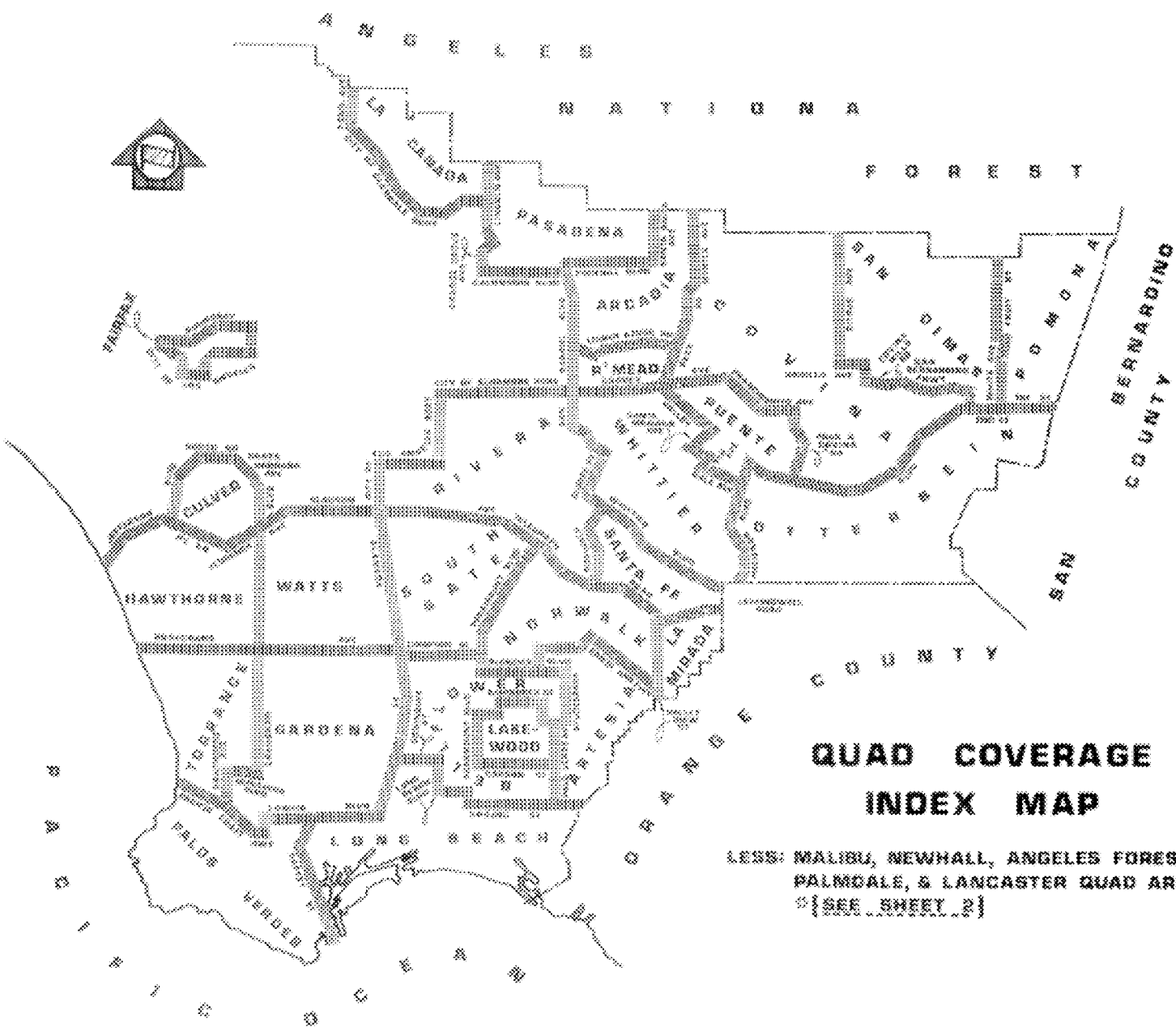

**QUAD COVERAGE
INDEX MAP**

LESS: MALIBU, NEWHALL, ANGELES FOREST,
PALMDALE, & LANCASTER QUAD AREAS.
☉ [SEE SHEET 2]

K E R N C O U N T Y

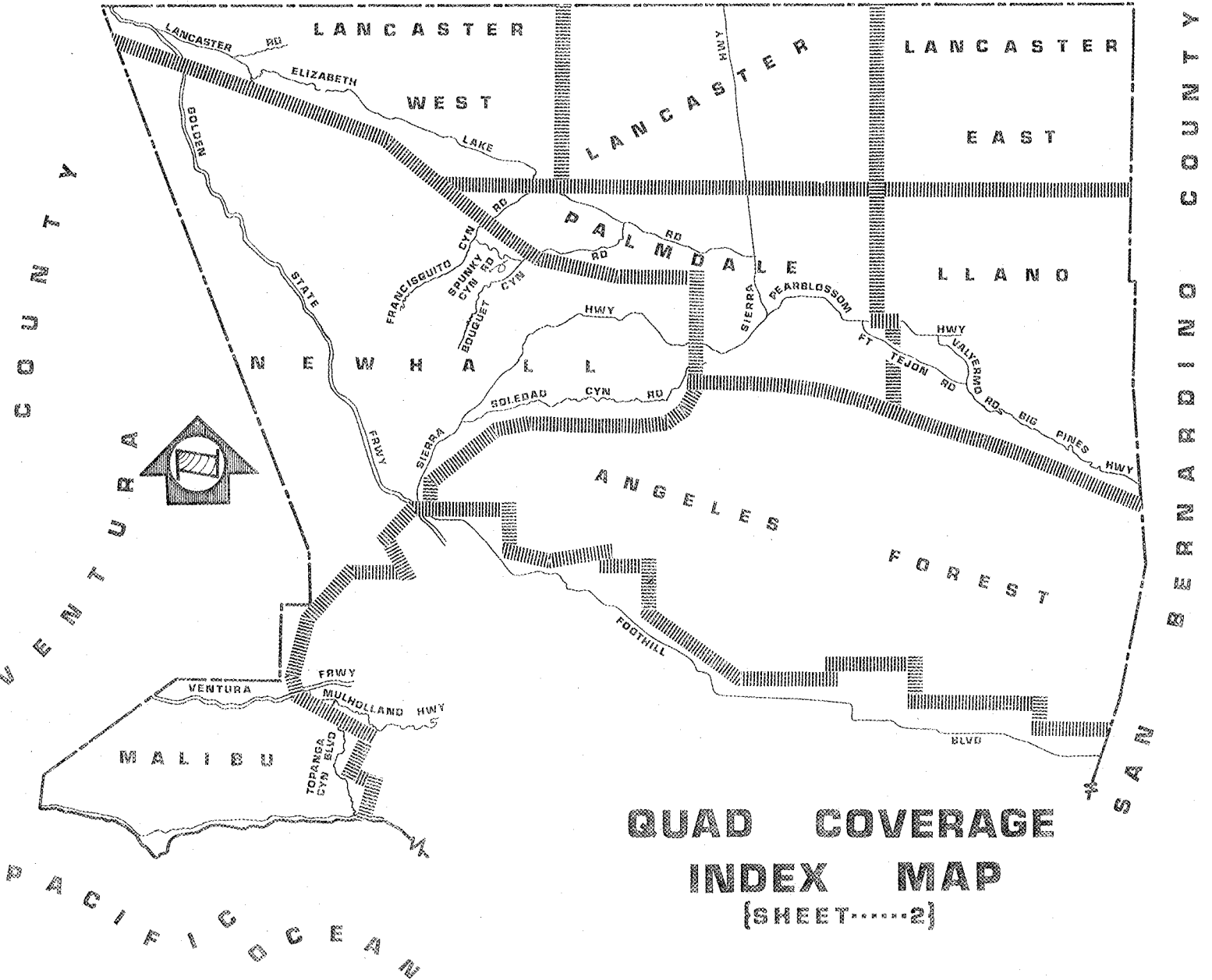

QUAD COVERAGE
INDEX MAP
(SHEET.....2)

ABBREVIATIONS USED IN BENCH MARK LISTINGS

ABUT -----	Abutment	LT -----	Left
ALG -----	Along	LACE -----	L.A. City Engineer
ANG PT -----	Angle Point	LACS -----	L.A. Co. Engineer
B/W -----	Back of Walk	LAFC -----	L.A. Co. Flood Control
BCR -----	Beginning of Curb Return	L&BN -----	Lead and Bench Nail
BC -----	Beginning of Curve	L&BR -----	Lead and Brad
BLDG -----	Building	L&N -----	Lead and Nail
BM -----	Bench Mark	L&SPK -----	Lead and Spike
BT SPK -----	Boat or Bolt Spike	L&T -----	Lead and Tack
BR CAP -----	Brass or Bronze Cap	MCR -----	Middle of Curb Return
C B -----	Catch Basin	MKD -----	Marked
CTR -----	Center	MC -----	Middle of Curve
C/L -----	Center Line	MON -----	Monument
C/L INT -----	Center Line Intersection	N/O -----	North of
C/L PROD ---	Center Line Produced	NR -----	Near
CONC -----	Concrete	OPP -----	Opposite
COR -----	Corner	PI -----	Point of Intersection
COE -----	Corps of Engineers	PK&W -----	PK Nail and Washer
CULV -----	Culvert	P/L -----	Property Line
CYN -----	Canyon	POST -----	Point of Semi-Tangent
CB -----	Curb	PP -----	Power Pole
CS MON -----	Co. Eng. Monument	PVMT -----	Pavement
CT SPK -----	Cut Spike	PROD -----	Produced
DPW -----	Dept. of Public Works	RD -----	Road
DR -----	Drive or Driveway	RDBM -----	Road Dept. Bench Mark
E/O -----	East of	RDBM TAG -----	Road Dept. Bench Mark Tag
ECR -----	End of Curb Return	RR -----	Railroad
EC -----	End of Curve	RT -----	Right
ENT -----	Entrance	R/W -----	Right of Way
FL -----	Floor	SDMH -----	Storm Drain Manhole
FTG -----	Footing	SMH -----	Sewer Manhole
FRWY -----	Freeway	SPK -----	Spike
F/W -----	Front of Walk	ST&W -----	Spike Tin and Washer
GAR -----	Garage	S/O -----	South of
HDWL -----	Headwall	TP -----	Telephone Pole
HSE -----	House	USC&GS -----	U.S. Coast and Geodetic Survey
HWY -----	Highway	USGS -----	U.S. Geological Survey
INT -----	Intersection	WK -----	Walk
IP -----	Iron Pipe	W/O -----	West of

RIVERA QUAD INDEX

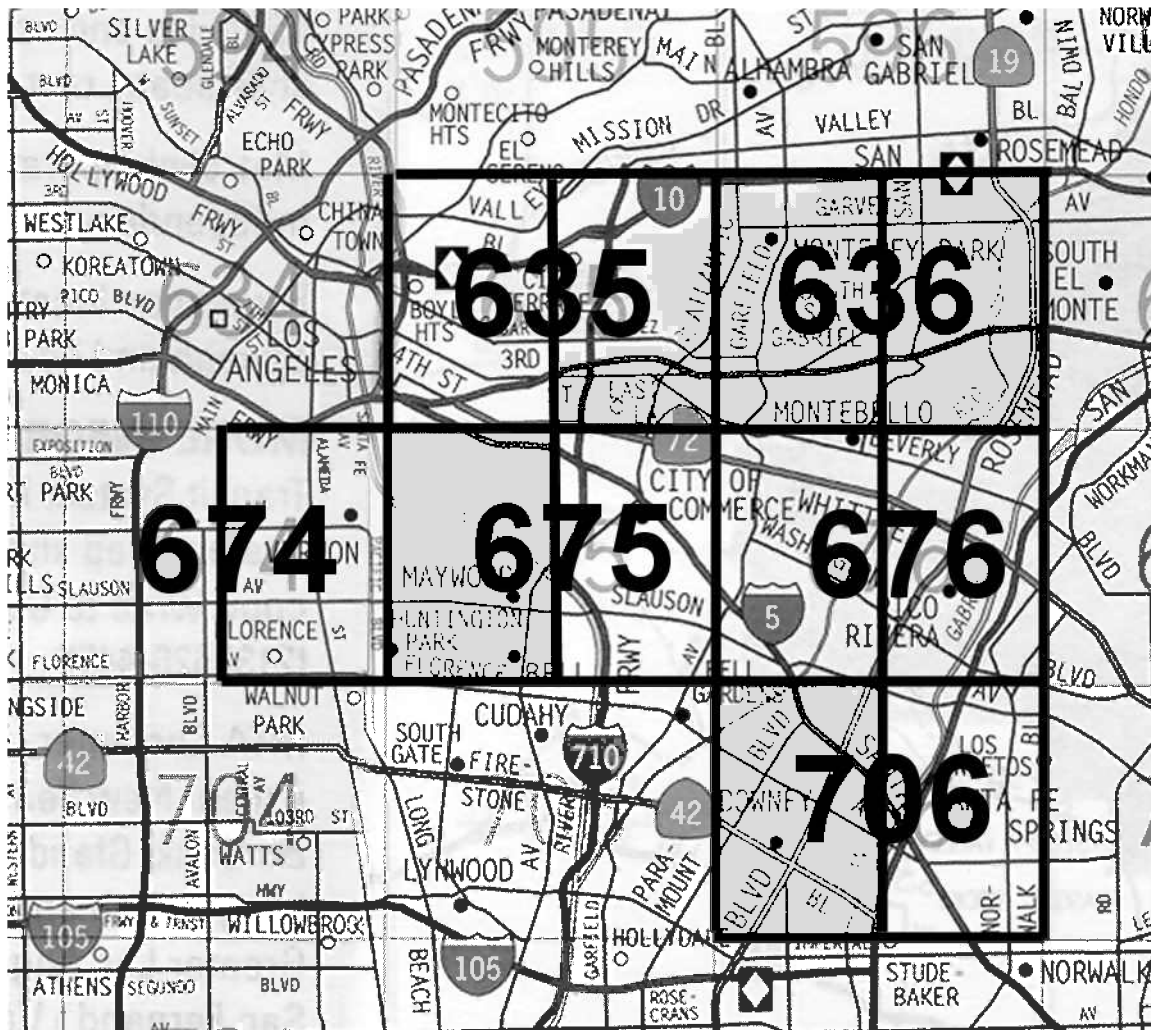

**NUMBERS REFER
TO THOMAS BROS
PAGE NUMBERS**

**EACH THOMAS BROS
PAGE IS DIVIDED INTO
TWO INDEX PAGES
EAST AND WEST**

MAP 635 WEST RIVERA QUAD

DATA CONTAINED IN THIS MAP IS PRODUCED
WHOLE OR PART FROM THE THOMAS BRIS
MAPS DIGITAL DATABASE. THIS MAP IS COPY-
RIGHTED AND IS PRODUCED WITH PERMISSION
GRANTED BY THOMAS BROS. MAPS. ALL RIGHTS
RESERVED.



TO MAP 675 WEST

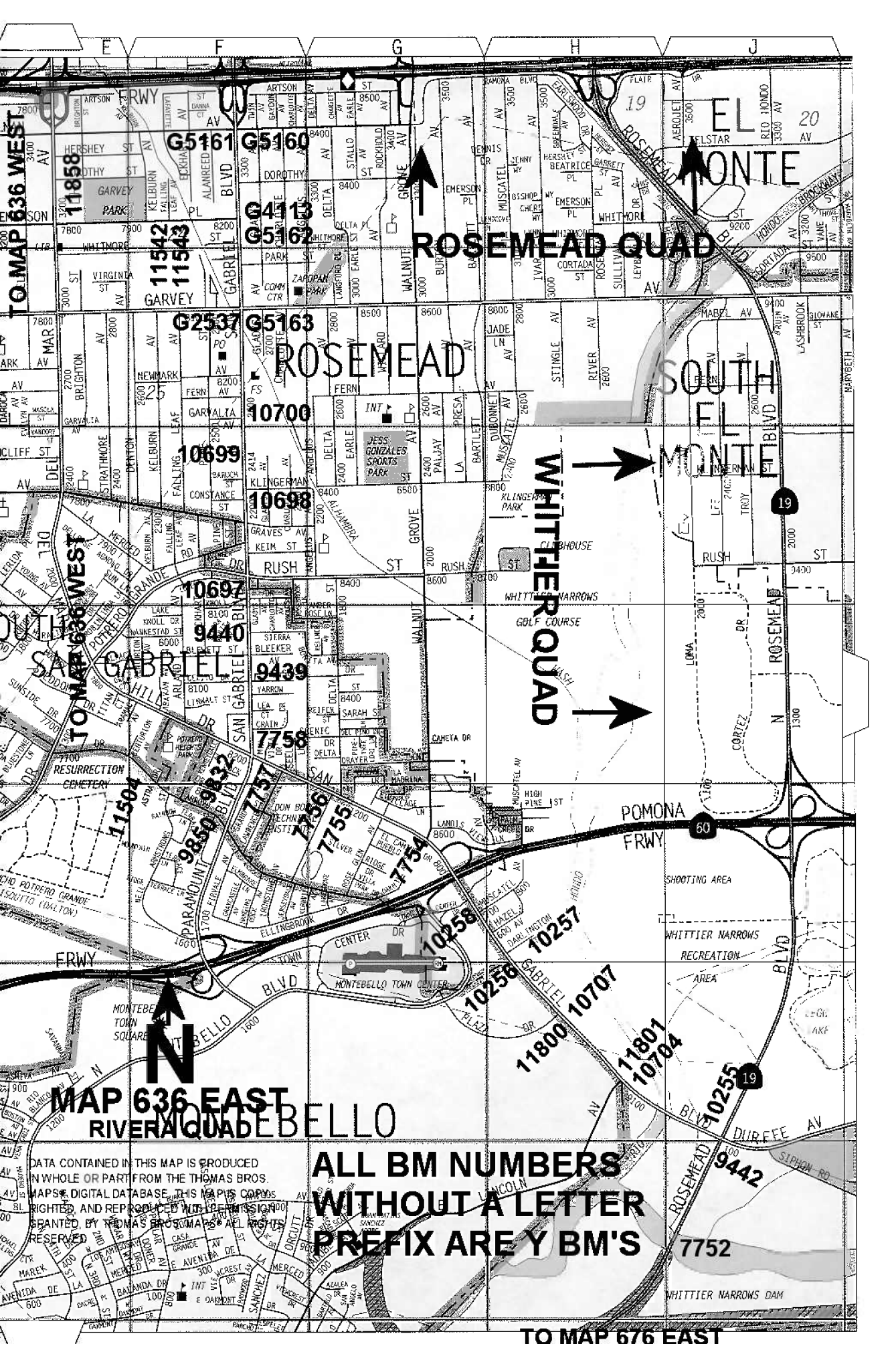

TO MAP 636 WEST

TO MAP 636 WEST

MAP 636 EAST
RIVERA QUAD BELLO

TO MAP 676 EAST

ROSEMEAD QUAD

ROSEMEAD

WHITTIER QUAD

SOUTH EL MONTE

DATA CONTAINED IN THIS MAP IS PRODUCED IN WHOLE OR PART FROM THE THOMAS BROS. MAPS DIGITAL DATABASE. THIS MAP IS UNPUBLISHED AND REPRODUCED WITHOUT PERMISSION GRANTED BY THOMAS BROS. MAPS. ALL RIGHTS RESERVED.

ALL BM NUMBERS WITHOUT A LETTER PREFIX ARE Y BM'S



11858

11504

11801

11801

11801

G5461

G5460

G4113

G5162

G2537

G5163

10700

10699

10698

10697

9440

9439

7758

9832

9850

7757

7756

7755

7754

10258

10256

10257

11800

11801

10707

10255

G5161

G5162

G4113

G5163

G2537

G5163

10700

10699

10698

10697

9440

9439

7758

9832

9850

7757

7756

7755

7754

10258

10256

10257

11800

11801

10707

10255

G5161

G5162

G4113

G5163

G2537

G5163

10700

10699

10698

10697

9440

9439

7758

9832

9850

7757

7756

7755

7754

10258

10256

10257

11800

11801

10707

10255

G5161

G5162

G4113

G5163

G2537

G5163

10700

10699

10698

10697

9440

9439

7758

9832

9850

7757

7756

7755

7754

10258

10256

10257

11800

11801

10707

10255

G5161

G5162

G4113

G5163

G2537

G5163

10700

10699

10698

10697

9440

9439

7758

9832

9850

7757

7756

7755

7754

10258

10256

10257

11800

11801

10707

10255

G5161

G5162

G4113

G5163

G2537

G5163

10700

10699

10698

10697

9440

9439

7758

9832

9850

7757

7756

7755

7754

10258

10256

10257

11800

11801

10707

10255

G5161

G5162

G4113

G5163

G2537

G5163

10700

10699

10698

10697

9440

9439

7758

9832

9850

7757

7756

7755

7754

10258

10256

10257

11800

11801

10707

10255

G5161

G5162

G4113

G5163

G2537

G5163

10700

10699

10698

10697

9440

9439

7758

9832

9850

7757

7756

7755

7754

10258

10256

10257

11800

11801

10707

10255

G5161

G5162

G4113

G5163

G2537

G5163

10700

10699

10698

10697

9440

9439

7758

9832

9850

7757

7756

7755

7754

10258

10256

10257

11800

11801

10707

10255

G5161

G5162

G4113

G5163

G2537

G5163

10700

10699

10698

10697

9440

9439

7758

9832

9850

7757

7756

7755

7754

10258

10256

10257

11800

11801

10707

10255

G5161

G5162

G4113

G5163

G2537

G5163

10700

10699

10698

10697

9440

9439

7758

9832

TO MAP 635 EAST

TO MAP 636 EAST

TO MAP 636 WEST

TO MAP 636 EAST

TO MAP 676 WEST

TO MAP 676 WEST

MAP 636 WEST RIVERA QUAD



DATA CONTAINED IN THIS MAP IS PRODUCED
WHOLE OR PART FROM THE THOMAS BROS.
DIGITAL DATABASE. THIS MAP IS COPY-
RIGHTED AND REPRODUCED WITH PERMISSION
BY THOMAS BROS. MAPS. ALL RIGHTS
RESERVED.



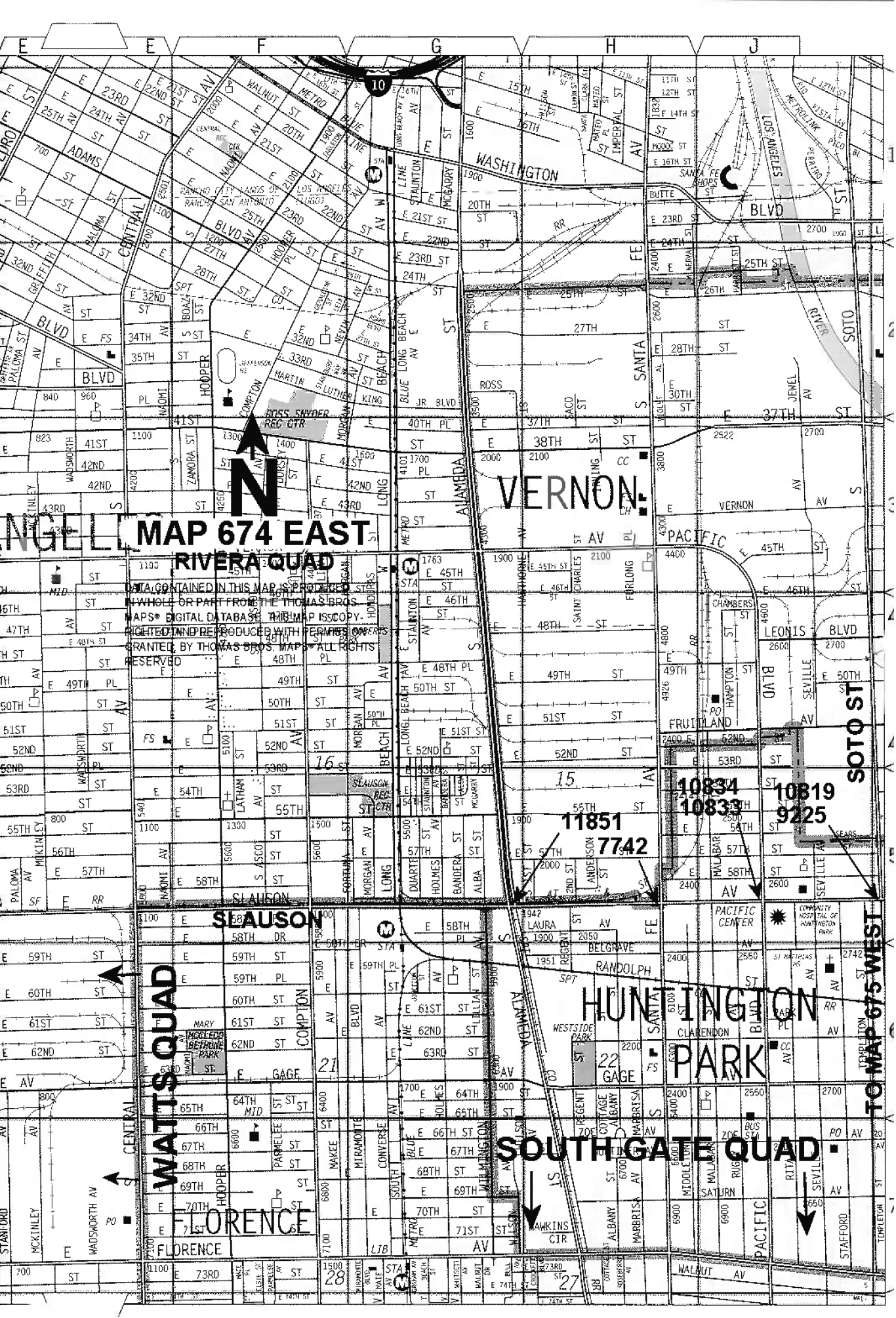

MAP 674 EAST

DATA CONTAINED IN THIS MAP IS UNCORRECTED
 WHOLE OR PART FROM THE THOMAS BROS
 MAPS® DIGITAL DATABASE. THIS IS A COPY.
 REPRODUCED WITH PERMISSION FROM
 THOMAS BROS. MAPS. ALL RIGHTS
 RESERVED.

SAUSON

WATTS QUAD

FLORENCE

VERNON

HUNTINGTON PARK

SOUTH GATE QUAD

11851
7742

10834
10833
9225

22 GAGE

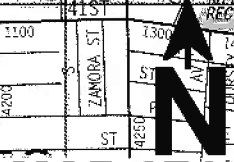

CENTRAL

TO MAP 675 WEST

73RD

28

27

27

TO MAP 635 EAST

TO MAP 676 WEST

TO MAP 675 WEST

TO MAP 675 WEST

TO MAP 676 WEST

TO MAP 675 EAST
RIVERA QUAD

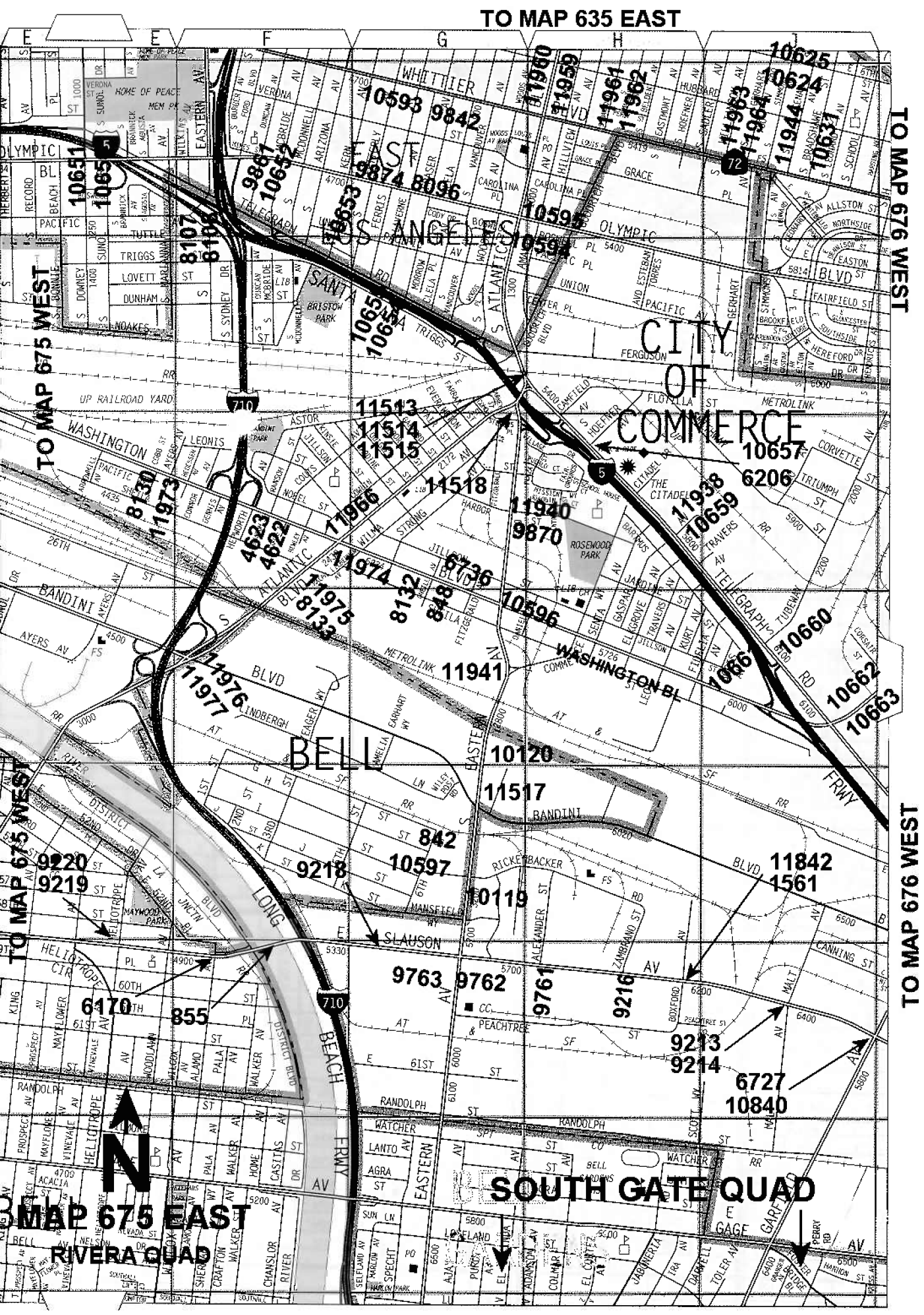

CITY OF COMMERCE

BELL

SOUTH GATE QUAD



TO MAP 675 EAST

TO MAP 675 EAST

TO MAP 675 EAST

TO MAP 675 EAST

TO MAP 676 EAST

TO MAP 676 EAST

TO MAP 676 EAST

TO MAP 676 EAST

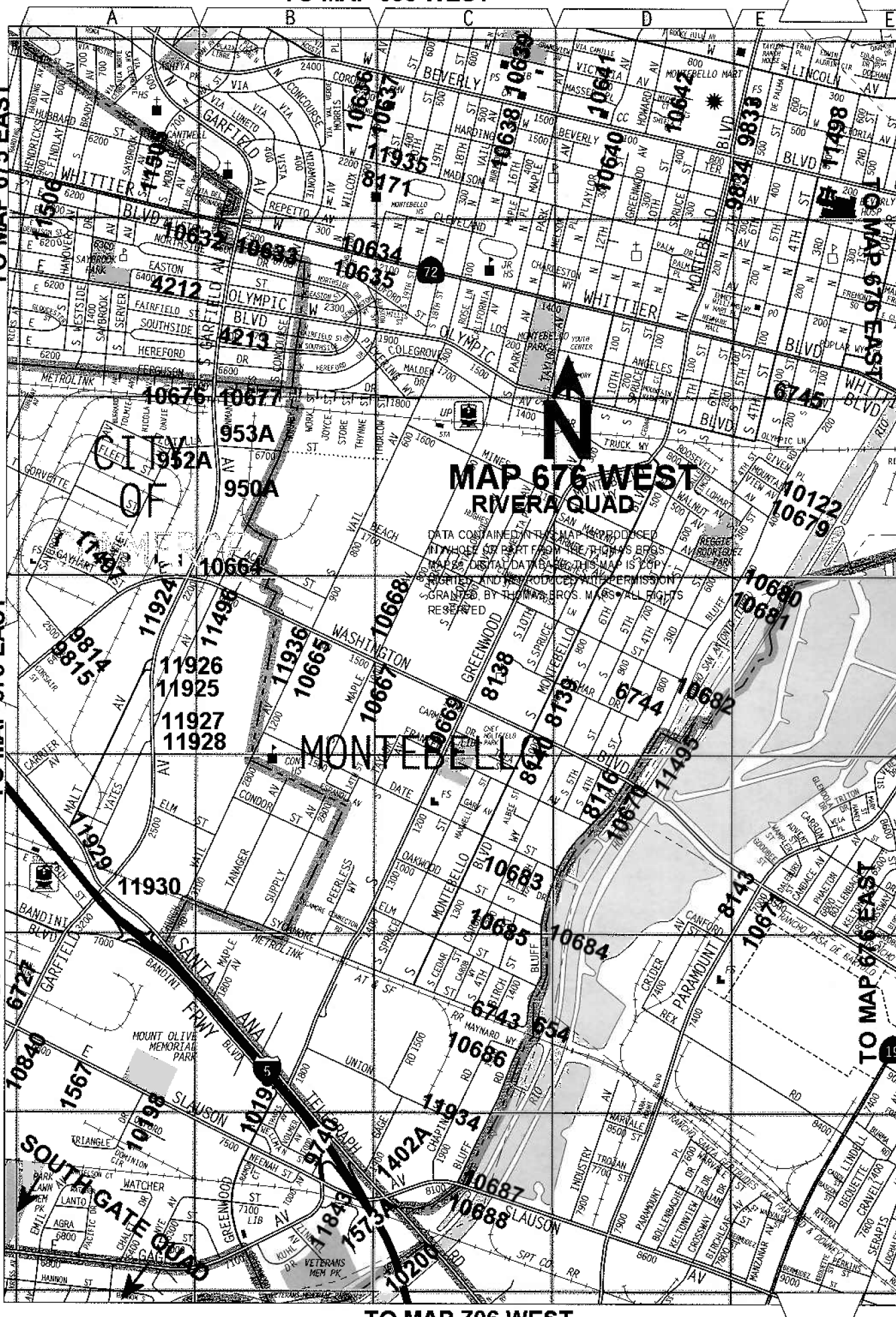

QUAD YEAR	ELEV FOOT/METER	DESCRIPTION	BM NUMBER
BASELINE (2005)	278.225 84.803	FC BR CAP IN W WINGWALL 22.3M(73FT) N/O C/L GARVEY AVE & 69M(226FT) W/O C/L SAN GABRIEL BLVD MKD (BM 55-24) 34FT N/O CF	G 2537
BASELINE (2005)	282.182 86.009	CSBM MON IN WELL 300MM(1FT) N/O CF @ BCR @ NW COR SAN GABRIEL BLVD & EMERSON PL MKD (BM 1-25C 1970)	G 4113
BASELINE (2005)	297.188 90.583	LACO BM TAG IN N CB 1M(3.3FT) W/O BCR @ NW COR HEILMAN AVE & SAN GABRIEL BLVD	G 5160
BASELINE (2005)	296.347 90.327	LACO BM TAG IN W CB 3M(10FT) S/O BCR @ SW COR HELLMAN AVE & SAN GABRIEL BLVD	G 5161
BASELINE (2005)	282.129 85.993	L&BRAD IN W CB 300MM(1FT) S/O BCR @ SW COR EMERSON PLACE & SAN GABRIEL BLVD	G 5162
BASELINE (2005)	275.868 84.085	L&DPW BM TAG 300MM(1FT) W/O BCR @ NW COR SAN GABRIEL BL & GARVY AV	G 5530
BASELINE (2005)	177.234 54.021	L&BR IN S CB WHITTIER BLVD ON C/L PROD REDMAN AVE (TO THE N)	Y 619
RIVERA (2005)	211.876 64.580	L&BR IN N CB @ NW COR POPLAR AVE & MADISON AVE 10.4M(34FT) W/O & 6M(19.7FT) N/O C/L INT	Y 648
RIVERA (2005)	210.589 64.188	L&BN IN N CB 300MM(1FT) W/O BCR @ NW COR WHITTIER BLVD & 1ST ST	Y 649
RIVERA (2005)	174.844 53.293	L&BN IN W CB 300MM(1FT) N/O C. B. 76M(249FT) N/O & 6M(20FT) W/O C/L INT BLUFF RD & SYCAMORE ST (NR HSE #1425)	Y 654
RIVERA (2005)	139.774 42.603	L&BN IN E CB NR S END CB 4.6M(15FT) N/O JCT RR 11.6M(38FT) E/O C/L EASTERN AVE & 117M(384FT) S/O C/L BANDINI BLVD	Y 842
RIVERA (2005)	143.186 43.643	L&N N CB 1FT E/O BCR @ NE COR ONEIL AVE & WASHINGTON BLVD 47FT E & 36FT N C/L INT	Y 848
BASELINE (2005)	159.873 48.729	L&N IN W END OF N HDWL OF BRIDGE OVER LA RIVER 8.8M(29FT) N/O C/L SLAUSON AVE MKD (USED BM #2305)	Y 855
RIVERA (2005)	174.085 53.061	L&BN IN E CB GARFIELD AVE 12M(40FT) E/O C/L & 273M(895FT) S/O C/L FLOTILLA ST @ BLDG #2100	Y 950A
RIVERA (2005)	175.745 53.567	RDBM TAG IN S CB 2M(6.5FT) E/O BCR @ SE COR GARFIELD AVE & FLOTILLA ST	Y 952A
RIVERA (2005)	175.734 53.564	RDBM TAG IN W CB @ BCR @ NW COR GARFIELD AVE & FLOTILLA ST	Y 953A
BASELINE (2005)	145.837 44.451	RAM SET IN N CB TELEGRAPH RD & 33.5M(110FT) W/O C/L CRIDER AVE (16FT E/O PP #14630Y)	Y 1400A
BASELINE (2005)	153.759 46.866	L&T IN N CB TELEGRAPH RD 1M(3.3FT) E/O BCR @ NE COR SLAUSON AVE	Y 1402A
BASELINE (2005)	142.053 43.298	L&T IN N CB SLAUSON AVE 13M(43FT) N/O C/L & 91M(300FT) E/O C/L BOXFORD AVE (13FT W/O W END C. B.)	Y 1561

QUAD YEAR	ELEV FOOT/METER	DESCRIPTION	BM NUMBER
BASELINE (2005)	154.631 47.132	L&BN IN S CB SLAUSON AVE 9.7M(32FT) E/O DRWY TO BLDG #7000 & 1M(3.3FT) N/O PP #666256E 322M(1050FT) E/O GARFIELD AVE	Y 1567
BASELINE (2005)	154.198 47.000	L&CALTRANS TAG IN S CB TELEGRAPH RD 1.5M(5FT) E/O BCR @ SE COR SLAUSON AVE	Y 1573A
BASELINE (2005)	144.747 44.119	L&BN IN W CB 1M(3.3FT) S/O BCR @ SW COR TELEGRAPH RD & BIRCHBARK AVE	Y 1593
BASELINE (2005)	139.342 42.472	L&T IN S CB 2M(6.5FT) W/O BCR @ SE COR TELEGRAPH RD & SERAPIS AVE	Y 1600A
RIVERA (2005)	144.053 43.907	L&BN IN E CB 300MM(1FT) N/O BCR @ NE COR CLAYMORE ST & PASSONS BLVD	Y 1604
RIVERA (2005)	148.271 45.193	L&BN IN E CB 600MM(2FT) N/O BCR @ NE COR SUNGLOW ST & BUHMAN AVE	Y 1605
RIVERA (2005)	148.823 45.361	L&BN IN E CB @ ANG PT PASSONS BL & CHARLESWORTH DR 61M(200FT) S/O & 6M(20FT) E/O C/L INT @ HSE #8430	Y 1606
RIVERA (2005)	150.416 45.847	L&BN IN E CB 300MM(1FT) N/O BCR @ NE COR PASSONS BLVD & LA DOCENA LN	Y 1607
RIVERA (2005)	149.708 45.631	L&BN IN N CB 300MM(1FT) W/O BCR @ NW COR PASSONS BLVD & MYRON ST	Y 1609
RIVERA (2005)	163.153 49.729	RDBM TAG IN N CB 15M(49FT) W/O BCR @ NW COR ROSEMEAD BLVD & WASHINGTON BLVD	Y 1666A
RIVERA (2005)	163.556 49.852	L&T IN W CB 600MM(2FT) N/O BCR @ NW COR WASHINGTON BLVD & CROSSWAY DR	Y 1673A
RIVERA (2005)	162.916 49.657	L&BN IN N CB 300MM(1FT) E/O BCR @ NE COR WASHINGTON BLVD & LINDSEY AVE	Y 1676
RIVERA (2005)	162.318 49.475	L&T IN CTR ISLAND CB RET @ SW COR WASHINGTON BLVD & KILGARRY AVE 13.7M(45FT) S/O & 8.5M(28FT) W/O C/L INT	Y 1677
RIVERA (2005)	159.389 48.582	L&BN IN N CB 300MM(1FT) E/O BCR @ NE COR WASHINGTON BLVD & MORRILL AVE	Y 1688
BASELINE (2005)	188.704 57.517	L&BN IN E CB 4.6M(15FT) N/O BCR @ NE COR BEVERLY BLVD & DURFEE AVE	Y 2284
BASELINE (2005)	192.058 58.539	SM SPK IN N END 1ST STEP TO HSE #4252 @ NE COR DURFEE AVE & DORK ST	Y 2286
RIVERA (2005)	155.893 47.516	L&BN IN W CB PASSONS BLVD 600MM(2FT) N/O N EDGE DRWY TO HSE #7525 & 31M(102FT) S/O C/L PROD BASCOM ST	Y 2450
RIVERA (2005)	156.266 47.630	L&T IN W CB PASSONS BLVD 300MM(1FT) N/O DRWY TO HSE #7503 & 35M(115FT) N/O C/L PROD BASCOM ST	Y 2451
RIVERA (2005)	158.499 48.311	L&T IN E CB 1M(3.3FT) S/O BCR @ SE COR PASSONS BLVD & FOXSBURY WAY	Y 2454
RIVERA (2005)	159.314 48.559	L&T IN E CB PASSONS BLVD 300MM(1FT) N/O N EDGE DRWY TO HSE #7202 9M(29.5FT) S/O C/L PROD DANBRIDGE ST	Y 2455

QUAD YEAR	ELEV FOOT/METER	DESCRIPTION	BM NUMBER
RIVERA (2005)	165.542 50.457	L&T IN E CB NR BCR @ NE COR PASSONS BLVD & CARRON DR	Y 2461
RIVERA (2005)	169.456 51.650	L&T IN W CB 300MM(1FT) N/O BCR @ SW COR PASSONS BL & COSGROVE ST	Y 2467
RIVERA (2005)	184.606 56.268	L&T IN E CB 2M(6.5FT) N/O BCR @ NE COR BEVERLY RD & ROSEMEAD BLVD	Y 3245
BASELINE (2005)	168.684 51.415	L&BR IN W CB 600MM(2FT) S/O BCR @ NW COR ROSEHEDGE DR & NORWALK BL	Y 3256
BASELINE (2005)	166.772 50.832	L&SPK IN E CB 1.5M(5FT) S/O BCR @ SE COR NORWALK BLVD & MINES BLVD	Y 3257
BASELINE (2005)	156.059 47.567	L&BN IN W CB 300MM(1FT) N/O BCR @ NW COR NORWALK BLVD & WADDELL ST	Y 3266
BASELINE (2005)	159.851 48.723	RAMSET IN W CB 900MM(3FT) N/O BCR @ NW COR WASHINGTON BL & NORWALK BL	Y 3708
RIVERA (2005)	196.092 59.769	L&BN IN N CB 10.7M(35FT) E/O BCR @ NE COR OLYMPIC BLVD & GARFIELD AVE	Y 4212
RIVERA (2005)	193.180 58.881	L&T IN CB 1.5M(5FT) W/O BCR @ NW COR GARFIELD AVE & FAIRFIELD ST	Y 4213
RIVERA (2005)	420.361 128.126	L&T IN CONC RET WALL @ SE COR BLANCHARD ST & ROWAN AVE 9M(29.5FT) E/O & 8M(26.2FT) S/O C/L INT	Y 4583
RIVERA (2005)	416.658 126.998	L&BR IN CONC WK @ NW COR ROWAN AVE & WINTER ST 9M(29.5FT) N/O & 9M(29.5FT) W/O C/L INT (@ HSE #3547)	Y 4596
RIVERA (2005)	310.388 94.607	L&T IN W CB ROWAN AVE ON C/L PROD DOZER ST	Y 4600
RIVERA (2005)	300.227 91.509	L&BN IN E CB 2M(6.5FT) N/O BCR @ NE COR DITMAN AVE & CESAR CHAVEZ AVE	Y 4602
RIVERA (2005)	292.368 89.114	CUT SPK IN E CB INDIANA ST @ N END C. B. 6M(19.7FT) S/O C/L PROD CESAR CHAVEZ PL	Y 4604
RIVERA (2005)	319.163 97.281	CUT SPK IN S CB 1.5M(5FT) W/O BCR @ SW COR INDIANA ST & 3RD ST	Y 4608
RIVERA (2005)	224.954 68.566	SPK IN W END C. B. 2M(6.5FT) W/O BCR @ NW COR INDIANA ST & WHITTIER BLVD	Y 4613
RIVERA (2005)	189.657 57.808	WIRE SPK IN E END C. B. 1.5M(5FT) W/O BCR @ NW COR INDIANA ST & OLYMPIC BLVD	Y 4617
RIVERA (2005)	152.210 46.394	L&BN E CB 10FT N/O BCR @ NE COR WASHINGTON & RANSOM ST 48FT N & 41FT W OF C/L INT	Y 4622
RIVERA (2005)	152.931 46.614	L&BN 1FT W BCR @ NW COR WASHINGTON BLVD & HEPWORTH AVE PROD 48FT N & 85FT W C/L INT & 62FT W/O C/L N BOUND OFF RAMP LONG BEACH FRWY	Y 4623

QUAD YEAR	ELEV FOOT/METER	DESCRIPTION	BM NUMBER
RIVERA (2005)	169.944 51.799	L&BN SE COR RR SIGNAL 41FT S C/L WASHINGTON BLVD & 43FT E C/L ELM ST	Y 4628
RIVERA (2005)	169.689 51.721	L&BN S EDGE STEP BLDG NO 4260 WASHINGTON BLVD 56FT S C/L & 29FT W/O C/L ASH ST	Y 4629
RIVERA (2005)	184.374 56.197	SQ BOLT IN N CB 4M(13FT) W/O BCR @ NW COR DOWNEY RD & LEONIS BLVD	Y 4659
RIVERA (2005)	314.250 95.784	L&T IN W CB 2.4M(8FT) S/O BCR @ SW COR ROWAN AVE & 3RD ST	Y 4813
RIVERA (2005)	314.329 95.808	L&T IN E CB 3.4M(11FT) S/O BCR @ SE COR ROWAN AVE & 3RD ST	Y 4814
RIVERA (2005)	312.036 95.109	L&BN IN E CB 10.4M(34FT) N/O BCR @ NE COR FLORAL DR & MENDIK AVE	Y 5660
BASELINE (2005)	141.657 43.177	CS BR CAP MON IN WELL 12IN DN @ NE COR SLAUSON AVE & ALAMO AVE 17.4M(57FT) N/O & 12.5M(41FT) E/O C/L INT MKD (BM 4-21 1951 RE 329) 750MM(2.5FT) N/O CF OF ISL	Y 6170
RIVERA (2005)	149.226 45.484	CAL-TRANS TAG IN SLY CB TELEGRAPH RD & 4.6M(15FT) ELY/O C/L PROD HOEFNER AVE (3.3FT W/O E END C. B.)	Y 6206
RIVERA (2005)	158.017 48.164	L&T IN N CB (SERV RD) 7.6M(25FT) W/O BCR @ NW COR WASHINGTON BL & PICO VISTA RD 24M(79FT) N/O & 15M(50FT) W/O C/L INT (15FT N/O C/L SER RD)	Y 6212
RIVERA (2005)	158.978 48.457	L&T IN N CB @ NE COR WASHINGTON BLVD & PICO VISTA RD 17M(55.8FT) E/O & 11.6M(38FT) N/O C/L INT	Y 6213
RIVERA (2005)	206.982 63.088	RDBM TAG IN N CB 300MM(1FT) E/O BCR @ NE COR 1ST ST & WHITTIER BLVD	Y 6220
RIVERA (2005)	150.597 45.902	L&BN IN N CB 300MM(1FT) E/O BCR @ NE COR PASSONS BLVD & SHADE LN MKD (BM)	Y 6226
BASELINE (2005)	168.730 51.429	CO ENGR BRASS CAP IN N END C. B. 7.4M(24.3FT) W/O BCR @ NW COR NORWALK BLVD & ROSEHEDGE DR MKD (BM 2-16 1961 RE 5869)	Y 6247
BASELINE (2005)	179.527 54.720	RDBM TAG IN W CB 11.3M(37FT) N/O BCR @ NW COR NORWALK BLVD & WHITTIER BLVD	Y 6627
BASELINE (2005)	166.945 50.885	SPK IN S CB 3M(10FT) E/O BCR @ SE COR NORWALK BLVD & MINES BLVD	Y 6664
BASELINE (2005)	154.154 46.986	BT SPK IN W CB 1.5M(5FT) N/O BCR @ NW COR NORWALK BLVD & SLAUSON AVE	Y 6665
BASELINE (2005)	154.103 46.971	RDBM TAG IN E CB 600MM(2FT) N/O BCR @ SE COR NORWALK BLVD & SLAUSON AVE	Y 6666
BASELINE (2005)	155.430 47.375	L&T IN E CB NORWALK BLVD ON C/L PROD BURKE ST (TO THE W)	Y 6667
BASELINE (2005)	155.530 47.406	RDBM TAG IN E CB 600MM(2FT) S/O BCR @ SE COR NORWALK BLVD & BURKE ST	Y 6668

QUAD YEAR	ELEV FOOT/METER	DESCRIPTION	BM NUMBER
RIVERA (2005)	383.369 116.851	CSBM MON IN WELL 1M(3.3FT) E/O E CF @ SE COR EMERSON AVE & ALHAMBRA AVE 9.4M(31FT) S/O & 9M(29.5FT) E/O C/L INT MKD (BM 31-19 1953 RE 63)	Y 6710
RIVERA (2005)	382.193 116.493	CSBM MON IN WELL 300MM(1FT) S/O S CF @ SE COR GARVEY AVE & ATLANTIC BLVD 54M(177FT) E/O & 12M(39FT) S/O C/L INT MKD (BM 31-17 1953 RE 63)	Y 6713
RIVERA (2005)	417.297 127.193	L&BN IN SLY END OF CONC PLANTER IN WLY TRAFFIC ISLE 11M(36FT) W/O C/L MONTEREY PASS RD @ FREMONT AVE OPP FROM N SIDE PROD BLDG #508	Y 6715
RIVERA (2005)	401.302 122.317	CSBM MON IN C. B. 300MM(1FT) E/O CF 10.5M(34FT) E/O C/L MONTEREY PASS RD NR N SIDE PROD OF BLDG #736 MKD (BM 31-15A 1961 RE 5869)	Y 6717
RIVERA (2005)	336.678 102.620	L&BR IN E CB MONTEREY PASS RD 10.7M(35FT) E/O C/L & 38M(125FT) N/O PI WITH KERN AVE @ BLDG #1350 (20 FT NLY OF SLY P/L)	Y 6718
RIVERA (2005)	314.664 95.910	CSBM MON IN WELL @ NW COR FORD BLVD & FLORAL DR 21.6M(71FT) N/O & 6M(20FT) W/O C/L INT MKD (31-12A 1961 RE 5869)	Y 6720
RIVERA (2005)	319.110 97.265	L&T IN N CB 2.7M(9FT) E/O BCR @ NE COR INDIANA ST & 3RD ST	Y 6722
BASELINE (2005)	150.272 45.803	L&BN IN CB 300MM(1FT) N/O BCR @ NW COR SLAUSON AVE & GARFIELD AVE	Y 6727
RIVERA (2005)	141.398 43.098	L&T IN SE CB RET 6M(20FT) W/O BCR @ SE COR EASTERN AVE & WASHINGTON BLVD	Y 6736
RIVERA (2005)	152.897 46.603	L&BN IN W CB 600MM(2FT) S/O BCR @ SW COR PASSONS BL & SLAUSON AVE MKD BM	Y 6742
RIVERA (2005)	175.438 53.474	RDBM TAG IN W CB 300MM(1FT) N/O BCR @ NW COR SYCAMORE AVE & BLUFF RD	Y 6743
RIVERA (2005)	201.901 61.540	RAMSET IN CB @ S END OF S DRWY TO HSE #833 BLUFF RD 161M(528FT) S/O BEACH ST	Y 6744
RIVERA (2005)	213.542 65.088	L&BN IN W CB 300MM(1FT) S/O BCR @ SW COR LOS ANGELES AVE & BLUFF RD	Y 6745
RIVERA (2005)	178.519 54.413	L&BN IN S CB BEVERLY RD 12M(39FT) S/O C/L & 23.5M(77FT) E/O C/L CULP DR (@ CUL-DE-SAC)	Y 6746
RIVERA (2005)	354.564 108.071	L&BN IN W CB POTRERO GRANDE DR 300MM(1FT) S/O BCR @ SW COR ARROYO DR MKD (BM)	Y 6747
RIVERA (2005)	153.725 46.856	L&BN IN E CB 1FT N/O BCR @ NW COR ATLANTIC BLVD & 55TH ST 35FT E/O & 31FT N/O C/L INT	Y 6751
RIVERA (2005)	164.416 50.114	L&T IN W CB 17FT S/O C/L OF RR 30FT W/O C/L ATLANTIC BLVD @ N END BRIDGE OVER LA RIVER	Y 6752
RIVERA (2005)	248.081 75.615	L&BN IN W CB 10M(32.8FT) S/O BCR @ SW COR BEVERLY BLVD & GERHART AVE	Y 6757

QUAD YEAR	ELEV FOOT/METER	DESCRIPTION	BM NUMBER
RIVERA (2005)	328.992 100.277	CS MON IN WELL 250MM(0.8FT) DN 6M(20FT) N/O BCR @ NE COR EASTERN AVE & BLANCHARD ST MKD (BM 61-2 1961)	Y 6759
RIVERA (2005)	504.791 153.861	BT SPK IN E CB EASTERN AVE & 10M(33FT) N/O C/L PROD ROSILYN DR (NR NLY P/L HSE #1362)	Y 6763
RIVERA (2005)	457.961 139.587	BT SPK IN E CB 5M(16.5FT) N/O BCR @ NE COR EASTERN AVE & CITY TERRACE DR (NR NLY P/L HSE #1454)	Y 6764
RIVERA (2005)	251.633 76.698	RDBM TAG IN E CB 600MM(2FT) S/O BCR @ NE COR POTRERO GRANDE DR & ARROYO DR	Y 7390
BASELINE (2005)	142.876 43.549	LACS MON IN S END C. B. 14M(46FT) N/O BCR @ NW COR TELEGRAPH RD & PASSONS BLVD INT MKD (BM 4-15A 1968)	Y 7747
BASELINE (2005)	183.371 55.892	FC MON @ NE COR BRIDGE OVER SAN GABRIEL RIVER 15M(49FT) N/O C/L WHITTIER BLVD MKD (BM 078-00010 1968)	Y 7750
BASELINE (2005)	184.442 56.218	FC MON @ SW COR BRIDGE OVER SAN GABRIEL RIVER 14M(46FT) S/O C/L WHITTIER BLVD MKD (BM 077-02855 1968)	Y 7751
BASELINE (2005)	217.940 66.428	CO ENG DISK FL @ SE COR BRIDGE OVER WHITTIER NARROWS RIVER 13M(42.7FT) E/O C/L ROSEMEAD BLVD & 644M(0.4MI) S/O SAN GABRIEL BLVD MKD (BM 1-20B 1965 RE 5869)	Y 7752
BASELINE (2005)	310.638 94.683	RDBM TAG IN CB 300MM(1FT) E/O BCR @ NW COR SAN GABRIEL BLVD & WALNUT GROVE AVE	Y 7754
BASELINE (2005)	318.006 96.929	RDBM TAG IN N CB 600MM(2FT) E/O BCR @ NE COR DELTA ST & SAN GABRIEL BL	Y 7755
BASELINE (2005)	320.112 97.570	RDBM TAG IN N CB 600MM(2FT) W/O BCR @ NW COR DELTA ST & SAN GABRIEL BLVD	Y 7756
BASELINE (2005)	335.850 102.367	RDBM TAG IN S CB 300MM(1FT) W/O BCR @ SW COR SAN GABRIEL BLVD & HILL ST	Y 7757
BASELINE (2005)	334.881 102.072	RDBM TAG IN N CB 300MM(1FT) W/O BCR @ NW COR SAN GABRIEL BLVD & HILL ST	Y 7758
RIVERA (2005)	178.892 54.526	L&BN IN CONC APRON @ NE COR LA VERNE AVE & OLYMPIC BLVD 18.6M(62FT) N/O & 9M(30FT) E/O C/L INT (1.5FT W/O SW COR BLDG)	Y 8096
RIVERA (2005)	310.531 94.650	L&T IN W CB NR BCR @ SW COR FLORAL DR & MEDNIK AVE	Y 8097
RIVERA (2005)	302.109 92.083	RDBM TAG IN E CB 300MM(1FT) N/O BCR @ NE COR CESAR CHAVEZ AVE & MEDNIK AVE	Y 8098
RIVERA (2005)	297.161 90.575	L&BN 1.5M(5FT) S/O BCR @ NE COR OF BRIDGE 17M(55.8FT) S/O & 9M(29.5FT) E/O C/L INT 1ST ST & MENDIK AVE	Y 8099
RIVERA (2005)	245.036 74.687	L&N IN S CB 6.7M(22FT) W/O BCR @ SW COR DOWNEY RD & 3RD ST	Y 8102
RIVERA (2005)	185.528 56.549	WIRE SPK IN S CB 300MM(1FT) W/O BCR @ SW COR INDIANA ST & UNION PACIFIC AVE	Y 8104

QUAD YEAR	ELEV FOOT/METER	DESCRIPTION	BM NUMBER
RIVERA (2005)	185.934 56.673	WIRE SPK IN W END C. B. @ BCR @ NE COR INDIANA ST & UNION PACIFIC AVE	Y 8105
RIVERA (2005)	182.482 55.621	L&T IN W CB @ BCR @ SW COR UNION PACIFIC AVE & MARIANNA AVE	Y 8107
RIVERA (2005)	182.692 55.685	RDBM TAG IN N CB 600MM(2FT) E/O BCR @ NE COR UNION PACIFIC AVE & MARIANNA AVE	Y 8108
RIVERA (2005)	351.715 107.203	RND HD SPK IN S CB EMERSON PL 4.3M(14FT) W/O C/L PROD STEVENS AVE	Y 8109
RIVERA (2005)	179.633 54.752	L&T 13FT S/O BCR 78FT S & 24FT E/O C/L INT WASHINGTON BLVD & INDIANA ST	Y 8111
RIVERA (2005)	192.558 58.692	SPK&L IN E CB 5.2M(17FT) N/O BCR @ NE COR WASHINGTON BL & GRANDE VISTA AVE	Y 8112
RIVERA (2005)	192.988 58.823	L&SPK IN C. B. 3.7M(12FT) W/O BCR @ SW COR WASHINGTON BLVD & GRANDE VISTA AVE	Y 8113
RIVERA (2005)	189.699 57.820	L&T IN S CB 5.8M(19FT) E/O BCR @ SE COR WASHINGTON BLVD & BLUFF RD	Y 8116
RIVERA (2005)	407.301 124.146	RDBM TAG IN E CB EASTERN AVE 10M(33FT) E/O C/L & 185M(607FT) S/O C/L SHERIFF RD	Y 8119
RIVERA (2005)	198.405 60.474	RDBM TAG 1FT W/O BCR 28FT N & 59FT E C/L INT WHITTIER BLVD & EASTERN AVE	Y 8129
RIVERA (2005)	160.444 48.903	RDBM TAG 1FT S BCR 66FT S & 15FT W C/L INT WASHINGTON BLVD & COBB ST	Y 8130
RIVERA (2005)	143.320 43.684	RD HD SPK 1FT W/O BCR 36FT N & 40FT W/O C/L INT WASHINGTON BLVD & O'NEIL AVE CB CUT BM	Y 8132
RIVERA (2005)	148.280 45.196	RDBM TAG 2FT S/O BCR 90FT S/O & 36FT W/O C/L INT ATLANTIC BLVD & SHEILA ST	Y 8133
RIVERA (2005)	187.696 57.210	RDBM TAG IN E CB 600MM(2FT) N/O BCR @ NE COR WASHINGTON BLVD & GREENWOOD AVE	Y 8138
RIVERA (2005)	192.067 58.542	RDBM TAG IN S CB 1M(3.3FT) W/O BCR @ SW COR WASHINGTON BLVD & MONTEBELLO BLVD	Y 8139
RIVERA (2005)	192.853 58.782	RDBM TAG IN S CB NR BCR @ SE COR WASHINGTON BLVD & MONTEBELLO BLVD	Y 8140
RIVERA (2005)	170.146 51.861	L&T IN W CB 600MM(2FT) S/O BCR @ SW COR PASSONS BLVD & MINES AVE	Y 8142
RIVERA (2005)	163.208 49.746	RDBM TAG IN W CB 600MM(2FT) S/O BCR @ SW COR WASHINGTON BLVD & PARAMOUNT BLVD	Y 8143
RIVERA (2005)	372.455 113.525	L&BN IN S CB POTRERO DR L & 160M(525FT) E/O GREENWOOD DR 17M(56FT) W/O ELY MOST DRWY TO EDISON BLDG	Y 8149

QUAD YEAR	ELEV FOOT/METER	DESCRIPTION	BM NUMBER
RIVERA (2005)	264.399 80.589	L&BN IN E CB 4.6M(15FT) N/O BCR @ NE COR POMONA BLVD & FULTON AVE MKD (BM)	Y 8156
RIVERA (2005)	262.335 79.960	L&BN IN N CB 3.7M(12FT) W/O BCR @ NW COR POMONA BLVD & FULTON AVE MKD (BM)	Y 8157
RIVERA (2005)	252.221 76.877	L&BN IN N CB 1.5M(5FT) W/O BCR @ NW COR WILCOX AVE & VIA CAMPO MKD (BM)	Y 8158
RIVERA (2005)	296.892 90.493	L&BN IN S CB 3M(10FT) W/O BCR @ SW COR WILCOX AVE & VIA PASEO MKD (BM)	Y 8161
RIVERA (2005)	295.554 90.085	L&BN IN W CB 450MM(1.5FT) N/O BCR @ NW COR MERLE DR & WESTMORELAND DR MKD (BM)	Y 8164
RIVERA (2005)	297.252 90.603	L&BN IN N CB 300MM(1FT) E/O BCR @ NE COR WESTMORELAND DR & MERLE DR MKD (BM)	Y 8165
RIVERA (2005)	218.956 66.738	L&BR IN E CB @ BCR @ NE COR WILCOX AVE & MADISON AVE	Y 8171
BASELINE (2005)	143.477 43.732	CS MON IN WELL 300MM(1FT) W/O CF 600MM(2FT) S/O BCR @ SW COR NORWALK BLVD & TELEGRAPH RD MKD (BM 2-11B 1970 RE 5869)	Y 8723
BASELINE (2005)	146.887 44.771	FC MON FL @ NW COR OF BRIDGE MKD 1937 OVER SAN GABRIEL RIVER 8M(26FT) N/O C/L TELEGRAPH RD MKD (77-73 1952)	Y 9210
BASELINE (2005)	146.597 44.683	CE MON IN E END C. B. 6.4M(21FT) E/O BCR @ NE COR MALT AVE & SLAUSON AVE MKD (BM 4-18B 1973 RE 7078)	Y 9213
BASELINE (2005)	146.183 44.557	RD BM TAG IN CB 900MM(3FT) W/O BCR @ NW COR SLAUSON AVE & MALT AVE	Y 9214
BASELINE (2005)	137.756 41.988	CSBM MON IN E END C. B. 22.6M(74FT) W/O BCR @ NW COR SLAUSON AVE & ZAMBRANO ST MKD (BM 4-19B 1968 RE 5869)	Y 9216
BASELINE (2005)	141.736 43.201	CS BR CAP MON IN B/W @ W P/L BLDG #5500 SLAUSON AVE NR PP #1007282H MKD (RE 329)	Y 9218
BASELINE (2005)	145.082 44.221	RDBM TAG IN CB 600MM(2FT) E/O BCR @ NE COR SLAUSON AVE & HELIOTROPE AVE	Y 9219
BASELINE (2005)	145.233 44.267	RDBM TAG IN CB 600MM(2FT) W/O BCR @ NW COR SLAUSON AVE & HELIOTROPE AVE	Y 9220
BASELINE (2005)	175.997 53.644	RDBM TAG IN CB 600MM(2FT) E/O BCR @ NE COR SLAUSON AVE & SOTO ST	Y 9225
BASELINE (2005)	323.462 98.592	RDBM TAG IN E CB 300MM(1FT) N/O BCR @ NE COR SAN GABRIEL BLVD & BLEEKER ST	Y 9439
BASELINE (2005)	324.732 98.979	CSBM MON IN WELL 600MM(2FT) S/O BCR @ SW COR SAN GABRIEL BLVD & BLEWETT ST MKD (BM 1-24C 1970 RE 5869)	Y 9440
BASELINE (2005)	212.280 64.703	RDBM TAG IN S CB 300MM(1FT) E/O BCR @ SE COR ROSEMEAD BLVD & SAN GABRIEL BLVD	Y 9442

QUAD YEAR	ELEV FOOT/METER	DESCRIPTION	BM NUMBER
BASLINE (2005)	154.944 47.227	RDBM TAG IN W CB NORWALK BLVD 3.4M(11FT) N/O C/L DRWY TO BLDG #9703 (29.5FT S/O ST LT)	Y 9444
BASLINE (2005)	154.785 47.179	RDBM TAG IN E CB NORWALK BLVD 36.6M(120FT) N/O C/L DRWY TO BLDG #9720 (@ S END C. B.)	Y 9445
BASLINE (2005)	158.436 48.291	L&BR IN N CB 1M(3.3FT) E/O BCR @ NW COR NORWALK BLVD & LOS NIETOS RD	Y 9651
BASLINE (2005)	157.805 48.099	L&T IN E CB @ SE COR SLAUSON AVE & GAGE AVE 32M(105FT) S/O & 10M(33FT) E/O C/L INT	Y 9740
BASLINE (2005)	180.235 54.936	RDBM TAG IN E CB 7M(23FT) N/O BCR @ NE COR WHITTIER BLVD & DURFEE AVE	Y 9756
BASLINE (2005)	180.148 54.909	RDBM TAG IN W CB 9M(29.5) N/O BCR @ NW COR WHITTIER BLVD & DURFEE AVE	Y 9757
BASLINE (2005)	184.665 56.286	RDBM TAG IN E CB 300MM(1FT) S/O BCR @ SE COR BEVERLY RD & DURFEE AVE	Y 9759
BASLINE (2005)	184.826 56.335	RDBM TAG IN C. B. 1M(3.3FT) E/O BCR @ NE COR BEVERLY RD & DURFEE AVE	Y 9760
BASLINE (2005)	134.957 41.135	RDBM TAG IN E END C. B. @ NE COR SLAUSON AVE & ALEXANDER ST	Y 9761
BASLINE (2005)	137.165 41.808	RDBM TAG IN S END C. B. @ NE COR EASTERN AVE & SLAUSON AVE	Y 9762
BASLINE (2005)	137.548 41.925	RDBM TAG IN C. B. 4.6M(15FT) W/O BCR @ SW COR SLAUSON AVE & EASTERN AVE	Y 9763
RIVERA (2005)	185.040 56.400	WIRE SPK NR W ED C B 41FT S/O C/L WASHINGTON BLVD & 0.45 MI W/O INT INDIANA ST MKD (V-673)	Y 9803
RIVERA (2005)	295.816 90.165	RDBM TAG IN S CB 1M(3.3FT) W/O BCR @ SW COR EASTERN AVE & CESAR CHAVEZ AVE	Y 9805
RIVERA (2005)	383.654 116.938	RDBM TAG IN S CB MONTEREY PASS RD 10.7M(35FT) S/O C/L & 483M(1580FT) ELY OF KERN AVE @ BEG OF WALK TO ENT ELY END OF BLDG #1000	Y 9806
RIVERA (2005)	383.230 116.809	RDBM TAG IN E CB @ S END C. B. @ NE COR GARVEY AVE & GARFIELD AVE	Y 9809
RIVERA (2005)	390.840 119.128	SPK IN N CB 3M(10FT) E/O BCR @ NE COR EMERSON AVE & GARFIELD AVE	Y 9810
RIVERA (2005)	156.752 47.778	L&T IN SLY CB WASHINGTON BLVD 10M(33FT) WLY OF C/L PROD SAYBROOK AVE STAMPED (LS 3125)	Y 9814
RIVERA (2005)	157.213 47.919	FC TAG IN ELY CB SAYBROOK AVE @ NE COR WASHINGTON BLVD 5M(16FT) NLY/O BCR @ C. B.	Y 9815
RIVERA (2005)	162.576 49.553	RDBM TAG IN W CB 300MM(1FT) S/O BCR @ NW COR PASSONS BLVD & WASHINGTON BLVD	Y 9817

QUAD YEAR	ELEV FOOT/METER	DESCRIPTION	BM NUMBER
RIVERA (2005)	238.122 72.580	RDBM TAG IN E CB 7.3M(24FT) N/O BCR @ NE COR BEVERLY BLVD & ATLANTIC BLVD	Y 9829
RIVERA (2005)	304.104 92.691	L&T IN S CB ARROYO DR 300MM(1FT) E/O BCR @ SW COR PARAMOUNT BLVD	Y 9832
RIVERA (2005)	218.972 66.743	RDBM TAG IN S END C. B. 1.5M(5FT) N/O BCR @ NW COR BEVERLY BLVD & MONTEBELLO BLVD	Y 9833
RIVERA (2005)	218.880 66.715	RDBM TAG IN E CB @ S END C. B. @ NE COR MONTEBELLO BLVD & BEVERLY BLVD	Y 9834
RIVERA (2005)	208.849 63.657	RDBM TAG IN E CB @ S END C. B. 600MM(2FT) N/O BCR @ NE COR BEVERLY BLVD & POPLAR AVE	Y 9836
RIVERA (2005)	181.487 55.317	RDBM TAG IN S CB @ E END C. B. @ SE COR PARAMOUNT BLVD & BEVERLY RD	Y 9837
RIVERA (2005)	193.775 59.063	L&BN IN E CB 600MM(2FT) S/O BCR @ SE COR LA VERNE AVE & WHITTIER BLVD	Y 9842
RIVERA (2005)	341.889 104.208	RDBM TAG IN E CB 300MM(1FT) S/O BCR @ SE COR WILCOX AVE & HAY ST	Y 9846
RIVERA (2005)	342.388 104.360	RDBM TAG IN E CB 300MM(1FT) N/O BCR @ NW COR WILCOX AVE & HAY ST	Y 9847
RIVERA (2005)	370.542 112.942	RDBM TAG IN N CB POTRERO GRANDE DR 300MM(1FT) W/O BCR @ NW COR KENTON DR	Y 9849
RIVERA (2005)	304.794 92.901	L&T IN E CB PARAMOUNT BLVD 1M(3.3FT) S/O BCR @ SE COR ARROYO DR (3.3FT N/O N END C. B.)	Y 9850
RIVERA (2005)	191.496 58.368	RDBM TAG IN S END C. B. @ NW COR UNION PACIFIC AVE & DITMAN AVE 12.5M(41FT) N/O & 6.4M(21FT) W/O C/L INT	Y 9858
RIVERA (2005)	191.925 58.499	RDBM TAG IN W CB 300MM(1FT) N/O BCR @ NW COR UNION PACIFIC AVE & HERBERT AVE	Y 9859
RIVERA (2005)	176.009 53.648	CS TAG IN SLY CB TELEGRAPH RD ON C/L PROD DUNCAN AVE	Y 9861
RIVERA (2005)	257.695 78.546	L&T IN S CB 3RD ST ON C/L PROD SUNOL DR	Y 9864
RIVERA (2005)	143.522 43.746	L&T IN SE CB RET 300MM(1FT) N/O BCR @ SE COR EASTERN AVE & HARBOR ST	Y 9870
RIVERA (2005)	177.730 54.172	CS TAG IN S CB 300MM(1FT) W/O BCR @ SE COR OLYMPIC BLVD & LA VERNE AVE	Y 9874
RIVERA (2005)	297.167 90.577	L&BN IN NW COR BRIDGE OVER POMONA FRWY 17M(55.8FT) S/O & 9M(29.5FT) W/O C/L INT MENDIK AVE & 1ST ST	Y 9878
RIVERA (2005)	416.936 127.082	L&T IN S CB 300MM(1FT) W/O BCR @ SW COR BLANCHARD ST & DITMAN AVE	Y 9880

QUAD YEAR	ELEV FOOT/METER	DESCRIPTION	BM NUMBER
RIVERA (2005)	437.168 133.249	L&SPK IN TOP OF 1M(3.3FT) RET WALL @ WLY ANGLE PT 9M(30FT) E/O C/L PROD HERBERT AVE (TO N) 3M(10FT) S/O CF & 15M(49FT) S/O C/L CITY TERRACE DR	Y 9882
RIVERA (2005)	324.490 98.905	L&T IN W CB EASTERN AVE @ C/L PROD BLANCHARD ST	Y 9883
RIVERA (2005)	435.171 132.641	CS TAG IN W CB EASTERN AVE @ C/L PROD SHERIFF RD	Y 9886
RIVERA (2005)	190.715 58.130	FC BR CAP MON IN NE COR OF RR BRIDGE ABUT OVER LA RIVER 70M(230FT) S/O & 23.5M(77FT) E/O C/L INT DOWNEY RD & BANDINI BLVD MKD (BM 006-02790 1963)	Y 10115
RIVERA (2005)	138.404 42.186	BM TAG IN C. B. 300MM(1FT) N/O CF @ NW COR RICKENBACKER RD & EASTERN AVE	Y 10119
RIVERA (2005)	140.928 42.955	L&T IN E CB @ BLDG #4680 EASTERN AVE & 25.5M(84FT) N/O C/L SLY DRWY ENT (MKD BM) 267M(875FT) N/O C/L BANDINI BLVD	Y 10120
RIVERA (2005)	212.966 64.912	RDBM TAG IN N CB 1.5M(5FT) W/O BCR @ NW COR BLUFF RD & MOUNTAIN VIEW AVE	Y 10122
BASELINE (2005)	150.797 45.963	RDBM TAG IN S CB 300MM(1FT) W/O BCR @ SE COR SLAUSON AVE & ATLANTIC BLVD	Y 10197
BASELINE (2005)	158.212 48.223	RDBM TAG IN N CB SLAUSON AVE @ OR NR C/L PROD TRIANGLE DR (600MM(2FT) W/O W END C. B.)	Y 10198
BASELINE (2005)	161.175 49.126	RDBM TAG IN S CB 300MM(1FT) W/O BCR @ SW COR SLAUSON AVE & GREENWOOD AVE	Y 10199
BASELINE (2005)	150.536 45.884	RDBM TAG NE COR CONC HDWL TO ELECTRIC TOWER #BTL1-258D4 59M(194FT) E/O E END BRIDGE #53-212 OVER RIO HONDO & 12M(40FT) S/O C/L TELEGRAPH RD	Y 10200
BASELINE (2005)	144.996 44.195	CALIF DIV OF HWY 50MM(2IN) DISC IN CB 1M(3.3FT) W/O BCR @ NW COR TELEGRAPH RD & PARAMOUNT BLVD MKD (BELL K-4 1941 NO 5 1972)	Y 10201
BASELINE (2005)	141.079 43.001	RDBM TAG IN S CB 300MM(1FT) E/O BCR @ NE COR ROSEMEAD BLVD & TELEGRAPH RD	Y 10202
BASELINE (2005)	144.605 44.076	RDBM TAG IN S CB 300MM(1FT) E/O BCR @ SE COR NORWALK BLVD & TELEGRAPH RD	Y 10203
RIVERA (2005)	224.412 68.401	DPW BM TAG IN E CB 300MM(1FT) N/O BCR @ NE COR WHITTIER BLVD & INDIANA ST	Y 10242
RIVERA (2005)	317.400 96.744	L&T IN S CB 300MM(1FT) W/O BCR @ SW COR CESAR CHAVEZ AVE & RECORD AVE	Y 10244
RIVERA (2005)	268.094 81.715	L&T IN S CB 300MM(1FT) W/O BCR @ SW COR CESAR CHAVEZ AVE & CARMELITA AVE	Y 10245
RIVERA (2005)	303.178 92.409	L&SPK IN N CB 3M(10FT) E/O BCR @ NE COR EASTERN AVE & CESAR CHAVEZ AVE	Y 10246

QUAD YEAR	ELEV FOOT/METER	DESCRIPTION	BM NUMBER
RIVERA (2005)	410.043 124.981	DPW BM TAG IN N CB 300MM(1FT) E/O BCR @ NE COR GARVEY AVE & HITCHOCK DR (N) CUL-DE-SAC	Y 10249
BASELINE (2005)	194.706 59.347	DPW BM TAG IN W CB 300MM(1FT) S/O BCR @ SW COR DURFEE AVE & ISORA ST	Y 10254
BASELINE (2005)	246.841 75.237	LACO BM TAG IN E CB 300MM(1FT) S/O BCR @ SE COR SAN GABRIEL BLVD & DARLINGTON ST	Y 10256
BASELINE (2005)	250.927 76.483	DPW BM TAG IN E CB 300MM(1FT) N/O BCR @ NE COR SAN GABRIEL BLVD & DARLINGTON ST	Y 10257
BASELINE (2005)	279.038 85.051	DPW BM TAG IN E CB 300MM(1FT) N/O BCR @ NE COR MUSCATEL AVE & SAN GABRIEL BLVD	Y 10258
BASELINE (2005)	171.767 52.355	L&BR IN W CB RET 2.4M(8FT) N/O BCR @ SW COR NORWALK BLVD & LOCH AVON DR	Y 10259
BASELINE (2005)	167.969 51.197	L&DN IN N CB 300MM(1FT) W/O BCR @ NW COR SLAUSON AVE & DOWNEY RD	Y 10568
RIVERA (2005)	175.440 53.474	DPW BM TAG IN W CB DOWNEY RD 3M(10FT) N/O N END C. B. @ BLDG #5501 (1300 FT N/O C/L SLAUSON AVE)	Y 10570
RIVERA (2005)	184.159 56.132	DPW BM TAG IN W CB 300MM(1FT) S/O BCR @ SW COR DOWNEY RD & LEONIS BLVD	Y 10571
RIVERA (2005)	185.967 56.683	L&SPK IN W CB 1M(3.3FT) N/O BCR @ NW COR DOWNEY RD & 45TH ST	Y 10572
RIVERA (2005)	277.791 84.671	2 IN BR DISC IN CTR DEPRESSED CB RET @ SW COR INDIANA ST & 6TH ST W MKD (LAMTA ESE-021 1994)	Y 10573
RIVERA (2005)	282.899 86.228	DPW BM TAG IN E CB 1M(3.3FT) S/O BCR @ NE COR INDIANA ST & 6TH ST (TO THE E)	Y 10574
RIVERA (2005)	405.629 123.636	DPW BM TAG IN SLY CB MONTERY PASS RD 300MM(1FT) E/O E END C. B. @ BLDG #616 (10.7M(35FT) S/O C/L)	Y 10575
RIVERA (2005)	405.606 123.629	DPW BM TAG IN N CB MONTERY PASS RD 300MM(1FT) E/O E END C. B. @ BLDG #617	Y 10576
RIVERA (2005)	383.930 117.022	DPW BM TAG IN N CB 20M(66FT) E/O BCR @ NE COR ATLANTIC BLVD & GARVEY AVE (@ FIRE HYD)	Y 10577
RIVERA (2005)	387.774 118.194	DPW BM TAG IN S CB 2.4M(8FT) W/O BCR @ SW COR GARVEY AVE & YNEZ AVE	Y 10578
RIVERA (2005)	387.276 118.042	RAM SET IN S CB 300MM(1FT) E/O BCR @ SE COR GARVEY AVE & YNEZ AVE	Y 10579
RIVERA (2005)	383.024 116.746	DPW BM TAG IN N CB 300MM(1FT) E/O BCR @ NW COR GARFIELD AVE & GARVEY AVE	Y 10580
RIVERA (2005)	373.308 113.785	L&BR IN S CB 1.5M(5FT) E/O BCR @ SE COR EMERSON AVE & ORANGE AVE	Y 10582
RIVERA (2005)	359.213 109.488	L&RCE TAG #9548 IN W CB 600MM(2FT) S/O BCR @ SW COR EMERSON AVE & NEW AVE	Y 10583

QUAD YEAR	ELEV FOOT/METER	DESCRIPTION	BM NUMBER
RIVERA (2005)	307.885 93.844	L&T IN CB RET 2.7M(9FT) N/O BCR @ SE COR EMERSON PL & DEL MAR AVE	Y 10584
RIVERA (2005)	191.822 58.468	LRG PK IN W CB OF BRIDGE OVER LA RIVER 12M(39.5FT) S/O NW COR BRIDGE 70.4M(230FT) S/O & 8M(26.2FT) W/O C/L INT DOWNEY RD & BANDINI BLVD	Y 10586
RIVERA (2005)	319.826 97.483	50MM(2IN) BR DISC IN W DRWY 29M(95FT) S/O BCR @ SW COR 1ST ST & INDIANA ST MKD (LAMTA ESE-019 1994)	Y 10587
RIVERA (2005)	301.826 91.997	LACE TAG IN W CB 1M(3.3FT) N/O BCR @ SW COR MEDNIK AVE & CESAR CHAVEZ AVE (BROOKLYN AV)	Y 10588
RIVERA (2005)	248.520 75.749	DPW BM TAG IN W CB 2M(6.5FT) N/O BCR @ NW COR 4TH ST & LA VERNE AVE	Y 10589
RIVERA (2005)	215.597 65.714	DPW BM TAG IN E CB 1M(3.3FT) N/O BCR @ NE COR 6TH ST & LA VERNE AVE	Y 10591
RIVERA (2005)	214.697 65.440	DPW BM TAG IN W CB 1M(3.3FT) S/O BCR @ SW COR 6TH ST & LA VERNE AVE	Y 10592
RIVERA (2005)	193.874 59.093	50MM(2IN) DISK IN S CB 1M(3.3FT) E/O BCR @ SE COR LA VERNE AVE & WHITTIER BLVD MKD (LAMTA ESE 031 1994)	Y 10593
RIVERA (2005)	176.260 53.724	DPW BM TAG IN N CB 1M(3.3FT) W/O BCR @ NE COR OLYMPIC BLVD & ATLANTIC BLVD	Y 10594
RIVERA (2005)	174.735 53.259	DPW BM TAG IN W CB 600MM(2FT) N/O BCR @ SW COR OLYMPIC BLVD & ATLANTIC BLVD	Y 10595
RIVERA (2005)	141.590 43.157	L&SPK IN E CB 300MM(1FT) N/O BCR @ NE COR WASHINGTON BLVD & EASTERN AVE	Y 10596
RIVERA (2005)	138.596 42.244	DPW BM TAG IN E CB 300MM(1FT) N/O BCR @ SE COR EASTERN AVE & RICKENBACKER RD	Y 10597
BASELINE (2005)	168.611 51.393	2 IN DISC IN WALK 1.4M(4.6FT) N/O CF 4.5M(14.8FT) W/O BCR @ NE COR SLAUSON AVE & BOYLE AVE (TO THE N) MKD (CITY OF VERNON MON)	Y 10598
RIVERA (2005)	302.243 92.124	DPW BM TAG IN N CB 6M(20FT) E/O C/L DRWY E/O BCR @ NE COR 3RD ST & GAGE AVE (TO THE N) 27M(89FT) E/O & 12.5M(41FT) N/O C/L INT	Y 10600
RIVERA (2005)	303.186 92.411	DPW BM TAG IN S END C. B. 2M(6.5FT) N/O BCR @ NE COR 3RD ST & EASTERN AVE	Y 10602
RIVERA (2005)	410.467 125.111	DPW BM TAG IN W CB 1M(3.3FT) N/O BCR @ NW COR ROWAN AVE & FOLSOM ST	Y 10604
RIVERA (2005)	408.180 124.414	DPW BM TAG IN E CB 1M(3.3FT) N/O BCR @ NE COR TOWNSEND AVE & BLANCHARD ST	Y 10605
RIVERA (2005)	420.931 128.300	DPW BM TAG IN W CB 300MM(1FT) N/O BCR @ NW COR DITMAN AVE & BLANCHARD ST	Y 10606

QUAD YEAR	ELEV FOOT/METER	DESCRIPTION	BM NUMBER
RIVERA (2005)	441.936 134.702	DPW BM TAG IN E CB 600MM(2FT) N/O BCR @ NE COR POMEROY ST & CITY TERRACE DR	Y 10607
RIVERA (2005)	432.682 131.882	DPW BM TAG IN N CB 600MM(2FT) E/O BCR @ NE COR HERBERT AVE (TO THE N) & CITY TERRACE DR	Y 10609
RIVERA (2005)	381.034 116.140	L&T IN C. B. 3M(10FT) W/O BCR @ NW COR MEDFORD ST & BONNIE BEACH PL	Y 10610
RIVERA (2005)	411.629 125.465	DPW BM TAG IN NLY CB MEDFORD ST 10M(33FT) N/O C/L & 43M(144FT) SWLY/O C/L EASTERN AVE (6.5FT W/O BCR)	Y 10611
RIVERA (2005)	460.180 140.263	DPW BM TAG IN CONC WALK 1.5M(5FT) S/O BCR & 300MM(1FT) E/O CF @ SE COR EASTERN AVE & CITY TERRACE DR	Y 10614
RIVERA (2005)	303.447 92.491	DPW BM TAG IN N CB 300MM(1FT) E/O BCR @ NE COR ROWAN AVE & CESAR CHAVEZ AVE	Y 10617
RIVERA (2005)	438.416 133.630	DPW BM TAG IN E CB 300MM(1FT) N/O BCR @ NE COR EASTERN AVE & SHERRIFF RD	Y 10618
RIVERA (2005)	239.366 72.959	DPW BM TAG IN N CB 3.7M(12FT) W/O BCR @ NW COR BEVERLY BLVD & ATLANTIC BLVD (NR WLY END C. B.)	Y 10619
RIVERA (2005)	234.253 71.401	DPW BM TAG IN N CB BEVERLY BLVD 5M(16.5FT) W/O BCR @ NW COR MARGARET AVE	Y 10620
RIVERA (2005)	234.469 71.466	DPW BM TAG IN S CB BEVERLY BLVD 300MM(1FT) E/O BCR @ SE COR MARGARET AVE	Y 10621
RIVERA (2005)	241.736 73.681	DPW BM TAG IN S CB BEVERLY BLVD 300MM(1FT) W/O BCR @ SW COR BRADSHAW AVE	Y 10622
RIVERA (2005)	241.503 73.610	DPW BM TAG IN E CB BRADSHAW AVE 300MM(1FT) N/O BCR @ NE COR BEVERLY BLVD	Y 10623
RIVERA (2005)	221.075 67.384	L&DPW TAG IN W CB 1M(3FT) N/O BCR @ NW COR BRADSHAW AVE & 6TH ST	Y 10624
RIVERA (2005)	220.149 67.102	L&T IN S CB 300MM(1FT) W/O BCR @ SW COR BRADSHAW AVE & 6TH ST	Y 10625
RIVERA (2005)	190.052 57.928	DPW BM TAG IN S CB WHITTIER BLVD 3M(10FT) E/O C/L PROD BRADSHAW AVE (TO THE N)	Y 10631
RIVERA (2005)	203.720 62.094	DPW BM TAG IN S CB 300MM(1FT) E/O BCR @ SE COR GARFIELD AVE & WHITTIER BLVD	Y 10632
RIVERA (2005)	203.594 62.056	DPW BM TAG IN W CB 300MM(1FT) N/O BCR @ NW COR GARFIELD AVE & WHITTIER BLVD	Y 10633
RIVERA (2005)	201.895 61.538	DPW BM TAG IN W CB 3M(10FT) N/O BCR @ NW COR WHITTIER BLVD & WILCOX AVE (@ N END C. B.)	Y 10634
RIVERA (2005)	201.924 61.547	DPW BM TAG IN E CB 17M(56FT) N/O BCR @ NE COR WHITTIER BLVD & WILCOX AVE	Y 10635
RIVERA (2005)	247.877 75.553	DPW BM TAG IN W CB 300MM(1FT) S/O BCR @ SW COR BEVERLY BLVD & WILCOX AVE	Y 10636

QUAD YEAR	ELEV FOOT/METER	DESCRIPTION	BM NUMBER
RIVERA (2005)	249.653 76.094	DPW BM TAG IN N CB 11M(36FT) E/O BCR @ NE COR BEVERLY BLVD & WILCOX AVE	Y 10637
RIVERA (2005)	251.720 76.724	DPW BM TAG IN S CB 3.7M(12FT) W/O BCR @ SW COR BEVERLY BLVD & VAIL AVE	Y 10638
RIVERA (2005)	251.094 76.534	DPW BM TAG IN S CB 5M(16.4FT) E/O BCR @ SE COR VAIL AVE & BEVERLY BLVD	Y 10639
RIVERA (2005)	225.030 68.589	L&BR IN N CB 13.4M(44FT) N/O BCR @ NW COR BEVERLY BLVD & TAYLOR AVE	Y 10640
RIVERA (2005)	224.924 68.557	L&BR IN E CB 13.7M(45FT) N/O BCR @ NE COR BEVERLY BLVD & TAYLOR AVE	Y 10641
RIVERA (2005)	225.946 68.869	DPW BM TAG IN W CB 12M(39.4FT) S/O BCR @ SW COR 10TH ST & BEVERLY BLVD	Y 10642
RIVERA (2005)	208.559 63.569	DPW BM TAG IN W CB 2M(6.5FT) S/O BCR @ SW COR BEVERLY BLVD & POPLAR AVE	Y 10643
RIVERA (2005)	179.658 54.760	DPW BM TAG IN N CB 600MM(2FT) W/O BCR @ NW COR BEVERLY RD & PINE ST	Y 10644
RIVERA (2005)	180.240 54.937	DPW BM TAG IN S CB 600MM(2FT) E/O BCR @ SE COR BEVERLY RD & PINE ST	Y 10645
RIVERA (2005)	181.352 55.276	DPW BM TAG IN N CB 8.5M(28FT) E/O BCR @ NE COR PARAMOUNT BLVD & BEVERLY RD	Y 10646
RIVERA (2005)	184.138 56.125	DPW BM TAG IN W CB 11M(36FT) N/O BCR @ NW COR ROSEMEAD BLVD & BEVERLY RD	Y 10647
RIVERA (2005)	186.267 56.774	DPW BM TAG IN N CB 1M(3.3FT) E/O BCR @ NE COR BEVERLY RD & LINDSEY AVE	Y 10648
RIVERA (2005)	191.764 58.450	DPW BM TAG IN N CB 600MM(2FT) W/O BCR @ NW COR UNION PACIFIC AVE & DOWNEY RD	Y 10650
RIVERA (2005)	190.875 58.179	L&BR IN S CB 1.5M(5FT) E/O BCR @ SE COR DOWNEY RD & UNION PACIFIC AVE	Y 10651
RIVERA (2005)	176.279 53.730	DPW BM TAG IN E CB 8.5M(28FT) N/O BCR @ NE COR TELEGRAPH RD & DUNCAN AVE	Y 10652
RIVERA (2005)	166.801 50.841	DPW BM TAG IN N CB 600MM(2FT) W/O BCR @ NW COR TELEGRAPH RD & KERN AVE	Y 10653
RIVERA (2005)	162.650 49.576	DPW BM TAG IN W CB 300MM(1FT) S/O BCR @ NW COR LA VERNE AVE & TELEGRAPH RD	Y 10654
RIVERA (2005)	162.448 49.514	DPW BM TAG IN E CB 3M(10FT) N/O BCR @ NE COR TELEGRAPH RD & LA VERNE AVE	Y 10655
RIVERA (2005)	149.109 45.449	DPW BM TAG IN NLY CB 2.7M(9FT) W/O BCR @ NW COR TELEGRAPH RD & HOFNER AVE	Y 10657

QUAD YEAR	ELEV FOOT/METER	DESCRIPTION	BM NUMBER
RIVERA (2005)	153.026 46.642	DPW BM TAG IN N CB 300MM(1FT) E/O BCR @ NE COR TELEGRAPH RD & GASPAR AVE	Y 10659
RIVERA (2005)	149.279 45.500	DPW BM TAG IN N CB 2.4M(8FT) W/O BCR @ NW COR TELEGRAPH RD & TUBEWAY AVE	Y 10660
RIVERA (2005)	149.943 45.703	DPW BM TAG IN E CB 300MM(1FT) N/O BCR @ NE COR TELEGRAPH RD & TUBEWAY AVE	Y 10661
RIVERA (2005)	150.023 45.727	DPW BM TAG IN S CB 1M(3.3FT) W/O BCR @ SW COR TELEGRAPH RD & WASHINGTON BLVD	Y 10662
RIVERA (2005)	150.720 45.940	DPW BM TAG IN N CB 600MM(2FT) W/O BCR @ NW COR TELEGRAPH RD & WASHINGTON BLVD	Y 10663
RIVERA (2005)	171.069 52.142	DPW BM TAG IN E CB 1M(3.3FT) N/O BCR @ NE COR WASHINGTON BLVD & GARFIELD AVE	Y 10664
RIVERA (2005)	174.997 53.339	DPW BM TAG IN S CB 600MM(2FT) E/O BCR @ SE COR WASHINGTON BLVD & VAIL AVE	Y 10665
RIVERA (2005)	176.926 53.927	DPW BM TAG IN N CB 1M(3.3FT) W/O BCR @ NW COR WASHINGTON BLVD & MAPLE AVE	Y 10667
RIVERA (2005)	180.205 54.927	DPW BM TAG IN N CB 41.5M(136FT) E/O BCR @ NE COR WASHINGTON BLVD & MAPLE AVE	Y 10668
RIVERA (2005)	187.845 57.255	DPW BM TAG IN W CB 14.6M(48FT) N/O BCR @ NW COR GREENWOOD AVE & WASHINGTON BLVD	Y 10669
RIVERA (2005)	191.489 58.366	FC DISC 1M(3.3FT) BK/O CF @ NW COR BRIDGE 16.5M(54FT) N/O C/L WASHINGTON BLVD & 9.4M(31FT) E/O C/L BLUFF RD MKD (BM 053-02001 1979)	Y 10670
RIVERA (2005)	163.155 49.730	DPW BM TAG IN N CB 4.6M(15FT) E/O BCR @ NE COR PARAMOUNT BLVD & WASHINGTON BLVD	Y 10671
RIVERA (2005)	162.750 49.606	DPW BM TAG IN S CB 1M(3.3FT) E/O BCR @ SE COR ROSEMEAD BLVD & WASHINGTON BLVD	Y 10672
RIVERA (2005)	162.075 49.401	DPW BM TAG IN N CB 1.8M(6FT) E/O BCR @ NE COR PASSONS BLVD & WASHINGTON BLVD	Y 10673
RIVERA (2005)	160.293 48.857	DPW BM TAG IN N CB 1M(3.3FT) W/O BCR @ NW COR WASHINGTON BLVD & PIONEER BLVD	Y 10674
RIVERA (2005)	159.937 48.749	DPW BM TAG IN S CB 1M(3.3FT) E/O BCR @ SE COR WASHINGTON BLVD & PIONEER BLVD	Y 10675
RIVERA (2005)	188.025 57.310	DPW BM TAG IN W CB 1M(3.3FT) N/O BCR @ NW COR GARFIELD AVE & FERGUSON DR	Y 10676
RIVERA (2005)	186.852 56.953	L&T IN S CB 150MM(0.5FT) E/O BCR @ SE COR GARFIELD AVE & FERGUSON DR	Y 10677
RIVERA (2005)	213.404 65.046	DPW BM TAG IN W CB 3M(10FT) N/O BCR @ NW COR POPLAR AVE & POPLAR WAY (@ HSE #117)	Y 10678

QUAD YEAR	ELEV FOOT/METER	DESCRIPTION	BM NUMBER
RIVERA (2005)	213.277 65.007	DPW BM TAG IN W CB 4.6M(15FT) S/O BCR @ SW COR MOUNTAIN VIEW AVE & BLUFF RD	Y 10679
RIVERA (2005)	213.529 65.084	L&T IN W CB 1.5M(5FT) N/O BCR @ NW COR BLUFF RD & MINES AVE	Y 10680
RIVERA (2005)	212.757 64.849	DPW BM TAG IN W CB 14.3M(47FT) S/O BCR @ SW COR BLUFF RD & MINES AVE	Y 10681
RIVERA (2005)	204.609 62.365	RAMSET IN W CB 600MM(2FT) S/O BCR @ SW COR BLUFF RD & BEACH ST	Y 10682
RIVERA (2005)	182.854 55.734	DPW BM TAG IN W CB 1M(3.3FT) N/O BCR @ NW COR BLUFF RD & DATE ST	Y 10683
RIVERA (2005)	181.678 55.376	DPW BM TAG IN N CB 1M(3.3FT) W/O BCR @ NW COR OAKWOOD ST & BLUFF RD	Y 10684
RIVERA (2005)	181.659 55.370	L&BR IN W CB 1.5M(5FT) S/O BCR @ SW COR BLUFF RD & OAKWOOD ST	Y 10685
RIVERA (2005)	173.053 52.747	DPW BM TAG IN W CB 300MM(1FT) S/O BCR @ SW COR MAYNARD RD & BLUFF RD	Y 10686
RIVERA (2005)	160.189 48.826	FC DISC @ NW COR BRIDGE ABUT 24.4M(80FT) E/O & 8.7M(29FT) N/O C/L INT SLAUSON AVE & BLUFF RD MKD (053-00955)	Y 10687
RIVERA (2005)	156.847 47.807	DPW BM TAG IN N CB 600MM(2FT) W/O BCR @ NW COR SLAUSON AVE & BLUFF RD	Y 10688
BASELINE (2005)	181.408 55.293	LACO BM TAG IN E CB 1M(3.3FT) N/O BCR @ NE COR WHITTIER BLVD & PASSONS BLVD	Y 10689
BASELINE (2005)	180.778 55.101	LACO BM TAG IN W CB 8M(26FT) N/O BCR @ NW COR WHITTIER BLVD & PASSONS BLVD	Y 10690
RIVERA (2005)	178.725 54.476	PK&L IN E CB 300MM(1FT) N/O BCR @ NE COR PASSONS BLVD & HOLBROOK ST	Y 10691
RIVERA (2005)	178.341 54.359	DPW BM TAG IN E CB 2M(6.5FT) S/O BCR @ SE COR PASSONS BLVD & HOLBROOK ST	Y 10692
RIVERA (2005)	175.315 53.436	DPW BM TAG IN E CB 2M(6.5FT) N/O BCR @ NE COR PASSONS BLVD & TOWNLEY DR	Y 10693
RIVERA (2005)	174.622 53.225	DPW BM TAG IN E CB 2M(6.5FT) S/O BCR @ SE COR PASSONS BLVD & TOWNLEY DR	Y 10694
RIVERA (2005)	169.888 51.782	DPW BM TAG IN N CB 1.6M(5FT) E/O BCR @ NE COR PASSONS BLVD & MINES AVE	Y 10695
RIVERA (2005)	166.485 50.745	DPW BM TAG IN S CB 1.5M(5FT) E/O BCR @ SE COR PASSONS BLVD & MAJORIE AVE	Y 10696

QUAD YEAR	ELEV FOOT/METER	DESCRIPTION	BM NUMBER
BASELINE (2005)	271.638 82.796	LACO BM TAG IN E CB 2M(6.5FT) N/O BCR @ NE COR SAN GABRIEL BLVD & RUSH ST	Y 10697
BASELINE (2005)	280.880 85.612	LACO BM TAG IN E CB 4.3M(14FT) S/O BCR @ SE COR SAN GABRIEL BLVD & KLINGERMANN	Y 10698
BASELINE (2005)	281.155 85.696	L&BR IN W CB 300MM(1FT) N/O BCR @ NW COR SAN GABRIEL BLVD & BARUCH ST	Y 10699
BASELINE (2005)	268.735 81.911	DPW BM TAG IN W CB 1M(3.3FT) S/O BCR @ SW COR SAN GABRIEL BLVD & GARVALIA AVE	Y 10700
BASELINE (2005)	219.140 66.794	L&BR IN S CB 17M(56FT) W/O BCR @ SW COR SAN GABRIEL BLVD & LINCOLN AVE	Y 10704
BASELINE (2005)	230.011 70.108	LACO BM TAG IN E CB 11.5M(38FT) S/O BCR @ SE COR SAN GABRIEL BLVD & PLAZA DR	Y 10707
BASELINE (2005)	134.879 41.111	LACO BM TAG IN N CB 300MM(1FT) E/O BCR @ NE COR ORR & DAY RD & TELEGRAPH RD	Y 10710
BASELINE (2005)	142.403 43.405	L&T IN W CB 5.2M(17FT) S/O BCR @ SW COR TELEGRAPH RD & HASTY AVE	Y 10712
BASELINE (2005)	140.667 42.875	CAL TRANS 50MM(2IN) BR DISC IN SW CB RET 4M(13FT) E/O BCR TRUE AVE & TELEGRAPH RD (E END ISLE) 13.4M(44FT) S/O & 8.8M(29FT) W/O C/L INT MKD WHITTIER A-6 1941 NO5 1972	Y 10713
BASELINE (2005)	159.300 48.555	LACO DPW BM TAG IN S CB 1.5M(5FT) W/O BCR @ SW COR SLAUSON AVE & GIFFORD AVE	Y 10787
BASELINE (2005)	176.365 53.756	DPW BM TAG IN N CB 600MM(2FT) W/O BCR @ NW COR SLAUSON AVE & SOTO ST	Y 10819
BASELINE (2005)	168.343 51.311	DPW BM TAG IN S CB 300MM(1FT) W/O BCR @ SE COR SLAUSON AVE & STATE ST (TO THE S)	Y 10835
BASELINE (2005)	165.667 50.495	L&DN IN S CB 3.4M(11FT) E/O BCR @ SE COR SLAUSON AVE & ALCOA AVE (@ F HYD)	Y 10836
BASELINE (2005)	151.250 46.101	DPW BM TAG IN S CB 1M(3.3FT) W/O BCR @ SW COR SLAUSON AVE & ATLANTIC BL	Y 10838
BASELINE (2005)	149.665 45.618	DPW BM TAG IN W CB 1M(3.3FT) S/O BCR @ SW COR SLAUSON AVE & GARFIELD AVE	Y 10840
BASELINE (2005)	144.762 44.124	CAL TRANS 100MM(4IN) BR DISC IN B/W NR MCR @ SW COR TELEGRAPH RD & PARAMOUNT BLVD MKD (BELL K-4 1941 NO 4 1972)	Y 10841
BASELINE (2005)	141.106 43.009	US ARMY CORP OF ENG 100MM(4IN) BR DISC IN E CB 1.8M(6FT) N/O BCR @ NE COR TELEGRAPH RD & ROSEMEAD BLVD MKD (WS 101 1981 LAAO)	Y 10882
BASELINE (2005)	139.490 42.517	DPW BM TAG IN W CB 1M(3.3FT) N/O BCR @ NW COR TELEGRAPH RD & SERAPIS AVE	Y 10883
BASELINE (2005)	140.751 42.901	RAM SET IN S CB 10.5M(34.4FT) W/O BCR @ SW COR TELEGRAPH RD & TRUE AVE	Y 10884

QUAD YEAR	ELEV FOOT/METER	DESCRIPTION	BM NUMBER
BASELINE (2005)	153.724 46.855	DPW BM TAG IN E CB 1M(3.3FT) S/O BCR @ SE COR NORWALK BLVD & BELL RANCH DR	Y 10885
BASELINE (2005)	158.583 48.336	DPW BM TAG IN E CB 2M(6.5FT) S/O BCR @ SE COR NORWALK BLVD & PIKE ST	Y 10886
BASELINE (2005)	197.557 60.216	L&T IN W CB 150MM(0.5FT) N/O BCR @ NW COR SANDOWN RD & DURFEE AVE	Y 10888
BASELINE (2005)	197.030 60.055	CSBM DISC IN SW LEG OF DWP TOWER # 253D4 @ NE COR DURFEE AVE & KRUSE RD MKD (BM 1-19A 1970)	Y 10889
RIVERA (2005)	171.757 52.352	US ARMY CORP ENGR DISK IN N CB 300MM(1FT) W/O NW COR BRIDGE OVER SAN GABRIEL RIVER 7M(23FT) N/O C/L WASHINGTON BL MKD (SG 431 1959)	Y 11494
RIVERA (2005)	162.977 49.676	LACO BM TAG IN N CB WASHINGTON BLVD 13M(42FT) N/O C/L & 162M(530FT) E/O E END BRIDGE OVER RIO HONDO RIVER (@ PP #2317333E)	Y 11495
RIVERA (2005)	173.306 52.824	LACO BM TAG IN N CB NR E END C. B. 4M(13FT) E/O BCR @ NE COR YATES AVE & WASHINGTON BLVD	Y 11496
RIVERA (2005)	164.080 50.012	LACO BM TAG IN N CB 13M(43FT) E/O BCR @ W END C. B. @ NE COR WASHINGTON BLVD & GAYHART ST	Y 11497
RIVERA (2005)	208.793 63.640	LACO BM TAG IN W CB @ N END C. B. 4M(13FT) N/O BCR @ NW COR BEVERLY BLVD & 4TH ST	Y 11498
RIVERA (2005)	258.613 78.825	LACO BM TAG IN W CB 150MM(0.5FT) S/O BCR @ SW COR POMONA BLVD & WILCOX AVE	Y 11499
RIVERA (2005)	290.329 88.493	LACO BM TAG IN E CB MARKLAND AVE 1M(3.3FT) S/O BCR @ SE COR POTRERO GRANDE DR	Y 11500
RIVERA (2005)	293.806 89.552	MWD DISK IN N CB POTRERO GRANDE DR 4M(13FT) E/O BCR @ NE COR MARKLAND AVE MKD (GVE 13 1992)	Y 11501
RIVERA (2005)	330.225 100.653	L&BN IN N CB POTRERO GRANDE DR & 95M(312FT) E/O C/L ATLAS AVE (86FT W/O C/L ENT TO BLDG #601)	Y 11502
RIVERA (2005)	351.642 107.181	SM DISK IN S CB POTRERO GRANDE DR & 16.5M(54FT) W/O E DRWY TO EDISON PLANT MKD (S-4) 320M(1050FT) W/O GREENWOOD AVE	Y 11503
RIVERA (2005)	313.084 95.428	LS TAG #3054 IN N CB ARROYO DR 300MM(1FT) E/O BCR @ NE COR ASTRA DR	Y 11504
RIVERA (2005)	197.468 60.188	LACO BM TAG IN N CB 1M(3.3FT) E/O BCR @ NE COR WHITTIER BLVD & SAYBROOK AVE	Y 11505
RIVERA (2005)	193.933 59.111	LACO BM TAG IN N CB 1M(3.3FT) E/O BCR @ NE COR WHITTIER BLVD & FINDLAY AVE	Y 11506
RIVERA (2005)	241.799 73.701	L&TACK IN N CB 1.5M(5FT) E/O BCR @ NE COR BEVERLY BLVD & SADLER AVE	Y 11507

QUAD YEAR	ELEV FOOT/METER	DESCRIPTION	BM NUMBER
RIVERA (2005)	306.121 93.306	RDBM TAG IN N CB 1M(3.3FT) W/O BCR @ NW COR EASTERN AVE & 3RD ST	Y 11510
RIVERA (2005)	305.162 93.014	L&BN IN N CB 5M(16.5FT) W/O BCR @ NW COR 3RD ST & GAGE AVE	Y 11511
RIVERA (2005)	143.992 43.889	CAL-TRANS TAG IN ELY CB TELEGRAPH RD & 5.5M(18FT) N/O C/L PROD ATLANTIC BLVD (S SIDE RR BRIDGE)	Y 11513
RIVERA (2005)	141.957 43.269	CAL-TRANS TAG IN WLY CB TELEGRAPH RD 20.4M(67FT) W/O C/L & 33.5M(110FT) N/O C/L ATLANTIC BLVD (S SIDE RR BRIDGE)	Y 11514
RIVERA (2005)	156.166 47.600	LACO BM TAG IN N CB TELEGRAPH RD 3.4M(11FT) W/O BCR 12M(40FT) N/O C/L & 37M(122FT) W/O C/L ATLANTIC AVE (N/O RR BRIDGE)	Y 11515
RIVERA (2005)	190.600 58.095	L&T IN S CB UNION PACIFIC AVE ON C/L PROD DITMAN AVE	Y 11516
RIVERA (2005)	140.624 42.862	L&T IN S CB 8.5M(28FT) W/O BCR @ SW COR EASTERN AVE & BANDINI BLVD	Y 11517
RIVERA (2005)	147.544 44.972	CAL-TRANS TAG IN E CB EASTERN AVE & 20M(66FT) S/O C/L PROD ALLEY S/O STEVENS PL	Y 11518
RIVERA (2005)	247.912 75.564	LACO DPW TAG IN W CB 1M(3.3FT) S/O BCR @ SW COR LA VERNE AVE & 4TH ST	Y 11519
RIVERA (2005)	182.037 55.485	L&T IN E CB 7M(23FT) N/O BCR @ NE COR DOWNEY RD & FRUITLAND AVE	Y 11520
RIVERA (2005)	191.394 58.337	L&SPK IN N CB @ E END C. B. @ NE COR EMERY ST & DE LA TORRE WY	Y 11521
RIVERA (2005)	187.416 57.125	L&SPK IN W CB ESPERANZA ST 8M(26.2FT) S/O C/L PROD NOAKES ST	Y 11522
RIVERA (2005)	181.073 55.191	LACO BM TAG IN CONC LT STD BASE 8M(26FT) S/O C/L NOAKES ST & 3.5M(11.5FT) W/O C/L PROD CALZONA ST	Y 11523
RIVERA (2005)	316.600 96.500	LACO BM TAG IN S CB 1M(3.3FT) E/O BCR @ SE COR CESAR CHAVEZ AVE & RECORD AVE	Y 11524
RIVERA (2005)	268.142 81.730	LACO BM TAG IN S CB 2M(6.5FT) E/O BCR @ SE COR CESAR CHAVEZ AVE & CARMELITA AVE	Y 11525
RIVERA (2005)	316.414 96.443	LACO BM TAG IN S CB 1M(3.3FT) W/O BCR @ SW COR CESAR CHAVEZ AVE & FORD BLVD	Y 11526
RIVERA (2005)	316.193 96.376	LACO BM TAG IN E CB 700MM(2.3FT) S/O BCR @ NE COR CESAR CHAVEZ AVE (BROOKLYN) & FORD BLVD	Y 11527
RIVERA (2005)	316.168 96.368	LACO BM TAG IN N CB 1M(3.3FT) E/O BCR @ NE COR FORD BLVD & FLORAL DR	Y 11528
RIVERA (2005)	309.840 94.440	LACO BM TAG IN S CB 2M(6.5FT) E/O BCR @ SE COR FLORAL DR & DANGLER AVE	Y 11529

QUAD YEAR	ELEV FOOT/METER	DESCRIPTION	BM NUMBER
RIVERA (2005)	422.947 128.915	L&T IN N CB CITY TERRACE DR ON C/L PROD DITMAN AVE	Y 11530
RIVERA (2005)	427.125 130.188	LACO BM TAG IN E CB CITY TERRACE DR 1M(3.3FT) N/O BCR @ NE COR TOWNSEND AVE	Y 11531
RIVERA (2005)	443.511 135.183	LACO BM TAG IN E CB 1M(3.3FT) S/O BCR @ SE COR CITY TERRACE DR & MEISNER ST	Y 11532
RIVERA (2005)	418.174 127.460	L&T IN W CB CITY TERRACE DR ON C/L PROD RAMBOZ DR	Y 11533
RIVERA (2005)	402.470 122.673	CS TAG IN NLY CB CITY TERRACE DR ON C/L PROD ROWAN AVE	Y 11534
RIVERA (2005)	404.112 123.174	L&T IN S CB MEDFORD ST ON C/L PROD MARIANNA AVE (SW/O EASTERN AVE)	Y 11535
RIVERA (2005)	444.230 135.402	DPW TAG IN SLY CB EASTERN AVE @ C/L PROD TIM AVE	Y 11536
RIVERA (2005)	448.332 136.652	LACO BM TAG IN W CB 2M(6.5FT) S/O BCR @ SW COR EASTERN AVE & E BND OFF-RAMP 10 FRWY (RAMONA E) 26M(85FT) S/O & 11.5M(38FT) W/O C/L INT	Y 11537
RIVERA (2005)	435.578 132.765	CSBM MON IN TOP OF 1M(3.3FT) HIGH CONC WALL 300MM(1FT) S/O BC OF WALL @ SE COR EASTERN AVE & SHERIFF RD 19M(62FT) S/O & 12M(39FT) E/O C/L INT MKD (BM 61-2D 1975 RE 7078)	Y 11538
RIVERA (2005)	410.315 125.064	LACO BM TAG IN ELY CB 300MM(1FT) S/O BCR @ SE COR FREMONT AVE & MONTEREY PASS RD	Y 11539
RIVERA (2005)	390.386 118.990	LACO BM TAG IN S CB 12M(39FT) E/O BCR @ SE COR EMERSON AVE & GARFIELD AVE	Y 11540
RIVERA (2005)	335.841 102.365	LACO BM TAG IN S CB 1M(3.3FT) E/O BCR @ SE COR EMERSON AVE & ISABEL AVE	Y 11541
RIVERA (2005)	286.121 87.210	LACO BM TAG IN N CB 1M(3.3FT) W/O BCR @ NW COR EMERSON PLACE & FALLING LEAF AVE	Y 11542
RIVERA (2005)	291.037 88.708	FC DISK IN SW COR BRIDGE ABUT OVER ALHAMBRA WASH 8.5M(28FT) S/O C/L EMERSON PL MKD (BM 055-01515 1967)	Y 11543
RIVERA (2005)	230.968 70.399	L&LADPW BM TAG 300MM(1FT) N/O BCR @ NWLY COR SAN GABRIEL BL & PLAZA DR	Y 11800
BASELINE (2005)	216.400 65.959	L&LADPW BM TAG 300MM(1FT) E/O BCR @ SE COR SAN GABRIEL BL & LINCOLN AV	Y 11801
BASELINE (2005)	182.611 55.660	L&DPW TAG IN E CB @ BCR @ NE COR STEPHEN ST & DURFEE AV	Y 11802
BASELINE (2005)	187.768 57.232	L&T IN S CB @ BCR @ SE COR BEVERLY BL & DURFEE AV	Y 11803

QUAD YEAR	ELEV FOOT/METER	DESCRIPTION	BM NUMBER
BASLINE (2005)	179.208 54.623	L&DPW BM TAG N CB 300MM(1FT) W/O BCR @ W END C.B. @ NE COR WHITTIER BL & NORWALK BL	Y 11804
BASLINE (2005)	150.062 45.739	L&DPW TAG IN E CB NORWALK BL @ N END DR TO BLDG #10110	Y 11834
BASLINE (2005)	160.202 48.830	L&LS#2428 TAG IN N CB 900MM(3FT) W/O BCR @ NW COR NORWALK BL & WASHINGTON BL	Y 11835
BASLINE (2005)	162.131 49.418	L&DPW TAG IN E CB 300MM(1FT) N/O BCR @ SE COR NORWALK BL & CHOISSER ST	Y 11836
BASLINE (2005)	162.035 49.388	L&DPW TAG IN E CB 2.1M(7FT) S/O ECR @ NE COR NORWALK BL & CHOISSER ST	Y 11837
BASLINE (2005)	171.268 52.203	SPK @ BW ON W SIDE NORWALK BL 7.6M(25FT) N/O C/L SLY DR TO WEST WHITTIER ELEM SCHOOL 46M(150FT) S/O C/L INT NORWALK BL & LOCH LOMOND DR	Y 11838
BASLINE (2005)	146.802 44.745	L&DPW TAG IN N CB TELEGRAPH RD @ NE COR BRIDGE OVER SAN GABRIEL RIVER	Y 11839
BASLINE (2005)	147.185 44.862	L&LS#2428 TAG IN W CB 3M(10FT) N/O ECR @ SW COR TELEGRAPH RD & STAMPS RD	Y 11840
BASLINE (2005)	134.293 40.933	L&DPW TAG @ MOC @ SE COR TELEGRAPH RD & ORR & DAY RD	Y 11841
BASLINE (2005)	140.412 42.798	L&DPW TAG @ MC @ NW COR SLAUSON AV & BOXFORD AV	Y 11842
BASLINE (2005)	159.019 48.469	L&CALTRANS TAG @ MC @ SW COR SLAUSON AV & GAGE AV	Y 11843
BASLINE (2005)	149.449 45.552	L&DPW TAG @ MOC @ NE COR SLAUSON AV & KINGS AV	Y 11844
BASLINE (2005)	159.085 48.489	L&DPW TAG IN S CB @ BCR @ SE COR SLAUSON AV & GIFFORD AV	Y 11845
BASLINE (2005)	162.573 49.552	L&PLS#6034 TAG @ MOC @ NE COR SLAUSON AV & CARMELITA AV	Y 11846
BASLINE (2005)	164.605 50.172	L&DPW TAG @ MOC @ NE COR SLAUSON AV & EVERETT AV	Y 11847
BASLINE (2005)	153.900 46.909	L&DPW TAG IN S CB 300MM(1FT) W/O BCR @ SW COR SLAUSON AV & FLORA AV	Y 11848
BASLINE (2005)	168.871 51.472	CITY OF VERNON BRASS DISK @ B/W @ SW COR SLAUSON AV & MALBERG WAY (+/-25FT SELY/O PP#10794)	Y 11849
RIVERA (2005)	182.915 55.753	L&DPW TAG IN CONC BASE TO 3 PIPE BARRICADES @ NE COR NOAKES ST & INDIANA ST	Y 11850
BASLINE (2005)	180.949 55.153	CITY OF L.A. BM MON (BRASS DISK) 1.2M(3.9FT) S/O S CF 2.2M(7.2FT) E/O BCR @ SE COR SLAUSON AV & ALAMEDA ST (E BARREL) MKD (18-03593 1981)	Y 11851

QUAD YEAR	ELEV FOOT/METER	DESCRIPTION	BM NUMBER
RIVERA (2005)	284.860 86.826	L&DPW TAG IN E CB 300MM(1FT) N/O ECR @ NE COR 3RD ST & MEDNIK AV	Y 11852
RIVERA (2005)	278.468 84.877	L&DPW TAG IN N CB 300MM(1FT) E/O BCR @ NE COR 3RD ST & MEDNIK AV	Y 11853
RIVERA (2005)	276.226 84.194	L&DPW TAG IN N CB 300MM(1FT) W/O ECR @ NW COR 3RD ST & MEDNIK AV	Y 11854
RIVERA (2005)	297.151 90.572	L&DPW TAG IN N CB 300MM(1FT) W/O ECR @ NW COR 3RD ST & FORD BL	Y 11855
RIVERA (2005)	282.208 86.017	L&DPW TAG IN N CB 300MM(1FT) E/O BCR @ NE COR 3RD ST & KERN AV	Y 11857
RIVERA (2005)	305.170 93.016	L&T IN S CB EMERSON PL 300MM(1FT) E/O C.B. 3M(10FT) W/O C/L INT WILSON WY	Y 11858
RIVERA (2005)	414.304 126.280	L&DPW TAG IN E CB MONTEREY PASS RD @ TOP X DR TO BLDG #508 +/- 23M(75FT) S/O CL INT FREMONT AV	Y 11871
RIVERA (2005)	152.961 46.623	L&T NEAR MCR @ NE COR PASSIONS BL & SLAUSON AV	Y 11918
RIVERA (2005)	163.369 49.795	L&DPW TAG IN S CB WASHINGTON BL @ SW COR TO ENTRANCE TO WALMART SHOPPING CENTER & 16.8M(55FT) W/O C/L PROD CANDACE AV	Y 11919
RIVERA (2005)	163.672 49.887	L&DPW TAG IN N CB 300MM(1FT) E/O BCR @ NE COR WASHINGTON BL & CROSSWAY DR	Y 11922
RIVERA (2005)	150.796 45.963	L&T IN W CB PASSIONS BL & 10.7M(35FT) N/O C/L PROD SHADE LN ELY	Y 11923
RIVERA (2005)	170.479 51.962	L&T IN E CB 900MM(3FT) S/O BCR @ SE COR GARFIELD AV & WASHINGTON BL	Y 11924
RIVERA (2005)	164.603 50.171	L&DPW TAG IN W CB 300MM(1FT) S/O ECR @ N END OF ISLAND @ GARFIELD AV & MALT AV	Y 11925
RIVERA (2005)	164.812 50.235	L&DPW TAG IN W CB 300MM(1FT) N/O BCR @ NW COR GARFIELD AV & MALT AV	Y 11926
RIVERA (2005)	162.713 49.595	L&T IN W CB 1.5M(5FT) S/O ECR @ SW COR GARFIELD AV & YATES AV	Y 11927
RIVERA (2005)	163.321 49.780	L&DPW TAG IN W CB 300MM(1FT) N/O BCR @ S END OF ISLAND @ GARFIELD AV & YATES AV	Y 11928
RIVERA (2005)	146.950 44.790	L&T IN N CB 1.5M(5FT) E/O ECR @ NW COR GARFIELD AV & TELEGRAPH RD	Y 11929
RIVERA (2005)	148.236 45.182	L&T IN S CB 6.1M(20FT) W/O BCR @ SW COR GARFIELD AV & TELEGRAPH RD	Y 11930
RIVERA (2005)	209.449 63.840	L&DPW TAG IN W CB 300MM(1FT) N/O BCR @ NW COR POPLAR AV & HARDING AV	Y 11931

QUAD YEAR	ELEV FOOT/METER	DESCRIPTION	BM NUMBER
RIVERA (2005)	205.748 62.712	L&DPW TAG @ MCR @ SW COR BEVERLY BL & REA DR	Y 11932
RIVERA (2005)	206.359 62.898	L&DPW TAG IN S CB 300MM(1FT) E/O ECR @ SE COR BEVERLY BL & REA DR @ SW COR BRIDGE OVER PASS TO RIO HONDO RIVER	Y 11933
RIVERA (2005)	160.637 48.962	L&DPW TAG IN W CB BLUFF RD @ S EDGE TO DR @ BLDG #1707	Y 11934
RIVERA (2005)	218.974 66.743	L&BR IN W CB 300MM(1FT) N/O BCR @ NW COR WILCOX AV & MADISON AV	Y 11935
RIVERA (2005)	175.906 53.616	BRASS CAP MKD (M.F. S-17) IN W CB 300MM(1FT) S/O BCR @ NW COR WASHINGTON BL & VAIL AV	Y 11936
RIVERA (2005)	372.836 113.641	L&DPW TAG IN S CB POTERO GRANDE DR @ E SIDE OF DRWY TO EDISON BLDG #1000	Y 11937
RIVERA (2005)	152.961 46.623	L&CALTRANS TAG IN S CB 15.2M(50FT) W/O C/L PROD TELEGRAPH RD & GASPAR AV	Y 11938
RIVERA (2005)	191.491 58.367	L&DPW TAG @ MCR @ NE COR UNION PACIFIC AV & HERBERT AV	Y 11939
RIVERA (2005)	144.059 43.909	L&T IN W CB 2.4M(8FT) N/O BCR @ NW COR EASTERN AV & HARBOR ST (NEAR CTR C.B.)	Y 11940
RIVERA (2005)	139.200 42.428	L&T IN W CB EASTERN AV @ C/L PROD COMMERCE WAY	Y 11941
RIVERA (2005)	264.244 80.542	L&DPW TAG IN S CB 3M(10FT) E/O ECR @ SE COR 3RD ST & LA VERNE AV	Y 11942
RIVERA (2005)	263.481 80.309	L&T IN E CB 1.5M(5FT) N/O ECR @ NW COR LA VERNE AV & ALLEY (S/O 3RD ST)	Y 11943
RIVERA (2005)	190.191 57.970	L&DPW TAG NEAR MCR @ NE COR WHITTIER BL & BRADSHAW AV (5FT W/O BCR)	Y 11944
RIVERA (2005)	248.467 75.733	L&T IN S CB 5.2M(17FT) E/O ECR @ SE COR BEVERLY BL & GERHART AV	Y 11945
RIVERA (2005)	295.708 90.132	L&LA CITY SURVEYOR TAG IN S CB 300MM(1FT) W/O ECR @ SE COR CESAR CHAVEZ AV & CESAR CHAVEZ PL	Y 11946
RIVERA (2005)	302.976 92.347	BRASS DISK 300MM(1FT) S/O CB 1.5M(5FT) E/O BCR @ SE COR CESAR CHAVEZ AV & ROWAN AV	Y 11947
RIVERA (2005)	488.219 148.810	L&DPW TAG IN E CB 300MM(1FT) S/O BCR @ SE COR EASTERN AV & HAUCK ST	Y 11948
RIVERA (2005)	382.036 116.445	L&T IN S CB 300MM(1FT) E/O ECR @ SE COR MEDFORD ST & BONNIE BEACH PL (@ NW COR C.B.)	Y 11949
RIVERA (2005)	213.003 64.924	L&T NEAR MCR @ NE COR WHITTIER BL & DOWNEY RD	Y 11950
RIVERA (2005)	211.617 64.501	L&DPW TAG IN E CB 900MM(3FT) N/O BCR @ SE COR WHITTIER BL & DOWNEY RD	Y 11951

QUAD YEAR	ELEV FOOT/METER	DESCRIPTION	BM NUMBER
RIVERA (2005)	223.341 68.075	L&DPW TAG IN S CB @ BCR @ SW COR WHITTIER BL & GAGE AV	Y 11952
RIVERA (2005)	222.664 67.868	L&CALTRANS TAG NEAR MCR @ SE COR WHITTIER BL & GAGE AV	Y 11953
RIVERA (2005)	197.182 60.101	L&CALTRANS TAG NEAR MCR @ SW COR WHITTIER BL & EASTERN AV	Y 11954
RIVERA (2005)	192.833 58.776	L&CALTRANS TAG NEAR MCR @ SE COR WHITTIER BL & FORD BL	Y 11955
RIVERA (2005)	192.649 58.720	L&CALTRANS TAG NEAR MCR @ SW COR WHITTIER BL & FORD BL	Y 11956
RIVERA (2005)	196.000 59.741	L&T IN W CB 1.5M(5FT) S/O BCR @ SW COR WHITTIER BL & ARIZONA AV	Y 11957
RIVERA (2005)	197.119 60.082	L&T IN E CB 1.5M(5FT) N/O ECR @ NE COR WHITTIER BL & ARIZONA AV	Y 11958
RIVERA (2005)	192.642 58.717	L&DPW TAG NEAR MCR @ SE COR WHITTIER BL & ATLANTIC BL	Y 11959
RIVERA (2005)	193.781 59.065	BRASS DISK IN S CB 4.6M(15FT) W/O BCR @ SW COR WHITTIER BL & ATLANTIC BL	Y 11960
RIVERA (2005)	193.485 58.974	L&DPW TAG NEAR MCR @ SW COR WHITTIER BL & GOODRICH BL	Y 11961
RIVERA (2005)	194.467 59.274	BRASS DISK 300MM(1FT) S/O BW ON CB OF PLANTER 3M(10FT) E/O BCR @ SW COR WHITTIER BL & GOODRICH BL	Y 11962
RIVERA (2005)	191.230 58.287	L&DPW TAG IN S CB 1.5M(5FT) W/O ECR @ SE COR WHITTIER BL & GERHART AV (S)	Y 11963
RIVERA (2005)	190.872 58.178	L&DPW TAG IN S CB WHITTIER BL 19.8M(65FT) W/O C/L PROD GERHART AV (N)	Y 11964
RIVERA (2005)	409.843 124.921	L&DPW TAG NEAR MCR 300MM(1FT) N/O CB & NE COR ROWAN AV & FOLSOM ST	Y 11965
RIVERA (2005)	147.482 44.953	L&T @ MCR @ NW COR ATLANTIC BL & WASHINGTON BL	Y 11966
RIVERA (2005)	179.654 54.759	L&BN IN S CB 900MM(3FT) E/O ECR @ SE COR WASHINGTON BL & INDIANA ST	Y 11967
RIVERA (2005)	187.147 57.043	L&DPW TAG IN S CB 300MM(1FT) E/O E SIDE C.B. +/-0.3MI E/O C/L INT WASHINGTON BL & GRANDE VISTA 10.7M(35FT) W/O PP#2190VP	Y 11968
RIVERA (2005)	183.118 55.815	SQ HD SPK IN S CB NEAR W END C.B. +/-0.2MI W/O C/L INT WASHINGTON BL & INDIANA ST	Y 11969
RIVERA (2005)	173.643 52.927	L&T @ MCR @ SW COR WASHINGTON BL & PINE ST	Y 11970

QUAD YEAR	ELEV FOOT/METER	DESCRIPTION	BM NUMBER
RIVERA (2005)	173.481 52.877	L&BN @ MCR @ SE COR WASHINGTON BL & PINE ST	Y 11971
RIVERA (2005)	163.390 49.801	L&T @ MCR @ SE COR WASHINGTON BL & ARROW MILL	Y 11972
RIVERA (2005)	159.695 48.675	L&BN IN S CB 19.8M(65FT) W/O BCR @ SW COR WASHINGTON BL & AYERS AV	Y 11973
RIVERA (2005)	147.633 44.999	L&T IN E CB 3M(10FT) N/O BCR @ SE COR WASHINGTON BL & ATLANTIC BL	Y 11974
RIVERA (2005)	147.468 44.948	L&DPW TAG @ MCR @ NW COR ATLANTIC BL & SHIELA ST	Y 11975
RIVERA (2005)	151.184 46.081	L&DPW TAG IN W CB ATLANTIC BL NEAR MOC OF CURVE @ S END OF C.B. @ NW COR ATLANTIC BL & BANDINI BL	Y 11976
RIVERA (2005)	151.409 46.150	L&DPW TAG IN W CB 300MM(1FT) N/O ECR @ SW COR ATLANTIC BL & BANDINI BL	Y 11977
RIVERA (2005)	165.221 50.360	FLOOD CONTROL DISK MKD (BM 7-20) IN W CB @ S END OF BRIDGE OVER LA RIVER (FC BM 006-01450)	Y 11978
RIVERA (2005)	153.839 46.890	L&DPW TAG IN W CB 600MM(2FT) S/O ECR @ SW COR ATLANTIC BL & 55TH ST	Y 11979