

NOTICES TO CONTRACTOR

- 1. SPECIFICATIONS: ALL WORK SHALL CONFORM TO THE LATEST EDITION AND SUPPLEMENTS OF THE STANDARD SPECIFICATIONS FOR PUBLIC WORKS CONSTRUCTION ADOPTED BY THE BOARD OF PUBLIC WORKS OF THE CITY OF LOS ANGELES AS MODIFIED BY THE CORRESPONDING ISSUE OF LATEST "BROWN BOOK".
2. PLAN REFERENCES: THIS IMPROVEMENT CONSISTS OF WORK CALLED FOR ONLY ON THIS PLAN.
3. STANDARD PLANS FOR THIS PROJECT (CITY OF LOS ANGELES STANDARD PLANS) TYPES OF CURB AND GUTTER S-410-2 CURB RAMPS S-442-3 SYMBOLS FOR CONSTRUCTION NOTES S-627-0 ADVANCE CONSTRUCTION NOTICE SIGN S-791-1
(STANDARD PLANS FOR PUBLIC WORKS CONSTRUCTION 2009 STANDARDS) CURB AND GUTTER SPPWC 120-2 MEDIAN TAPER SPPWC 140-3
(STATE OF CALIFORNIA DEPARTMENT OF TRANSPORTATION STANDARD PLANS) CURB RAMP DETAILS A88A CURB RAMP AND ISLAND PASSAGEWAY DETAILS A88B
4. INSPECTION: ALL WORK AND MATERIALS ARE SUBJECT TO INSPECTION PURSUANT TO LATEST EDITION OF THE STANDARD SPECIFICATIONS. CALL (213) 485-5080 BEFORE NOON OF THE WORKING DAY BEFORE THE INSPECTION IS REQUIRED. ALL PUBLIC WORKS IMPROVEMENTS WITHIN CITY R/W AS INDICATED ON SHEET3 SHALL BE INSPECTED BY CITY INSPECTOR.
5. REMOVALS: A. REMOVE ALL EXISTING IMPROVEMENTS THAT INTERFERE WITH THE CONSTRUCTION OF THIS PROJECT. B. ALL UTILITIES SHALL BE REMOVED OR RELOCATED BY OTHERS.
6. POTHOLE: THE CONTRACTOR IN CONFORMANCE TO LOS ANGELES CITY ORDINANCE 150.478, SHALL POTHOLE EXISTING SUBSURFACE INSTALLATION CARRYING UNSTABLE SUBSTANCES OR OTHER SUBSURFACE INSTALLATIONS AS INDICATED ON THESE PLANS AND DETERMINE THEIR LOCATIONS AND ELEVATIONS PRIOR TO COMMENCING EXCAVATION.
7. CURB AND GUTTERS: A. REPAIR AND/OR REPLACE ANY EXISTING BROKEN OR OFF GRADE CONCRETE CURB, GUTTER, SIDEWALK, OR STREET PAVEMENT IMMEDIATELY ADJACENT TO OR WITHIN THE AREA OF THIS IMPROVEMENT TO THE SATISFACTION OF THE CITY ENGINEER. B. CONSTRUCTION STAKES FOR CURB AND LONGITUDINAL GUTTER, WITH GRADE LESS THAN 0.5 % SHALL BE SET AT 12.5 FEET ON CENTER.
8. UTILITY TRENCHING: IN ADDITION TO THE CONSTRUCTION OF PAVEMENT SHOWN HEREON, WORK REQUIRED UNDER THIS PLAN SHALL ALSO INCLUDE THE CONSTRUCTION OF PERMANENT TRENCH RESURFACING IN ALL AREAS WHERE UTILITY LINES HAVE BEEN INSTALLED TO SERVE THIS DEVELOPMENT. CONDITIONS OF TRENCH BACKFILL AND RESURFACING SHALL BE AS SPECIFIED ON THE EXCAVATION PERMIT. PAVING AND ROADWAY AREAS SHALL BE WITHHELD UNTIL CONTEMPLATED UTILITY CHANGES OR INSTALLATIONS HAVE BEEN MADE UNDER CITY PERMIT.
9. NOTICE TO ADJACENT PROPERTY OWNER: THE CONTRACTOR SHALL GIVE REASONABLE NOTICE TO ADJACENT PROPERTY OWNERS OR OCCUPANTS OF THIS IMPROVEMENT FRONTING THEIR PROPERTY PER SECTION 7-9 OF THE STANDARD SPECIFICATION.
10. ADVANCE CONSTRUCTION NOTICE SIGNS: IN ADDITION TO SIGNS REQUIRED BY THE PROVISIONS OF THE "WORK AREA TRAFFIC CONTROL HANDBOOK", LATEST EDITION, SIGNS FOR GIVING ADVANCE NOTICE TO MOTORISTS OF TRAFFIC DISRUPTION, MUST BE FURNISHED AND PLACED AS A PART OF THIS PROJECT IN ACCORDANCE WITH STANDARD PLAN S-791-1
11. UNDERGROUND SERVICE ALERT: BEFORE COMMENCING ANY EXCAVATION, THE CONTRACTOR SHALL OBTAIN AN UNDER GROUND SERVICE ALERT INQUIRY I.D. NUMBER BY CALLING 1-(800)-422-4133. THIS I.D. NUMBER MUST BE REPORTED TO THE BUREAU OF CONTRACT ADMINISTRATION WHEN CALLING FOR INSPECTION AT (213) 485-5080. THIS IDENTIFICATION NUMBER IS VALID FOR TEN (10) DAYS ONLY. PRIOR TO START OF EXCAVATION WORK, CONTRACTOR SHALL NOTIFY UTILITY OWNERS WITHIN TWO WORKING DAYS SOON AFTER OBTAINING I.D. NUMBER.
12. SURVEY MONUMENT: SURVEY MONUMENT PRESERVATION IS REQUIRED AND SHALL INCLUDE SUBMITTAL OF PRE AND POST-CONSTRUCTION SURVEY MONUMENT TIES TO BOTH HORIZONTAL AND VERTICAL CONTROL TO THE CITY OF LOS ANGELES, SURVEY DIVISION, AS REQUIRED BY SECTIONS 2-9.1 AND 2-9.3 OF THE DEPARTMENT OF PUBLIC WORKS ADDITIONS AND AMENDMENTS TO THE LATEST EDITION OF THE SPECIFICATIONS FOR PUBLIC WORKS CONSTRUCTION.
13. SURVEY BENCH MARKS: A. BM#18-12051, ELEV 126.081, YEAR NAVD 1988, 2000 ADJ. DESCRIPTION: L.A. CO BM N&TAG W CURB SAN PEDRO ST; 1FT S/O BCR S/O IMPERIAL HWY B. BM# 18-07330, ELEV 198.111, YEAR NAVD 1988, 2000 ADJ DESCRIPTION: CUT SPK IN CONC BASE FOR FORMER ELECTROLIER; NEAR CTR OR TRIANGULAR TRAFFIC ISLAND; 9FT E OF E CURB LINE PRODUCED; OF VERMONT AVE; 30 FT N OF N CURB LINE PRODUCED OF IMPERIAL HWY
14. SPECIAL NOTE: THE CONTRACTOR SHALL HAVE GRADE SHEETS AND DESIGN CHANGES APPROVED BY THE PRIVATE ENGINEER OF RECORD
15. CONTRACTOR SHALL ADHERE TO THE REQUIREMENTS OF STANDARD PLAN S-601-1 (BOXES AND/OR COVERS FOR VAULTS, PULLBOXES, MANHOLES, TREETWELLS AND SIMILAR INSTALLATIONS). WHEN THE CONTRACTOR SELECT PRODUCT/COMPANY ITEMS THAT ARE NOT INCLUDED IN THE "STANDARD PLAN S-601 PRODUCTS" LISTS, (HTTP://ENG.LACITY.ORG/TECHDOCS/PRODUCT_MATERIAL/PRODUCT_MATERIALS.HTM), SHALL THEN CONTACT DESIGN STANDARDS AND INVESTIGATION GROUP (DSIG) OF BUREAU OF ENGINEERING 213-485-5310 (OR 5311) FOR PRE-APPROVAL OF PRODUCTS, PRIOR TO CONTACTING CONTRACT ADMINISTRATION FOR AN INSPECTION.

- 16. UPON RECEIVING A STATEMENT OF COMPLETION FORM FROM THE PUBLIC WORKS INSPECTOR (OR WHEN THE CONSTRUCTION IS NEARING A FINAL INSPECTION), THE CONTRACTOR SHALL: A) NOTIFY THE PRIVATE ENGINEER OF THE RECORD TO PREPARE AND SUBMIT "AS-BUILT" PLANS TO B-PERMIT OFFICE. B) PROVIDE COPIES OF ICA CHANGE ORDER FORMS SIGNED BY ALL OFFICES TO THE PRIVATE ENGINEER OF RECORD. ('UNLESS OTHERWISE INDICATED, THE PRIVATE ENGINEER OF RECORD IS RESPONSIBLE FOR PREPARING "AS-BUILT" PLANS IN COORDINATION WITH THE CONTRACTOR. AS-BUILT PLANS CAN BE PREPARED BY DOWNLOADING THE CITY'S FULL SIZED INDEXED PLANS ONTO BOND PAPERS. B-PERMIT INDEXED PLANS ARE AVAILABLE FROM THE CITY'S WEBSITE: HTTP://ENGVault.LACITY.ORG/APPS/VAULT/INDEX.HTM). AS-BUILT PLANS WITH ASSOCIATED ICA FORMS SIGNED BY ALL OFFICES SHALL BE SENT TO THE CENTRAL DISTRICT AS-BUILT GROUP (201 N. FIGUEROA ST., ROOM 770, TEL:213-482-7480, 482-7474). FOR CENTRAL DISTRICT B-PERMIT OFFICE, AN ELECTRONIC AS-BUILT PLAN SUBMITTAL IS REQUIRED (THE PRIVATE ENGINEER OF THE RECORD SHALL CONTACT THE CENTRAL DISTRICT AS-BUILT GROUP STAFF EITHER BY EMAIL (GEORGE.AVANESIAN@LACITY.ORG OR DANIEL.SUE@LACITY.ORG) OR BY PHONES (213-482-7480, 7474, 7485). INSTRUCTION SHEETS ON HOW TO SUBMIT ELECTRONIC AS-BUILT PLANS AS WELL AS SAMPLE AS-BUILT PLANS ARE AVAILABLE UPON REQUEST.
17. PEAK HOUR TRAFFIC RESTRICTIONS ON CITY STREETS: ALL TRAFFIC LANES IN MAJOR, SECONDARY AND COLLECTOR DESIGNATED STREETS SHALL BE UNOBSTRUCTED FROM 6 AM TO 9 AM AND 3:30 PM TO 7 PM.
18. TRAFFIC LANE REQUIREMENTS VERMONT AVENUE: ALL TRAFFIC LANES (INCLUDING THROUGH, TURNING AND PARKING LANES) SHALL BE UNOBSTRUCTED FROM 3:30 PM TO 9 AM OF THE NEXT DAY. ONE LANE IN EACH DIRECTION MAY BE CLOSED AT ALL OTHER TIMES. WORK HOURS SHALL BE 9:00 AM TO 3:30 PM MONDAY TO FRIDAY AND 8:00 AM TO 5:00 PM ON SATURDAY.
19. DETOUR/WTCP PLAN REQUIRED THE WORK SHALL BE PERFORMED IN ACCORDANCE WITH THE MANUAL ON UNIFORM TRAFFIC CONTROL DEVICES (MUTCD, 2009 ED OR LATEST) AND THE CALIFORNIA MUTCD 2012 ED. TRAFFIC LANE CLOSURES FOR THIS PROJECT REQUIRES WORKSITE SIGNING AND STRIPING PLANS (WORKSITE TRAFFIC CONTROL PLANS (WTCP)). THE WTCP SHALL BE SUBMITTED IN FINAL DRAFT FORM AT LEAST TEN (10) DAYS PRIOR TO THE START OF CONSTRUCTION. CONTACT THE SOUTHERN DISTRICT OFFICE, LADOT AT (310) 732-4599 TO ARRANGE FOR PLAN REVIEW. ANY DEVIATION FROM THE APPROVED WTCP FOR BF002479 SHALL BE SUBMITTED IN WRITING AND RECEIVE APPROVAL FROM THE SOUTHERN DISTRICT OFFICE, LADOT PRIOR TO IMPLEMENTATION. THE CONTRACTOR SHALL NOTIFY LADOT'S SPECIAL TRAFFIC CONTROL DIVISION AT (213) 485-2298, FOUR (4) WORK DAYS PRIOR TO THE START OF CONSTRUCTION FOR THE POSTING OF TEMPORARY "TOW AWAY NO STOPPING" SIGNS.
20. TRAFFIC CONTROL DEVICES MAINTENANCE THE B-PERMITTEE SHALL PAY FOR THE RESTORATION OF ALL OBLITERATED STRIPING AND PAVEMENT MARKINGS AND FOR THE REINSTALLATION OF ALL MISSING, DAMAGED AND NECESSARY TRAFFIC CONTROL DEVICES (I.E. SIGNS, CURB MARKINGS, SPEED HUMPS, STAMPED CROSSWALKS, PARKING METER, ETC.). WHEN NECESSARY, ADDITIONAL RELATED TRAFFIC CONTROL DEVICES, INCLUDING, BUT NOT LIMITED TO, DETOUR/CONSTRUCTION WORKSITE TRAFFIC CONTROL DEVICES, SHALL BE INSTALLED IN SUPPORT OF THE PROJECT-A WORKSITE TRAFFIC CONTROL PLAN (WTCP) IS REQUIRED FOR APPROVAL BY LADOT PRIOR TO STARTING CONSTRUCTION. THE CONTRACTOR WILLBE REQUIRED TO PHYSICALLY INSTALL SOME OR ALL THE TRAFFIC CONTROL DEVICES TO THE SATISFACTION OF LADOT. THE ENTIRE COST THEREOF SHALL BE BORNE BY THE CONTRACTOR. ALL STRIPING AND PAVEMENT MARKINGS SHALL BE INSTALLED UTILIZING THERMOPLASTIC MATERIALS PER LADOT SPECIFICATIONS. THE CONTRACTOR SHALL CONTACT LADOT'S CITYWIDE INVESTIGATIONS AT (213) 928-9612 PRIOR TO COMMENCING ANY WORK THAT REQUIRES TRAFFIC CONTROL DEVICES' MAINTENANCE.
FOR TRAFFIC RELATED QUESTIONS DURING CONSTRUCTION, PLEASE CONTACT LADOT'S SOUTHERN DISTRICT OFFICE, AT (310) 732-4599.

INDEX TO SHEETS Table with columns: SHT NO, PLANS OF, FROM, TO. Rows include Title Sheet, Subtitle Sheet, Vermont Ave Plan and Profile, Traffic Signal, Street Lighting, Signing and Striping, Traffic Control.

CONSTRUCTION SYMBOLS

- CONSTRUCT, EXISTING, REMOVE, REMODEL EXIST., REMOVE & CONST., WORK BY OTHERS
1 - CONCRETE CURB, SPPWC TYPE A1-8
1A - CONCRETE CURB, TYPE A*
2 - CONCRETE CURB & GUTTER, SPPWC TYPE A2-8
2A - CONCRETE CURB & GUTTER, TYPE C*
8 - CONCRETE PAVEMENT
12 - CONCRETE WALK, T = 4'
13 - CURB RAMP, SPPWC 111-4, CASE PER PLAN
13A - CURB RAMP, CASE C*
14 - ASPHALT CONCRETE PAVEMENT, T = 6"
16 - BASE MATERIAL, CMB T = 18" OR 6"
17 - ADJUST MANHOLE TO GRADE
20 - REMOVE EXISTING TREE
23 - GRADE ONLY
46 - RELOCATE WATER METER
48 - STREET LIGHT
49 - GUY WIRE
* DENOTES CITY OF LOS ANGELES STD PLANS

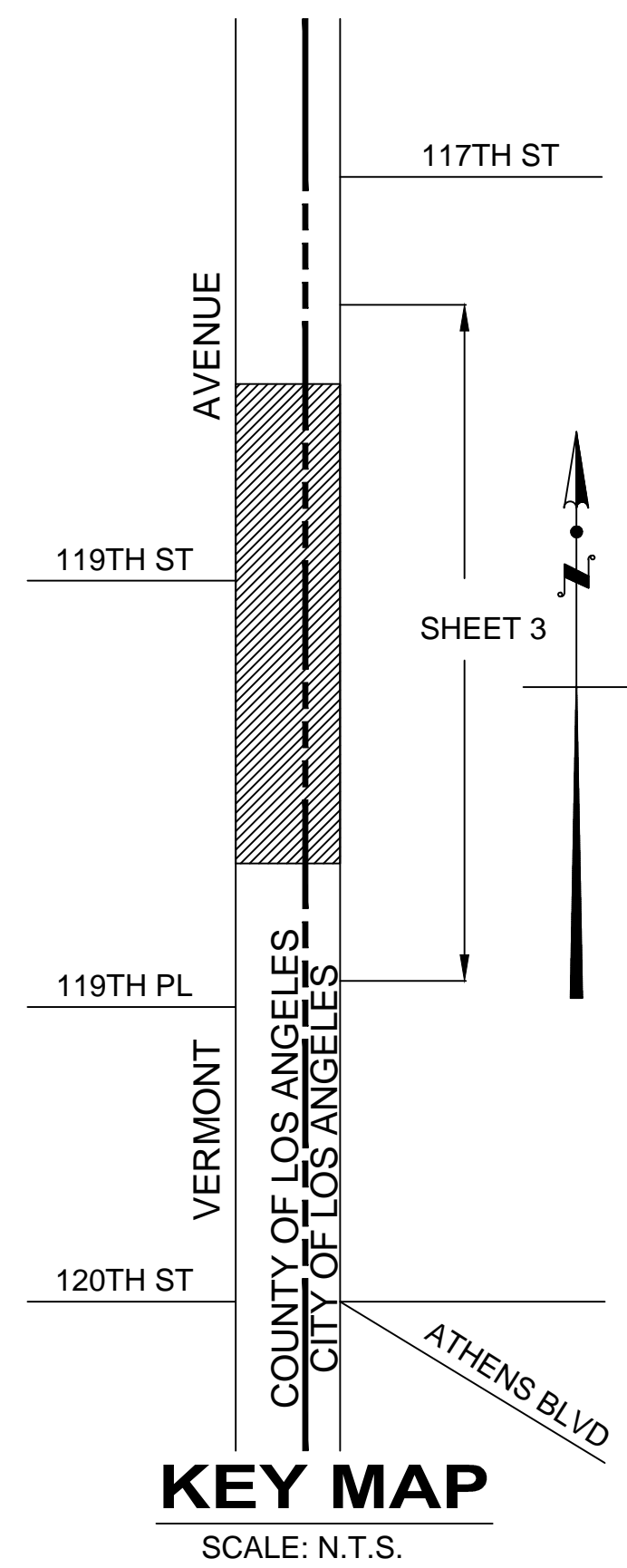

PH085045

Table with columns: BASIS, DESCRIPTION, BASIS, DESCRIPTION. Lists various construction items like concrete curb, gutter, pavement, etc.

County of Los Angeles Approved for Construction. Includes signatures and dates for City Engineer Gary Lee Moore, P.E. and District Engineer.

Professional Engineer Seal for Kenneth C. Taylor, No. 56185, State of California.

WILDAN Engineering logo and contact information. Includes project title: Vermont Ave @ 119th St Pedestrian and Traffic Improvements.

Vertical sidebar containing: BUREAU OF ENGINEERING logo, revision table, approval signatures, project title, drawing number (SHEET 1 OF 6 SHEETS), and drawing title (AS-BUILT RECORD DRAWING).

Vertical text on the left margin: THE CITY OF LOS ANGELES OR ITS OFFICERS OR AGEN'S SHALL NOT BE RESPONSIBLE FOR THE ACCURACY OR COMPLETENESS OF ELECTRONIC COPIES OF THIS PLAN SHEET.