

March 4, 2011

TO: Nicholas Agbobu
Engineering, Budget, and Office Operations

FROM: Robert Swartz
Field Operations



**CONSOLIDATED SEWER MAINTENANCE DISTRICT
CONDITION ASSESSMENT PROGRAM REPORT
PROJECT Y0TV0809B**

This memo is to inform you that as part of the Sewer Condition Assessment Program, the County of Los Angeles Department of Public Works Consolidated Sewer Maintenance District has completed the closed-circuit television (CCTV) inspection of 5,167 feet or approximately 0.3 percent of the sewer system within Unincorporated County maintained by the District's Central Yard.

The attached report outlines the structural and maintenance ratings of our system based on the Pipeline Assessment and Certification Program's rating methodology. Included in the report are the following:

- Condition Assessment Report
- Project Overview Map (Enclosure 1)
- Quick Maintenance Rating Report Priority List and Quick Maintenance Rating Map (Enclosure 2)
- Quick Structural Rating Report Priority List and Quick Structural Rating Map (Enclosure 3)
- Infrastructure Inspection Reports for Grades 4 and 5 (Enclosure 4)
- CCTV Sewer Inspection Project Schedule (Enclosure 5)

The Condition Assessment Report will provide details regarding the maintenance and structural condition of our sewer mainlines. This information can be included in our agency's Sewer System Management Plan as a reference in Chapter 8.0 System Evaluation and Capacity Assurance Plan. The segments with critical maintenance issues have been cleaned and, in some instances, have been incorporated into our routine cleaning schedule for continued monitoring. In addition, the segments with severe structural defects have either been repaired or will be scheduled for repair as part of the ongoing Accumulative Capital Outlay Project.

EL:

S:\2_CCTV PROJECT FOLDERS\Y0TV0809 Projects\Y0TV0809B\9-Final_Reports_by_JUR\ZLAC\Memo_0809B_ZLAC.doc

Attach.

bc: RS, FV, File (Y0TV0809B)

**CONDITION ASSESSMENT REPORT
COUNTY OF LOS ANGELES DEPARTMENT OF PUBLIC WORKS
CONSOLIDATED SEWER MAINTENANCE DISTRICT**

PROJECT NAME:	Y0TV0809B	PROJECT MGR:	Kari Eskridge
PROJECT DATE:	01/12/2009	CONTACT NO:	(626) 300-3390
SUP. DISTRICT(s):	4	MAP PAGE(S):	2029
Report By:	Eric Liu	Report Date:	02/22/2011

INTRODUCTION

As part of the Sewer Condition Assessment Program, the County of Los Angeles Department of Public Works Consolidated Sewer Maintenance District has completed the closed-circuit television (CCTV) inspection of 5,167 feet or approximately 0.3 percent of the Unincorporated Los Angeles County sewer system maintained by the District's Central Yard.

The Sewer Condition Assessment Program utilizes the Pipeline Assessment and Certification Program (PACP) Quick Rating methodology to rank the structural and maintenance condition of your system based on industry standards.

PROJECT AREA AND DESCRIPTION

Project Y0TV0809B included sewer lines located in the Unincorporated County of Los Angeles area and in the Cities of Artesia, Bell Gardens, Bellflower, Commerce, Lakewood and Paramount. Enclosed for your reference is an overview map of the project area within the unincorporated County area (Enclosure 1).

DEFECT GRADE DESCRIPTION

The Quick Rating indicates the number of occurrences for the highest severity grade for each pipe segment for either maintenance or structural defects. A grade of 1 indicates that a pipe segment is in excellent condition with minor defects, while a grade of 5 indicates that a pipe segment may require immediate attention. A detailed breakdown of the five possible defect grades is as follows:

Grade	Description	Estimate time to Failure
1:	EXCELLENT: Minor Defects.	Unlikely in the foreseeable future
2:	GOOD: Defects that have not begun to deteriorate.	20 years or more
3:	FAIR: Moderate defects that will continue to deteriorate.	10 to 20 years
4:	POOR: Severe defects that will become grade 5 defects within the foreseeable future.	5 to 10 years
5:	IMMEDIATE ATTENTION: Defects requiring immediate attention.	Has failed or will likely fail within the next 5 years

MAINTENANCE REPORT

Our inspection revealed that approximately 96.7 percent of the system televised was free of blockages or restrictions that would impede sewer flows. However, the remaining 3.3 percent of the inspected pipe segments within the Unincorporated County of Los Angeles area had a PACP maintenance grade of 4 as indicated in the Quick Maintenance Rating Table shown below.

The segment had deficiencies discovered inside the lateral connections to the mainline. The District does not maintain lateral lines; it is the responsibility of the property owner to maintain their respective lateral lines to facilitate the flow of wastewater from their property to the mainline. A letter had been sent to the lateral owner notifying them of the maintenance issues discovered in their lateral. A sample lateral notice letter is provided in Enclosure 2 for your reference. The corrective action taken is noted on the Quick Maintenance Rating Report Priority List (Enclosure 2).

In addition, a color-coded map showing the quick maintenance rating for each pipe segment is provided in Enclosure 2.

QUICK MAINTENANCE RATING TABLE

DEFECT GRADE	PIPE LENGTH (FT)	PERCENT TOTAL INSPECTED PIPE LENGTH	NO. SEGMENTS
1: Excellent	0.0	0.0	0
2: Good	4,996	96.7	20
3: Fair	0.0	0.0	0
4: Poor	171	3.3	1
5: Immediate Attention	0.0	0.0	0
TOTAL	5,167	100.0	21

High Water Levels

Our inspection revealed that high water level was not detected in any pipe segment in the unincorporated County area.

Infiltration

Our inspection revealed that infiltration was not detected in any pipe segment in the unincorporated County area.

STRUCTURAL REPORT

Our inspection revealed that approximately 94.1 percent of the inspected pipe segments within the Unincorporated County of Los Angeles were free of severe structural defects. However, the remaining 5.9 percent of the inspected pipe segments had a PACP structural grade of 4 as indicated in the Quick Structural Rating Table shown below. The segment required a point repair to address the fractures in the pipe. The point repair was performed by District maintenance crews under force account on 02/20/2010.

A color-coded map showing the Quick Structural Rating for each pipe segment is located in Enclosure 3. A copy of the actual inspection report for this segment is included in Enclosure 4.

QUICK STRUCTURAL RATING TABLE

DEFECT GRADE	PIPE LENGTH (FT)	PERCENT TOTAL INSPECTED PIPE LENGTH	NO. SEGMENTS
1: Excellent	3,891	75.3	15
2: Good	464	9.0	3
3: Fair	508	9.8	2
4: Poor	304	5.9	1
5: Immediate Attention	0	0.0	0
TOTAL	5,167	100.0	21

FUTURE PROJECTS

The Sewer Condition Assessment Program will be performing future closed-circuit television (CCTV) inspection of the remaining sewer lines within the Unincorporated County of Los Angeles maintained by the Central Yard. For your reference, the CCTV Sewer Inspection project schedule is listed in Enclosure 5.

ENCLOSURE 1:

Project Overview Map

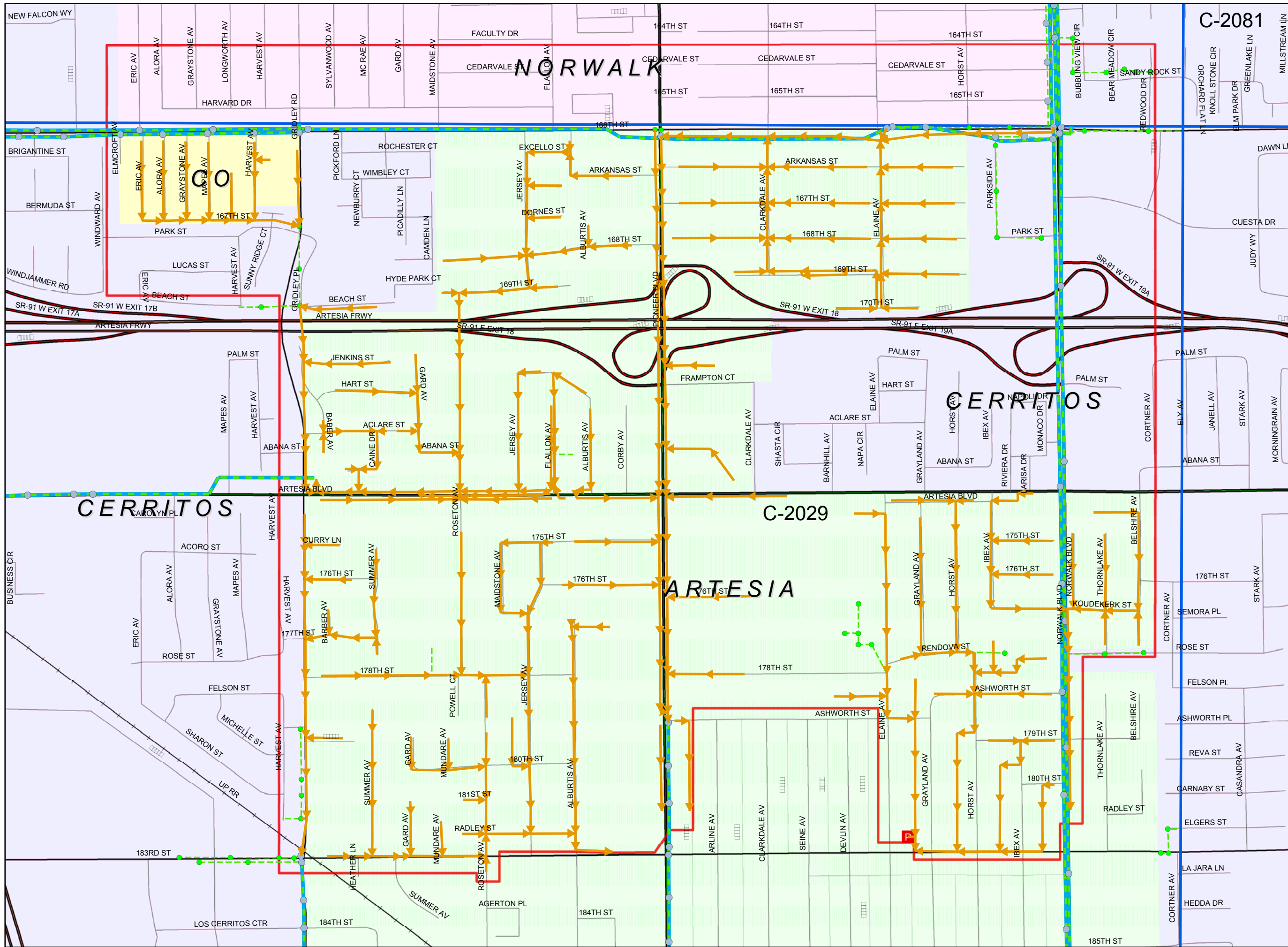

OVERVIEW MAP

CCTV PROJECT
Y0TV0809B
 COUNTY
 UNINCORPORATED

Cities of
 Artesia, Bell Gardens,
 Bellflower, Commerce,
 Lakewood, Paramount &
 County Unincorporated

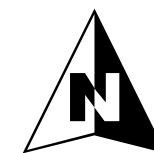

Legend

SMD Sanitary Sewers



SMD Manholes

- ⊙ Other
- Standard
- ▲ DROP
- ◻ Shallow
- ◇ Trap
- ⊗ Siphon

SMD Pump Stations

SMD Treatment Plants

Maintained by Others:

- Trunk Sewerlines
- - - Non SMD Sanitary Sewers
- Non SMD Maintained MH
- ▭ SMD Operations Maps
- ▭ Y0TV0809B

This map is intended only for internal operations of the Los Angeles County Sewer Maintenance Districts. Los Angeles County expressly disclaims any liability for any inaccuracies which may be present in this map. Data contained in this map is produced in whole or part from the Thomas Bros. Maps digital database. This map is copyrighted, and reproduced with permission granted, by Thomas Bros. Maps. All rights reserved.

FEBRUARY 2011

ENCLOSURE 2:

- Quick Maintenance Rating Report
Priority List
- Quick Maintenance Rating Map
- Sample Lateral Notice Letter

ENCLOSURE 2
QUICK MAINTENANCE RATING REPORT PRIORITY LIST
COUNTY UNINCORPORATED (Y0TV0809B)

as of 01/12/2009

ITEM NO.	QMR	START MH	END MH	STREET	OBSERVATION	CORRECTIVE ACTION TAKEN
1	4121	2029-0004	2029-0009	167TH ST	Root ball lateral: 128'	Letter to home owner: 3/4/10

ENCLOSURE 2

CCTV PROJECT
Y0TV0809B
 COUNTY
 UNINCORPORATED

QUICK
 MAINTENANCE
 RATING
 (QMR)

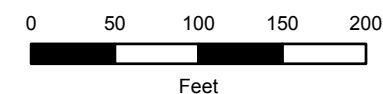

Legend

SMD Sanitary Sewers

- QMR**
- 2: GOOD
 - 4: POOR

SMD Manholes

- Other
- Manhole Type**
- Standard
- DROP
- Shallow
- Trap
- Siphon
- SMD Pump Stations
- SMD Treatment Plants

Maintained by Others:

- Trunk Sewerlines
- - - Non SMD Sanitary Sewers
- Non SMD Maintained MH
- SMD Operations Maps
- Y0TV0809B

This map is intended only for internal operations of the Los Angeles County Sewer Maintenance Districts. Los Angeles County expressly disclaims any liability for any inaccuracies which may be present in this map. Data contained in this map is produced in whole or part from the Thomas Bros. Maps digital database. This map is copyrighted, and reproduced with permission granted, by Thomas Bros. Maps. All rights reserved.

FEBRUARY 2011

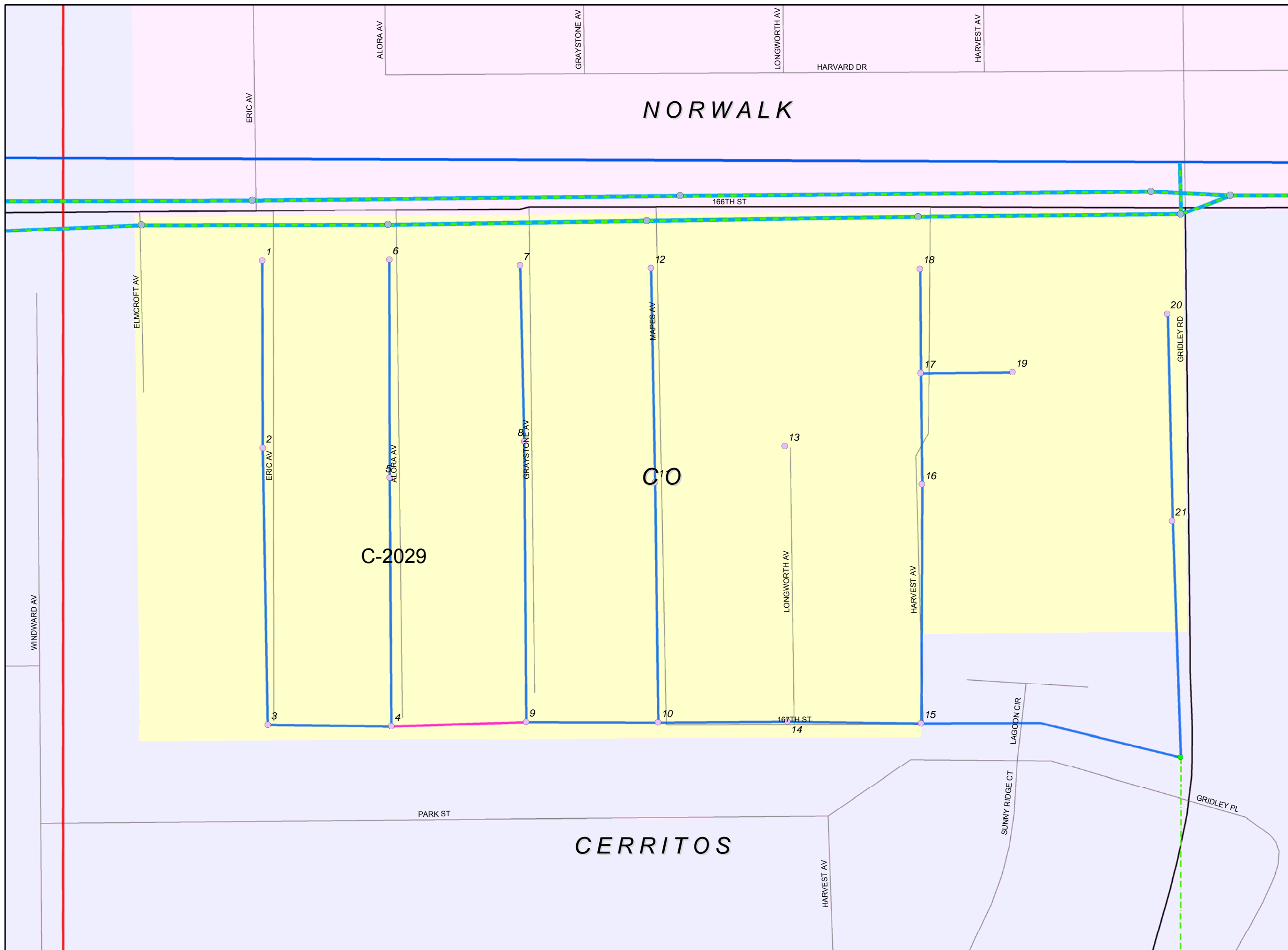



GAIL FARBER, Director

COUNTY OF LOS ANGELES

DEPARTMENT OF PUBLIC WORKS

"To Enrich Lives Through Effective and Caring Service"

900 SOUTH FREMONT AVENUE
ALHAMBRA, CALIFORNIA 91803-1331
Telephone: (626) 458-5100
<http://dpw.lacounty.gov>

ADDRESS ALL CORRESPONDENCE TO:
P.O. BOX 1460
ALHAMBRA, CALIFORNIA 91802-1460

August 19, 2010

Current Property Owner
3476 Marengo Ave
Altadena, CA 91001

Dear Property Owner:

SEWER LATERAL ROOT INTRUSION 3476 MARENGO AVE, ALTADENA, CALIFORNIA 91001

As the agency responsible for the maintenance of the sanitary sewer system in your area, the County of Los Angeles Consolidated Sewer Maintenance District (District) is providing you with this letter informing you that the sewer lateral serving the property located at 3476 Marengo Ave, Altadena, California 91001, requires maintenance and is in violation of **County Code 20.24.080 Maintenance of Sewer Laterals**, which states:

☐ All house laterals, industrial connection sewers, septic tank outlet connections to STEP system, and appurtenances thereto existing as of January 23, 1953, or thereafter constructed, shall be maintained by the owner of the property served in a safe and sanitary condition, and all devices or safeguards which are required by this Division 2 for the operation thereof shall be maintained in good working order.☐

Using closed-circuit television (CCTV) camera technology, the District recently televised the sanitary sewer mainline and discovered the presence of roots in your sewer lateral connection. The intrusion of the roots from your lateral may block the flow of sewage in the mainline sewer causing a sanitary sewer overflow upstream of your property.

Since the CCTV inspection, the sewer mainline has been cleaned and blockages from root growth have been removed; however, the root blockage in your sewer lateral is still present. As the property owner, you are responsible for the entire length of the sewer lateral, which includes the portion that extends beyond the property line into the public right of way. We request that you contact a qualified plumbing contractor to service

IN REPLY PLEASE

REFER TO FILE:

SM-1

Current Property Owner
August 19, 2010
Page 2

your sewer lateral within 90 days to remove roots and any other obstructions that may cause a sewage backup. Failure to do so may result in future overflows and subject you to civil prosecution, reimbursement costs, and fines up to \$1,000. Reference 20.24.160 Violation - Penalty; 20.24.170 Continued violations; 20.32.690 Reimbursement for repairs and maintenance following violations.

Prior to your plumbing contractor servicing your lateral, please notify the District's sewer maintenance yard in your area at (626) 446-5227 to arrange for authorization to access the downstream manhole.

During your lateral service, your plumbing contractor must protect the District's sewer mainlines from dislodged roots and other debris by utilizing catcher baskets at the manhole downstream from your lateral connection.

After your lateral has been serviced, please notify the District office, Mr. Fernando Villaluna, Sewer Maintenance Division, at (626) 300-3380 or fvillalun@dpw.lacounty.gov.

For your reference, we have enclosed photos of your lateral connection showing the presence of the root blockage. Also enclosed are some literature on ways of minimizing sewer overflows and damage to your home.

Thank you for helping the Department of Public Works keep the public's sewers clean and in good working order.

Very truly yours,

GAIL FARBER
Director of Public Works

JOHN T. WALKER
Assistant Deputy Director
Sewer Maintenance Division

PK:

Enc.

bc: JW, KL, RS, FV, RH, File (Lateral Notice), SPINDLE

3476 MARENGO AVE
ALTADENA
Roots at Lateral Connection



Minimizing Sewer Overflows and Damage to Your Home

The sewer system within the County of Los Angeles Consolidated Sewer Maintenance District (District) is comprised of a series of underground pipes. Many are publicly owned; however, the sewer laterals are entirely owned by the private property owner they serve. The laterals extend from the building to the mainline within the street (or within an easement at the rear of your home). The laterals are typically four inches in diameter while the District's mainline is typically at least eight inches in diameter. The private property owner is responsible for the entire length of the lateral, which includes that portion that may be located within the public right of way (under the asphalt and street landscaping).

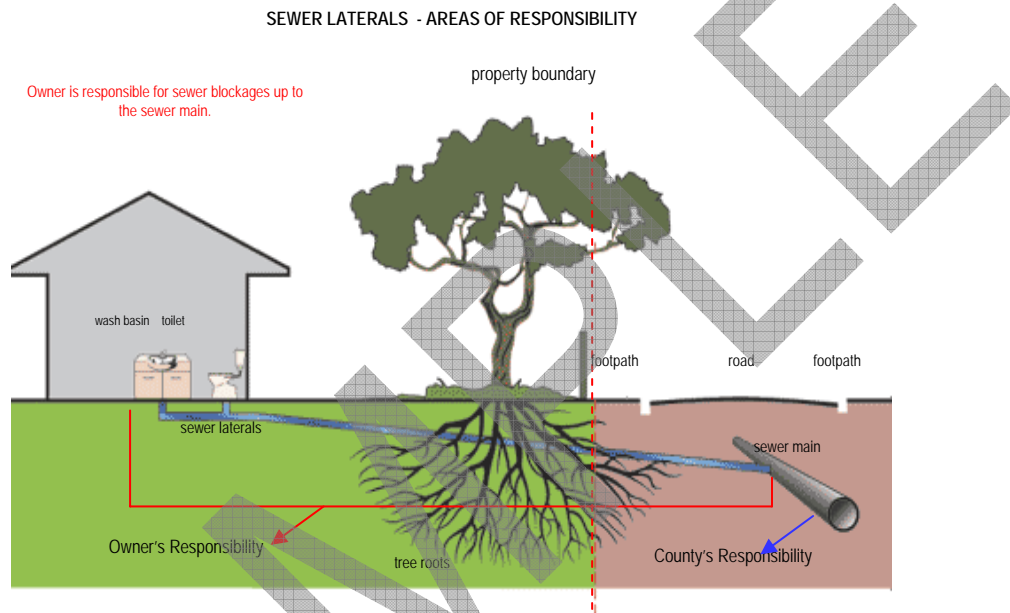

Sewer backups can cause tremendous damage to the interior of a home. In order to minimize these, the District provides continual maintenance services for the public sewer mainlines.

Unfortunately, sewer laterals are often not maintained by private property owners until a disaster strikes. Out of sight, out of mind is a typical approach to sewer lateral maintenance and operation by many. It is our hope that we can provide you various means of addressing these issues and thus minimize your risk of an overflow entering your home.

The three methods we suggest are:

1. Maintain your lateral through proper cleaning, repair, and replacement
2. Do not place improper items into the sewer or make improper connections to the sewer
 - a. Keep rainwater out of the sewer lines as it overwhelms the capacity of the sewer lines and may cause sewer spills.
 - b. Do not pour fats, oils, and grease in your drains as these products harden and stick to the inside of the sewer pipes, which build up and may eventually cause a blockage in the sewer pipe.
3. Install a backflow preventer and cleanout in your sewer lateral.

ENCLOSURE 3:

- Quick Structural Rating Report
Priority List
- Quick Structural Rating Map

ENCLOSURE 3
QUICK STRUCTURAL RATING REPORT PRIORITY LIST
UNINCORPORATED LOS ANGELES COUNTY (Y0TV0809B)
as of 01.12.2009

Item No.	QSR	Start MH	End MH	Street	Observation: Location	Proposed Corrective Method	Length of Repair (FT)
1	4131	2029-0010	2029-0011	MAPES AV	Fractures: 187'-192'	Point Repair: CSMD (completed 02.10.2010)	

ENCLOSURE 3

CCTV PROJECT
Y0TV0809B
 COUNTY
 UNINCORPORATED

QUICK
 STRUCTURAL
 RATING
 (QSR)

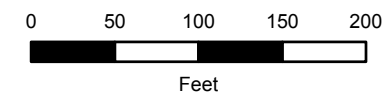

Legend

SMD Sanitary Sewers

QSR

- 1: EXCELLENT (Green line)
- 2: GOOD (Blue line)
- 3: FAIR (Orange line)
- 4: POOR (Pink line)

SMD Manholes

- Other (Circle with cross symbol)

Manhole Type

- Standard (Purple circle)
- DROP (Purple triangle)
- Shallow (Purple square)
- Trap (Purple diamond)
- Siphon (Purple circle with cross)
- SMD Pump Stations (Red square with 'P')
- SMD Treatment Plants (Red square with 'WTP')

Maintained by Others:

- Trunk Sewerlines (Thick blue line)
- Non SMD Sanitary Sewers (Dashed green line)
- Non SMD Maintained MH (Green dot)
- SMD Operations Maps (Blue outline)
- Y0TV0809B (Red outline)

This map is intended only for internal operations of the Los Angeles County Sewer Maintenance Districts. Los Angeles County expressly disclaims any liability for any inaccuracies which may be present in this map. Data contained in this map is produced in whole or part from the Thomas Bros. Maps digital database. This map is copyrighted, and reproduced with permission granted, by Thomas Bros. Maps. All rights reserved.

FEBRUARY 2011

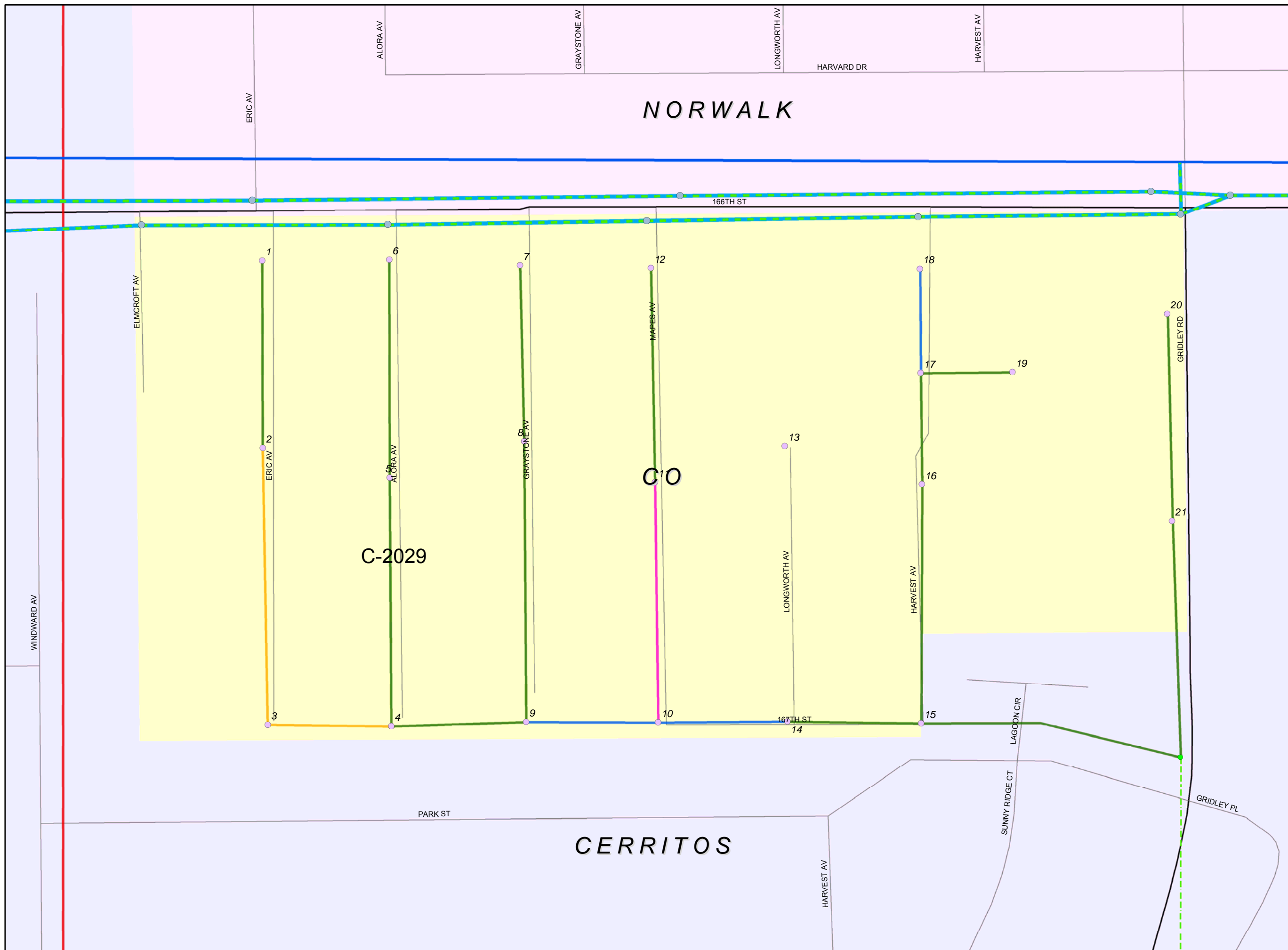

ENCLOSURE 4:

Infrastructure Inspection Reports
for Grades 4 and 5



Inspection report

Date: 20081003	P.O. # Y0TV0809B	Weather: 1 Dry	Surveyed By: B.FUGATE	section number: 1142	PSR: 766806
Total Pipe Length: 304	Survey Customer: LACDPW	System Owner: ZLAC	Clean Date: 10.03.2008	Pre-Cleaned: J Jetting	Map Grid # 2029

Street: MAPES AV	Flow Control: N Not Controlled	Start MH: 2029-0010
City: ZLAC	Year Renewed	End MH: 2029-0011
Location Code: C Light Highway	Tape Media #	pipe length: 285.5 ft

Reason for inspection: F Routine Assessment	Dia: Height: C Circular 8 8
Use of Sewer: SS Sanitary	Material: VCP Pipe Length: 304
Drain. Area: 0010 2029-0011 2029	Lining Method:
	Category:

Remark: **MH'S REVERSED ON MAP**

1:700	position	observation	MPEG	photo	grade
	0.00	Upstream Manhole, Survey Begins 2029-0011		75	
	0.00	Water Level, 5 % of cross sectional area			
	0.00	Water Mark, 5 % of cross sectional area			M 2
	32.60	Tap Factory Made Active, at 03 o'clock, 6", within 8 inch: YES	00:02:05	76	
	45.50	Tap Factory Made Active, at 09 o'clock, 6", within 8 inch: YES	00:02:36	77	
	68.35	Tap Factory Made Active, at 03 o'clock, 6", within 8 inch: YES	00:03:26	78	
	96.35	Tap Factory Made Active, at 09 o'clock, 6", within 8 inch: YES	00:04:28	79	
	115.15	Tap Factory Made Active, at 03 o'clock, 6", within 8 inch: YES	00:05:12	80	
	137.80	Tap Factory Made Active, at 09 o'clock, 6", within 8 inch: YES	00:06:08	81	
	160.60	Tap Factory Made Capped, at 03 o'clock, 6", within 8 inch: YES	00:07:03	82	
	163.05	Tap Factory Made Active, at 09 o'clock, 6", within 8 inch: YES	00:07:17	83	
	185.80	Tap Factory Made Active, at 03 o'clock, 6", within 8 inch: YES	00:08:04	84	
	187.35	Fracture Longitudinal, at 12 o'clock, within 8 inch: YES	00:08:24	85, b	S 3
	189.00	Fracture Multiple, from 07 to 03 o'clock, within 8 inch: YES	00:09:06	87, b	S 4
	229.25	Tap Factory Made Active, at 09 o'clock, 6", within 8 inch: YES	00:10:49	89	
231.95	Tap Factory Made Active, at 03 o'clock, 6", within 8 inch: YES	00:11:12	90		
285.50	Downstream Manhole, Survey Ends 2029-0010	00:13:08	91		

QSR	QMR	SPR	MPR	OPR	SPRI	MPRI	OPRI
4131	2100	7	2	9	3.5	2	3

ENCLOSURE 5:

CCTV Sewer Inspection Project Schedule

FUTURE PROJECTS

The Sewer Condition Assessment Program will be performing future closed-circuit television (CCTV) inspection of the remaining sewer lines within Unincorporated Central Yard according to the following schedule.

FISCAL YEAR	PROJECT NAME	LENGTH (FT)	PERCENTAGE OF SYSTEM	STATUS
2005-2006	Y0TV0506A	34,270	2.0	COMPLETE
2006-2007	Y0TV0607C	9,475	0.6	COMPLETE
2007-2008	Y0TV0708B	253,085	14.7	COMPLETE
2008-2009	Y0TV0809B	5,167	0.3	COMPLETE
2009-2010	Y0TV0910B	227,776	13.2	COMPLETE
2010-2011	Y0TV1011B	288,072	16.7	IN PROGRESS
2011-2012	Y0TV1112A	643,658	37.4	SCHEDULED
2012-2013	Y0TV1213D	16,239	0.9	SCHEDULED
2014-2015		183,013	10.6	FUTURE
2014-2015		61,341	3.6	FUTURE
TOTAL		1,722,096	100.0	