

**COUNTY OF LOS ANGELES**  
**ROAD DEPARTMENT**

**PRECISE**  
**BENCH MARK LIST**



**ARCADIA QUAD**

**1975 ADJUSTMENT**

## P R E F A C E

The Road Department level net is composed of more than 2,000 miles of levels supporting in excess of 12,000 bench marks. In 1975, a major readjustment of the net was undertaken. To emphasize the complete break with previous elevations, the BY,BG & BL series bench marks have been relabeled CY,CG & CL, respectively.

To facilitate the adjustment, indexing, and distribution of adjusted values of the net, the County territory is divided into 34 quads or areas. For identification purposes each quad is given a name, viz., "Rosemead," "La Mirada," "Santa Fe," etc. When bench marks and elevations in the Road Department net are used, the name of the quad in which the bench mark is located and the date of the adjustment of the elevation must be included in the bench mark description, e.g.,

CG 6234 --L&BN IN CONC HDWL OF DRAIN PIPE UNDER DR 218 FT  
NE&18 FT SE C/L INT GRAND AVE & CAMERON AVE MKD (BM)  
(COVINA -1975) ELEV. 696.238

Experience indicates that this general adjustment will, for the most part, remain sound for the next 10 years. Updating constrained adjustments will be made in 5 years. It is expected that these updating adjustments will be in the nature of a few hundredths of a foot. When a quad is readjustment, new elevation lists will be published and the date of the readjustment will replace the "1975" at the end of the bench mark description. Two bench marks with different adjustment dates will not normally agree with each other.

The basic accuracy of the net is reflected by an indicated field probable error of plus or minus 0.012 foot per mile of leveling as determined from over 600 conditions of closure. However, many years experience in vertical control in the greater Los Angeles basin and Antelope Valley indicate that because of varying degrees of subsidence and heaving, the true datum is recovered only by obtaining substantial agreement of a number of bench marks.

The users of this net are invited to assist in its maintenance by notifying this Department of cases of obliteration, apparent mistakes in descriptions or elevations, and proven disturbance of bench marks.

---

DATUM: U. S. Coast and Geodetic Survey Sea Level Datum  
of 1929, through the medium of the Los Angeles  
County Engineer Precise Level Net.

ABBREVIATIONS USED IN BENCH MARK LISTINGS

ABUT - - - - -	Abutment	EC - - - - -	End of Curve
ALG - - - - -	Along	ENT - - - - -	Entrance
ANG PT - - - - -	Angle Point	FL - - - - -	Floor
B/W - - - - -	Back of Walk	FTG - - - - -	Footing
BCR - - - - -	Beginning of Curb Return	FRWY - - - - -	Freeway
BC - - - - -	Beginning of Curve	F/W - - - - -	Front of Walk
BLDG - - - - -	Building	GAR - - - - -	Garage
EM - - - - -	Bench Mark	HDWL - - - - -	Headwall
BT SPK - - - - -	Boat or Bolt Spike	HSE - - - - -	House
BR CAP - - - - -	Brass or Bronze Cap	HWY - - - - -	Highway
C B - - - - -	Catch Basin	INT - - - - -	Intersection
CTR - - - - -	Center	IP - - - - -	Iron Pipe
C/L - - - - -	Center Line	LT - - - - -	Left
C/L INT - - - - -	Center Line Intersection	LACE - - - - -	L. A. City Engineer
C/L PROD - - - - -	Center Line Produced	LACS - - - - -	L. A. Co. Engineer
CONC - - - - -	Concrete	LAFC - - - - -	L. A. Co. Flood Control
COR - - - - -	Corner	L&BN - - - - -	Lead and Bench Nail
COE - - - - -	Corps of Engineers	L&BR - - - - -	Lead and Brad
CULV - - - - -	Culvert	L&N - - - - -	Lead and Nail
CYN - - - - -	Canyon	L&SPK - - - - -	Lead and Spike
CB - - - - -	Curb	L&T - - - - -	Lead and Tack
CS MON - - - - -	Co. Engineer Monument	MCR - - - - -	Middle of Curb Return
CT SPK - - - - -	Cut Spike	MKD - - - - -	Marked
DR - - - - -	Drive or Driveway	MC - - - - -	Middle of Curve
E/O - - - - -	East of	MON - - - - -	Monument
ECR - - - - -	End of Curb Return	N/O - - - - -	North of

ABBREVIATIONS USED IN BENCH MARK LISTINGS . . . CONTINUED

NR - - - - - Near  
OPP - - - - - Opposite  
PI - - - - - Point of Intersection  
PK&W - - - - - PK Nail and Washer  
P/L - - - - - Property Line  
POST - - - - - Point on Semi-Tangent  
PP - - - - - Power Pole  
PVMT - - - - - Pavement  
PROD - - - - - Produced  
RD - - - - - Road  
RDEM - - - - - Road Dept. Bench Mark  
RDEM TAG - - - - - Road Dept. Bench Mark Tag  
RR - - - - - Railroad  
RT - - - - - Right  
R/W - - - - - Right of Way  
SDMH - - - - - Storm Drain Manhole  
SMH - - - - - Sewer Manhole  
SPK - - - - - Spike  
ST&W - - - - - Spike Tin and Washer  
S/O - - - - - South of  
TP - - - - - Telephone Pole  
USC&GS - - - - - U. S. Coast and Geodetic Survey  
USGS - - - - - U. S. Geological Survey  
WK - - - - - Walk  
W/O - - - - - West of

# ARCADIA QUAD

2-10-78

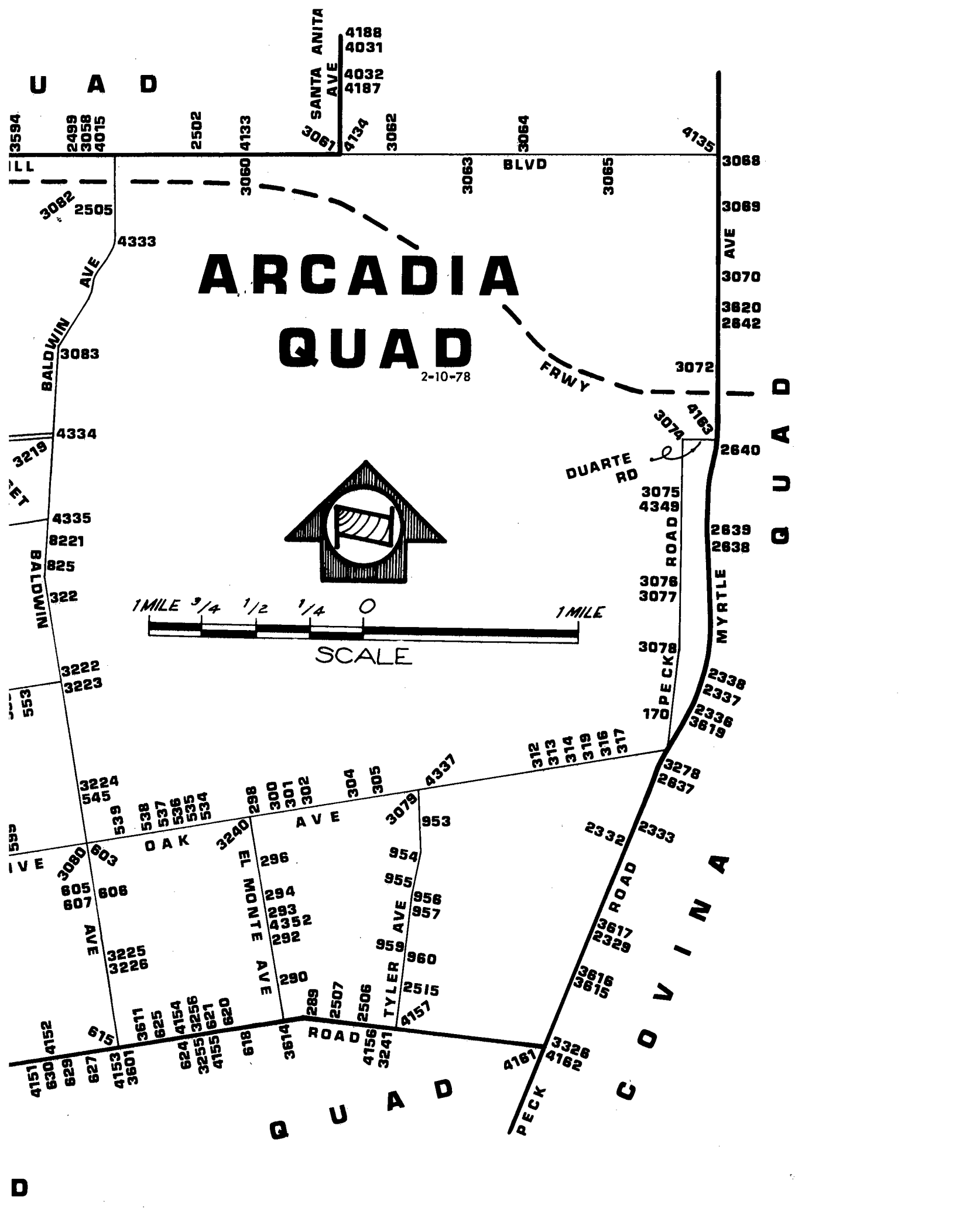
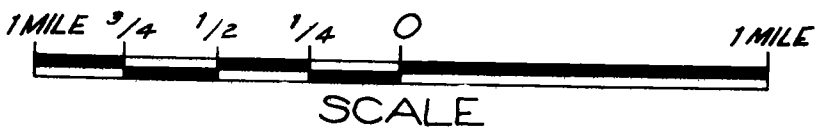
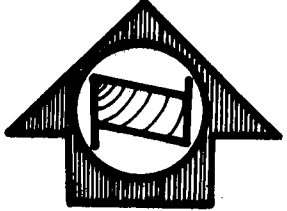

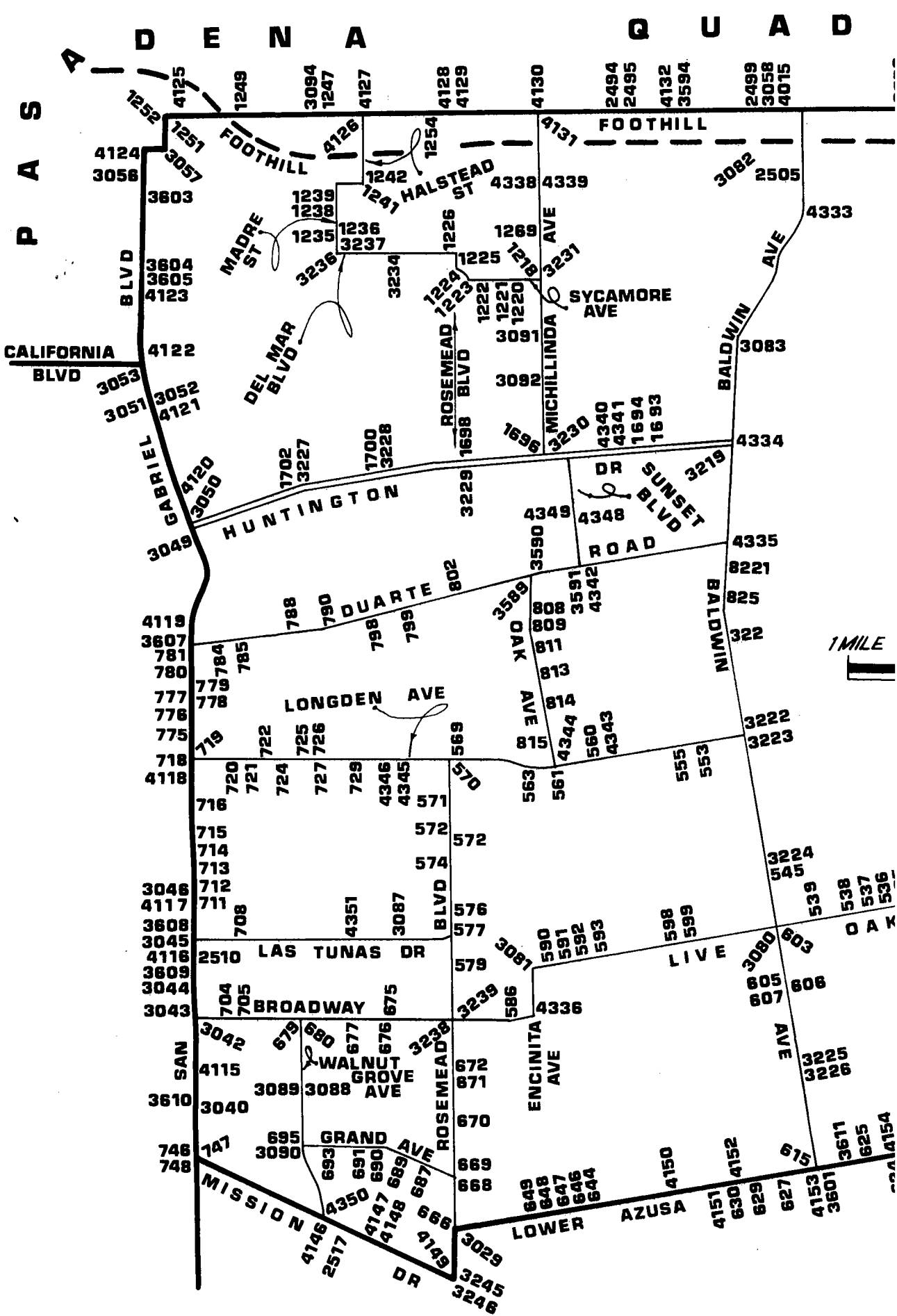

P A S A D E N A

Q U A D

CALIFORNIA BLVD

R O S E M E A D



1252 4125 1249 3094 1247 4127 4128 4129 4130 2494 2495 4132 3594 2499 3058 4015

FOOTHILL

4124 3056 3603 1251 3057 1226 1254 4131 3082 2505 4333

BLVD

1239 1238 1242 4338 4339

MADRE ST

1235 1236 1226 1269

DEL MAR BLVD

3236 3237 3234 1225 1218 3231

ROSEMEAD

1224 1223 1222 1221 1220 3091 3092 1698 1696 3230

SYCAMORE AVE

3230 4340 4341 1694 1693

BALDWIN AVE

3083 4334

HUNTINGTON

1702 3227 1700 3228 3229 1698 1696 3230

DR SUNSET BLVD

3219 4334

DUARTE

788 790 798 799 802 3589 3590 4349 4348

OAK AVE

811 813 814 4344 560 4343

BALDWIN

8221 825 322 4335

LONGDEN AVE

719 722 725 726 569 815 814 4344 560 4343

BLVD

570 571 572 572 574 576 577 579

716 720 721 724 727 729 4346 4345 571 572 574 576 577 579

715 714 713 712 711 708 4351 3087

2510 LAS TUNAS DR

3046 4117 3608 3045 4116 3609 3044 3043

BROADWAY

704 705 3042 679 680 677 676 675 3239 586 590 591 592 593 598 599 3080 603 605 607 606

WALNUT GROVE AVE

672 671 670 669 668 4336

ENCINITA AVE

590 591 592 593 598 599 3080 603 605 607 606

GRAND AVE

695 693 691 690 689 687 668 669 668 649 648 647 646 644 4150 4151 630 4152 629 627 615 4153 3601 3611 625 6154

MISSION

748 748 147 3090 695 693 691 690 689 687 668 669 668 649 648 647 646 644 4150 4151 630 4152 629 627 615 4153 3601 3611 625 6154

LOWER AZUSA

4151 630 4152 629 627 615 4153 3601 3611 625 6154

QUAD-YEAR	ELEV	DESCRIPTION (INCLUDE QUAD AND YEAR IN DESCRIPTION)	BM NUMBER
ARCADIA (1975)	358.930	L&T 1FT E OF END OF CB @ SE COR PECK RD & LONGDEN AVE 90FT E & 38FT S C/L INT	CG 170
ARCADIA (1975)	309.703	BT SPK E CB EL MONTE AVE 18FT N CONC DR TO HSE NO 4850 28FT E C/L 500FT N LOWER AZUSA RD MKD (TE 466)	CG 290
ARCADIA (1975)	323.167	BT SPK E CB EL MONTE AVE 475FT S FREER ST MKD (TE 462)	CG 292
ARCADIA (1975)	326.813	BT SPK W CB 10FT S BCR @ SW COR FREER ST & EL MONTE AVE MKD (TE 461)	CG 293
ARCADIA (1975)	332.599	BT SPK E CB EL MONTE AVE 28FT E C/L & 28FT S C/L PROD OLIVE ST MKD (TE 459)	CG 294
ARCADIA (1975)	341.066	BT SPK W CB EL MONTE AVE 7FT S C/L PROD DANBURY ST MKD (TE 553)	CG 296
ARCADIA (1975)	350.872	BT SPK S CB 8FT E BCR @ SE COR LIVE OAK AVE & EL MONTE AVE MKD (TE 517)	CG 298
ARCADIA (1975)	351.197	PK IN S CB 5FT E BCR @ SE COR PERSIMMON AVE & OAK AVE 58FT E & 38FT N/D C/L INT	CG 300
ARCADIA (1975)	351.927	BT SPK 6FT W BCR @ SW COR MC CULLOCH AVE & LIVE OAK AVE MKD (TE 520)	CG 301
ARCADIA (1975)	352.295	BT SPK 8FT W BCR @ SW COR WELLAND AVE & LIVE OAK AVE MKD (TE 522)	CG 302
ARCADIA (1975)	348.801	BT SPK S CB LIVE OAK AVE 20FT W C/L PROD LOUISE AVE MKD (TE 526)	CG 304
ARCADIA (1975)	348.057	BT SPK 4FT W BCR @ SW COR MYRTUS AVE & LIVE OAK AVE MKD (TE 527)	CG 305
ARCADIA (1975)	346.962	L&T 4FT W BCR @ SW COR CENTER AVE & LIVE OAK AVE	CG 312
ARCADIA (1975)	347.404	L&BN 5FT E BCR @ SW COR NINTH AVE & LIVE OAK AVE	CG 313
ARCADIA (1975)	347.880	PK N CB SERVICE RD LIVE OAK AVE C/L PROD 10TH AVE & 105FT W C/L HODGES AVE	CG 314
ARCADIA (1975)	347.761	L&T 1FT E BCR SERVICE RD @ SE COR EISENHOWER AVE & LIVE OAK AVE	CG 315
ARCADIA (1975)	349.568	L&T S CB LIVE OAK AVE 1FT W ISLAND BCR @ SW COR MAYFLOWER AVE 38FT S & 35FT W C/L INT	CG 316

QUAD-YEAR	ELEV	DESCRIPTION (INCLUDE QUAD AND YEAR IN DESCRIPTION)	BM NUMBER
ARCADIA (1975)	352.019	L&T 1FT W BCR @ SW COR LYND AVE & LIVE OAK AVE	CG 317
ARCADIA (1975)	356.212	L&PK W CB 6FT N BCR @ NW COR LONGLEY WAY & LIVE OAK AVE MKD (TE 513)	CG 534
ARCADIA (1975)	359.960	L&PK E CB 5FT N BCR @ NE COR WARREN WAY & LIVE OAK AVE MKD (TE 512)	CG 535
ARCADIA (1975)	362.408	L&PK W CB 6FT N BCR @ NW COR CAROLINE WAY & LIVE OAK AVE MKD (TE 510)	CG 536
ARCADIA (1975)	363.689	L&SPK E CB 9FT N BCR @ NE COR HOLLY AVE & LIVE OAK AVE MKD (TE 508)	CG 537
ARCADIA (1975)	366.579	PK W CB 5FT N BCR @ NW COR WINTHROP AVE & LIVE OAK AVE MKD (TE 507)	CG 538
ARCADIA (1975)	369.752	PK W CB 5FT N BCR @ NW COR BRADFORD AVE & LIVE OAK AVE MKD (TE 506)	CG 539
ARCADIA (1975)	387.981	L&BN S CB LAS TUNAS DR 15FT E BCR @ SE COR BALDWIN AVE 84FT E & 57FT S/O C/L INT	CG 545
ARCADIA (1975)	430.606	L&T CONC DR TO HSE NO 9846 1FT E OF W EDGE & 8FT S/O N EDGE 34FT S/O C/L LONGDEN AVE 18FT W/O C/L AGNES AVE PROD	CG 553
ARCADIA (1975)	433.463	L&T CONC WALK TO HSE NO 6303 62FT W/O C/L GOLDEN WEST AVE 30FT N/O C/L LONGDEN AVE	CG 555
ARCADIA (1975)	442.791	L&BN N CB OF LONGDEN AVE 18FT N C/L 15FT E OF DR TO GIRL SCOUTS BLDG NO 9509 & 300FT W PRIMROSE AVE	CG 560
ARCADIA (1975)	447.259	L&SPK S CB 10FT E BCR @ SE COR OAK AVE & LONGDEN AVE MKD (TE 118)	CG 561
ARCADIA (1975)	449.180	L & SPK W CB ENCINITA AVE 18FT W & 131FT S/O C/L INT LONGDEN AVE FRONT OF HSE NO 6261 MKD (TE119)	CG 563
ARCADIA (1975)	461.790	L&BN E CB 1FT N BCR @ NE COR ROSEMEAD BLVD & LONGDEN AVE	CG 569
ARCADIA (1975)	460.001	L&SPK E CB 5FT S BCR @ SE COR ROSEMEAD BLVD & LONGDEN AVE MKD (TE 142)	CG 570
ARCADIA (1975)	449.781	L&BN W CB ROSEMEAD AVE 2FT N OF DR TO HSE NO 6165 800FT S LONGDEN AVE	CG 571
ARCADIA (1975)	438.392	L&BN N CB 3FT W BCR @ NW COR ROSEMEAD BLVD & GARIBALDI AVE	CG 572



QUAD-YEAR	ELEV	DESCRIPTION (INCLUDE QUAD AND YEAR IN DESCRIPTION)	BM NUMBER
ARCADIA (1975)	436.931	BT SPK IN E CB 6FT S BCR @ SE COR ROSEMEAD BLVD & GARIBALDI AVE MKD (TE 139)	CG 573
ARCADIA (1975)	427.738	L&BN IN W CB ROSEMEAD BLVD 1FT N OF CONC DR TO HSE NO 5947 MIDWAY BET GARIBALDI AV & HERMOSA DR	CG 574
ARCADIA (1975)	412.629	L&SPK E CB 6FT S BCR @ SE COR ROSEMEAD BLVD & ELM AVE MKD (TE 136)	CG 576
ARCADIA (1975)	408.875	L&SPK E CB 29FT N BCR @ NE COR ROSEMEAD BLVD & LAS TUNAS DR MKD (TE 135)	CG 577
ARCADIA (1975)	405.338	BT SPK E CB ROSEMEAD BLVD 22FT S/O C/L 1ST ALLEY S/O LAS TUNAS DR 122FT S/O BCR @ LAS TUNAS DR MKD (TE 785)	CG 579
ARCADIA (1975)	386.630	L&SPK IN E CB RIO HONDO AVE 20FT N/O BCR 18FT E & 50FT N/O C/L INT LIVE OAK AVE	CG 590
ARCADIA (1975)	387.109	L&SPK W CB 62FT N & 18FT W/O C/L INT ALESSANDRO AVE & LIVE OAK AVE MKD (TE 25)	CG 591
ARCADIA (1975)	386.123	L&SPK W CB OAK AVE 15FT N/O BCR 18FT W & 43FT N/ C/L INT LIVE OAK AVE MKD (TE-26)	CG 592
ARCADIA (1975)	384.370	L&SPK W CB CLOVERLY AVE 10FT N/O BCR 43FT N & 18 FT W/O C/L INT LIVE OAK AVE MKD (T27)	CG 593
ARCADIA (1975)	381.050	L&BN E CB CAMELLIA AVE 38FT N/O BCR 18FT E & 80 FT N/O C/L INT LIVE OAK AVE	CG 598
ARCADIA (1975)	380.072	L&SPK W CB KAUFFMAN AVE 22FT N/O BCR 18FT W & 64 FT N/O C/L INT LIVE OAK AVE MKD (TE 32)	CG 599
ARCADIA (1975)	369.279	L&T W CB 1FT S BCR @ SW COR BALDWIN AVE & DUFFY ST 48FT S & 40FT W/O C/L INT	CG 603
ARCADIA (1975)	361.374	L&T W CB 1FT S BCR @ SW COR BALDWIN AVE & BROADWAY 45FT S & 40FT W/O C/L INT	CG 605
ARCADIA (1975)	357.475	CS BR CAP MON IN WELL C/L INT BALDWIN AVE & DAINES DR TO WEST	CG 606
ARCADIA (1975)	357.765	L&T W CB 1FT S BCR @ SW COR BALDWIN AVE & DAINES DR TO WEST 40FT W & 40FT S/O C/L INT	CG 607
BASELINE (1975)	310.212	L&SPK E CB 7FT N/O BCR @ NE COR LOWER AZUSA RD & BIRCHLAND PL 60FT N & 15FT E C/L INT MKD (TE 477)	CG 625

QUAD-YEAR	ELEV	DESCRIPTION (INCLUDE QUAD AND YEAR IN DESCRIPTION)	BM NUMBER
BASELINE (1975)	330.770	USC & GS BR CAP MON IN W CONC CHANNEL WALL @ SW COR OF LOWER AZUSA RD BRIDGE NO B 1053 OVER EATON CYN WASH 34FT S C/L LOWER AZUSA RD & 200FT W C/L RIO HONDO AVE MKD (S 1142 1961)	CG 644
BASELINE (1975)	327.815	L&BN (NO HEAD) S CB 38FT S C/L LOWER AZUSA RD & 37FT W INT SPRR & 437FT E INT ENCINITA AVE	CG 646
BASELINE (1975)	324.142	L&SPK N CB 8FT E/O BCR @ NE COR LOWER AZUSA RD & ENCINITA AVE 50FT E & 28FT N C/L INT MKD (WM 254)	CG 647
BASELINE (1975)	323.771	L&T N CB 1FT W BCR @ NW COR LOWER AZUSA RD & ENCINITA AVE 35FT W & 28FT N C/L INT	CG 648
BASELINE (1975)	322.167	LACS BR CAP MON IN WELL @ C/L INT LOWER AZUSA RD & ENCINITA AVE MKD (RE 329)	CG 649
BASELINE (1975)	336.486	L&T W CB 40FT W C/L ROSEMEAD BLVD & 50FT S C/L PROD LOWER AZUSA RD	CG 666
ARCADIA (1975)	348.250	L&SPK W CB 6FT S BCR @ SW COR ROSEMEAD BLVD W SERVICE RD & GRAND AVE MKD (WM 3)	CG 668
ARCADIA (1975)	353.050	L&BN 1FT UP IN S WALL @ W END SPRR BRIDGE OVER ROSEMEAD BLVD 70FT N C/L GRAND AVE	CG 669
ARCADIA (1975)	362.456	L & T W CB OF W SERVICE RD 80FT W C/L ROSEMEAD BLVD ON C/L PENTLAND ST	CG 670
ARCADIA (1975)	373.664	L&SPK E CB 10FT N BCR @ NE COR SERENO DR & ROSEMEAD BLVD (TE 776)	CG 671
ARCADIA (1975)	382.784	FC DISC IN CONC WK NE COR BRIDGE NO 53-329 OVER EATON WASH 4FT S BCR @ SE COR ROSEMEAD BLVD & OLIVE ST	CG 672
ARCADIA (1975)	395.183	L&T W CB 5FT N/O END 40FT N & 20FT W/O C/L INT BROADWAY & MUSCATEL AVE TO THE N	CG 675
ARCADIA (1975)	395.447	L&T W CB 18FT W & 77FT S/O C/L INT BROADWAY & MUSCATEL AVE TO THE S	CG 676
ARCADIA (1975)	399.538	L&T S CB 1FT E BCR @ SE COR BROADWAY & N LA PRESA AVE 59FT E & 20FT S/O C/L INT	CG 677
ARCADIA (1975)	399.585	L&T S EDGE CONC WK 5FT FROM END 30FT S C/L BROADWAY 35FT W C/L WALNUT GROVE AVE	CG 679
ARCADIA (1975)	398.509	L&T N EDGE CONC DR @ SW COR BROADWAY & WALNUT GROVE AVE 133FT S & 33FT W/O C/L INT	CG 680

QUAD-YEAR	ELEV	DESCRIPTION (INCLUDE QUAD AND YEAR IN DESCRIPTION)	BM NUMBER
ARCADIA (1975)	351.384	SPK NEAR S EDGE CONC WALK TO HSE NO 4756 38FT E C/L IVAR AVE & 100FT S C/L GRAND AVE (MKD WM 297)	CG 687
ARCADIA (1975)	361.395	CS MON IN WELL @ P I OF GRAND AVE 6FT E/O CS MON @ C/L MUSCATEL AVE	CG 689
ARCADIA (1975)	361.530	CS MON IN WELL @ C/L INT GRAND AVE & MUSCATEL AVE 6FT W/O CS MON @ P I GRAND AVE	CG 690
ARCADIA (1975)	367.598	L&T S CB 1FT W BCR @ SW COR GRAND AVE & BARTLETT AVE	CG 691
ARCADIA (1975)	371.254	L&T S CB 1FT E BCR @ SE COR GRAND AVE & HALKETT AVE	CG 693
ARCADIA (1975)	372.097	SPK N CB GRAND AVE 4FT E C/L PROD WILLARD AVE 5FT W OF END OF CB 197FT W/O C/L WALNUT GROVE AVE MKD ( W M 401)	CG 695
ARCADIA (1975)	398.400	L&T W CB 3FT N BCR @ NW COR CHARLOTTE AVE & BROADWAY 33FT N & 20FT W/O C/L INT	CG 704
ARCADIA (1975)	398.350	L&T E CB 3FT N/O BCR @ NE COR BROADWAY & CHARLOTTE AVE 33FT N & 20FT E/O C/L INT	CG 705
ARCADIA (1975)	416.787	L&SPK N CB 22FT E BCR @ NE COR LAS TUNAS DR & CHARLOTTE AVE MKD (BM 216)	CG 708
ARCADIA (1975)	446.966	SPK S CB 10FT E/O BCR @ SE COR SAN GABRIEL BLVD & HERMOSA DR 57FT E & 20FT S/O C/L INT	CG 711
ARCADIA (1975)	451.682	SPK E CB 5FT S/O BCR @ SE COR LESLIE DR & SAN GABRIEL BLVD 61FT S & 36FT E/O C/L INT	CG 712
ARCADIA (1975)	456.855	L&T S CB 2FT E BCR @ SE COR SAN GABRIEL BLVD & SANTA YNEZ ST 74FT E & 16FT S/O C/L INT	CG 713
ARCADIA (1975)	461.746	L&T S CB 3FT E BCR @ SE COR BEVAN ST & SAN GABRIEL BLVD 16FT S & 75FT E/O C/L INT	CG 714
ARCADIA (1975)	466.545	SPK E CB 6FT S BCR @ SE COR GARIBALDI AVE & SAN GABRIEL BLVD 51FT S & 38FT E/O C/L INT	CG 715
ARCADIA (1975)	472.881	SPK E CB 9FT N/O BCR @ NE COR BEVERLY DR & SAN GABRIEL BLVD 37FT N & 38FT E/O C/L INT	CG 716
ARCADIA (1975)	483.220	RD BR CAP MON IN WELL @ C/L INT SAN GABRIEL BLVD & LONGDEN AVE	CG 718
ARCADIA (1975)	483.154	L&T S CB 19FT E CB RET @ SE COR LONGDEN AVE & SAN GABRIEL BLVD 20FT S & 72FT E/O C/L INT	CG 719

QUAD-YEAR	ELEV	DESCRIPTION (INCLUDE QUAD AND YEAR IN DESCRIPTION)	BM NUMBER
ARCADIA (1975)	475.884	SPK S CB LONGDEN AVE 5FT E C/L PROD CHARLOTTE AVE MKD (TE 612)	CG 720
ARCADIA (1975)	474.423	SPK S CB LONGDEN AVE 5FT W C/L PROD LONGMONT AVE MKD (TE 611)	CG 721
ARCADIA (1975)	469.328	L&T N CB 1FT E BCR @ NE COR LONGDEN AVE & DEL LOMA AVE 25FT E & 18FT N/O C/L INT	CG 722
ARCADIA (1975)	467.800	L&BN S CB 1FT E BCR @ SE COR LONGDEN AVE & WILLARD AVE 20FT S & 40FT E/O C/L INT	CG 724
ARCADIA (1975)	469.322	L&BN N CB 1FT W BCR @ NW COR LONGDEN AVE & DEERFIELD AVE MKD (TE 608)	CG 725
ARCADIA (1975)	470.502	L&BN N CB 5FT W BCR @ NW COR LONGDEN AVE & VISTA ST TO N 18FT N & 34FT W/O C/L INT	CG 726
ARCADIA (1975)	469.450	L&BN E CB 1FT S BCR @ SE COR LONGDEN AVE & BION AVE MKD (TE 607)	CG 727
ARCADIA (1975)	469.391	L&SPK E CB BURTON AVE 12FT S OF END OF CB 42FT S C/L LONGDEN AVE MKD (TE 606)	CG 729
BASELINE (1975)	366.248	L&T CTR OF CB RET @ NW COR SAN GABRIEL BLVD & MISSION DR 43FT W & 53FT N C/L INT	CG 746
BASELINE (1975)	365.422	LACS BR CAP MON IN WELL C/L INT SAN GABRIEL BLVD & MISSION DR MKD (EL MONTE B-2 1940 RE2177)	CG 747
BASELINE (1975)	365.641	L&T W CB 7FT S BCR @ SW COR SAN GABRIEL BLVD & MISSION DR 30FT S & 38FT W C/L INT	CG 748
ARCADIA (1975)	490.171	L&SPK W CB 6FT N BCR @ NW COR LOS OLIVOS DR TO W & SAN GABRIEL BLVD 39FT N & 38FT W/O C/L INT MKD (TE)615)	CG 775
ARCADIA (1975)	496.372	SPK W CB 10FT N BCR @ NW COR SOMERSET PL & SAN GABRIEL BLVD 44FT N & 37FT W/O C/L INT MKD (616)	CG 776
ARCADIA (1975)	504.157	L&SPK W CB 6FT S BCR @ SW COR SHEFFIELD RD & SAN GABRIEL BLVD 43FT S & 37FT W/O C/L INT MKD (TE 617)	CG 777
ARCADIA (1975)	504.570	RD BR CAP MON IN WELL C/L INT SAN GABRIEL BLVD & SHEFFIELD RD	CG 778
ARCADIA (1975)	506.154	L&SPK E CB 8FT N/O BCR @ NE COR SHEFFIELD RD & SAN GABRIEL BLVD 44FT N & 38FT E/O C/L INT MKD (TE)618)	CG 779

QUAD-YEAR	ELEV	DESCRIPTION (INCLUDE QUAD AND YEAR IN DESCRIPTION)	BM NUMBER
ARCADIA (1975)	513.634	L&SPK W CB 10FT N/O BCR @ NW COR WOODLAWN AVE & SAN GABRIEL BLVD 59FT N & 37FT W/O C/L INT MKD (TE 619)	CG 780
ARCADIA (1975)	528.441	RD BR CAP MON IN WELL C/L INT DUARTE RD & SAN GABRIEL BLVD	CG 781
ARCADIA (1975)	526.638	L&SPK W CB 6FT S BCR @ SW COR DUARTE RD & PROVENCE RD MKD (TE 338)	CG 784
ARCADIA (1975)	523.487	L&T S CB 1FT W BCR @ SE COR DUARTE RD & KIMDALE RD 40FT S & 32FT E/O C/L INT	CG 785
ARCADIA (1975)	515.746	SPK W CB VISTA ST 10FT N END CB & 45FT N C/L DUARTE RD MKD (TE 335)	CG 788
ARCADIA (1975)	510.104	CS MON IN 2IN I P IN WELL @ C/L INT LA PRESA DR & DUARTE RD 6FT W/O PI OF CURVE ON C/L DUARTE RD ( USE S EDGE OF PIPE)	CG 790
ARCADIA (1975)	511.410	L&SPK E CB DR TO HSE NO 8712 32FT S & 27FT E C/L INT MUSCATEL AVE TO THE N & DUARTE RD MKD (TE 329)	CG 798
ARCADIA (1975)	515.423	L&T E CB OF DR TO HSE NO 8850 55FT S C/L DUARTE RD & 185FT E C/L MAYESDALE AVE	CG 799
ARCADIA (1975)	513.263	RDBM TAG IN N CB DUARTE RD 2FT W CB RET @ NW COR OF ROSEMEAD BLVD 40FT N & 62FT W C/L INT	CG 802
ARCADIA (1975)	495.956	L&SPK E CB 12FT S BCR @ SE COR OAK AVE & NAOMI AVE MKD (TE 352)	CG 808
ARCADIA (1975)	489.408	L&SPK E CB OAK AVE 12FT N C/L ARDENDALE AVE FRONT OF HSE NO 6734 MKD (TE 353)	CG 809
ARCADIA (1975)	482.733	L&SPK E CB OAK AVE 5FT S C/L PROD CAMINO REAL TO W MKD (TE 355)	CG 811
ARCADIA (1975)	471.712	SPK E CB OAK AVE 3FT N C/L PROD EMPEROR AVE TO W MKD (TE 357)	CG 813
ARCADIA (1975)	466.359	L&SPK E CB 2FT S BCR @ SE COR OAK AVE & LEMON AVE MKD (TE 199)	CG 814
ARCADIA (1975)	453.507	L&SPK W CB OAK AVE 35FT S C/L PROD OLEMA ST FRONT OF HSE NO 6333 MKD (TE 204)	CG 815
ARCADIA (1975)	478.448	L&BN E CB 10FT S BCR @ SE COR DUARTE RD & BALDWIN AVE 30FT E & 45FT S/O C/L INT	CG 822

QUAD-YEAR	ELEV	DESCRIPTION (INCLUDE QUAD AND YEAR IN DESCRIPTION)	BM NUMBER
ARCADIA (1975)	466.938	RDBM TAG IN E CB BALDWIN AVE 50FT N CB RET @ NE COR CAMINO REAL AVE TO E 32FT E & 92FT N C/L INT	CG 825
ARCADIA (1975)	339.696	L&T E CB TYLER AVE ON C/L PROD DANESWOOD AVE	CG 953
ARCADIA (1975)	332.080	SPK W CB 5FT S BCR @ SW COR DAINES DR & TYLER AVE MKD (TE 534)	CG 954
ARCADIA (1975)	327.613	L&SPK W CB 8FT S BCR @ SW COR WILDFLOWER RD & TYLER AVE MKD (TE 535)	CG 955
ARCADIA (1975)	324.977	L&SPK E CB TYLER AVE 10FT S C/L PROD FREER ST MKD (TE 536)	CG 956
ARCADIA (1975)	324.211	L&T E CB 1FT S BCR @ SE COR TYLER AVE & MILDOANN ST 59FT S & 20FT E/O C/L INT	CG 957
ARCADIA (1975)	308.802	L & BN IN W WALL OF DRAINAGE CHANNEL 22FT W C/L TYLER AVE & 130FT S/O C/L ROCKFIELD DR MKD ( S D 605)	CG 959
ARCADIA (1975)	308.174	L&N IN E WALL DRAINAGE CHANNEL 30FT W C/L TYLER AVE & 275FT S/O C/L ROCKFIELD DR MKD (S D 601)	CG 960
ARCADIA (1975)	601.590	CS MON IN WELL 1FT W & 1FT N/O BCR @ NW COR MICHILLINDA AVE & SCYAMORE AVE	CG 1218
ARCADIA (1975)	615.127	L&T W EDGE CONC DR TO HSE NO 3834 SYCAMORE AVE 35FT S C/L & 0.1 MI W/O C/L MICHILLINDA AVE	CG 1220
ARCADIA (1975)	617.986	L&T W EDGE CONC DR TO HSE NO 3798 SYCAMORE AVE 35FT S C/L 0.1 MI E/O WALNUT DR	CG 1221
ARCADIA (1975)	623.652	L&SPK 2FT E BCR @ SE COR WALNUT DR & SYCAMORE AVE 15FT S & 50FT E/O C/L INT	CG 1222
ARCADIA (1975)	623.932	L&T IN CONC APRON OF DR TO HSE NO 325 WALNUT DR ON C/L PROD SYCAMORE AVE	CG 1223
ARCADIA (1975)	629.587	L&T 1FT S BCR @ SE COR MOUNTAIN VIEW AVE & ROSEMEAD BLVD 38FT S & 42FT E/O C/L INT	CG 1224
ARCADIA (1975)	630.887	L&T 1FT N BCR @ NE COR MOUNTAIN VIEW AVE & ROSEMEAD BLVD 36FT N & 42FT E/O C/L INT	CG 1225
ARCADIA (1975)	635.521	L&T E CB ROSEMEAD BLVD ON C/L PROD DEL MAR BLVD	CG 1226
ARCADIA (1975)	666.439	L&T 3FT S BCR @ SE COR MILTON ST & MADRE ST 20FT E & 31FT S/O C/L INT	CG 1235

QUAD-YEAR	ELEV	DESCRIPTION (INCLUDE QUAD AND YEAR IN DESCRIPTION)	BM NUMBER
ARCADIA (1975)	672.392	L&T 2FT S BCR @ SE COR BRANDON ST & MADRE ST 20FT E & 37FT S/O C/L INT	CG 1236
ARCADIA (1975)	678.832	L&T 6FT S BCR @ SE COR GREEN ST & MADRE ST 20FT E & 35FT S/O C/L INT	CG 1238
ARCADIA (1975)	684.948	BT SPK 6FT E/O BCR @ SE COR MADRE ST & COLORADO BLVD MKD (TE 683)	CG 1239
ARCADIA (1975)	680.413	L&T 1FT W/O BCR @ NW COR HALSTEAD ST & COLORADO BLVD 38FT N & 44FT W/O C/L INT	CG 1241
ARCADIA (1975)	680.065	L&T 1FT N/O BCR @ NE COR HALSTEAD ST & COLORADO BLVD 63FT N & 18FT E/O C/L INT	CG 1242
BASELINE (1975)	714.305	L&BN 29FT N/O BCR @ NE COR SIERRA MADRE VILLA AVE & FOOTHILL BLVD 98FT N & 28FT E C/L INT	CG 1247
BASELINE (1975)	720.743	RAMSET 1FT W BCR @ NW COR SANTA PAULA AVE & FOOTHILL BLVD 51FT W & 30FT N C/L INT	CG 1249
BASELINE (1975)	739.232	L&BT SPK 2FT E BCR @ SE COR DAISY AVE & FOOTHILL BLVD 42FT E & 32FT S C/L INT	CG 1251
BASELINE (1975)	738.135	LACS BM MON IN WELL 51FT S & 15FT E OF C/L INT FOOTHILL BLVD & DAISY AVE MKD (BM 10-8 1952 RE 63)	CG 1252
BASELINE (1975)	687.629	L&BN S CB FOOTHILL BLVD 0.1MI W INT ROSEMEAD BLVD 34FT S C/L IN CTR C B FRONT OF BLDG NO 3600	CG 1254
ARCADIA (1975)	613.523	L&BN IN W CB MICHILLINDA AVE 1FT N CB RET @ NW COR BLANCHE AVE 20FT W & 34FT N C/L INT	CG 1269
ARCADIA (1975)	523.116	RDBM TAG N CB OF ISI 1FT W ANG PT 30FT S C/L HUNTINGTON DR N BARREL 50FT W/O C/L GOLDEN WEST AVE	CG 1693
ARCADIA (1975)	523.501	L&T N CB 3FT W BCR 30FT N/O C/L HUNTINGTON DR N BARREL & 54FT W/O C/L GOLDEN WEST AVE	CG 1694
ARCADIA (1975)	550.332	CS MON IN WELL 11IN DN 1FT BACK OF CB @ BCR @ NW COR HUNTINGTON DR & MICHILLINDA AVE MKD (BM 20-7)	CG 1696
ARCADIA (1975)	563.436	SQ HD SPK W CB 45FT N BCR 85FT N C/L HUNTINGTON DR N & 45FT W C/L ROSEMEAD BLVD MKD (SD 809)	CG 1698
ARCADIA (1975)	568.959	L&SPK W CB 4FT N BCR 64FT N/O C/L HUNTINGTON DR N BARREL 20FT W/O C/L MADRE ST	CG 1700

QUAD-YEAR	ELEV	DESCRIPTION (INCLUDE QUAD AND YEAR IN DESCRIPTION)	BM NUMBER
ARCADIA (1975)	587.530	BT SPK W CB 1FT S CATCH BASIN 20FT W C/L LA PRESA DR 80FT N/O C/L HUNTINGTON DR N BARREL MKD (TE 637)	CG 1702
BASELINE (1975)	336.941	L&T @ NE COR CONC WK OF BLDG NO 5343 @ SW COR PECK RD & RIO HONDO PKWY 147FT S & 78FT W/O C/L INT MKD (BM)	CG 2329
BASELINE (1975)	338.560	FC MON IN N END OF CB ON BRIDGE NO B 1270 40FT W C/L PECK RD & 1000FT N CLARK ST MKD (BM 67-75)	CG 2332
BASELINE (1975)	339.265	RDBM TAG CONC WALL OF WASH @ NE COR BRIDGE NO B1270 5FT E CB & 45FT E C/L PECK RD & 1000FT N CLARK ST	CG 2333
BASELINE (1975)	357.452	RD MON IN WELL 6IN DN @ INT MYRTLE AVE & LONGDEN AVE	CG 2336
BASELINE (1975)	364.237	L&T E CB MYRTLE AVE 40FT E C/L & 37FT S BCR OF ISL & 66FT S C/L CALIFORNIA AVE EXIT	CG 2337
BASELINE (1975)	365.158	LAFC TAG W CB MYRTLE AVE 40FT W C/L & 5FT S/O C B & 46FT N CALIFORNIA AVE EXIT S TAG OF 2 TAGS	CG 2338
BASELINE (1975)	666.808	SMALL SPK & W N CB 1FT E/O BCR @ NE COR DEXTER AVE & FOOTHILL BLVD 49FT E & 27FT N C/L INT	CG 2494
BASELINE (1975)	670.152	L&BN E CB 1FT S/O BCR @ NE COR FOOTHILL BLVD N SERV RD & DEXTER AVE 25FT N & 21FT E C/L INT	CG 2495
BASELINE (1975)	635.601	LAFC MON FL 1FT N/O N CB NW COR DRWY @ NW COR BALDWIN AVE & FOOTHILL BLVD 91FT W & 28FT N C/L INT MKD (BM 62-76 1937)	CG 2499
BASELINE (1975)	591.350	LACS BR CAP MON IN WELL 1FT N C/L FOOTHILL BLVD & 70FT E C/L BURNELL OAKS LN MKD ( SIERRA MADRE G 6 1940 RE2177)	CG 2502
ARCADIA (1975)	566.448	L&SML BT SPK CONC CB CAMBRIDGE DR 36FT E BCR @ NE COR BALDWIN AVE 100FT E & 18FT N C/L INT	CG 2505
BASELINE (1975)	308.548	LAFC MON IN E ABUT @ NE COR BRIDGE NO B1256 32FT RD BRIDGE NO B1256 OVER RIO HONDO RIVER 32FT N C/L LOWER AZUSA RD & 462FT E INT DALEVIEW AVE MKD (BM 62-128 1959)	CG 2506
BASELINE (1975)	306.908	RDBM TAG IN N CB 3FT W NW COR BRIDGE NO B1256 (OVER RIO HONDO RIVER) 26FT N/O C/L LOWER AZUSA RD & 233FT E/O INT DALEVIEW AVE	CG 2507
ARCADIA (1975)	431.817	LACS BR CAP MON IN WELL C/L INT LAS TUNAS DR & SAN GABRIEL BLVD MKD (RE 63)	CG 2510



QUAD-YEAR	ELEV	DESCRIPTION (INCLUDE QUAD AND YEAR IN DESCRIPTION)	BM NUMBER
ARCADIA (1975)	310.382	L&BN IN W CB OF ARROYO HIGH SCHOOL FOOTBALL FIELD PKNG LOT @ MOST NLY ENT 45FT E C/L TYLER AVE & 800FT N LOWER AZUSA RD	CG 2515
BASELINE (1975)	353.258	L&BN NR N EDGE OF CONC DRWY TO HSE NO 4471 BARTLETT AVE TO S @ SW COR OF MISSION DR 25FT W & 50FT S C/L INT	CG 2517
BASELINE (1975)	353.870	FC BR CAP IN S END W WINGWALL OF BRIDGE NO 964 @ SE COR PECK RD & LIVE OAK ST 48FT S & 82FT E APPROX C/L INT MKD (67-76 1959)	CG 2637
BASELINE (1975)	386.872	L&SPK IN W CB 6FT S BCR 55FT S & 45FT W C/L INT E ALTERN ST & S MYRTLE AVE MKD (LE 85)	CG 2638
BASELINE (1975)	387.470	L&SPK S CB E ALTERN ST 10FT E BCR 20FT S & 79FT E C/L INT S MYRTLE AVE & E ALTERN ST MKD (LE 20)	CG 2639
BASELINE (1975)	432.120	L&T E CB 15FT N BCR 75FT S & 43FT E C/L INT DUARTE RD & S MYRTLE AVE	CG 2640
BASELINE (1975)	499.580	CE MON FLUSH IN WLK BACK OF CB 30FT E BCR @ SE COR HUNTINGTON DR & MYRTLE AVE 126FT E & 36FT S C/L INT MKD (11-10A RE 5869 CE)	CG 2642
BASELINE (1975)	336.193	L&T E CB 10FT S/O BCR @ SE COR ROSEMEAD BLVD & LOWER AZUSA RD 50FT S & 40FT E C/L INT	CG 3029
ARCADIA (1975)	384.008	L&T IN E CB 10FT S/O BCR @ SE COR EL MONTE ST TO THE E & SAN GABRIEL BLVD 45FT S & 38FT E/O C/L INT	CG 3040
ARCADIA (1975)	405.574	L&BN E CB 11FT S BCR @ SE COR SAN GABRIEL BLVD & BROADWAY 41FT S & 35FT E C/L INT	CG 3042
ARCADIA (1975)	406.398	L&BR W CB 12FT N/O BCR CTR CB @ NW COR BROADWAY & SAN GABRIEL BLVD 42FT N & 35FT W/O C/L INT	CG 3043
ARCADIA (1975)	412.549	LAFC BR DISC @ NW BRIDGE ABUT OVER RUBIO WASH 50FT W & 61FT S/O C/L INT SAN GABRIEL BLVD & WEDGEWOOD PL MKD (BM 58-523)	CG 3044
ARCADIA (1975)	431.757	LACS BR CAP MON IN WELL 8FT S & 1FT E C/L INT SAN GABRIEL BLVD & LAS TUNAS DR MKD (SIERRA MADRE B-12 1940 RE2177)	CG 3045
ARCADIA (1975)	447.546	RD BR CAP MON IN WELL C/L INT SAN GABRIEL BLVD & HERMOSA DR	CG 3046
ARCADIA (1975)	597.972	L&BN S CB 60FT W BCR @ SW COR SAN GABRIEL BLVD & HUNTINGTON DR 139FT W & 88FT S/O C/L INT	CG 3049

QUAD-YEAR	ELEV	DESCRIPTION (INCLUDE QUAD AND YEAR IN DESCRIPTION)	BM NUMBER
ARCADIA (1975)	597.591	L&BN N CB 25FT E BCR @ NE COR SAN GABRIEL BLVD & HUNTINGTON DR 110FT E & 75FT N/O C/L INT	CG 3050
ARCADIA (1975)	651.067	LACS BM MON IN WELL @ SW COR LOMBARDY RD & SAN GABRIEL BLVD 45FT S & 25FT W/O C/L INT MKD (BM 10-6 1952 RE 63)	CG 3051
ARCADIA (1975)	653.233	BT SPK E CB 5FT N/O BCR @ NE COR LOMBARDY RD & SAN GABRIEL BLVD 35FT N & 30FT E C/L INT	CG 3052
BASELINE (1975)	661.239	SPK E CB 6FT S/O BCR @ SE COR CALIFORNIA BLVD & SAN GABRIEL BLVD 58FT S & 27FT E C/L INT	CG 3053
BASELINE (1975)	721.306	SPK CTR CB RET @ NW COR COLORADO BLVD & SAN GABRIEL BLVD 41FT N & 34FT W C/L INT	CG 3056
BASELINE (1975)	727.818	L&BN 5FT E/O BCR @ SE COR DAISY AVE & WALNUT AVE 35FT E & 30FT S C/L INT	CG 3057
BASELINE (1975)	635.348	LACS BM MON DN 4IN 1FT S/O S CB N SERV RD 2FT W/O BCR @ NE COR BALDWIN AVE & FOOTHILL BLVD 43FT E & 47FT N C/L INT MKD (BM 10-12A 1962 RE5869)	CG 3058
BASELINE (1975)	556.954	RAMSET 1FT S BCR @ SW COR FOOTHILL BLVD & RANCHO RD 61FT S & 18FT W C/L INT	CG 3060
BASELINE (1975)	543.075	LACS BR CAP MON IN WELL C/L FOOTHILL BLVD 26FT E C/L SANTA ANITA AVE MKD (SIERRA MADRE I-6 1940 RE2177)	CG 3061
ARCADIA (1975)	539.321	MWD BR DISC NE ABUT OF BRIDGE OVER SANTA ANITA WASH 50FT N C/L FOOTHILL BLVD & 277FT E/O INT HIGHLAND OAKS MKD (53 K 1933)	CG 3062
ARCADIA (1975)	510.193	L&BR CTR CB RET @ SE COR FOOTHILL BLVD & FIFTH ST 34FT S & 26FT E/O C/L INT	CG 3063
ARCADIA (1975)	507.340	LACS BR CAP MON IN WELL C/L FOOTHILL BLVD 43FT E/O C/L MC KINLEY PL MKD (SIERRA MADRE K6A 1940 RE 2177)	CG 3064
ARCADIA (1975)	548.231	LACS BR CAP MON IN WELL 37FT E & 8FT N C/L INT MAYFLOWER AVE & FOOTHILL BLVD MKD (SIERRA MADRE K-6 1940 RE2177)	CG 3065
BASELINE (1975)	576.442	L&BR CTR CB RET @ SE COR FOOTHILL BLVD & MYRTLE AVE 41FT S & 33FT E/O C/L INT	CG 3068
BASELINE (1975)	554.843	L&BR CTR CB RET @ SE COR MYRTLE AVE & LIME AVE 32FT E & 24FT S C/L INT	CG 3069

QUAD-YEAR	ELEV	DESCRIPTION (INCLUDE QUAD AND YEAR IN DESCRIPTION)	BM NUMBER
BASELINE (1975)	517.927	L&T CTR CB RET @ NE COR MYRTLE AVE & CHESTNUT AVE 25FT N & 35FT E/O C/L INT	CG 3070
BASELINE (1975)	470.510	L&N 5FT N BCR @ NW COR MYRTLE AVE & MONTANA AVE 35FT N & 30FT W C/L INT	CG 3072
ARCADIA (1975)	425.730	L&T CTR CB RET @ SE COR PECK RD & DUARTE RD 49FT S & 25FT E/O C/L INT	CG 3074
ARCADIA (1975)	403.038	L&T 1FT S BCR @ NW COR PECK RD & CHULA ST 40FT N & 20FT W C/L INT	CG 3075
ARCADIA (1975)	380.169	CS MON IN WELL 51FT E & 23FT S/O C/L INT PECK RD & CAMINO REAL	CG 3076
ARCADIA (1975)	381.292	L&T 3FT E BCR @ SE COR PECK RD & CAMINO REAL 54FT E & 25FT S C/L INT	CG 3077
ARCADIA (1975)	368.266	L&T E CB PECK RD 10FT N/O C/L PROD JEFFRIES AVE	CG 3078
ARCADIA (1975)	342.858	L&T 5FT W BCR @ SW COR LIVE OAK AVE & TYLER AVE 57FT W & 38FT S C/L INT	CG 3079
ARCADIA (1975)	373.786	L&BN 11FT S/O BCR @ SW COR LIVE OAK AVE & BALDWIN AVE 56FT S & 40FT W/O C/L INT	CG 3080
ARCADIA (1975)	385.493	L&T CTR C B @ NE COR LIVE OAK AVE & ENCINITA AVE 43FT E & 20FT N/O C/L INT	CG 3081
ARCADIA (1975)	594.832	L&T N CB COLORADO ST ON C/L PROD BALDWIN AVE TO NO 9FT E/O L&BR APPROX 552FT E/O INT OLD RANCH RD	CG 3082
ARCADIA (1975)	502.430	L&T 2FT S BCR @ SW COR BALDWIN AVE & HUGO RIED DR 50FT S & 40FT W/O C/L INT	CG 3083
ARCADIA (1975)	417.913	SPK 15FT E BCR @ NE COR LAS TUNAS DR & MUSCATEL AVE 55FT N & 53FT E/O C/L INT	CG 3087
ARCADIA (1975)	386.016	L&BRAD 1FT N BCR @ NW COR E CLANTON ST & WALNUT-GROVE AVE 50FT N & 20FT W C/L INT	CG 3088
ARCADIA (1975)	385.292	L&T 1FT S BCR @ SW COR E CLANTON ST & WALNUT GROVE AVE 50FT S & 20FT W C/L INT	CG 3089
ARCADIA (1975)	371.496	L&T 5FT E BCR @ SE COR GRAND AVE & WALNUT GROVE 65FT E & 20FT S C/L INT	CG 3090
ARCADIA (1975)	583.033	SPK W CB MICHILLINDA AVE 5FT N C/L PROD HUGO RIED DR MKD (TE 431)	CG 3091

