

**COUNTY OF LOS ANGELES**  
**ROAD DEPARTMENT**

**PRECISE**  
**BENCH MARK LIST**



**LAKWOOD QUAD**  
**1970 ADJUSTMENT**

## PREFACE

The Road Department level net is composed of more than 1,000 miles of levels supporting in excess of 10,000 bench marks. In 1964-65, a major readjustment of the net was undertaken. To emphasize the complete break with previous elevations, the SY, SG & SL series bench marks have been re-labeled BY, BG & BL, respectively.

To facilitate the adjustment, indexing, and distribution of adjusted values of the net, the County territory was divided into 31 quads or areas. For identification purposes each quad was given a name, viz., "Rosemead," "La Mirada," "Santa Fe," etc. When bench marks and elevations in the Road Department net are used, the name of the quad in which the bench mark is located and the date of the adjustment of the elevation must be included in the bench mark description, e.g.,

BG 1887 ---L+BN IN CONC HDWL OF DRAIN PIPE UNDER DR 218 FT  
NE +18 FT SE C/L INT GRAND AVE +CAMERON AVE MKD (BM)  
(COVINA ---1965) ELEV. 696.238

It is expected that this general adjustment will, for the most part, remain sound for the next 8 to 12 years. As new circuits are completed, however, re-adjustment of individual quads may become advisable. It is expected that these subsequent adjustments will be in the nature of a few hundredths of a foot. When a quad is re-adjusted, new elevation lists will be published and the date of the re-adjustment will replace the "1965" at the end of the bench mark description. Two bench marks in the same quad with different adjustment dates will not normally join each other. Since all adjustments taper out to nothing at the periphery of the quad, any bench mark in one quad will join any bench mark in another quad regardless of their respective adjustment dates.

The basic accuracy of the net is reflected by an indicated field probable error of plus or minus 0.012 foot per mile of leveling as determined from 298 conditions of closure. However, many years experience in vertical control in the greater Los Angeles basin and Antelope Valley indicate that because of varying degrees of subsidence and heaving, the true datum is recovered only by obtaining substantial agreement of a number of bench marks.

The users of this net are invited to assist in its maintenance by notifying this Department of cases of obliteration, apparent mistakes in descriptions or elevations, and proven disturbance of bench marks.

---

DATUM: U. S. Coast and Geodetic Survey Sea Level Datum  
of 1929, through the medium of the Los Angeles  
County Engineer Precise Level Net, 1963 Adjust-  
ment.

ABBREVIATIONS USED IN BENCH MARK LISTINGS

ABUT - - - - -	Abutment	EC - - - - -	End of Curve
ALG - - - - -	Along	ENT - - - - -	Entrance
ANG PT - - - - -	Angle Point	FL - - - - -	Floor
B/W - - - - -	Back of Walk	FTG - - - - -	Footing
BCR - - - - -	Beginning of Curb Return	F/W - - - - -	Front of Walk
BC - - - - -	Beginning of Curve	GAR - - - - -	Garage
BLDG - - - - -	Building	HDWL - - - - -	Headwall
BM - - - - -	Bench Mark	HSE - - - - -	House
BT SPK - - - - -	Boat or Bolt Spike	INT - - - - -	Intersection
BR CAP - - - - -	Brass or Bronze Cap	IP - - - - -	Iron Pipe
C B - - - - -	Catch Basin	LT - - - - -	Left
CTR - - - - -	Center	LACE - - - - -	L. A. City Engineer
C/L - - - - -	Center Line	LACS - - - - -	L. A. County Engineer
C/L INT - - - - -	Center Line Intersection	LAFC - - - - -	L. A. Co. Flood Control
C/L PROD - - - - -	Center Line Produced	L+BN - - - - -	Lead and Bench Nail
CONC - - - - -	Concrete	L+BR - - - - -	Lead and Brad
COR - - - - -	Corner	L+N - - - - -	Lead and Nail
COE - - - - -	Corps of Engineers	L+RDBM TAG - - - - -	Lead and Road Dept. Bench Mark Tag
CULV - - - - -	Culvert	L+SPK - - - - -	Lead and Spike
CB - - - - -	Curb	L+T - - - - -	Lead and Tack
CS MON - - - - -	County Engineer Monument	MCR - - - - -	Middle of Curb Return
CS BR CAP - - - - -	County Engineer Brass Cap	MKD - - - - -	Marked
CT SPK - - - - -	Cut Spike	MC - - - - -	Middle of Curve
DR - - - - -	Drive or Driveway	MON - - - - -	Monument
E/O - - - - -	East of	N/O - - - - -	North of
ECR - - - - -	End of Curb Return	NR - - - - -	Near

ABBREVIATIONS USED IN BENCH MARK LISTINGS . . . CONTINUED

OPP - - - - - Opposite  
PI - - - - - Point of Intersection  
PK+W - - - - - PK Nail and Washer  
P/L - - - - - Property Line  
POST - - - - - Point on Semi-Tangent  
PP - - - - - Power Pole  
PVMT - - - - - Pavement  
PROD - - - - - Produced  
RD - - - - - Road  
RDEM - - - - - Road Dept. Bench Mark  
RR - - - - - Railroad  
RT - - - - - Right  
R/W - - - - - Right of Way  
SDMH - - - - - Storm Drain Manhole  
SMH - - - - - Sewer Manhole  
SPK - - - - - Spike  
ST+W - - - - - Spike Tin and Washer  
S/O - - - - - South of  
TP - - - - - Telephone Pole  
USC+GS - - - - - U. S. Coast and Geodetic Survey  
USGS - - - - - U. S. Geological Survey  
WK - - - - - Walk  
W/O - - - - - West of

**U A D**

**Q U A D**

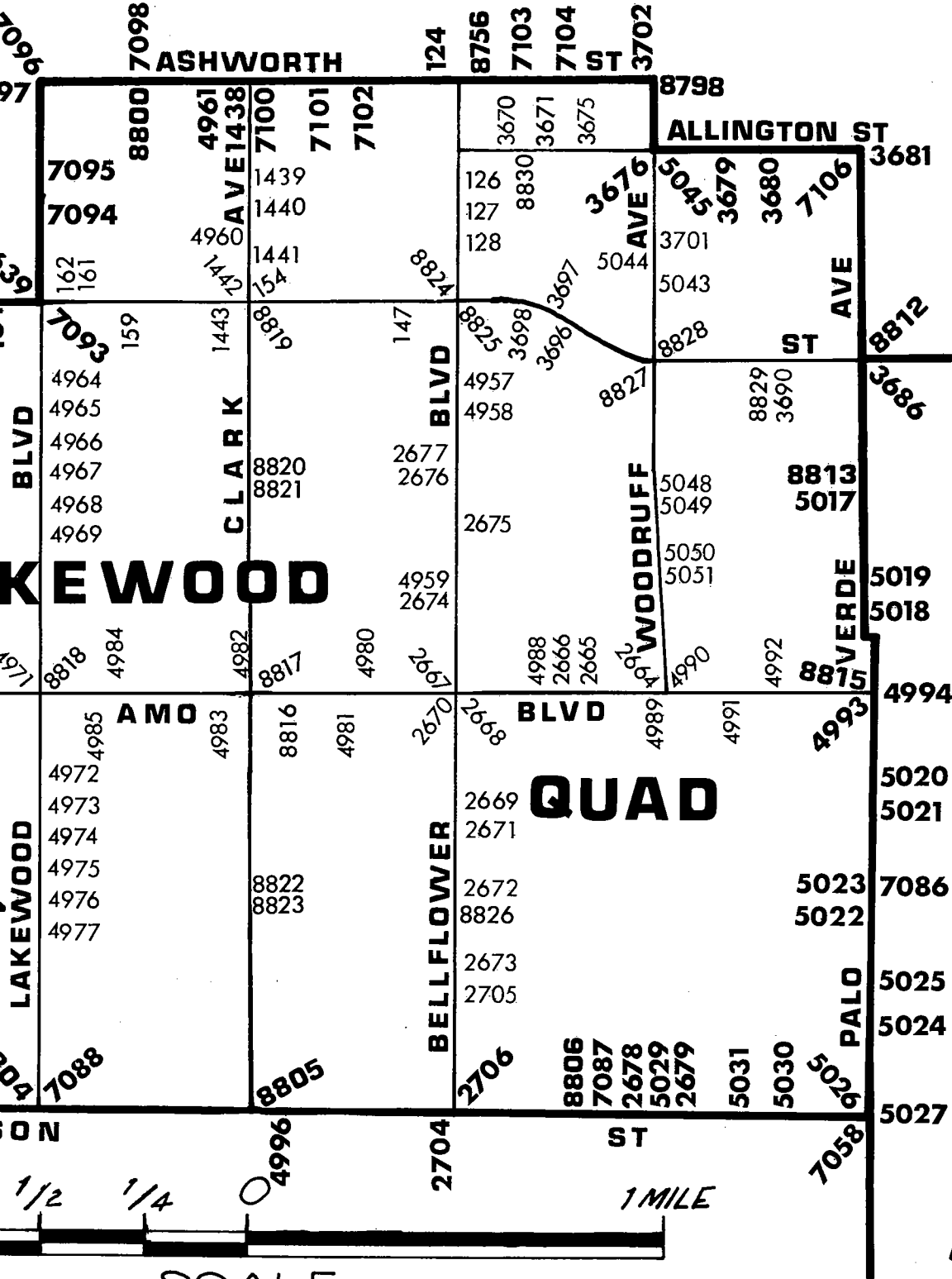

**A R T E S I A**

**T E B**



QUAD-YEAR	ELEV	DESCRIPTION (INCLUDE QUAD AND YEAR IN DESCRIPTION)	BM	NUMBER
BASELINE (1965)	59.183	L+T 1FT± W CB RET @ NW COR ASHWORTH ST + BELLFLOWER BLVD	BY	124
LAKWOOD (1970)	56.475	L+T E CB W SERVICE RD C/L PROD HEDDA ST + BELLFLOWER BLVD	BY	126
LAKWOOD (1970)	55.657	L+T W CB E SERVICE RD C/L PROD ANDY ST + BELLFLOWER BLVD	BY	127
LAKWOOD (1970)	55.068	L+BN 2FT± S BCR @ SE COR ROCKET ST + BELLFLOWER BLVD	BY	128
LAKWOOD (1970)	54.976	BT SPK E CB AUTRY AVE 85FT± N C/L SOUTH ST	BY	147
LAKWOOD (1970)	53.582	FC MON N CB SOUTH ST 52FT N C/L + 58 E C/L CLARK AVE MKD BM 74-50	BY	154
LAKWOOD (1970)	54.253	L+T N CB SERVICE RD 8FT± W BCR @ NW COR GRAYWOOD AVE + SOUTH ST 80FT N + 48FT W C/L INT	BY	159
LAKWOOD (1970)	54.445	L + T 10FT W BCR @ NW COR BLACKTHORNE AVE + SOUTH ST 80FT N + 50FT W C/L INT	BY	161
LAKWOOD (1970)	54.144	L+T N CB SERVICE RD 5FT± W BCR @ NW COR BONFAIR AVE + SOUTH ST 80FT N + 50FT W C/L INT	BY	162
BASELINE (1965)	53.439	L+T W CB 1FT± N CB RET @ NW COR OLIVA AVE + SOUTH ST 110FT N + 20FT W C/L INT	BY	164
BASELINE (1965)	53.048	L+T N CB SERVICE RD 2FT± W CB RET @ NW COR CASTANA AVE + SOUTH ST 89FT N + 57FT W C/L INT	BY	165
BASELINE (1965)	52.716	L+T N CB SERVICE RD 1FT± W CB RET @ NW COR HAYTER AVE + SOUTH ST 89FT N + 56FT W C/L INT	BY	166
BASELINE (1965)	58.587	L+T CTR CB RET SW COR ASHWORTH ST + CLARK AVE	BY	1438
LAKWOOD (1970)	57.587	L+T S EDGE CONC WK 35FT± E C/L CLARK AVE 15FT± N FIRE PLUG FRONT HORACE MANN SCHOOL	BY	1439
LAKWOOD (1970)	55.788	L+T CTR CB RET @ NE COR HEDDA ST + CLARK AVE	BY	1440
LAKWOOD (1970)	54.858	L + BN 30FT E C/L CLARK AVE IN FRONT HSE #5902	BY	1441
LAKWOOD (1970)	53.933	L+T 7FT± W BCR @ NW COR SOUTH ST + CLARK AVE 52FT N + 60FT W C/L INT	BY	1442
LAKWOOD (1970)	52.987	CS BR CAP C/L INT SOUTH ST + CLARK AVE	BY	1443
LAKWOOD (1970)	46.540	L+BN CTR CB RET @ NW COR DEL AMO BLVD + WOODRUFF AVE	BY	2664
LAKWOOD (1970)	48.997	RDBM TAG N CB 1FT± E BCR @ NE COR DEL AMO BLVD + DUNROBIN AVE 80FT± N + 43FT± E C/L INT	BY	2665
LAKWOOD (1970)	47.728	L+BN CTR CB RET @ SW COR LOMINA AVE + S SERVICE RD OF DEL AMO BLVD	BY	2666
LAKWOOD (1970)	49.118	L+BN W CB 5FT± N BCR @ NW COR BELLFLOWER BLVD + DEL AMO BLVD 79FT N + 40FT W C/L INT	BY	2667
LAKWOOD (1970)	49.083	L+T E CB 5FT± N BCR @ SE COR BELLFLOWER BLVD + DEL AMO BLVD 66FT± S + 38FT± E C/L INT	BY	2668

QUAD-YEAR	ELEV	DESCRIPTION (INCLUDE QUAD AND YEAR IN DESCRIPTION)	BM NUMBER
LAKWOOD (1970)	46.229	L + BN IN W CB OF E PKWY BELLFLOWER BLVD 40FT E C/L + 39FT N C/L ARBOR RD	BY 2669
LAKWOOD (1970)	48.191	CS MON IN WELL 10IN DN ON C/L BELLFLOWER BLVD 90FT± S C/L DEL AMO BLVD MKD (CLEARWATER J7)	BY 2670
LAKWOOD (1970)	46.350	L+T S CB 1FT± W BCR @ SW COR BELLFLOWER BLVD + ARBOR RD 63FT± W + 25FT± S C/L INT	BY 2671
LAKWOOD (1970)	43.865	L + T IN W CB OF E PKWY BELLFLOWER BL 40FT E C/L + 37FT N C/L CENTRALIA ST	BY 2672
LAKWOOD (1970)	41.217	RDBM TAG W CB 1FT± N BCR @ NW COR BELLFLOWER BLVD + HARVEY WAY 55FT± N + 40FT± W C/L INT	BY 2673
LAKWOOD (1970)	51.369	L + T 1FT S BCR @ SE COR BELLFLOWER BLVD + HARDWICK ST 46FT S + 80FT E C/L INT	BY 2674
LAKWOOD (1970)	52.067	L + T 1FT S BCR @ SE COR BELLFLOWER BLVD + CANDLEWOOD ST 46FT S + 80FT E C/L INT	BY 2675
LAKWOOD (1970)	51.556	L + T 1FT N BCR @ NE COR BELLFLOWER BLVD + CANDLEWOOD ST 46FT N + 80FT E C/L INT	BY 2676
LAKWOOD (1970)	52.295	L + TRANSIT TK IN W CB OF E PKWY @ ANG PT BELLFLOWER BLVD 2000FT S SOUTH ST IN FRONT HSE # 5328	BY 2677
BASELINE (1965)	44.262	L + BN 1FT E BCR @ NE COR CARSON ST + 1ST ALLEY W WOODRUFF AVE 40FT N + 400FT W C/L INT	BY 2678
BASELINE (1965)	44.772	L + T 2FT W BCR @ NW COR WOODRUFF AVE + CARSON ST 42FT N + 79FT W C/L INT MKD BM	BY 2679
BASELINE (1965)	39.974	RDBM TAG S CB 1FT± W BCR @ SW COR BELLFLOWER BLVD + CARSON ST 38FT± S + 70FT± W C/L INT	BY 2704A
LAKWOOD (1970)	40.978	RDBM TAG W CB 1FT± S BCR @ SW COR BELLFLOWER BLVD + HARVEY WAY 55FT± S + 40FT± W C/L INT	BY 2705
BASELINE (1965)	39.747	L+T @ CTR CB RET @ NE COR BELLFLOWER BLVD + CARSON ST	BY 2706A
BASELINE (1965)	50.822	L+T E CB OBISPO AVE 6FT N BCR @ NE COR OBISPO AVE + SOUTH ST 65FT N + 10FT E C/L INT	BY 3637A
BASELINE (1965)	54.035	L + BN 1FT W BCR @ NW COR LAKEWOOD BL + SOUTH ST 40 N + 80FT W C/L INT	BY 3639
LAKWOOD (1970)	57.334	L+BN 1FT± E BCR @ SE COR ALLINGTON ST + BRIERCREST AVE 28FT S + 42FT E C/L INT	BY 3670
LAKWOOD (1970)	57.439	BN 1FT± E BCR @ SE COR ALLINGTON ST + DUNROBIN AVE 28FT S + 41FT E C/L INT	BY 3671
LAKWOOD (1970)	57.053	L+T 4FT± E BCR @ SE COR ALLINGTON ST + IBRETSON AVE 28FT S + 44FT E C/L INT	BY 3675
BASELINE (1965)	56.682	L+BN S CB ALLINGTON ST 75FT± W C/L WOODRUFF AVE	BY 3676
BASELINE (1965)	56.895	L+BR W CB 3FT± N BCR @ NW COR ALLINGTON ST + CANEHILL AVE 75FT± N + 18FT± W C/L INT	BY 3679
BASELINE (1965)	57.450	RDBM TAG S CB 1FT± E BCR @ SE COR ALLINGTON ST + CANEHILL AVE 30FT S + 60FT± E C/L INT	BY 3680
BASELINE (1965)	55.927	CS MON C/L INT PALO VERDE AVE + ALLINGTON ST	BY 3681A



QUAD-YEAR	ELEV	DESCRIPTION (INCLUDE QUAD AND YEAR IN DESCRIPTION)	BM NUMBER
BASELINE (1965)	49.786	LACS MON IN WELL 9IN DN 88FT S + 9FT E/O C/L INT @ SOUTH ST + PALO VERDE AVE MKD BM 9-9 1951	BY 3686
LAKWOOD (1970)	51.522	L+BN W CB 15FT± N BCR @ NW COR SOUTH ST + SNOWDEN AVE 120FT± N + 18FT± W C/L INT	BY 3690
LAKWOOD (1970)	54.247	L+BN 1FT± W OF BCR @ SW COR OCANA AVE + SERVICE RD SOUTH ST 80FT S + 48FT W C/L INT	BY 3696
LAKWOOD (1970)	55.365	L+BN 1FT± W BCR @ SW COR COLDBROOK AVE + SERVICE RD SOUTH ST 80FT S + 40FT W C/L INT	BY 3697
LAKWOOD (1970)	55.217	L + BN 42FT S C/L SOUTH ST + 15FT E C/L PROD ADENMOOR AVE	BY 3698
LAKWOOD (1970)	55.655	L+BN N EDGE CONC DRWY HSE NO 5933 WOODRUFF AVE 50FT± W C/L	BY 3701
BASELINE (1965)	58.142	L+T 1FT± S CB RET @ SW COR ASHWORTH ST + WOODRUFF AVE	BY 3702
LAKWOOD (1970)	48.497	L+T E CB 28FT± E C/L DOWNEY AVE ON C/L PROD WOLFE ST	BY 4540
LAKWOOD (1970)	47.877	L+BN E CB 1FT± S BCR @ SE COR MICHELSON ST + DOWNEY AVE 38FT S + 32FT E C/L INT	BY 4541
LAKWOOD (1970)	47.110	L+T E CB DOWNEY AVE 28FT± E C/L + 200FT N C/L CANDLEWOOD ST	BY 4542
LAKWOOD (1970)	47.480	L + T 11FT N BCR @ NE COR DOWNEY AVE + CANDLE WOOD ST 80FT N + 32FT E C/L INT	BY 4543
LAKWOOD (1970)	46.814	L + T 11FT S BCR ISLAND SE COR DOWNEY AVE + HARDWICK ST 46FT S + 30FT E C/L INT	BY 4544
LAKWOOD (1970)	47.272	L+T W CB 28FT± W C/L DOWNEY AVE ON C/L PROD YEARLING ST	BY 4545
LAKWOOD (1970)	46.748	L+T 1FT± N BCR @ NE COR DOWNEY AVE + DEL AMO BLVD 49FT N + 30FT E C/L INT	BY 4546
LAKWOOD (1970)	45.895	CS MON IN WELL 12IN DN CTR OF ISLAND 45FT± S C/L DEL AMO BLVD + 32FT± W C/L DOWNEY AVE	BY 4547
LAKWOOD (1970)	46.976	RDBM TAG S CB DEL AMO BLVD 115FT± E C/L OBISPO AVE	BY 4548
LAKWOOD (1970)	46.977	RDBM TAG S CB DEL AMO BLVD 85FT± W C/L OBISPO AVE	BY 4549
BASELINE (1965)	50.012	L+T NR SE COR CONC SLAB @ ENT BLDG NO 5584 PARAMOUNT BLVD 60FT± E C/L PARAMOUNT BLVD + 105FT± S C/L 56TH ST	BY 4565
BASELINE (1965)	51.026	RDBM TAG 1.5FT± E BCR @ NE COR PARAMOUNT BLVD + SOUTH ST 40FT± N + 75FT± E C/L INT	BY 4567
LAKWOOD (1970)	52.703	RDBM TAG E CB SERVICE RD 1FT± N BCR @ NE COR BELLFLOWER BLVD + MICHELSON ST 50FT± N + 80FT± E C/L INT	BY 4957
LAKWOOD (1970)	52.424	L+LS TAG NO 2428 E CB SERVICE RD 2FT± S BCR @ SE COR BELLFLOWER BLVD + MICHELSON ST 43FT± S + 80FT± E C/L INT MKD (TBM EL 52 86)	BY 4958
LAKWOOD (1970)	51.357	RDBM TAG E CB SERVICE RD 1FT± N BCR @ NE COR BELLFLOWER BLVD + HARDWICK ST 80FT± E 45FT± N C/L INT	BY 4959

QUAD-YEAR	ELEV	DESCRIPTION (INCLUDE QUAD AND YEAR IN DESCRIPTION)	BM NUMBER
LAKWOOD (1970)	55.877	RDBM TAG E CB 18FT± S BCR @ SE COR CLARK AVE + HEDDA ST 60FT± S + 28FT± E C/L INT	BY 4960
BASELINE (1965)	57.688	CS MON IN WELL 8IN DN ON SW COR CLARK AVE + ASHWORTH ST 38FT S + 30FT W C/L INT MKD (BM 32 3)	BY 4961
BASELINE (1965)	46.763	RDBM TAG W CB 6FT N BCR OF ISLAND @ NW COR PARAMOUNT BLVD + HARDWICK ST 45FT N + 40FT W C/L INT	BY 4962
BASELINE (1965)	46.925	RDBM TAG W CB 2FT S BCR OF ISLAND @ SW COR PARAMOUNT BLVD + HARDWICK ST 37FT S + 43FT W C/L INT	BY 4963
LAKWOOD (1970)	52.283	RDBM TAG W CB 3FT± N BCR @ NW COR LAKWOOD BLVD + MICHELSON ST 47FT± N + 80FT± W C/L INT	BY 4964
LAKWOOD (1970)	52.137	RDBM TAG W CB 2FT± S BCR @ SW COR LAKWOOD BLVD + MICHELSON ST 49FT± S + 80FT± W C/L INT	BY 4965
LAKWOOD (1970)	50.344	RDBM TAG W CB 3FT± N BCR @ NW COR LAKWOOD BLVD + CANDLEWOOD ST 67FT± N + 55FT± W C/L INT	BY 4966
LAKWOOD (1970)	51.042	L+T S CB 8FT± E BCR @ SE COR LAKWOOD BLVD + CANDLEWOOD ST 30FT± S + 100FT± E C/L INT	BY 4967
LAKWOOD (1970)	49.103	RDBM TAG W CB 1FT± W BCR @ SW COR LAKWOOD BLVD + HARDWICK ST 32FT± N + 62FT± W C/L INT	BY 4968
LAKWOOD (1970)	48.962	RDBM TAG W CB 2FT± S BCR @ SW COR LAKWOOD BLVD + HARDWICK ST 36FT S + 64FT W C/L INT	BY 4969
LAKWOOD (1970)	47.852	L+SPK CONC HDWL 59FT± S + 65FT± W C/L INT LAKWOOD BLVD + DEL AMO BLVD 1FT± SE OF END HDWL	BY 4971
LAKWOOD (1970)	50.850	L+BR W CB 16FT± N BCR @ NW COR LAKWOOD BLVD + ARBOR RD 50FT± N + 50FT± W C/L INT	BY 4972
LAKWOOD (1970)	50.741	L+BR W CB 16FT± S BCR @ SW COR LAKWOOD BLVD + ARBOR RD 50FT± S + 48FT± W C/L INT	BY 4973
LAKWOOD (1970)	49.223	RDBM TAG W CB 5FT± N BCR @ NW COR LAKWOOD BLVD + CENTRALIA ST 45FT± N + 80FT± W C/L INT	BY 4974
LAKWOOD (1970)	49.422	L+BR E CB ISLAND 30FT± S BCR @ SW COR LAKWOOD BLVD + CENTRALIA ST 45FT± W + 60FT± S C/L INT	BY 4975
LAKWOOD (1970)	46.191	RDBM TAG W CB 5FT± N BCR @ NW COR LAKWOOD BLVD + HARVEY WAY 50FT± N + 45FT± W C/L INT	BY 4976
LAKWOOD (1970)	46.047	L+BR W CB 6FT± S BCR @ SW COR LAKWOOD BLVD + HARVEY WAY 50FT± S + 45FT± W C/L INT	BY 4977
LAKWOOD (1970)	46.791	RDBM TAG N CB 3FT± E BCR @ NE COR DEL AMO BLVD + PEARCE AVE 78FT± N + 48FT± E C/L INT	BY 4980
LAKWOOD (1970)	46.536	RDBM TAG N CB 1FT± W BCR @ NW COR DEL AMO BLVD + PEARCE AVE 78FT± N + 46FT± W C/L INT	BY 4981
LAKWOOD (1970)	47.313	L+T S CB 1FT± W BCR @ SW COR CLARK AVE + DEL AMO BLVD 40FT± S + 50FT± W C/L INT	BY 4982
LAKWOOD (1970)	47.164	L+BR IN CHIS SQ 3FT± W BCR @ NW COR CLARK AVE + DEL AMO BLVD 40FT± N + 50FT± W C/L INT	BY 4983
LAKWOOD (1970)	47.909	RDBM TAG N CB 1FT± E BCR @ NE COR DEL AMO BLVD + GRAYWOOD AVE 50FT± N + 65FT± E C/L INT	BY 4984

QUAD-YEAR	ELEV	DESCRIPTION (INCLUDE QUAD AND YEAR IN DESCRIPTION)	BM NUMBER
LAKWOOD (1970)	47.862	RDBM TAG N CB 5FT± W BCR @ NW COR DEL AMO BLVD + GRAYWOOD AVE 40FT± N + 70FT± W C/L INT	BY 4985
LAKWOOD (1970)	45.997	RDBM TAG N CB 5FT± E BCR @ NE COR DEL AMO BLVD + COKE AVE 80FT± N + 48FT± E C/L INT	BY 4986
LAKWOOD (1970)	46.281	RDBM TAG N CB 40FT± W BCR @ NW COR DEL AMO BLVD + COKE AVE 80FT± N + 42FT± W C/L INT	BY 4987
LAKWOOD (1970)	49.178	RDBM TAG N CB 2FT± W BCR @ NW COR DEL AMO BLVD + DUNROBIN AVE 80FT± N + 48FT± E C/L INT	BY 4988
LAKWOOD (1970)	44.408	CS MON IN WELL 30IN DN C/L WOODRUFF AVE 90FT± S C/L DEL AMO BLVD MKD (M L CO 1928)	BY 4989
LAKWOOD (1970)	46.450	L+T E CB 9FT± S BCR @ SE COR DEL AMO BLVD + WOODRUFF AVE 85FT± S + 40FT± E C/L INT MKD (BM)	BY 4990
LAKWOOD (1970)	43.297	RDBM TAG S CB 1FT± W BCR @ SW COR DEL AMO BLVD + MCNAB AVE 80FT± S + 43FT± W C/L INT	BY 4991
LAKWOOD (1970)	43.530	RDBM TAG S CB 1FT± E BCR @ SE COR DEL AMO BLVD + MCNAB AVE 80FT± S + 43FT± E C/L INT	BY 4992
BASELINE (1965)	43.529	CS MON IN WELL 10IN DN ON SW COR DEL AMO BLVD + + PALO VERDE AVE 23FT± W + 85FT± S C/L INT MKD (BM 9-10)	BY 4993
BASELINE (1965)	44.611	L+T E CB 17FT± S BCR @ SE COR DEL AMO BLVD + PALO VERDE AVE 90FT± S + 30FT± E C/L INT MKD (BM)	BY 4994
BASELINE (1965)	38.426	USC+GS BR CAP NR S END E ABUT CONC BRIDGE 50FT± S C/L CARSON ST + 500FT± E CLARK AVE MKD (E 730 RESET 1953)	BY 4996/
BASELINE (1965)	55.214	USC+GS BR CAP E END CONC BRIDGE 1000FT± W LAKWOOD DR NR CTR GOLF COURSE 50FT± N C/L CARSON ST MKD (C780 1946)	BY 5000
BASELINE (1965)	55.249	SP HD BT E END HDWL CONC BRIDGE 1000FT± W LAKWOOD DR NR CTR GOLF COURSE 50FT± S C/L CARSON ST MKD (U)	BY 5001
BASELINE (1965)	56.142	RDBM TAG N CB 1FT± W ENT CATCH BASIN 40FT± N C/L + 25FT± E C/L PROD LEVELSIDE AVE	BY 5002
BASELINE (1965)	55.823	RDBM TAG S CB 40FT± S C/L CARSON ST + 3FT± W C/L PROD LEVELSIDE AVE	BY 5003/
BASELINE (1965)	60.316	RDBM TAG N CB 2FT± E BCR @ NE COR CARSON ST + PARAMOUNT BLVD 40FT± N + 80FT± E C/L INT	BY 5004/
BASELINE (1965)	47.771	L+T S CB 3FT± W BCR @ SW COR PALO VERDE AVE + CANDLEWOOD ST 68FT± W + 38FT± S C/L INT MKD (BM)	BY 5017
BASELINE (1965)	46.652	L+BR W CB 1FT± N BCR @ NW COR PALO VERDE AVE + CARFAX AVE 75FT± N + 30FT± W C/L INT MKD (BM)	BY 5018
BASELINE (1965)	46.618	L+BR E CB 1FT± N BCR @ NE COR PALO VERDE AVE + EBERLE ST 50FT± N + 30FT± E C/L INT MKD (BM)	BY 5019
BASELINE (1965)	38.768	CS MON IN WELL 10IN DN @ OR NR C/L INT PALO VERDE AVE + ARBOR RD USE S EDGE	BY 5020
BASELINE (1965)	41.372	L+BN N CB 73FT± W BCR @ NW COR PALO VERDE AVE + ARBOR RD 138FT± W + 18FT± N C/L INT (ALONG FC R/W) CB MKD (LC 28)	BY 5021

QUAD-YEAR	ELEV	DESCRIPTION (INCLUDE QUAD AND YEAR IN DESCRIPTION)	BM NUMBER
BASELINE (1965)	36.239	CS MON IN WELL 12IN DN @ OR NR C/L INT PALO VERDE AVE + CENTRALIA ST USE W EDGE	BY 5022
BASELINE (1965)	38.168	RD HD SPK S CB (W SIDE BRIDGE NO B950) 140FT# W BCR @ SW COR PALO VERDE AVE + CENTRALIA ST 205FT# W + 18FT# S C/L INT CB MKD (KN 240)	BY 5023A
BASELINE (1965)	35.231	CS MON IN WELL 12IN DN @ OR NR C/L INT PALO VERDE AVE + HARVEY WAY	BY 5024
BASELINE (1965)	36.345	L+BN E CB 1FT# S BCR @ SE COR PALO VERDE AVE + HARVEY WAY 30FT# E + 57FT# S C/L INT	BY 5025
BASELINE (1965)	36.648	RDBM TAG W CB 6FT# N BCR @ NW COR PALO VERDE AVE + CARSON ST 82FT# N + 30FT# W C/L INT	BY 5026
BASELINE (1965)	36.602	RDBM TAG E CB 6FT# N BCR @ NE COR PALO VERDE AVE + CARSON ST 82FT# N + 30FT# E C/L INT	BY 5027
BASELINE (1965)	45.002	CS MON FLUSH W/WLK 2FT# NW CTR CB RET @ NW COR CARSON ST + WOODRUFF AVE 57FT# N + 48FT# W C/L INT MKD (K9 RM NO 3)	BY 5029
BASELINE (1965)	42.264	RDBM TAG S CB OF N SERVICE RD 54FT# N C/L CARSON ST 1500FT# E INT WOODRUFF AVE + CARSON ST OPP ENT TO WATER PUMP HSE	BY 5030
BASELINE (1965)	41.800	RDBM TAG N CB OF N SERVICE RD 82FT# N C/L CARSON ST 1500FT# E INT WOODRUFF AVE + CARSON ST OPP ENT TO WATER PUMP HSE	BY 5031A
LAKWOOD (1970)	55.074	RDBM TAG E CB 1FT# N BCR @ SE COR WOODRUFF AVE + ARABELLA ST 42FT# S + 80FT# E C/L INT	BY 5043
LAKWOOD (1970)	55.413	RDBM TAG 1FT S BCR @ NE COR WOODRUFF AVE + ARABELLA ST 42FT N + 80FT E C/L INT CB MKD KN 352	BY 5044
BASELINE (1965)	56.200	L+T E CB 2FT# S BCR @ SE COR WOODRUFF AVE + ALLINGTON ST 76FT# S + 40FT# E C/L INT MKD (BM)	BY 5045
LAKWOOD (1970)	50.168	RDBM TAG W CB 3FT# N BCR @ NW COR WOODRUFF AVE + CANDLEWOOD ST 53FT# N + 78FT# W C/L INT	BY 5048
LAKWOOD (1970)	49.944	RDBM TAG W CB 1FT# S BCR @ SW COR WOODRUFF AVE + CANDLEWOOD ST 50FT# S + 78FT# W C/L INT	BY 5049
LAKWOOD (1970)	47.540	RDBM TAG W CB 3FT# N BCR @ NW COR WOODRUFF AVE + HARDWICK ST 78FT# W + 53FT# N C/L INT	BY 5050
LAKWOOD (1970)	47.162	RDBM TAG W CB 1FT# S BCR @ SW COR WOODRUFF AVE + HARDWICK ST 50FT# S + 78FT# W C/L INT	BY 5051
BASELINE (1965)	62.699	RDBM TAG 2FT# S BCR @ SW COR PARAMOUNT BLVD + WARWOOD RD 47FT# S + 76FT# W C/L INT	BY 5052
BASELINE (1965)	62.684	RDBM TAG W CB 2FT# N BCR @ NW COR PARAMOUNT BLVD + WARWOOD RD 48FT# N + 76FT# W C/L INT	BY 5053A
BASELINE (1965)	60.701	RDBM TAG W CB 2FT# S BCR @ SW COR PARAMOUNT BLVD + GREENTOP ST 46FT S + 76FT# W C/L INT	BY 5054
BASELINE (1965)	60.418	RDBM TAG W CB 2FT# N BCR @ NW COR PARAMOUNT BLVD + GREENTOP ST 46FT# N + 76FT# W C/L INT	BY 5055
BASELINE (1965)	54.531	RDBM TAG W CB 2FT# N BCR @ NW COR PARAMOUNT BLVD + CENTRALIA ST 47FT# N + 76FT# W C/L INT	BY 5057

QUAD-YEAR	ELEV	DESCRIPTION (INCLUDE QUAD AND YEAR IN DESCRIPTION)	BM NUMBER
BASELINE (1965)	34.107	USGS MON 3.5FT DN 75FT S + 47FT W C/L INT CARSON ST + PALO VERDE AVE 512 SYCAMORE TREES MKD (LBBM 512)	BY 7058
BASELINE (1965)	36.109	CS MON 12IN DN 6FT W OF E CB 46FT N + 25FT E C/L INT PALO VERDE AVE + CENTRALIA ST MKD (BM 9-11 1951 RE 63)	BY 7086
BASELINE (1965)	42.927	L+BN 1FT E BCR @ NW COR CARSON ST + SAN ANSELINE AVE 54FT E + 40FT N C/L INT	BY 7087
BASELINE (1965)	44.234	CS MON FL IN WK 45FT E BCR @ NE COR LAKEWOOD BLVD + CARSON ST 40FT N + 108FT E C/L INT MKD (G 9 A RM NO 6 RE 63)	BY 7088
BASELINE (1965)	49.336	L+T S CB 34FT W C/L PROD OBISPO AVE + 40FT S C/L SOUTH ST	BY 7090
BASELINE (1965)	50.213	RDBM TAG S CB 38FT W BCR @ SW COR SOUTH ST + DOWNEY AVE 40FT S + 97FT W C/L INT	BY 7091
BASELINE (1965)	49.462	L+T E CB 50FT S BCR @ SE COR SOUTH ST + DOWNEY AVE 117FT S + 31FT E C/L INT	BY 7092
BASELINE (1965)	53.314	RDBM TAG W CB 3FT S BCR @ SW COR LAKEWOOD BLVD + SOUTH ST 80FT S + 45FT W C/L INT	BY 7093
BASELINE (1965)	55.141	L+BN W CB SERVICE RD 1FT S BCR @ SW COR HEDDA ST + LAKEWOOD BLVD 47FT S + 89FT W C/L INT	BY 7094
BASELINE (1965)	55.228	L+BRAD W CB SERVICE RD 1FT N BCR @ NW COR LAKE- WOOD BLVD + HEDDA ST 47FT N + 89FT W C/L INT	BY 7095
BASELINE (1965)	56.511	L+BRAD W CB SERVICE RD 5FT N BCR @ SW COR LAKE- WOOD BLVD + ASHWORTH ST 40FT S + 90FT W C/L INT	BY 7096
BASELINE (1965)	56.131	FC BRS CAP FLUSH E CB SE COR LAKEWOOD BLVD + ASHWORTH ST 23FT S + 57FT E C/L INT MKD (FC BM 74-230 1946)	BY 7097
BASELINE (1965)	57.461	L+T N CB 17 W C/L PROD GRAYWOOD AVE 18FT N C/L ASHWORTH ST	BY 7098
BASELINE (1965)	58.574	FC BRS DISC E CB 5FT N BCR @ NE COR ASHWORTH ST + CLARK AVE 47FT N + 28FT E C/L INT MKD (FCBM 120-20D)	BY 7100
BASELINE (1965)	58.188	L+BN CB 17FT W C/L PROD LORELEI AVE 17FT N C/L ASHWORTH ST	BY 7101
BASELINE (1965)	58.149	L + BN 1FT E BCR @ SE COR LORELEI AVE + ASHWORTH ST 17FT S + 42FT E C/L INT	BY 7102
BASELINE (1965)	58.283	L+T N CB C/L PROD DUNROBIN AVE 20FT N C/L ASH- WORTH ST	BY 7103
BASELINE (1965)	58.333	L+BN S CB 1 FT E BCR @ SE COR DUNROBIN AVE + ASHWORTH ST 41FT E + 20FT S C/L INT	BY 7104
BASELINE (1965)	56.423	L+T W CB 3FT S BCR @ SW COR PALO VERDE AVE + ALLINGTON AVE 70FT S + 25FT W C/L INT	BY 7106
BASELINE (1965)	48.699	L+T E CB 8FT N BCR @ NE COR PARAMOUNT BLVD + CANDLEWOOD ST 71FT N + 40FT E C/L INT	BY 7108
BASELINE (1965)	50.835	RDBM TAG E CB 1FT S BCR @ SE COR PARAMOUNT BLVD + SOUTH ST 76FT S + 40FT E C/L INT	BY 7109

QUAD-YEAR	ELEV	DESCRIPTION (INCLUDE QUAD AND YEAR IN DESCRIPTION)	BM NUMBER
BASELINE (1965)	58.947	RDBM TAG 44FT N BCR @ NE COR BELLFLOWER BLVD + ASHWORTH ST 96FT N + 38FT E C/L INT	BY 8756
BASELINE (1965)	46.898	L + BRAD 15FT W BCR IN DEPRESSED CB @ SW COR DEL AMO BL + PARAMOUNT BL 42FT S + 82FT W C/L INT	BY 8775
BASELINE (1965)	47.211	CSBM MON FL @ SW COR DEL AMO BL + PARAMOUNT BL 124FT S + 39FT W C/L INT MKD BM 33-5A 1970	BY 8776
BASELINE (1965)	60.944	RDBM TAG 2FT N BCR @ NW COR CARSON ST + PARAMOUNT BLVD 80FT N + 40FT W C/L INT	BY 8793
BASELINE (1965)	58.441	L + T 2FT N BCR @ NW COR ASHWORTH ST + WOODRUFF AVE 48FT N + 38FT W C/L INT	BY 8798
BASELINE (1965)	57.142	RDBM TAG 1FT S BCR @ SW COR ASHWORTH ST + GRAYWOOD AVE 44FT S + 15FT W C/L INT	BY 8800
BASELINE (1965)	49.187	CITY OF LONG BEACH MON IN WELL 8IN DN @ C/L INT PARAMOUNT BLVD + 55TH WAY	BY 8801
BASELINE (1965)	48.232	RDBM TAG 1FT W BCR @ SW COR PARAMOUNT BLVD + CANDLEWOOD ST 32FT S + 77FT W C/L INT	BY 8802
BASELINE (1965)	55.850	RDBM TAG 7FT S BCR @ SW COR PARAMOUNT BLVD + CENTRALIA AVE 53FT S + 76FT W C/L INT	BY 8803
BASELINE (1965)	44.665	RAMSET 45FT N BCR @ NE COR CARSON ST + LAKEWOOD BLVD 106FT N + 42FT E C/L INT	BY 8804
BASELINE (1965)	38.573	CITY OF LONG BEACH MON FL @ NE COR CLARK AVE + CARSON ST 42FT N + 54FT E C/L INT MKD CLB 553 1970	BY 8805
BASELINE (1965)	42.647	RDBM TAG 1FT W BCR @ NW COR CARSON ST + SAN ANSELINA AVE 40FT N + 45FT W C/L INT	BY 8806
BASELINE (1965)	51.200	RDBM TAG IN SO CB 2FT W/O BCR @ SE COR SOUTH ST + PALO VERDE AVE 42FT S + 65FT E/O C/L INT	BY 8812
BASELINE (1965)	48.006	L + T IN E CB 2FT S/O BCR @ SE COR PALO VERDE AVE + CANDLEWOOD ST 75FT S + 30FT E/O C/L INT	BY 8813
BASELINE (1965)	44.595	LACS MON FL IN C B @ NW COR DEL AMO BLVD + PALO VERDE AVE 43FT N + 103 W C/L INT MKD BM 9-10A 1965	BY 8815
LAKWOOD (1970)	46.601	LACS MON IN WELL 8IN DN @ NE COR CLARK AVE + DEL AMO BLVD 48FT N + 93FT E C/L INT MKD BM 32-78 1961	BY 8816
LAKWOOD (1970)	46.702	LACS MON IN WELL 8IN DN @ NW COR DEL AMO BLVD CLARK AVE 55 N + 45FT W C/L INT MKD BM 32-7A 1961	BY 8817
LAKWOOD (1970)	47.952	LAFC MON FL 4FT S BCR @ SW COR DEL AMO BLVD + LAKEWOOD BL 65FT S + 40FT W C/L INT MKD BM 120- 107 1961	BY 8818
LAKWOOD (1970)	52.688	LACS MON IN WELL 8IN DN @ NE COR CLARK AVE + SOUTH ST 53FT N + 57FT E C/L INT MKD CLEARWATER H 5 RM #2	BY 8819
LAKWOOD (1970)	51.106	RDBM TAG 10FT N BCR @ NE COR CLARK AVE + CANDLEWOOD AVE 73FT N + 32FT E C/L INT	BY 8820
LAKWOOD (1970)	50.080	LACS MON IN WELL 8IN DN @ C/L INT CLARK AVE + CANDLEWOOD AVE	BY 8821

QUAD-YEAR	ELEV	DESCRIPTION (INCLUDE QUAD AND YEAR IN DESCRIPTION)	BM NUMBER
LAKWOOD (1970)	43.032	RD MON IN WELL @ C/L INT CLARK AVE + CENTRALIA STREET	BY 8822
LAKWOOD (1970)	43.847	L AFC MON FL 5FT S BCR @ SE COR CLARK AVE + CENTRALIA ST 50FT S + 28FT E C/L INT MKD BM 120-160 1946	BY 8823
LAKWOOD (1970)	54.653	L AFC MON FL 36FT E BCR @ NE COR BELLFLOWER BL + SOUTH ST 46FT N + 114FT E C/L INT MKD BM 4-503 A 1946	BY 8824
LAKWOOD (1970)	54.555	RDBM TAG 0.5FT W BCR INTO RET @ SE COR BELLFLOWER BL + SOUTH ST 46FT S + 75FT E C/L INT	BY 8825
LAKWOOD (1970)	43.672	RAMSET 25FT S BCR @ SE COR BELLFLOWER BL + CENTRALIA ST ISLAND 60FT S + 40FT E C/L INT	BY 8826
LAKWOOD (1970)	53.439	RDBM TAG 44FT W BCR @ SW COR SOUTH ST + WOODRUFF AVE 40FT S + 116FT W C/L INT	BY 8827
LAKWOOD (1970)	53.423	RDBM TAG 1FT E BCR @ SE COR SOUTH ST + WOODRUFF AVE 40FT S + 76FT E C/L INT	BY 8828
LAKWOOD (1970)	52.822	L + BRAD 38FT N/O SOUTH ST + ON C/L PROD SNOWDEN AVE	BY 8829
LAKWOOD (1970)	57.510	RD HD SPK 4FT W BCR @ SW COR ALLINGTON ST + DUNROBIN AVE 28FT S + 46FT W C/L INT	BY 8830