

COUNTY OF LOS ANGELES
ROAD DEPARTMENT

PRECISE
BENCH MARK LIST



LANCASTER QUAD

1965 ADJUSTMENT

PREFACE

The Road Department level net is composed of more than 1,000 miles of levels supporting in excess of 10,000 bench marks. In 1964-65, a major readjustment of the net was undertaken. To emphasize the complete break with previous elevations, the SY, SG & SL series bench marks have been re-labeled BY, BG & BL, respectively.

To facilitate the adjustment, indexing, and distribution of adjusted values of the net, the County territory was divided into 31 quads or areas. For identification purposes each quad was given a name, viz., "Rosemead," "La Mirada," "Santa Fe," etc. When bench marks and elevations in the Road Department net are used, the name of the quad in which the bench mark is located and the date of the adjustment of the elevation must be included in the bench mark description, e.g.,

BG 1887 —L+BN IN CONC HDWL OF DRAIN PIPE UNDER DR 218 FT
NE +18 FT SE C/L INT GRAND AVE +CAMERON AVE MKD (BM)
(COVINA —1965) ELEV. 696.238

It is expected that this general adjustment will, for the most part, remain sound for the next 8 to 12 years. As new circuits are completed, however, re-adjustment of individual quads may become advisable. It is expected that these subsequent adjustments will be in the nature of a few hundredths of a foot. When a quad is re-adjusted, new elevation lists will be published and the date of the re-adjustment will replace the "1965" at the end of the bench mark description. Two bench marks in the same quad with different adjustment dates will not normally join each other. Since all adjustments taper out to nothing at the periphery of the quad, any bench mark in one quad will join any bench mark in another quad regardless of their respective adjustment dates.

The basic accuracy of the net is reflected by an indicated field probable error of plus or minus 0.012 foot per mile of leveling as determined from 298 conditions of closure. However, many years experience in vertical control in the greater Los Angeles basin and Antelope Valley indicate that because of varying degrees of subsidence and heaving, the true datum is recovered only by obtaining substantial agreement of a number of bench marks.

The users of this net are invited to assist in its maintenance by notifying this Department of cases of obliteration, apparent mistakes in descriptions or elevations, and proven disturbance of bench marks.

DATUM: U. S. Coast and Geodetic Survey Sea Level Datum
of 1929, through the medium of the Los Angeles
County Engineer Precise Level Net, 1963 Adjust-
ment.

K E R N C O U N T Y

L I B E R T Y Q U A D L A N C A S T E R Q U A D

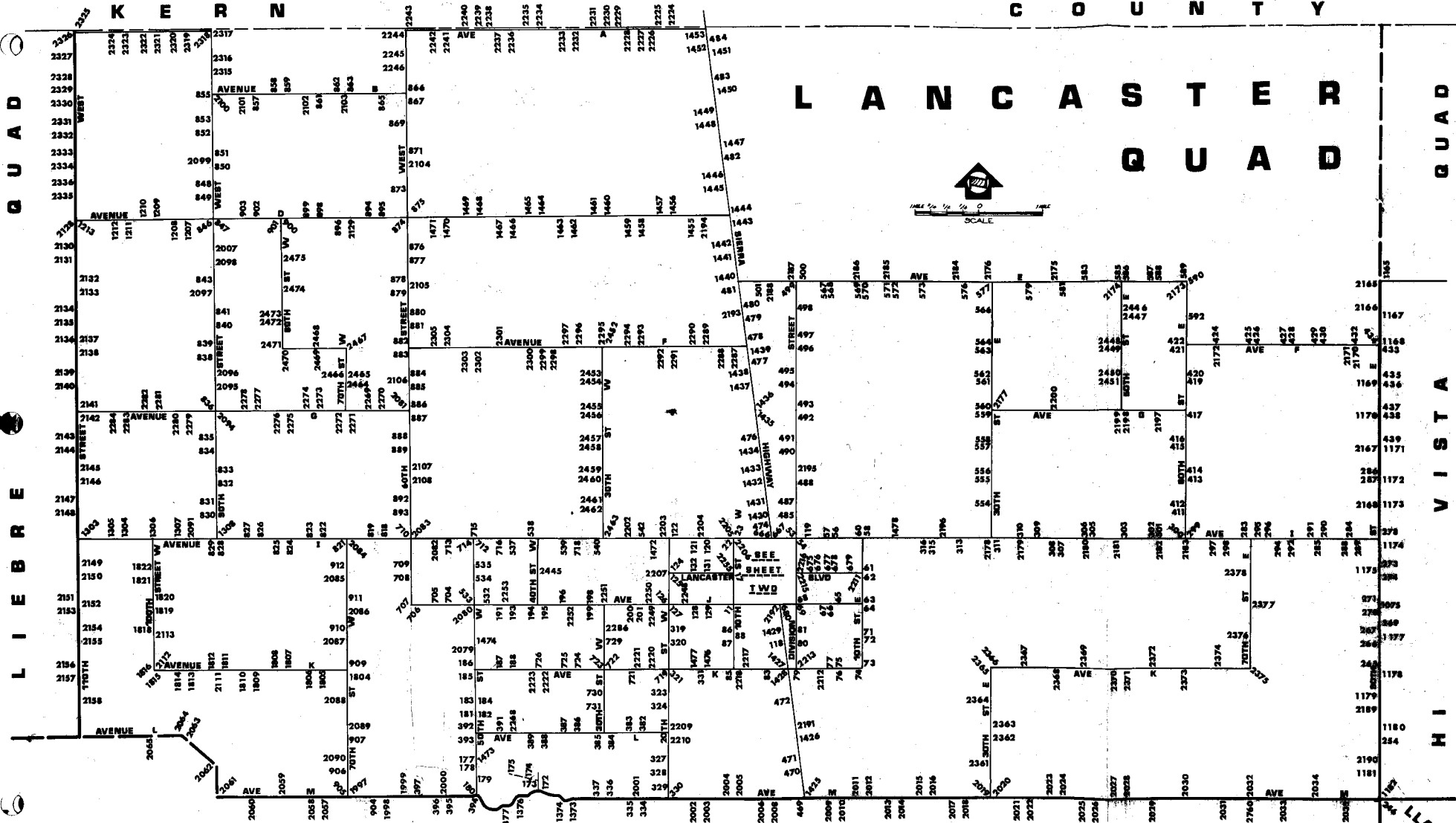

P A L M D A L E Q U A D H I L L A N D Q U A D

QUAD-YEAR	ELEV	DESCRIPTION (INCLUDE QUAD AND YEAR IN DESCRIPTION)	BM NUMBER
LANCASTR (1965)	2360.474	L+T MCR @ SE COR BEECH AVE + NEWGROVE ST 22FT E + 23FT S C/L INT	BL 2
LANCASTR (1965)	2362.101	L+T E CB CEDAR AVE 20FT E C/L + 35FT S C/L NEWGROVE ST	BL 3
LANCASTR (1965)	2365.638	L+BN MCR NW COR CEDAR AVE + OLDFIELD ST 24FT N + 24FT W C/L INT	BL 4
LANCASTR (1965)	2369.096	L+T MCR NW COR CEDAR AVE + PILLSBURY ST 23FT N + 22FT W C/L INT	BL 5
LANCASTR (1965)	2369.349	L+BN W CB 1FT N BCR @ NW COR ELM AVE + AVE J 18FT W + 66FT N C/L INT	BL 7
LANCASTR (1965)	2367.598	WLY L+T S CB AVE J 60FT S C/L ON C/L PROD FERN AVE IN FRONT OF PARK VIEW SCHOOL	BL 9
LANCASTR (1965)	2360.699	L+BN MCR SW COR AVE J + TENTH ST W 57FT S + 50FT W C/L INT	BL 11
LANCASTR (1965)	2354.561	L+T CONC WLK HSE NO 44540 TENTH ST W 5FT FROM FIRST STEP TO FRONT DOOR 52FT E + 81FT N C/L INT 10TH ST W + NORBERRY AVE	BL 14
LANCASTR (1965)	2346.527	L+T IN CONC SLAB 69FT E + 104FT N C/L INT LANCASTER BLVD + TENTH ST W	BL 17
LANCASTR (1965)	2338.946	L+BN W CB 10TH ST W 28FT W C/L 3FT N OF S P/L BLDG 44913 + 570FT S JACKMAN ST 3FT N PP 271449E	BL 18
LANCASTR (1965)	2338.220	L+BN E CB 10TH ST W 28FT E C/L + 86FT N OF N EDGE DRWY BLDG 44902 480FT S JACKMAN ST	BL 19
LANCASTR (1965)	2336.507	L+T IN CB RET 10FT N BCR @ SW COR 10TH ST W + JACKMAN ST 33FT S + 30FT W C/L INT	BL 20
LANCASTR (1965)	2330.775	L+T MCR @ NW COR AVE I + 10TH ST W 50FT N + 39FT W C/L INT	BL 23
LANCASTR (1965)	2332.814	L+T N CB AVE I 40FT N C/L ON C/L PROD FERN AVE	BL 24
LANCASTR (1965)	2335.785	L+T N CB AVE I 40FT N C/L ON C/L PROD ALLEY W OF DATE AVE	BL 25
LANCASTR (1965)	2335.141	L+BN W EDGE CONC DRWY HSE NO 673 31FT W + 75FT N C/L INT ELM AVE + AVE I	BL 26
LANCASTR (1965)	2336.376	L+T N CB AVE I 40FT N C/L ON C/L PROD CEDAR AVE	BL 27
LANCASTR (1965)	2337.147	L+BN E CB CEDAR AVE 6FT S BCR @ SE COR CEDAR AVE + AVE I 41FT S + 18FT E C/L INT	BL 28
LANCASTR (1965)	2342.011	L+T W CB CEDAR AVE 3FT S BCR @ SW COR CEDAR AVE + JACKMAN ST 36FT S + 18FT W C/L INT	BL 29
LANCASTR (1965)	2340.498	L+T W CB DATE AVE 0.5FT N BCR @ NW COR DATE AVE + JACKMAN ST 33FT N + 18FT W C/L INT	BL 30
LANCASTR (1965)	2341.113	L+BN S CB JACKMAN ST 20FT S C/L + 25FT W C/L ALLEY TO S BETWEEN FIG AVE + ELM AVE 5FT W BCR	BL 31

QUAD-YEAR	ELEV	DESCRIPTION (INCLUDE QUAD AND YEAR IN DESCRIPTION)	BM NUMBER
LANCASTR (1965)	2340.566	L+BN S CB JACKMAN ST 6FT W BCR @ SW COR FIG AVE + JACKMAN ST 20FT S + 52FT W C/L INT	BL 32
LANCASTR (1965)	2351.120	L+T CONC STEP HSE NO 45027 N DIVISION ST 295FT N + 54FT W C/L INT KETTERING ST + DIVISION ST	BL 34
LANCASTR (1965)	2348.526	L+BN W CB YUCCA AVE 6FT N BCR @ NW COR YUCCA AVE + KETTERING ST 60FT N + 34FT W C/L INT	BL 38
LANCASTR (1965)	2349.523	L+T CONC BASE FENCE POST 30FT N OF C/L KETTERING ST + 209FT W C/L YUCCA AVE 27FT W OF W EDGE CONC DRWY	BL 39
LANCASTR (1965)	2347.198	L+BRAD E CB SIERRA HWY 30FT E C/L + 25FT N C/L KETTERING ST	BL 40
LANCASTR (1965)	2347.541	L+T IN SW CB RET 26FT S C/L KETTERING ST + 30FT W C/L SIERRA HWY	BL 41
LANCASTR (1965)	2373.107	L+T IN CONC APRON IN NE COR GROCERY STORE @ SW COR NUGENT ST + DIVISION ST 26FT S + 33FT W C/L INT	BL 44
LANCASTR (1965)	2364.936	CS BR CAP MON @ C/L INT OF DIVISION ST + NEWGROVE ST (E EDGE)	BL 47
LANCASTR (1965)	2360.561	CS MON (E EDGE) IN WELL @ C/L INT NEWGROVE ST TO E + TREVOR AVE	BL 49
LANCASTR (1965)	2363.014	L+BN E CB SIERRA HWY 25FT E C/L + 115FT S C/L PROD NEWGROVE ST 16FT S OF END CB	BL 51
LANCASTR (1965)	2362.265	L+T @ MCR SW COR NEWGROVE ST + SIERRA HWY 23FT S + 37FT W C/L INT	BL 52
LANCASTR (1965)	2345.012	L+T @ MCR NW COR AVE I + DIVISION ST 42FT N + 43FT W C/L INT	BL 53
LANCASTR (1965)	2345.125	L+T @ MCR SW COR AVE I + DIVISION ST 42FT S + 44FT W C/L INT	BL 54
LANCASTR (1965)	2354.467	CSBM MON IN CONC FLUSH 1FT N OF N CB + 19FT W BCR @ NW COR 5TH ST E + AVE I 41FT N + 82FT W C/L INT MKD (EM 105-20 1958)	BL 56
LANCASTR (1965)	2354.307	L+T N CB 3FT W BCR 40FT N + 62FT W C/L INT AVE I + 5TH ST E	BL 57
LANCASTR (1965)	2361.266	USC+GS BR CAP IN CONC POST 8IN UP 48FT W E C/L INT AVE I + 10TH ST E MKD (Z1155, OUT)	BL 58
LANCASTR (1965)	2361.272	USC+GS BR CAP 78FT W + 40FT S C/L INT AVE I + 10TH ST E MKD (Y 488 RESET 1961)	BL 60
LANCASTR (1965)	2378.079	CS MON IN WELL 20IN DN @ C/L INT LANCASTER BLVD + 10TH ST E MKD (1/4 COR 14 13 17N R12W)	BL 61
LANCASTR (1965)	2381.417	L+T W EDGE OF CONC DR OF GARAGE TO HSE NO 1016 LANCASTER BLVD 45FT S C/L + 145FT E C/L 10TH ST E	BL 62
LANCASTR (1965)	2397.770	L+T NR MCR @ SW COR 10TH ST E + AVE J 48FT W + 45FT S C/L INT	BL 63

QUAD-YEAR	ELEV	DESCRIPTION (INCLUDE QUAD AND YEAR IN DESCRIPTION)	BM NUMBER
LANCASTR (1965)	2396.742	CS MON IN WELL 18IN DN @ C/L INT AVE J + 10TH ST E MKD (SEC COR 14 13 23 24 T7N R12W)(W EDGE)	BL 64
LANCASTR (1965)	2391.642	CS MON IN WELL @ C/L INT AVE J + 5TH ST E MKD (T7N R12W 1/4 COR 14 23)(E EDGE)	BL 65
LANCASTR (1965)	2385.088	L+BN @ MCR SE COR 4TH ST E + AVE J (SERVICE RD) 80FT S + 24FT E C/L INT	BL 66
LANCASTR (1965)	2384.240	L+BN @ MCR SE COR KIRKLAND AVE + AVE J 75FT S + 27FT E C/L INT	BL 67
LANCASTR (1965)	2382.535	L+BN 1FT W BCR @ SE COR AVE J + DIVISION ST 71FT E + 30FT S C/L INT	BL 68
LANCASTR (1965)	2380.946	CS MON (N EDGE) IN WELL @ C/L INT AVE J + DIVISION ST MKD (15 14 22 23 T7N R12W)	BL 69
LANCASTR (1965)	2413.483	L+T E SIDE 36IN STANDPIPE 215FT W C/L 10TH ST E + 5FT N C/L AVE J-8 263FT NW PP 917614F	BL 71
LANCASTR (1965)	2414.126	CS MON IN WELL 8IN DN @ C/L INT 10TH ST E + AVE J-8 0.5 MI S AVE J MKD (T7N, R12W 1/4 COR, 23-24)(W EDGE)	BL 72
LANCASTR (1965)	2434.632	CS MON IN WELL 15IN DN @ C/L INT 10TH ST E + AVE K MKD (SEC COR 23 24 25 26 T7N R12W)(N EDGE)	BL 73
LANCASTR (1965)	2436.087	CHIS X IN TOP OF BOLT ON S SIDE OF FIRE HYDRANT BASE 50FT W C/L 10TH ST E + 28FT S C/L AVE K	BL 74
LANCASTR (1965)	2425.967	CS MON IN WELL @ C/L INT AVE K + 6TH ST E (W EDGE)	BL 75
LANCASTR (1965)	2426.582	CS MON IN CONC POST 3IN UP 40FT S + 55FT W C/L INT AVE K + 6TH ST E MKD (BM 105-9 1958)	BL 76
LANCASTR (1965)	2425.530	CHIS X IN TOP OF BOLT ON W SIDE OF FIRE HYDRANT BASE 24FT S + 40FT W C/L INT AVE K + 5TH ST E 135FT W DRWY TO HSE 504	BL 77
LANCASTR (1965)	2400.717	L+BN @ MCR @ NE COR DIVISION ST + AVE J-8 28FT N + 41FT E C/L INT	BL 80
LANCASTR (1965)	2399.564	L+BN @ MCR SE COR DIVISION ST + AVE J-7 36FT S + 35FT E C/L INT	BL 81
LANCASTR (1965)	2414.104	CS MON IN WELL 18IN DN @ C/L INT AVE K + 5TH ST W MKD (22 27 T7N R12W)(N SIDE)	BL 83
LANCASTR (1965)	2405.378	L+BN @ NE COR OF SO CAL GAS CO VALVE BOX 44FT N C/L AVE K + 115FT W C/L 10TH ST W	BL 85
LANCASTR (1965)	2380.875	CS MON IN WELL @ C/L INT 10TH ST W + AVE J-8 MKD (1/4 COR 21 22 T7N R12W)(W EDGE)	BL 86
LANCASTR (1965)	2381.124	L+T 1FT N BCR @ NE COR 10TH ST W + AVE J-8 51FT N + 30FT E C/L INT	BL 87
LANCASTR (1965)	2377.361	L+T S CB AVE J-6 1FT E BCR @ SE COR 10TH ST W + AVE J-6 18FT S + 65FT E C/L INT	BL 88
LANCASTR (1965)	2363.653	CS MON IN WELL 8IN DN @ C/L INT OLDFIELD ST + DATE AVE	BL 91

AUG 1968

LOS ANGELES COUNTY ROAD DEPARTMENT
SURVEY SECTION FIELD ENGINEERING DIVISION

PAGE 4

QUAD-YEAR	ELEV	DESCRIPTION (INCLUDE QUAD AND YEAR IN DESCRIPTION)	BM NUMBER
LANCASTR (1965)	2363.934	L+T @ MCR NW COR OLDFIELD ST + DATE AVE 21FT N + 24FT W C/L INT	BL 92
LANCASTR (1965)	2397.623	USC+GS DISK IN CONC 6IN DN 60FT E + 125FT S C/L INT SIERRA HWY + AVE J-8 MKD (S 811 1947 RESET 1955)	BL 118
LANCASTR (1965)	2347.125	USC+GS BRASS DISK IN CONC 4IN UP 65FT E DR TO ANTELOPE VALLEY FAIR 681FT E OF C/L DIVISION ST + 41FT N C/L AVE I MKD (X 488 1955)	BL 119
LANCASTR (1965)	2325.791	L+T IN N SERVICE ROAD CB @ NE COR AVE I + 15TH ST W 51FT E + 80FT N C/L INT	BL 120
LANCASTR (1965)	2325.981	RDBM TAG IN S SERVICE ROAD CB @ SW COR AVE I + 15TH ST W 51FT W + 80FT S C/L INT	BL 121
LANCASTR (1965)	2322.988	CS MON 5IN UP @ NE COR AVE I + 20TH ST W 40FT N + 66FT E C/L INT MKD (BM 102-3 1957)	BL 122
LANCASTR (1965)	2342.607	CS MON IN WELL 12IN DN @ C/L INT AVE J + 20TH ST W MKD (SEC COR 17 16 20 21 R12W T7N) (N EDGE)	BL 126
LANCASTR (1965)	2344.463	RDBM TAG IN N CB @ NE COR AVE J + 20TH ST W 108FT E + 30FT N C/L INT	BL 127
LANCASTR (1965)	2350.130	RDBM TAG 6FT W BCR @ SW COR AVE J + 15TH ST W 66FT W + 30FT S C/L INT	BL 128
LANCASTR (1965)	2350.849	RDBM TAG 40FT S BCR @ SE COR AVE J + 15TH ST W 100FT S + 30FT E C/L INT	BL 129
LANCASTR (1965)	2339.556	L+BN 3FT W OF BCR @ SW COR LANCASTER BLVD + LOWTREE AVE 53FT W + 30FT S C/L INT	BL 131
LANCASTR (1965)	2337.125	L+BN 4FT N BCR @ NE COR LANCASTER BLVD + 15TH ST W 69FT N + 30FT E C/L INT	BL 132
BASELINE (1965)	2494.079	USC+GS DISK IN CONC POST 92FT N + 65FT W C/L INT AVE M + 40TH ST W MKD (F 489 1955)	BL 172
LANCASTR (1965)	2470.430	USC+GS DISK IN CONC POST 106FT W C/L 40TH ST W + 0.1 MI N AVE M 150FT S OF E-W RUNWAY QUARTZ HILL AIRPORT MKD (G 489 1955)	BL 173
LANCASTR (1965)	2453.389	USC+GS DISK IN CONC POST @ QUARTZ HILL AIRPORT WIND INDICATOR 90FT S OF E-W RUNWAY 1120FT S AVE L-8 + 1400FT E 45TH ST W MKD (H 489 1955)	BL 174
LANCASTR (1965)	2461.844	L+T NE COR CONC SLAB 100FT W + 66FT S C/L INT 50TH ST W + AVE L-8	BL 177
LANCASTR (1965)	2477.886	L+T CONC WLK IN FR OF CHURCH 45FT N + 65FT W C/L INT 50TH ST W + AVE L-12	BL 178
LANCASTR (1965)	2485.343	L+T CONC PORCH 50FT W + 45FT N C/L INT 50TH ST W + AVE L-14	BL 179
BASELINE (1965)	2495.229	L+T CONC SLAB NW COR PORCH TO HSE NO 42002 50TH ST W 48FT N + 66FT E C/L INT 50TH ST W + AVE M	BL 180
LANCASTR (1965)	2428.580	L+T NE COR CONC WK HSE NO 42002 50TH ST W 71FT W + 390FT S C/L INT 50TH ST W + AVE K-12	BL 181

OUT

QUAD-YEAR	ELEV	DESCRIPTION (INCLUDE QUAD AND YEAR IN DESCRIPTION)	BM NUMBER
LANCASTR (1965)	2425.267	L+T N CONC DR HSE NO 42958 50TH ST W 44FT E + 60FT S C/L INT 50TH ST W + AVE K-12	BL 182
LANCASTR (1965)	2411.862	2IN IRON PIPE 6IN UP 40FT W OF C/L 50TH ST W ON C/L AVE K-8	BL 183
LANCASTR (1965)	2410.168	CS MON (E EDGE) IN WELL 18IN DN @ C/L INT 50TH ST W + AVE K-8 MKD (1/4 COR 25 26 T7N R13W)	BL 184
LANCASTR (1965)	2380.129	CS MON (W EDGE) IN WELL 12IN DN @ C/L INT 50TH ST W + AVE K MKD (SEC COR 23 24 25 26 T7N R13W)	BL 185
LANCASTR (1965)	2382.382	L+T NW COR CONC PORCH HSE NO 4849 AVE K 115FT E + 120FT N C/L INT AVE K + 50TH ST W	BL 186
LANCASTR (1965)	2378.122	SPK + L E SIDE WIER BOX 375FT N + 25FT W C/L INT AVE K + 45TH ST W	BL 187
LANCASTR (1965)	2376.844	L+T CONC STEP TO BACK OF HSE 425FT N + 85FT W C/L INT AVE K + 45TH ST W	BL 188
LANCASTR (1965)	2350.546	RDBM TAG S SIDE WIER BOX 97FT E + 85FT N C/L INT AVE J + 45TH ST W (TO THE N)	BL 191
LANCASTR (1965)	2347.405	L+T CONC WALK HSE 4320 AVE J 100FT S C/L + 500FT E 45TH ST W TO THE N	BL 193
LANCASTR (1965)	2344.007	ENG TAG + BRAD IN 2IN IP RP TO C/L INT 3IN UP @ SW COR AVE J + 40TH ST W 50FT S + 50FT W C/L INT	BL 194
LANCASTR (1965)	2344.060	CS MON IN WELL 8IN DN @ C/L INT AVE J + 40TH ST W MKD (T7N, R12W 13-18-19-24) USE N EDGE	BL 195
LANCASTR (1965)	2341.697	L+T CONC SLAB IN FRONT OF CHURCH @ NE COR AVE J + 35TH ST W 130FT N + 170FT E C/L INT MKD (BM)	BL 196
LANCASTR (1965)	2342.184	L+T IN SE COR CONC PORCH TO HSE NO 3129 W AVE J 75FT N C/L + 895FT W 30TH ST W	BL 198
LANCASTR (1965)	2341.952	PM IN DIAMOND ON NW QUAD SMH RIM ON C/L AVE J + 500FT W 30TH ST W 385FT E HSE 3129 + 90FT E PP 800770E	BL 199
LANCASTR (1965)	2338.681	CS MON (N EDGE) IN WELL 18IN DN @ C/L INT AVE J + 25TH ST W MKD (1/4 COR 17 20 T7N R12W)	BL 200
LANCASTR (1965)	2340.115	PM IN DIAMOND ON SMH RIM IN THE SW QUAD 15FT N C/L AVE J + 6FT W C/L 25TH ST W	BL 201
BASELINE (1965)	2523.907	CS MON IN WELL @ C/L INT AVE M + 90TH ST E MKD (SEC COR 31 32 5 6 T6N T7N R10W)	BL 246
BASELINE (1965)	2496.483	CS MON IN WELL @ C/L INT AVE L + 90TH ST E MKD (T7N R10W, SEC COR 29,30,31,32)	BL 254
BASELINE (1965)	2473.603	CS MON 30IN DN @ C/L INT AVE K + 90TH ST E MKD (T7N R10W SEC 19 20 29 30)	BL 263
BASELINE (1965)	2455.242	CS MON 30IN DN @ C/L INT AVE J-8 + 90TH ST E MKD (R10W T7N 1/4 SEC 19 20)	BL 266
BASELINE (1965)	2450.692	L+T N END 1ST STEP OF PORCH OF HSE NO 44233 90TH ST E 100FT W C/L + 1000FT S AVE J	BL 269

QUAD-YEAR	ELEV	DESCRIPTION (INCLUDE QUAD AND YEAR IN DESCRIPTION)	BM NUMBER
BASELINE (1965)	2444.714	L+T NR SE EDGE CONC BASE NR CTR OF GAS PUMP ISL 60FT W C/L 90TH ST E + 60FT N C/L AVE J	BL 270
BASELINE (1965)	2442.962	CS MON 15IN DN @ C/L INT 90TH ST E + AVE J MKD (T7N R10W SEC COR 18 17 19 20)	BL 271
BASELINE (1965)	2432.999	L+T NR E EDGE CONC PORCH HSE NO 44709 90TH ST E 79FT W C/L + 2200FT N AVE J 6FT N OF S EDGE PORCH	RL 273
BASELINE (1965)	2426.784	CS MON 20IN DN @ C/L INT 90TH ST E + AVE I-8 MKD (1/4 SEC 17 18 T7N R10W)	BL 274
BASELINE (1965)	2414.157	CS MON 12IN DN @ C/L INT 90TH ST E + AVE I MKD (R10W T7N COR SEC 7,8,17,18)	BL 278
LANCASTR (1965)	2401.814	CS MON IN CONC SQ 2IN UP 3FT S PP NO 991755E 39FT S C/L AVE I + 70FT W C/L 70TH ST E MKD (BM 107-30 1961)	BL 283
LANCASTR (1965)	2412.707	CS MON IN CONC SQ 2IN UP 1FT N TP NO K3143Y 30FT N C/L AVE I + 27FT W C/L PROP 85TH ST E MKD (BM 107-27 1961)	BL 284
LANCASTR (1965)	2414.585	CS MON 2FT S PP NO 991781E 30FT S C/L AVE I + 47FT W C/L 80TH ST E MKD (BM 107-28 1961)	BL 285
BASELINE (1965)	2394.238	CS MON @ C/L INT AVE H + 90TH ST E MKD (R10W T7N COR SEC 5 6 7 8)	BL 286
BASELINE (1965)	2395.698	RDBM TAG @ CTR OF OLD CONC BASE OF MTR MOUNT 40FT W C/L 90TH ST E + 100FT N C/L AVE H	BL 287
LANCASTR (1965)	2410.977	CS MON 18IN DN @ C/L INT AVE I + PROP 85TH ST E MKD (R10W T7N SEC 7 18)	BL 288
LANCASTR (1965)	2412.478	RDBM TAG @ SE COR OF CONC SLAB OF WATER TANK TOWER @ HSE 8359 AVE I 60FT N C/L + 20FT W C/L PROP 85TH ST E	BL 289
LANCASTR (1965)	2417.944	RDBM TAG TOP OF CONC SUPPORT OF LGE WATER TANK 90FT N C/L AVE I + 45FT W C/L 80TH ST F	BL 290
LANCASTR (1965)	2416.137	L+T @ SW COR OF CONC WLK TO HSE NO 7848 AVE I 200FT W C/L 80TH ST E + 80FT N C/L AVE I	BL 291
LANCASTR (1965)	2404.475	L+T W SIDE OF RIM OF 12IN STAND PIPE 50FT E OF C/L 75TH ST E + 53FT N C/L AVE I	BL 292
LANCASTR (1965)	2404.479	CSBM MON FLUSH 25FT S C/L AVE I + 25FT W C/L 75TH ST E 15FT W PP 482159E MKD (BM 107-29 1961)	BL 294
LANCASTR (1965)	2399.808	CS MON IN CONC 2IN UP 33FT S C/L AVE I + 142FT W C/L 65TH ST E 3FT S PP NO 1121124 MKD (BM 107- 31 1961)	BL 297
LANCASTR (1965)	2402.918	RDBM TAG TOP OF CONC WEIR BOX 35FT N C/L AVE I 400FT E OF 65TH ST E 50FT E OF DRWY TO HSE NO 6535 AVE I	BL 298
LANCASTR (1965)	2401.735	L+T E CB DRWY HSE NO 6007 AVE I 40FT N + 100FT E C/L INT E AVE I + 60TH ST E	BL 299

QUAD-YEAR	ELEV	DESCRIPTION (INCLUDE QUAD AND YEAR IN DESCRIPTION)	BM NUMBER
LANCASTR (1965)	2401.637	L+T W CB DRWY HSE NO 6007 AVE I 42FT N + 90FT E C/L INT E AVE I + 60TH ST E	BL 300
LANCASTR (1965)	2394.356	L+T W END CONC GARAGE SLAB HSE NO 5347 AVE I 130FT N + 165FT W C/L INT AVE I + 55TH ST E	BL 301
LANCASTR (1965)	2394.275	L+T S END CONC PORCH HSE NO 5335 AVE I 140FT N + 310FT W C/L INT AVE I + 55TH ST E	BL 302
LANCASTR (1965)	2390.014	L+T W END 1ST STEP HSE NO 5018 AVE I 90FT S + 165FT E C/L INT AVE I + 50TH ST E	BL 303
LANCASTR (1965)	2386.605	2IN IP 1FT ABOVE GROUND 40FT S OF C/L INT AVE I + 45TH ST E (USE E EDGE)	BL 305
LANCASTR (1965)	2384.324	L+T NE COR CONC WLK HSE NO 4359 AVE I 100FT N + 80FT W C/L INT AVE I + 45TH ST E	BL 306
LANCASTR (1965)	2384.441	L+T NE COR CONC WLK HSE NO 4010 AVE I 90FT S + 140FT E C/L INT AVE I + 40TH ST E	BL 307
LANCASTR (1965)	2383.886	CS MON FLUSH (W EDGE) 30FT S + 30FT W C/L INT AVE I + 40TH ST E	BL 308
LANCASTR (1965)	2382.451	L+T SE COR CONC SLAB @ NE COR BLDG NO 3606 AVE I 82FT S C/L + 150FT E C/L 36TH ST E	BL 309
LANCASTR (1965)	2380.377	CS MON IN CONC 2IN UP 2' S OF INT W W D AVE I + 30TH ST E 3FT S OF INT W W D (BM 107-38 1961)	BL 311
LANCASTR (1965)	2376.336	CS MON IN WELL @ C/L INT AVE I + 25TH ST E MKD (T7N, R11W, 1/4 COR 7-18) (E EDGE)	BL 313
LANCASTR (1965)	2373.973	USGS MON W/BR CAP 6IN UP 30FT S + 35FT E C/L INT 20TH ST E + AVE I MKD (LS 11 1929)	BL 315
LANCASTR (1965)	2373.226	L+T SE COR OF CONC APRON OF GAS STA 55FT N C/L AVE I + 65FT W C/L 20TH ST E	BL 316
LANCASTR (1965)	2353.715	L+T IN NW COR OF 4FT SQ CONC SLAB AT NW COR HSE NO 44126 20TH ST W 1700FT S OF AVE J 68FT E OF C/L 20TH ST W	BL 319
LANCASTR (1965)	2414.047	CS BR CAP MON 18IN DN @ C/L INT 20TH ST W + AVE K-8 MKD (1/4 COR SEC 29-28 T7N R12W)	BL 323
LANCASTR (1965)	2418.545	L+T IN CONC SLAB ON SE COR TO HSE NO 43141 20TH ST W 100FT W C/L + 260FT S C/L AVE K-8	BL 324
LANCASTR (1965)	2480.589	L+T IN CONC SLAB IN FRONT OF DOOR TO HSE 42423 20TH ST W 100FT W C/L + 250FT N C/L AVE L-8	BL 327
LANCASTR (1965)	2482.068	CS MON IN WELL 18IN DN @ C/L INT 20TH ST W + AVE L-8 MKD (SEC COR 28 29 32 33 T7N R12W)	BL 328
LANCASTR (1965)	2520.859	RDBM TAG IN NE COR 3FT SQ CONC BASE TO GAS PUMP 200FT N C/L AVE M + 125FT W C/L 20TH ST W	BL 329
BASELINE (1965)	2523.175	USC+GS BRASS DISK IN TOP OF CONC POST 4IN UP 208FT E OF C/L 20TH ST W + 33FT N C/L AVE M MKD (D 489 1955)	BL 330

UNSTABLE

DISTURBED

QUAD-YEAR	ELEV	DESCRIPTION (INCLUDE QUAD AND YEAR IN DESCRIPTION)	BM NUMBER
LANCASTR (1965)	2391.608	CS MON IN WELL 18IN DN @ C/L INT 15TH ST W + AVE K MKD (1/4 SEC 21 28 T7N R12W)	BL 331
BASELINE (1965)	2518.149	CS MON IN WELL 18IN DN @ C/L INT AVE M + 25TH ST W MKD (1/4 COR 32 5 T6N R12W)	BL 334
BASELINE (1965)	2523.287	L+T IN SE COR OF CONC DR TO HSE NO 2524 AVE M 140FT S C/L + 215FT W C/L 25TH ST W	BL 335
BASELINE (1965)	2520.165	USC+GS MON TOP OF CONC POST 4IN UP 300FT E C/L 30TH ST W + 34FT N C/L AVE M 6FT W PP NO 1054594E MKD (E 489 1955)	BL 336
BASELINE (1965)	2514.880	CS MON IN WELL @ C/L INT AVE M + 30TH ST W MKD (SEC COR 31 32 5 6 T7N T6N R12W)	BL 337
LANCASTR (1965)	2448.713	CS MON 24IN DN @ C/L INT OF AVE L + 25TH ST W MKD (1/4 SEC COR 29 32 T7N R12W)	BL 382
LANCASTR (1965)	2448.906	L+T IN BOTTOM STEP @ W EDGE OF CONC STEPS TO HSE NO 2507 AVE L 73FT N C/L + 78FT W C/L 25TH ST W	BL 383
LANCASTR (1965)	2441.201	CS MON 18IN DN @ C/L INT OF AVE L + 30TH ST W MKD (SEC COR 29 30 31 32 T7N R12W)	BL 384
LANCASTR (1965)	2441.238	L+T NE COR CONC DR TO HSE NO 3018 AVE L 75FT S C/L + 195FT W C/L 30TH ST W	BL 385
LANCASTR (1965)	2434.981	L+T NW COR CONC SLAB TO HSE NO 3550 AVE L 65FT S C/L + 139FT E C/L 35TH ST W	BL 386
LANCASTR (1965)	2433.347	CS MON 6IN DN @ C/L INT AVE L + 35TH ST W MKD (1/4 COR SEC 30 31 T7N R12W)(S EDGE)	BL 387
LANCASTR (1965)	2428.377	CS MON 8IN DN @ C/L INT OF AVE L + 40TH ST W MKD (T7N R12W R13W SEC COR 25 30 36 31)(SE EDGE)	BL 388
LANCASTR (1965)	2431.859	L+T IN W EDGE OF 2FT CONC WLK TO APT NO 4012 AVE L 50FT S C/L + 110FT W C/L 40TH ST W	BL 389
LANCASTR (1965)	2428.400	USGS MON @ NW COR AVE L + 45TH ST W 38FT N + 37FT W C/L INT MKD (RESET R49 1942)	BL 391
LANCASTR (1965)	2432.360	L+T IN CONC PORCH OF HSE ON NW COR 50TH ST W + AVE L 109FT N + 232FT W C/L INT MKD (BM)	BL 392
BASELINE (1965)	2491.235	CS MON IN WELL 14IN DN @ C/L INT AVE M + 50TH ST W MKD (SEC COR 35 36 2 1 T7N T6N R13W) (W EDGE)	BL 394
BASELINE (1965)	2496.566	CS MON IN WELL 15IN DN @ C/L INT OF AVE M + 55TH ST W MKD (1/4 COR SEC 35, 2 R-13W T-7N T-6N) USE S EDGE	BL 395
BASELINE (1965)	2500.800	L+T IN CONC WLK TO HSE SW COR AVE M + 55TH ST W 57FT S + 34FT W C/L INT	BL 396
BASELINE (1965)	2513.834	CS MON IN WELL 22IN DN @ C/L INT OF AVE M + 60TH ST W MKD (SEC COR 34 35 3 2 T7N T6N R13W)	BL 397
LANCASTR (1965)	2384.194	CS MON IN WELL 18IN DN @ C/L INT 60TH ST E + AVE H-8 PROP MKD (1/4 SEC COR 11 10 R11W T7N) (S EDGE)	BL 411

QUAD-YEAR	ELEV	DESCRIPTION (INCLUDE QUAD AND YEAR IN DESCRIPTION)	BM NUMBER
LANCASTR (1965)	2387.253	RDBM TAG IN SE COR CONC RESERVOIR @ HSE NO 45609 60TH ST E 110FT W C/L + 55FT N C/L AVE H-8 PROP	BL 412
LANCASTR (1965)	2371.669	CS MON IN WELL 18IN DN @ C/L INT 60TH ST E + AVE H MKD (SEC COR 3 2 10 11 R11W T7N)(S EDGE)	BL 413
LANCASTR (1965)	2361.934	CS MON 18IN DN @ C/L INT 60TH ST E + AVE G-8 MKD (1/4 SEC COR 3 2 R11W T7N)(N EDGE)	BL 415
LANCASTR (1965)	2363.220	L+T NR S EDGE OF CONC WK TO HSE NO 46415 60TH ST E 130FT W C/L + 145FT N C/L AVE G-8 MKD (SLBM)	BL 416
LANCASTR (1965)	2353.313	CS MUN 16IN DN @ C/L INT 60TH ST E + AVE G MKD (SEC COR 34 35 3 2 R11W T8N)	BL 417
LANCASTR (1965)	2346.467	L+T IN CONC FENCE POST @ SE COR 60TH ST E + AVE F-8 20FT S + 22FT E C/L INT MKD (SLBM)	BL 419
LANCASTR (1965)	2344.844	CS MON @ C/L INT 60TH ST E + AVE F-8 MKD (1/4 SEC COR 34 35 R11W T8N)(W EDGE)	BL 420
LANCASTR (1965)	2337.475	RD MON 8IN DN @ SW COR AVE F + 60TH ST E 47FT W + 25FT S C/L INT	BL 422
LANCASTR (1965)	2339.878	RD MON IN WELL WITH COVER @ NE COR 65TH ST E + AVE F 24FT N + 42FT E C/L INT 4FT E GUY POLE NO 627428E	BL 424
LANCASTR (1965)	2344.134	RD MON IN WELL W/COVER 8IN DN @ NW COR AVE F + 70TH ST E 34FT N + 25FT W C/L INT 4FT N OF PP NO 373290E	BL 425
LANCASTR (1965)	2343.700	CS MON 16IN DN @ C/L INT AVE F + 70TH ST E MKD (SEC COR 26 25 35 36 R11W T8N)(N EDGE)	BL 426
LANCASTR (1965)	2348.784	L+T IN CONC FTG OF 36IN STAND-PIPE 40FT N C/L AVE F + 31FT W C/L 75TH ST E PROP MKD (SLBM)	BL 427
LANCASTR (1965)	2345.945	CS MON 30IN DN @ C/L INT AVE F + 75TH ST E MKD (1/4 SEC COR 25 36 R11W T8N)(N EDGE)	BL 428
LANCASTR (1965)	2350.730	L+T IN CONC MOTOR PAD @ NW COR AVE F + 80TH ST E PROP 50FT N + 100FT W C/L INT MKD (SLBM)	BL 429
LANCASTR (1965)	2349.178	CS MON @ C/L INT AVE F + 80TH ST E MKD (SEC COR 25 30 36 31 R10W R11W T8N)(E EDGE)	BL 430
LANCASTR (1965)	2351.163	BT SPK IN 2IN IP IN CONC 28IN DN @ C/L INT AVE F + 85TH ST E PROP	BL 432
BASELINE (1965)	2355.879	L+T CONC FOUNDATION OF WATER TOWER 6FT W + 1.5FT N OF SE COR @ NW COR 90TH ST E + AVE F 45FT N + 95FT W C/L INT MKD (SLBM)	BL 433
BASELINE (1965)	2355.517	CS MON 12IN DN @ C/L INT 90TH ST E + AVE F MKD (SEC COR 30 29 31 32 R10W T8N)(E EDGE)	BL 434
BASELINE (1965)	2366.889	L+T 1ST STEP OF CONC PORCH OF APT UNIT NO 47205 @ THE NW COR 90TH ST E + AVE F-8 140FT W + 70FT N C/L INT	BL 435
BASELINE (1965)	2366.188	2IN IP WITH CONC PLUG + BT SPK @ C/L INT 90TH ST E + AVE F-8	BL 436

QUAD-YEAR	ELEV	DESCRIPTION (INCLUDE QUAD AND YEAR IN DESCRIPTION)	BM NUMBER
BASELINE (1965)	2374.042	CS MON IN WELL 15IN DN @ C/L INT 90TH ST E + AVE G MKD (SEC COR 31 32 6 5 R10W T8N T7N)	BL 437
BASELINE (1965)	2375.376	RD MON IN WELL WITH CONC COLLAR @ SE COR 90TH ST E + AVE G 30FT E + 40FT S C/L INT	BL 438
BASELINE (1965)	2386.416	2IN IP IN CONC WITH BR CAP ON C/L AVE G-8 30FT W C/L 90TH ST E MKD (WC SEC 6 R10W T7N)	BL 439
BASELINE (1965)	2528.029	USC+GS MON 6IN UP 35FT S C/L AVE M + 87FT W C/L W RDWY SIERRA HWY MKD (FF 487 1955)	BL 469
LANCASTR (1965)	2497.852	USC+GS MON 3IN UP 60FT E C/L SIERRA HWY OPP BLDG 42445 44FT W C/L SPRR + 2200FT S AVE L MKD (U 811 1947)	BL 470
LANCASTR (1965)	2486.637	USC+GS MON 12IN DN 60FT E C/L SIERRA HWY OPP BLDG 42607 43FT W C/L SPRR + 1250FT S AVE L MKD (B 57 RESET 1955)	BL 471
LANCASTR (1965)	2447.474	USC+GS MON 3IN UP 59FT E C/L SIERRA HWY 45FT W C/L SPRR + 75FT N C/L PROP AVE K-8 200FT W OF L A CO WATERWORKS DIST 4 WELL 8 STORAGE TANK MKD (T 811 1947)	BL 472
LANCASTR (1965)	2361.487	USC+GS MON 5IN UP IN LUMBER YD @ 44701 YUCCA AVE 310FT W + 185FT N C/L INT YUCCA AVE + NEWGROVE ST 85FT SE SEMAPHORE 4057 + 3FT S TP MKD (G 487 1955)	BL 473
LANCASTR (1965)	2333.641	BR CAP MON ON 3IN IP 8IN UP IN A V PLUMBING SUPPLY YD @ 45358 SIERRA HWY 161FT E C/L + 1100FT N AVE I 120FT SE OF STUCCO BLDG MKD (2335 B 1902)	BL 474
LANCASTR (1965)	2318.029	USC+GS MON S EDGE HDWL CULV G90+50 25FT W C/L SIERRA HWY + 1.6MI N AVE I MKD (Z 811 1947)	BL 476
LANCASTR (1965)	2306.003	USC+GS MON 10IN UP 34FT E C/L SIERRA HWY + 1450FT S AVE F MKD (Y 56 1926)	BL 477
LANCASTR (1965)	2302.704	BR CAP MON ON 3IN IP 8IN UP 85FT E C/L SIERRA HWY + 800FT N AVE F MKD (2302 B 1902 33)	BL 478
LANCASTR (1965)	2304.834	BRASS TRI STA MON 15IN UP 227FT W C/L SIERRA HWY + 2200FT N AVE F MKD (OBAN 1929 LINT)	BL 479
LANCASTR (1965)	2302.086	BRASS REF MON 8IN UP 227FT W C/L SIERRA HWY + 2280FT N AVE F MKD (OBAN NO 2 1941)	BL 480
LANCASTR (1965)	2301.443	USC+GS MON FLUSH W END S CONC ABUT OF RR BRIDGE 73FT N C/L AVE E + 121FT E C/L SIERRA HWY MKD (H 487 1955)	BL 481
LANCASTR (1965)	2304.303	USC+GS MON FLUSH TOP OF E END OF S CONC ABUT OF SPRR BRIDGE 88FT N C/L AVE C + 141FT E C/L SIERRA HWY MKD (J 487 1955)	BL 482
LANCASTR (1965)	2305.916	USC+GS MON FLUSH S END W HDWL CULV UNDER SPRR 35FT N C/L AVE B + 122FT E C/L SIERRA HWY MKD (N 487 1955)	BL 483
LANCASTR (1965)	2307.929	USC+GS MON FLUSH N END HDWL OF SPRR CULV 123FT E C/L SIERRA HWY + 175FT S C/L AVE A (KERN CO LINE) MKD (M 487 1955)	BL 484

QUAD-YEAR	ELEV	D E S C R I P T I O N (INCLUDE QUAD AND YEAR IN DESCRIPTION)	BM NUMBER
LANCASTR (1965)	2334.804	RDBM TAG E CB 60FT S BCR @ SE COR DIVISION ST + AVE H-8 20FT E + 135FT S C/L INT	BL 485
LANCASTR (1965)	2333.044	CS MON (N EDGE) IN WELL 18IN DN @ C/L INT AVE H-8 + DIVISION ST MKD (1/4 SEC COR 10 11 T7N R12W)	BL 487
LANCASTR (1965)	2333.924	CS MON 12IN DN @ C/L INT DIVISION ST + AVE H MKD (SEC COR 3-2 10-11 T7N R12W) USE W EDGE	BL 488
LANCASTR (1965)	2328.314	L+T NW COR CONC WALK BLDG NO 46350 @ SE COR OF DIVISION ST + AVE G8 (PROP) 205FT S + 45FT E OF C/L INT	BL 490
LANCASTR (1965)	2326.308	CS BR CAP MON 24IN DN @ C/L INT OF AVE G8 PROP + DIVISION ST MKD (1/4 SEC COR 2-3 T7N R12W)	BL 491
LANCASTR (1965)	2323.231	2IN IP WITH CONC PLUG 12IN UP @ SE COR DIVISION ST + AVE G 35FT S + 35FT E OF C/L INT USE E EDGE	BL 492
LANCASTR (1965)	2321.121	CS BR CAP MON IN WELL 15IN DN @ C/L INT DIVISION ST + AVE G MKD (SEC COR 34-35-3-2 T8N T7N R12W)	BL 493
LANCASTR (1965)	2315.669	L+T @ NE COR CONC SLAB @ SIDE ENT N SIDE OF HSE NO 47159 DIVISION ST 100FT W C/L + 80FT S C/L AVE F-8	BL 494
LANCASTR (1965)	2315.416	L+T @ NE COR CONC SLAB @ SIDE ENT ON N SIDE OF HSE NO 47205 DIVISION ST 100FT W C/L + 115FT N C/L AVE F-8	BL 495
LANCASTR (1965)	2308.922	L+T CONC WK TO HSE NO 47547 DIVISION ST @ SW COR OF AVE F 82FT W + 185FT S OF C/L INT MKD (SL BM)	BL 496
LANCASTR (1965)	2307.006	CS MON 14IN DN @ C/L INT OF AVE F + DIVISION ST MKD (SEC COR 26-27 34-35 R12W T8N) (E EDGE)	BL 497
LANCASTR (1965)	2301.617	CS BR CAP MON 14IN DN @ C/L INT AVE E-8 + DIVISION ST MKD (26-27 R12W T8N)	BL 498
LANCASTR (1965)	2296.258	RD DEPT BM MON IN WELL 6IN DN @ SW COR DIVISION ST + AVE E 27FT W + 51FT S C/L INT 4 FT WLY PP NO 306431E	BL 499
LANCASTR (1965)	2294.708	CS MON (NE EDGE) IN WELL 18IN DN @ C/L INT AVE E + DIVISION ST MKD (SEC COR 22 23 26 27 R12W T8N)	BL 500
LANCASTR (1965)	2296.463	CS MON 14IN DN ON C/L AVE E 2677FT W OF DIVISION ST MKD (T8N 22-27 R12W 1/4 COR) (N EDGE)	BL 501
LANCASTR (1965)	2349.025	RDBM TAG CONC SLAB NR 36IN STANDPIPE 40FT N C/L AVE J + 640FT E 50TH ST W	BL 532
LANCASTR (1965)	2348.276	CS MON IN WELL 20IN DN @ C/L INT AVE J + 50TH ST W MKD (SEC COR 14 13 23 24 T7N R13W)	BL 533
LANCASTR (1965)	2338.119	2IN IP 6IN DN 50FT S + 50FT E C/L INT 50TH ST W + AVE I-8	BL 534
LANCASTR (1965)	2338.017	2IN IP 6IN DN 50FT N + 50FT E C/L INT 50TH ST W + AVE I-8	BL 535

AUG 1968

LOS ANGELES COUNTY ROAD DEPARTMENT
SURVEY SECTION FIELD ENGINEERING DIVISION

PAGE 12

QUAD-YEAR	ELEV	DESCRIPTION (INCLUDE QUAD AND YEAR IN DESCRIPTION)	BM NUMBER
LANCASTR (1965)	2329.964	CS MON IN TOP 12IN CONC POST 5IN UP 89FT N C/L AVE I + 30FT E C/L 45TH ST W MKD (BM 102-9 1957)	BL 537
LANCASTR (1965)	2328.386	USC+CS MON 12IN UP 36FT W C/L 40TH ST W + 147FT S C/L AVE I 33FT E OF E SIDE HSE 4011 MKD (LINT ALKALI 1929)	BL 538
LANCASTR (1965)	2318.474	CS MON TOP 12IN CONC POST 6IN UP 42FT N C/L AVE I + 63FT E C/L 35TH ST W 39FT E OF DRWY HSE 3355 + 25FT W PP 865024E MKD (BM 102-7 1957)	BL 539
LANCASTR (1965)	2318.273	L+PK TOP NW COR N HDWL OF BRIDGE NO 53-406 40 ²² FT N C/L AVE I + 100FT E C/L 30TH ST W	BL 540
LANCASTR (1965)	2317.698	CS MON TOP CONC POST 4IN UP 86FT N C/L AVE I + 2FT W C/L 25TH ST W 4FT S PP 1162700E MKD (BM 102-5 1957)	BL 542
LANCASTR (1965)	2309.160	CS MON 12IN DN @ C/L INT 30TH ST E + AVE H-8 MKD (1/4 COR 7-8 T7N R11W)(E EDGE)	BL 554
LANCASTR (1965)	2362.121	2IN IP 50FT E C/L 30TH ST E + 50FT S C/L AVE H USE SW RIM	BL 555
LANCASTR (1965)	2359.767	CS MON 6IN DN @ C/L INT 30TH ST E + AVE H MKD (SEC COR 5-6-7-8 T7N R11W) USE S EDGE	BL 556
LANCASTR (1965)	2353.671	2IN IP 50FT E C/L 30TH ST E + 50FT S C/L AVE G-3 USE SE RIM	BL 557
LANCASTR (1965)	2350.707	CS MON 8IN DN @ C/L INT 30TH ST E + AVE G-8 MKD (1/4 SEC COR 6-7 T7N R11W) USE S EDGE	BL 558
LANCASTR (1965)	2344.585	2IN IP 50FT E C/L 30TH ST E + 50FT S C/L AVE G USE S EDGE	BL 559
LANCASTR (1965)	2343.646	CS MON 3IN DN @ C/L INT 30TH ST E + AVE G MKD (31-32-5-6 T7N R11W) USE SW EDGE	BL 560
LANCASTR (1965)	2335.284	CS MON 12IN DN @ C/L INT 30TH ST E + AVE F-8 MKD (1/4 COR 31-32 T8N R11W)(S EDGE)	BL 561
LANCASTR (1965)	2336.588	2IN IP 50FT E C/L 30TH ST E + 50FT N C/L AVE F-8 USE NE RIM	BL 562
LANCASTR (1965)	2328.958	2IN IP 50FT E C/L 30TH ST E + 50FT S C/L AVE F	BL 563
LANCASTR (1965)	2327.617	CS MON 15IN DN @ C/L INT 30TH ST E + AVE F MKD (29-30-31-32 T8N R11W) USE E EDGE	BL 564
LANCASTR (1965)	2319.381	CS MON (E EDGE) IN WELL 15IN DN @ C/L INT 30TH ST E + AVE E-8 MKD (1/4 COR 29 30 T8N R11W)	BL 566
LANCASTR (1965)	2297.538	RD MON IN WELL 8IN DN 5FT S PP NO 1270585E 36FT S C/L AVE E + 240FT W C/L 5TH ST E PROP	BL 567
LANCASTR (1965)	2297.673	CS MON (E EDGE) IN WELL @ C/L INT AVE E + PROP 5TH ST E MKD (1/4 COR 23 26 T8N R12W)	BL 568
LANCASTR (1965)	2301.019	CS MON (N EDGE) IN WELL 18IN DN @ C/L INT AVE E + 10TH ST E PROP MKD (SEC COR 23 24 25 26 T8N R12W)	BL 569

QUAD-YEAR	ELEV	DESCRIPTION (INCLUDE QUAD AND YEAR IN DESCRIPTION)	BM NUMBER
LANCASTR (1965)	2302.729	RD MON IN WELL 8IN DN 6FT S PP NO 1270596E 36FT S C/L AVE E 70FT E C/L 10TH ST E (PROPOSED)	BL 570
LANCASTR (1965)	2303.502	RD MON IN WELL 8IN DN 5FT S PP NO 1270605E 40FT S C/L AVE E 240FT W C/L 15TH ST E (PROPOSED)	BL 571
LANCASTR (1965)	2303.060	CS MON 30IN DN @ C/L INT AVE E + 15TH ST E MKD (1/4 COR 24-25 T8N R12W)(W EDGE)	BL 572
LANCASTR (1965)	2307.391	CS MON 24IN DN @ C/L INT AVE E + 20TH ST E MKD (SEC COR 19-24-25 T8N R11W R12W)	BL 573
LANCASTR (1965)	2310.750	RD MON IN WELL 8IN DN 6FT S PP NO 1270627E 39FT S C/L AVE E + 225FT E C/L 25TH ST E PROP	BL 576
LANCASTR (1965)	2312.221	2IN IP 50FT E C/L 30TH ST E + 50FT S C/L AVE E USE N RIM	BL 577
LANCASTR (1965)	2313.874	RD MON IN WELL 8IN DN 5FT S PP NO 1270648E 28FT S C/L AVE E 260FT W C/L 35TH ST E (PROPOSED)	BL 579
LANCASTR (1965)	2316.199	RD MON IN WELL 8IN DN 5FT S PP NO 1273708E 30FT S C/L AVE E + 250FT W C/L 40TH ST E (PROPOSED)	BL 581
LANCASTR (1965)	2314.797	CS MON IN WELL 18IN DN @ C/L INT AVE E + 45TH ST E (PROPOSED) MKD (1/4 COR 21-28 T8N R11W) USE N EDGE	BL 583
LANCASTR (1965)	2317.266	CS MON IN WELL 8IN DN @ C/L INT AVE E + 50TH ST E MKD (SEC COR 21-22-27-28 T8N R11W) USE N EDGE	BL 585
LANCASTR (1965)	2318.779	2IN IP 50FT E C/L 50TH ST E + 50FT N C/L AVE E USE N EDGE PUNCH MARK	BL 586
LANCASTR (1965)	2321.390	CS MON IN WELL 8IN DN @ C/L INT AVE E + 55TH ST E MKD (1/4 COR 22 27 R11W T8N)(N EDGE)	BL 587
LANCASTR (1965)	2322.563	L+T IN CONC STANDPIPE 33FT N C/L AVE E + 40FT W C/L 55TH ST E MKD (BM)	BL 588
LANCASTR (1965)	2322.176	CS MON IN WELL 8IN DN @ C/L INT AVE E + 60TH ST E MKD (SEC COR 22-23-26-27 T8N R11W) USE N EDGE	BL 589
LANCASTR (1965)	2322.429	L+T IN CONC SLAB OF GARAGE TO HSE ON NW COR AVE E + 60TH ST E 65FT W + 145FT N C/L INT MKD (BM)	BL 590
LANCASTR (1965)	2330.793	L+T CONC PUMP BASE 35FT N C/L AVE E + 170FT E C/L 60TH ST E MKD (BM)	BL 592
LANCASTR (1965)	2339.580	L+T 4FT E BCR 38FT N C/L AVE I 50FT E C/L SIERRA HWY	BL 666
LANCASTR (1965)	2338.667	CSBM MON 64FT N C/L AVE I + 168FT E C/L SIERRA HWY MKD (BM 101-132 1957)	BL 667
LANCASTR (1965)	2342.150	L+T 5FT E OF W END CONC PUMP ISL 50FT E C/L TREVOR AVE 60FT S C/L AVE I	BL 668
LANCASTR (1965)	2341.815	L+T N CB (DEP) 24FT E C/L SPEARMAN AVE + 40FT N C/L AVE I	BL 669
LANCASTR (1965)	2356.991	L+T 10FT W BCR @ NW COR DIVISION ST + LANCASTER BLVD FROM W 30FT N + 44FT W C/L INT	BL 671