

COUNTY OF LOS ANGELES
ROAD DEPARTMENT

PRECISE
BENCH MARK LIST



T

LANCASTER QUAD

1975 ADJUSTMENT

P R E F A C E

The Road Department level net is composed of more than 1,500 miles of levels supporting in excess of 18,000 bench marks. In 1975, a major readjustment of the net was undertaken. To emphasize the complete break with previous elevations, the BY,BG & BL series bench marks have been relabeled CY,CG & CL, respectively.

To facilitate the adjustment, indexing, and distribution of adjusted values of the net, the County territory is divided into 34 quads or areas. For identification purposes each quad is given a name, viz., "Rosemead," "La Mirada," "Santa Fe," etc. When bench marks and elevations in the Road Department net are used, the name of the quad in which the bench mark is located and the date of the adjustment of the elevation must be included in the bench mark description, e.g.,

CG 6234 --L+BN IN CONC HDWL OF DRAIN PIPE UNDER DR 218 FT
NE+18 FT SE C/L INT GRAND AVE + CAMERON AVE MKD (BM)
(COVINA --1975) ELEV. 696.238

Experience indicates that this general adjustment will, for the most part, remain sound for the next 10 years. Updating constrained adjustments will be made in 5 years. It is expected that these updating adjustments will be in the nature of a few hundredths of a foot. When a quad is readjusted, new elevation lists will be published and the date of the readjustment will replace the "1975" at the end of the bench mark description. Two bench marks with different adjustment dates will not normally agree with each other.

The basic accuracy of the net is reflected by an indicated field probable error of plus or minus 0.012 foot per mile of leveling as determined from over 600 conditions of closure. However, many years experience in vertical control in the greater Los Angeles basin and Antelope Valley indicate that because of varying degrees of subsidence and heaving, the true datum is recovered only by obtaining substantial agreement of a number of bench marks.

The users of this net are invited to assist in its maintenance by notifying this Department of cases of obliteration, apparent mistakes in descriptions or elevations, and proven disturbance of bench marks.

DATUM: U. S. Coast and Geodetic Survey Sea Level Datum
of 1929, through the medium of the Los Angeles
County Engineer Precise Level Net.

ABBREVIATIONS USED IN BENCH MARK LISTINGS

ABUT - - - - -	Abutment	EC - - - - -	End of Curve
ALG - - - - -	Along	ENT - - - - -	Entrance
ANG PT - - - - -	Angle Point	FL - - - - -	Floor
B/W - - - - -	Back of Walk	FTG - - - - -	Footing
BCR - - - - -	Beginning of Curb Return	F/W - - - - -	Front of Walk
BC - - - - -	Beginning of Curve	GAR - - - - -	Garage
BLDG - - - - -	Building	HDWL - - - - -	Headwall
BM - - - - -	Bench Mark	HSE - - - - -	House
BT SPK - - - - -	Boat or Bolt Spike	INT - - - - -	Intersection
BR CAP - - - - -	Brass or Bronze Cap	IP - - - - -	Iron Pipe
C B - - - - -	Catch Basin	LT - - - - -	Left
CTR - - - - -	Center	LACE - - - - -	L. A. City Engineer
C/L - - - - -	Center Line	LACS - - - - -	L. A. County Engineer
C/L INT - - - - -	Center Line Intersection	LAFC - - - - -	L. A. Co. Flood Control
C/L PROD - - - - -	Center Line Produced	L+BN - - - - -	Lead and Bench Nail
CONC - - - - -	Concrete	L+BR - - - - -	Lead and Brad
COR - - - - -	Corner	L+N - - - - -	Lead and Nail
COE - - - - -	Corps of Engineers	L+RDEM TAG - - - - -	Lead and Road Dept. Bench Mark Tag
CULV - - - - -	Culvert	L+SPK - - - - -	Lead and Spike
CB - - - - -	Curb	L+T - - - - -	Lead and Tack
CS MON - - - - -	County Engineer Monument	MCR - - - - -	Middle of Curb Return
CS BR CAP - - - - -	County Engineer Brass Cap	MKD - - - - -	Marked
CT SPK - - - - -	Cut Spike	MC - - - - -	Middle of Curve
DR - - - - -	Drive or Driveway	MON - - - - -	Monument
E/O - - - - -	East of	N/O - - - - -	North of
ECR - - - - -	End of Curb Return	NR - - - - -	Near

ABBREVIATIONS USED IN BENCH MARK LISTINGS . . . CONTINUED

OPP - - - - - Opposite
PI - - - - - Point of Intersection
PK+W - - - - - PK Nail and Washer
P/L - - - - - Property Line
POST - - - - - Point on Semi-Tangent
PP - - - - - Power Pole
PVMT - - - - - Pavement
PROD - - - - - Produced
RD - - - - - Road
RDEM - - - - - Road Dept. Bench Mark
RR - - - - - Railroad
RT - - - - - Right
R/W - - - - - Right of Way
SDMH - - - - - Storm Drain Manhole
SMH - - - - - Sewer Manhole
SPK - - - - - Spike
ST+W - - - - - Spike Tin and Washer
S/O - - - - - South of
TP - - - - - Telephone Pole
USC+GS - - - - - U. S. Coast and Geodetic Survey
USGS - - - - - U. S. Geological Survey
WK - - - - - Walk
W/O - - - - - West of

K E R N AVE

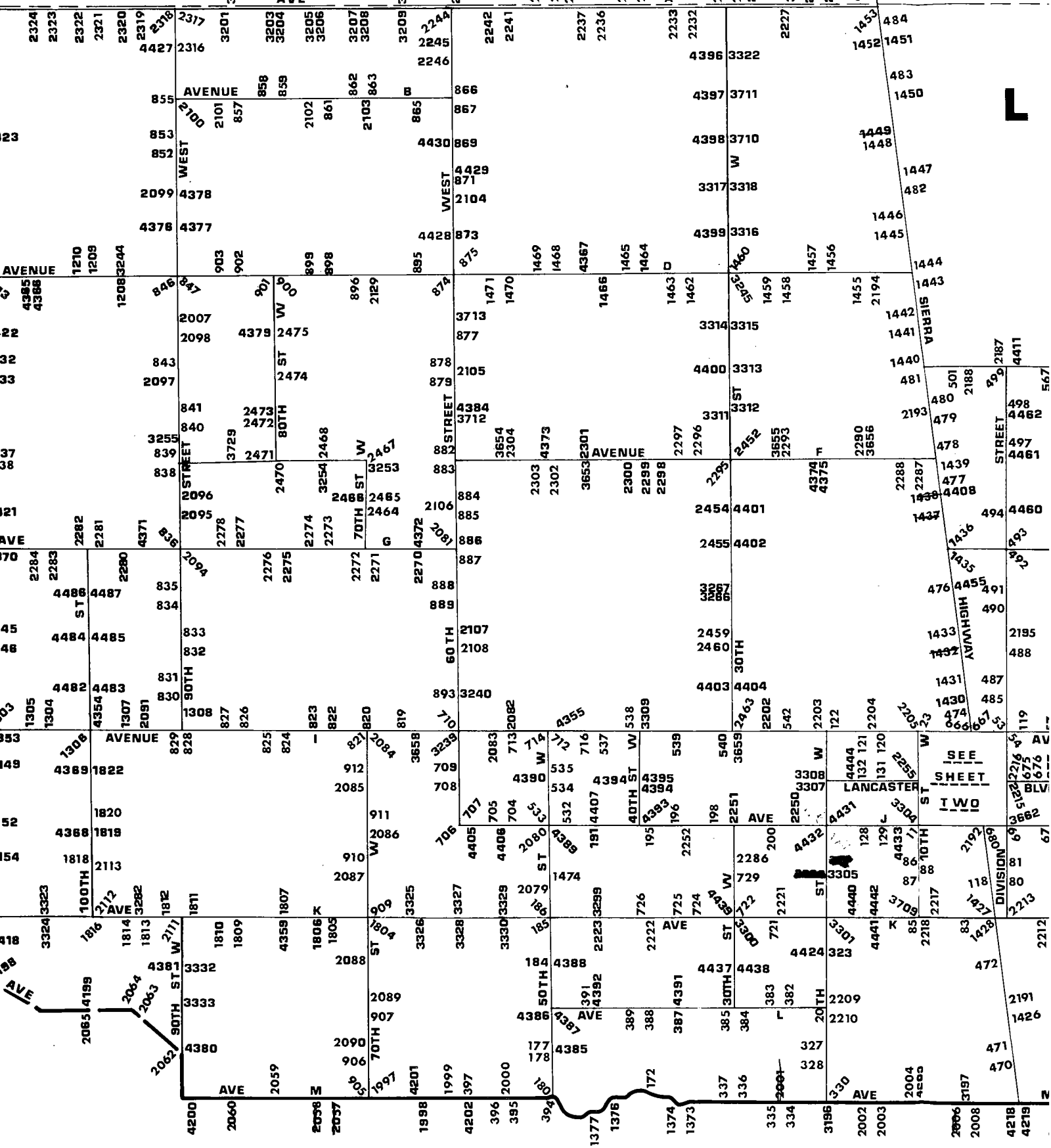

P A L M D A L E

LANCASTER QUAD

(SHEET 2)

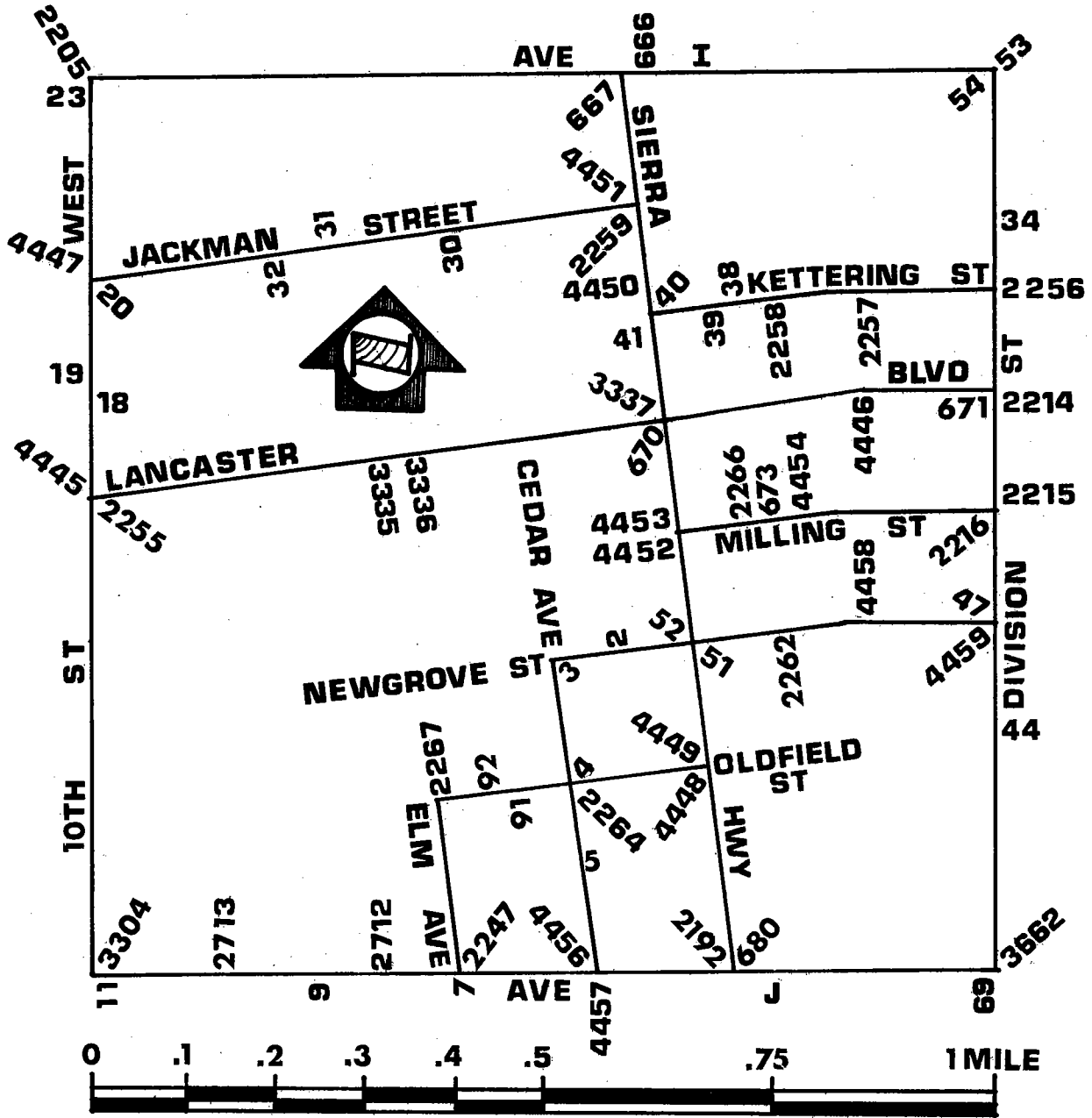

QUAD-YEAR	ELEV	DESCRIPTION (INCLUDE QUAD AND YEAR IN DESCRIPTION)	BM NUMBER
LANCASTR (1975)	2359.021	L+T MCR @ SE COR BEECH AVE + NEWGROVE ST 22FT E + 23FT S C/L INT	CL 2
LANCASTR (1975)	2360.602	L+T E CB CEDAR AVE 20FT E C/L + 35FT S C/L NEWGROVE ST	CL 3
LANCASTR (1975)	2364.298	L+BN MCR NW COR CEDAR AVE + OLDFIELD ST 24FT N + 24FT W C/L INT	CL 4
LANCASTR (1975)	2367.933	L+T MCR NW COR CEDAR AVE + PILLSBURY ST 23FT N + 22FT W C/L INT	CL 5
LANCASTR (1975)	2368.316	L+BN W CB 1FT N BCR @ NW COR ELM AVE + AVE J 18FT W + 66FT N C/L INT	CL 7
LANCASTR (1975)	2366.630	WLY L+T S CB AVE J 60FT S C/L ON C/L PROD FERN AVE IN FRONT OF PARK VIEW SCHOOL	CL 9
LANCASTR (1975)	2359.890	L+BN MCR SW COR AVE J + TENTH ST W 57FT S + 50FT W C/L INT	CL 11
LANCASTR (1975)	2337.317	L+BN W CB 10TH ST W 28FT W C/L 3FT N OF S P/L BLDG 44913 + 570FT S JACKMAN ST 3FT N PP 271449E	CL 18
LANCASTR (1975)	2336.587	L+BN E CB 10TH ST W 28FT E C/L + 86FT N OF N EDGE DRWY BLDG 44902 480FT S JACKMAN ST	CL 19
LANCASTR (1975)	2334.856	L+T IN CB RET 10FT N BCR @ SW COR 10TH ST W + JACKMAN ST 33FT S + 30FT W C/L INT	CL 20
LANCASTR (1975)	2329.113	L+T MCR @ NW COR AVE I + 10TH ST W 50FT N + 39FT W C/L INT	CL 23
LANCASTR (1975)	2338.850	L+T 0.5FT N BCR @ NW COR JACKMAN ST + DATE AVE 33FT N + 18FT W C/L INT	CL 30
LANCASTR (1975)	2339.480	L+BN S CB JACKMAN ST 20FT S C/L + 25FT W C/L ALLEY TO S BETWEEN FIG AVE + ELM AVE 5FT W BCR	CL 31
LANCASTR (1975)	2338.863	L+BN 6FT W BCR @ SW COR JACKMAN ST + FIG AVE 20FT S + 52FT W C/L INT	CL 32
LANCASTR (1975)	2349.645	L+T CONC STEP TO HSE NO 45027 N DIVISION ST 54FT W C/L + 295FT N + KETTERING ST	CL 34
LANCASTR (1975)	2346.935	L+BN 6FT N BCR @ NW COR YUCCA AVE + KETTERING ST 60FT N + 34FT W C/L INT	CL 38
LANCASTR (1975)	2347.903	L+T CONC BASE FENCE POST 30FT N OF C/L KETTERING ST + 209FT W C/L YUCCA AVE	CL 39

QUAD-YEAR	ELEV	DESCRIPTION (INCLUDE QUAD AND YEAR IN DESCRIPTION)	BM	NUMBER
LANCASTR (1975)	2345.589	L+BRAD E CB SIERRA HWY 30FT E C/L + 25FT N C/L KETTERING ST	CL	40
LANCASTR (1975)	2345.920	L+T IN SW CB RET 26FT S C/L KETTERING ST + 30FT W C/L SIERRA HWY	CL	41
LANCASTR (1975)	2371.836	L+T IN CONC APRON IN NE COR GROCERY STORE @ SW COR NUGENT ST + DIVISION ST 23FT S + 33FT W C/L INT	CL	44
LANCASTR (1975)	2363.555	CS MON IN WELL 21IN DN @ C/L INT DIVISION ST + NEWGROVE ST MKD (CO SUR RE 2177) W EDGE	CL	47
LANCASTR (1975)	2361.572	L+BN E CB SIERRA HWY 25FT E C/L + 115FT S C/L PROD NEWGROVE ST 16FT S OF END CB	CL	51
LANCASTR (1975)	2360.825	L+T @ MCR SW COR NEWGROVE ST + SIERRA HWY 23FT S + 37FT W C/L INT	CL	52
LANCASTR (1975)	2343.562	L+T @ MCR NW COR AVE I + DIVISION ST 42FT N + 43FT W C/L INT	CL	53
LANCASTR (1975)	2343.657	L+T @ MCR SW COR AVE I + DIVISION ST 42FT S + 44FT W C/L INT	CL	54
LANCASTR (1975)	2353.087	CSBM MON IN CONC FLUSH 1FT N OF N CB + 19FT W BCR @ NW COR 5TH ST E + AVE I 41FT N + 82FT W C/L INT MKD (BM 105-20 1958)	CL	56
LANCASTR (1975)	2352.930	L+T N CB 3FT W/O BCR 40FT N + 66FT W/O C/L INT AVE I + 5TH ST E	CL	57
LANCASTR (1975)	2360.037	USC+GS BR CAP 78FT W + 40FT S C/L INT AVE I + 10TH ST E MKD (Y 488 RESET 1961)	CL	60
LANCASTR (1975)	2380.513	L+T W EDGE OF CONC GARAGE APRON TO HSE NO 1016 LANCASTER BLVD 49FT S C/L + 145 FT E C/L 10TH ST E	CL	62
LANCASTR (1975)	2397.202	L+T NR MCR @ SW COR 10TH ST E + AVE J 48FT W + 45FT S C/L INT	CL	63
LANCASTR (1975)	2396.138	CS MON IN WELL 18IN DN @ C/L INT AVE J + 10TH ST E MKD (CO SUR 14 13 23 34 T7N R12W RE 5869) USE E EDGE	CL	64
LANCASTR (1975)	2390.948	CS MON IN WELL 10IN DN @ C/L INT AVE J + 5TH ST E MKD (1/4 COR 14 23 T7N R12W RE 5869) USE E EDGE	CL	65

QUAD-YEAR	ELEV	DESCRIPTION (INCLUDE QUAD AND YEAR IN DESCRIPTION)	BM NUMBER
LANCASTR (1975)	2384.262	L+BN @ MCR SE COR 4TH ST E + AVE J 80FT S + 24FT E C/L INT	CL 66
LANCASTR (1975)	2383.362	L+BN @ MCR SE COR KIRKLAND AVE + AVE J 75FT S + 27FT E C/L INT	CL 67
LANCASTR (1975)	2379.806	CS MON IN WELL 14IN DN @ C/L INT AVE J + DIVISION ST MKD (CO SUR 15 14 22 23 T7N R12W 1927) USE N EDGE	CL 69
LANCASTR (1975)	2413.162	L+T E SIDE 36IN STANDPIPE 215FT W C/L 10TH ST E + 5FT N C/L AVE J-8 263FT NW PP 917614E	CL 71
LANCASTR (1975)	2413.801	CS MON IN WELL 8IN DN @ C/L INT 10TH ST E + AVE J-8 0.5 MI S AVE J MKD (T7N, R12W 1/4 COR, 23-24)(W EDGE)	CL 72
LANCASTR (1975)	2434.427	CS MON IN WELL 15IN DN @ C/L INT 10TH ST E + AVE K MKD (CO SUR 23 24 25 26 T7N R12W) N EDGE	CL 73
LANCASTR (1975)	2425.754	CS MON IN WELL 9IN DN @ C/L INT AVE K + 6TH ST E MKD (RE 5869) W EDGE	CL 75
LANCASTR (1975)	2426.371	CS MON IN CONC POST 3IN UP 40FT S + 55FT W C/L INT AVE K + 6TH ST E MKD (BM 105-9 1958)	CL 76
LANCASTR (1975)	2425.307	CHIS X IN TOP OF BOLT ON W SIDE OF FIRE HYDRANT BASE 24FT S + 40FT W C/L INT AVE K + 5TH ST E 135FT W DRWY TO HSE 504	CL 77
LANCASTR (1975)	2400.305	L+BN @ MCR @ NE COR DIVISION ST + AVE J-8 28FT N + 41FT E C/L INT	CL 80
LANCASTR (1975)	2399.086	L+BN @ MCR SE COR DIVISION ST + AVE J-7 36FT S + 35FT E C/L INT	CL 81
LANCASTR (1975)	2413.834	CS MON IN WELL 18IN DN @ C/L INT AVE K + 5TH ST W MKD (CO SUR 1/4 SEC COR 22 27 T7N R12W) N SIDE	CL 83
LANCASTR (1975)	2405.153	L+BN @ NE COR OF SQ CAL GAS CO VALVE BOX 44FT N C/L AVE K + 115FT W C/L 10TH ST W	CL 85
LANCASTR (1975)	2380.407	CS MON IN WELL 14IN DN @ C/L INT 10TH ST W + AVE J-8 MKD (CO SUR 1/4 SEC COR 21 22 T7N R12W) W EDGE	CL 86
LANCASTR (1975)	2380.657	L+T 1FT N BCR @ NE COR 10TH ST W + AVE J-8 51FT N + 30FT E C/L INT	CL 87
LANCASTR (1975)	2376.885	L+T S CB AVE J-6 1FT E BCR @ SE COR 10TH ST W + AVE J-6 18FT S + 65FT E C/L INT	CL 88

QUAD-YEAR	ELEV	DESCRIPTION (INCLUDE QUAD AND YEAR IN DESCRIPTION)	BM NUMBER
LANCASTR (1975)	2362.393	CS MON IN WELL 9IN DN @ C/L INT OLDFIELD ST + DATE AVE MKD (RE 5869)	CL 91
LANCASTR (1975)	2362.663	L+T @ MCR NW COR OLDFIELD ST + DATE AVE 21FT N + 24FT W C/L INT	CL 92
LANCASTR (1975)	2397.123	USC+GS DISK IN CONC 6IN DN 60FT E + 125FT S C/L INT SIERRA HWY + AVE J-8 MKD (S 811 1947 RESET 1955)	CL 118
LANCASTR (1975)	2345.674	USC +GS BRASS DISC FLUSH 16FT W +41FT N/O C/L INT AVE I + 2ND ST E MKD (X-488 1955)	CL 119
LANCASTR (1975)	2324.035	L+T IN N SERVICE ROAD CB @ NE COR AVE I + 15TH ST W 51FT E + 80FT N C/L INT	CL 120
LANCASTR (1975)	2324.250	RDBM TAG IN S SERVICE ROAD CB @ SW COR AVE I + 15TH ST W 51FT W + 80FT S C/L INT	CL 121
LANCASTR (1975)	2321.705	CS MON 5IN UP @ NE COR AVE I + 20TH ST W 40FT N + 66FT E C/L INT MKD (BM 102-3 1957)	CL 122
LANCASTR (1975)	2341.951	CS MON IN WELL 12IN DN @ C/L INT AVE J + 20TH ST W MKD (SEC COR 17 16 20 21 R12W T7N) (N EDGE)	CL 126
LANCASTR (1975)	2343.823	RDBM TAG IN N CB @ NE COR AVE J + 20TH ST W 108FT E + 30FT N C/L INT	CL 127
LANCASTR (1975)	2349.372	RDBM TAG 6FT W BCR @ SW COR AVE J + 15TH ST W 66FT W + 30FT S C/L INT	CL 128
LANCASTR (1975)	2350.119	RDBM TAG 40FT S BCR @ SE COR AVE J + 15TH ST W 100FT S + 30FT E C/L INT	CL 129
LANCASTR (1975)	2338.270	L+BN 3FT W OF BCR @ SW COR LANCASTER BLVD + LOWTREE AVE 53FT W + 30FT S C/L INT	CL 131
LANCASTR (1975)	2335.719	L+BN 4FT N BCR @ NE COR LANCASTER BLVD + 15TH ST W 69FT N + 30FT E C/L INT	CL 132
BASELINE (1973)	2494.020	USC+GS DISK IN CONC POST 92FT N + 65FT W C/L INT AVE M + 40TH ST W MKD (F 489 1955)	CL 172
LANCASTR (1975)	2461.796	L+T NE COR CONC SLAB 100FT W + 66FT S C/L INT 50TH ST W + AVE L-8	CL 177
LANCASTR (1975)	2477.842	L+T CONC WLK IN FR OF CHURCH 45FT N + 65FT W C/L INT 50TH ST W + AVE L-12	CL 178
BASELINE (1973)	2495.190	L+T IN CONC SLAB 1.5FT S/O SW COR PORCH HSE NO. 42002, 50TH ST W 48FT N + 66FT E/O C/L INT 50TH ST W + AVE M	CL 180

QUAD-YEAR	ELEV	DESCRIPTION (INCLUDE QUAD AND YEAR IN DESCRIPTION)	BM NUMBER
LANCASTR (1975)	2410.012	CS MON (E EDGE) IN WELL 18IN DN @ C/L INT 50TH ST W + AVE K-8 MKD (CO SUR 1/4 COR 25, 26, T7N R13W, 1928)	CL 184
LANCASTR (1975)	2379.924	CS MON (W EDGE) IN WELL 16 IN DN @ C/L INT 50 TH ST W + AVE K MKD (CO SUR 23, 24, 25, 26, T7N, R13W, 1927)	CL 185
LANCASTR (1975)	2382.150	L+T NW COR CONC PORCH HSE NO 4849 AVE K 115FT E + 120FT N C/L INT AVE K + 50TH ST W	CL 186
LANCASTR (1975)	2350.167	RDBM TAG S SIDE WIER BOX 97FT E + 85FT N C/L INT AVE J + 45TH ST W (TO THE N)	CL 191
LANCASTR (1975)	2343.517	CS MON IN WELL 13IN DN @ C/L INT AVE J + 40TH ST W MKD (T7N R12 W R13W 13 18 24 19 RE 5869) USE N EDGE	CL 195
LANCASTR (1975)	2340.999	L+T CONC WALK IN FRONT OF CHURCH @ NE COR AVE J + 35TH ST W 130FT N + 170FT E C/L INT MKD (8M)	CL 196
LANCASTR (1975)	2341.550	L+T IN SE COR CONC PORCH TO HSE NO 3129 W AVE J 75FT N + 895FT W/O C/L INT 30TH ST W	CL 198
LANCASTR (1975)	2338.217	CS MON IN WELL 21IN DN @ C/L INT AVE J + 25TH ST W MKD (CO SUR 1/4 SEC COR 17 20 T7N R12W) N EDGE	CL 200
LANCASTR (1975)	2441.292	CS MON IN WELL 15IN DN @ C/L INT 90TH ST E + AVE J MKD (CO SURV 18 17 19 20 T7N R10W 1926)	CL 271
LANCASTR (1975)	2424.311	CS MON IN WELL 20IN DN @ C/L INT 90TH ST E + AVE I-8 MKD (CO SURV 1/4 SEC COR 17 18 T7N R10W)	CL 274
LANCASTR (1975)	2411.815	CSMON IN WELL 12IN DN @ C/L INT 90TH ST E + AVE I MKD (CO SURV 7 8 17 18 T7N R10W)	CL 278
LANCASTR (1975)	2399.577	CS BM MON 2IN UP 39FT S + 70FT W C/L INT AVE I + 70ST E MKD (BM 107-30 1961)	CL 283
LANCASTR (1975)	2410.195	CS MON IN CONC SQ 2IN UP 1FT N TP NO K3143Y 30FT N C/L AVE I + 27FT W C/L PROP 85TH ST E MKD (BM 107-27 1961)	CL 284
LANCASTR (1975)	2412.559	CS MON 2FT S PP NO 991781E 30FT S C/L AVE I + 47FT W C/L 80TH ST E MKD (BM 107-28 1961)	CL 285
LANCASTR (1975)	2392.012	CS MON IN WELL 19IN DN @ C/L INT 90TH ST E + AVE H MKD (CO SURV 5 6 7 8 T7N R10W)	CL 286

QUAD-YEAR	ELEV	DESCRIPTION (INCLUDE QUAD AND YEAR IN DESCRIPTION)	BM NUMBER
LANCASTR (1975)	2393.473	RDBM TAG @ CTR OF OLD CONC BASE OF MTR MOUNT 40FT W C/L 90TH ST E + 100FT N C/L AVE H	CL 287
LANCASTR (1975)	2409.965	RDBM TAG @ SE COR CONC FTG OF WATER TOWER @ HSE NO 8359 AVE I 60FT N + 20FT W C/L INT AVE I + 85TH ST E	CL 289
LANCASTR (1975)	2415.932	RDBM TAG TOP OF CONC SUPPORT OF LGE WATER TANK 90FT N C/L AVE I + 45FT W C/L 80TH ST E	CL 290
LANCASTR (1975)	2414.150	L+T @ SW COR OF CONC WLK TO HSE NO 7848 AVE I 200FT W C/L 80TH ST E + 80FT N C/L AVE I	CL 291
LANCASTR (1975)	2402.561	CSBM MON FLUSH 25FT S C/L AVE I + 25FT W C/L 75TH ST E 15FT W PP 482159E MKD (BM 107-29 1961)	CL 294
LANCASTR (1975)	2397.335	CS MON IN CONC 2IN UP 33FT S C/L AVE I + 142FT W C/L 65TH ST E 3FT S PP NO 1121124 MKD (BM 107- 31 1961)	CL 297
LANCASTR (1975)	2400.395	RDBM TAG TOP OF CONC WEIR BOX 35FT N C/L AVE I 400FT E OF 65TH ST E 50FT E OF DRWY TO HSE NO 6535 AVE I	CL 298
LANCASTR (1975)	2399.251	L+T E CB DRWY HSE NO 6007 AVE I 40FT N + 100FT E C/L INT E AVE I + 60TH ST E	CL 299
LANCASTR (1975)	2399.148	L+T W CB DRWY HSE NO 6007 AVE I 42FT N + 90FT E C/L INT E AVE I + 60TH ST E	CL 300
LANCASTR (1975)	2384.791	2IN IP 1FT ABOVE GROUND 40FT S OF C/L INT AVE I + 45TH ST E (USE E EDGE)	CL 305
LANCASTR (1975)	2383.053	L+T NE COR CONC WLK HSE NO 4010 AVE I 90FT S + 140FT E C/L INT AVE I + 40TH ST E	CL 307
LANCASTR (1975)	2381.300	L+T SE COR CONC SLAB @ NE COR BLDG NO 3606 AVE I 82FT S C/L + 150FT E C/L 36TH ST E	CL 309
LANCASTR (1975)	2375.562	CS MON IN WELL @ C/L INT AVE I + 25TH ST E MKD (T7N, R11W, 1/4 COR 7-18)(E EDGE)	CL 313
LANCASTR (1975)	2372.378	L+T SE COR OF CONC APRON OF GAS STA 55FT N C/L AVE I + 65FT W C/L 20TH ST E	CL 316
LANCASTR (1975)	2413.879	CS MON IN WELL 20IN DN @ C/L INT 20TH ST W + AVE K-8 MKD (SUR 1/4 SEC COR 29 28 T7N R12W) N EDGE	CL 323
LANCASTR (1975)	2480.485	L+T IN CONC SLAB IN FRONT OF DOOR TO HSE 42423 20TH ST W 100FT W C/L + 250FT N C/L AVE L-8	CL 327

QUAD-YEAR	ELEV	DESCRIPTION (INCLUDE QUAD AND YEAR IN DESCRIPTION)	BM NUMBER
LANCASTR (1975)	2481.968	CS MON IN WELL 22IN DN @ C/L INT 20TH ST W + AVE L-8 MKD (CO SUR 1/4 SEC COR 32 33 T7N R12W)	CL 328
BASELINE (1973)	2523.094	USC+GS BRASS DISK IN TOP OF CONC POST 4IN UP 208FT E OF C/L 20TH ST W + 33FT N C/L AVE M MKD (D 489 1955)	CL 330
BASELINE (1973)	2518.075	CS MON IN WELL 18IN DN @ C/L INT AVE M + 25TH ST W MKD (1/4 COR 32 5 T6N R12W)	CL 334
BASELINE (1973)	2523.214	L+T IN SE COR OF CONC DR TO HSE NO 2524 AVE M 140FT S C/L + 215FT W C/L 25TH ST W	CL 335
BASELINE (1973)	2520.107	USC+GS MON TOP OF CONC POST 4IN UP 300FT E C/L 30TH ST W + 34FT N C/L AVE M 6FT W PP NO 1054594E MKD (E 489 1955)	CL 336
BASELINE (1973)	2514.806	CS MON IN WELL @ C/L INT AVE M + 30TH ST W MKD (SEC COR 31 32 5 6 T7N T6N R12W)	CL 337
LANCASTR (1975)	2448.604	CS MON IN WELL 21IN DN @ C/L INT AVE L + 25TH ST W MKD (CO SUR 1/4 SEC COR 29, 32, T7N, R12W)	CL 382
LANCASTR (1975)	2448.798	L+T IN BOTTOM STEP @ W EDGE OF CONC STEPS TO HSE NO 2507 AVE L 73FT N C/L + 78FT W C/L 25TH ST W	CL 383
LANCASTR (1975)	2441.097	CS MON IN WELL 13IN DN @ C/L INT AVE L + 30TH ST W MKD (CO SUR 29, 30, 31, 32, T7N, R12W)	CL 384
LANCASTR (1975)	2441.135	L+T E EDGE CONC DR 75FT S + 195FT W C/L INT AVE L + 30TH ST W	CL 385
LANCASTR (1975)	2433.248	CS MON IN WELL 10 IN DN @ C/L INT AVE L + 35TH ST W MKD (1/4 COR 30, 31, T7N, R12W, RE5869) (E EDGE)	CL 387
LANCASTR (1975)	2428.278	CS MON IN WELL 10IN DN @ C/L INT AVE L + 40TH ST W MKD (T7N, R12W, R13W, 25, 30, 36, 31, RE 5869) (SE EDGE)	CL 388
LANCASTR (1975)	2431.834	L+T IN W EDGE 2FT CONC WALK 50FT S + 110FT W/O C/L INT AVE L + 40TH ST W	CL 389
LANCASTR (1975)	2428.327	USGS MON @ NW COR AVE L + 45TH ST W 38FT N + 37FT W C/L INT MKD (R 49 1929 RESET 1942)	CL 391
BASELINE (1973)	2491.198	CS MON IN WELL 14IN DN @ C/L INT AVE M + 50TH ST W MKD (CO SUR 35 36 2 1 T7N T6N R13W 1927) (W EDGE)	CL 394

QUAD-YEAR	ELEV	DESCRIPTION (INCLUDE QUAD AND YEAR IN DESCRIPTION)	BM NUMBER
BASELINE (1973)	2496.524	CS MON IN WELL 18IN DN @ C/L INT OF AVE M + 55TH ST W MKD (CO SUR 1/4 COR SEC 35, 2 R-13W T-7N T-6N USE S EDGE	CL 395
BASELINE (1973)	2513.813	CS MON IN WELL 22IN DN @ C/L INT OF AVE M + 60TH ST W MKD (SEC COR 34 35 3 2 T7N T6N R13W)	CL 397
LANCASTR (1975)	2382.238	CS MON IN WELL 18IN DN @ C/L INT 60TH ST E + AVE H-8 PROP MKD (CO SUR 1/4 SEC COR 10 11 T7N R11W) S EDGE	CL 411
LANCASTR (1975)	2385.237	RDBM TAG IN SE COR CONC RESERVOIR @ HSE NO 45609 60TH ST E 110FT W C/L + 55FT N C/L AVE H-8 PROP	CL 412
LANCASTR (1975)	2369.711	CS MON IN WELL 18IN DN @ C/L INT 60TH ST E + AVE H MKD (CO SUR 2 3 10 11 T7N R11W) S EDGE	CL 413
LANCASTR (1975)	2360.023	CS MON IN WELL 23IN DN @ C/L INT 60TH E + AVE G-8 MKD (CO SUR 1/4 SEC COR 2 3 T7N R11W) N EDGE	CL 415
LANCASTR (1975)	2361.305	L+T NR S EDGE OF CONC WK 145FT N + 130FT W C/L INT 60TH ST E + AVE G-8	CL 416
LANCASTR (1975)	2351.813	CS MON IN WELL 20IN DN @ C/L INT AVE G + 60TH ST E MKD (CO SUR 2 3 34 35 T7N T8N R11W)	CL 417
LANCASTR (1975)	2343.709	CS MON IN WELL 24IN DN @ C/L INT 60TH ST E + AVE F-8 MKD (CO SUR 1/4 COR 34 35 T8N R11W)	CL 420
LANCASTR (1975)	2336.480	RD MON IN WELL 8IN DN @ SW COR AVE F + 60TH ST E 47FT W + 25FT S C/L INT MKD (1958)	CL 422
LANCASTR (1975)	2338.692	RD MON IN WELL @ NE COR AVE F + 65TH ST E 24FT N + 42 FT E C/L INT MKD (1958)	CL 424
LANCASTR (1975)	2342.899	RD MON IN WELL @ NW COR AVE F + 70TH ST E 34FT N + 25FT W C/L INT MKD (1958)	CL 425
LANCASTR (1975)	2343.346	CS MON IN WELL 8IN DN @ C/L INT AVE F + 70TH ST E MKD (26 25 35 36 R11W T8N RE 5869) N EDGE	CL 426
LANCASTR (1975)	2347.196	L+BN IN CONC FTG OF 36IN STANDPIPE 40FT N C/L AVE F + 31FT W C/L 75TH ST E PROP	CL 427
LANCASTR (1975)	2345.760	CS MON IN WELL 12IN DN @ C/L INT AVE F + 75TH ST E MKD (CO SUR 1/4 COR 25 36 R11W T8N RE 2177) N EDGE	CL 428
LANCASTR (1975)	2348.331	CS MON IN WELL 9IN DN @ C/L INT AVE F + 80TH ST E MKD (25 30 36 31 T8N R10W R11W RE 5869) W EDGE	CL 430

QUAD-YEAR	ELEV	DESCRIPTION (INCLUDE QUAD AND YEAR IN DESCRIPTION)	BM NUMBER
LANCASTR (1975)	2354.262	L+T IN S EDGE CONC SLAB UNDER WATER TOWER 45FT N + 95FT W C/L INT 90TH ST E + AVE F MKD (SLBM) 95FT W C/L INT MKD (SLBM)	CL 433
LANCASTR (1975)	2353.91 ⁴	CS MON 16IN DN @ C/L INT 90TH ST E + AVE F MKD (CO SURV 30 29 31 32 R10W T8N RE 2177) E EDGE	CL 434
LANCASTR (1975)	2364.440	2IN IP CONC PLUG + BT SPK IN WELL 15IN DN @ C/L INT 90TH ST E + AVE F-8 (USE SPK)	CL 436
LANCASTR (1975)	2373.622	RD MON IN WELL WITH CONC COLLAR @ SE COR 90TH ST E + AVE G 30FT E + 40FT S C/L INT MKD (1958)	CL 438
LANCASTR (1975)	2384.265	2IN IP IN CONC W/BR CAP ON C/L AVE G-8 30FT W C/L 90TH ST E MKD (CO SURV W C SEC 6 R10W T7N)	CL 439
LANCASTR (1975)	2497.672	USC+GS MON 3IN UP 60FT E C/L SIERRA HWY OPP BLDG NO 42445 2200FT S AVE L MKD U 811 1947	CL 470
LANCASTR (1975)	2486.467	USC+GS MON 12IN DN 60FT E C/L SIERRA HWY OPP BLDG NO 42607 1250FT S AVE L MKD B 57 1926 RESET 1955	CL 471
LANCASTR (1975)	2447.343	USC + GS MON 12IN DN 59FT E C/L SIERRA HWY + 75FT N C/L PROP AVE K-8 MKD (T811 1947)	CL 472
LANCASTR (1975)	2332.203	USGS MON ON 3IN IP FL 49FT W/O WLY RAIL MAIN LINE SPRR 1199FT N/O C/L AVE I MKD(USGS 2335 1902)	CL 474
LANCASTR (1975)	2317.009	USC+GS MON S EDGE HDWL CULV G90+50 25FT W C/L SIERRA HWY + 0.4MI S AVE G MKD (Z 811 1947)	CL 476
LANCASTR (1975)	2304.913	USC+GS MON 10IN UP 34FT E C/L SIERRA HWY + 1450FT S AVE F MKD (Y 56 1926)	CL 477
LANCASTR (1975)	2301.771	USGS MON ON 3IN IP 8IN UP 85FT E C/L SIERRA HWY + 800FT N/O AVE F MKD (BM 33 2302B 1902)	CL 478
LANCASTR (1975)	2303.926	USGS TRI STA MON 15IN UP 227FT W C/L SIERRA HWY + 2200FT N AVE F MKD (OBAN 1929 LINT)	CL 479
LANCASTR (1975)	2301.128	USC+GS REF MON 8IN UP 227FT W C/L SIERRA HWY + 2280FT N AVE F MKD (OBAN NO 2 1941)	CL 480
LANCASTR (1975)	2300.473	USC+GS MON FLUSH W END S CONC ABUT OF RR BRIDGE 73FT N C/L AVE E + 121FT E C/L SIERRA HWY MKD (H 487 1955)	CL 481
LANCASTR (1975)	2303.630	USC+GS MON FLUSH TOP OF E END OF S CONC ABUT OF SPRR BRIDGE 88FT N C/L AVE C + 141FT E C/L SIERRA HWY MKD (J 487 1955)	CL 482

QUAD-YEAR	ELEV	DESCRIPTION (INCLUDE QUAD AND YEAR IN DESCRIPTION)	BM NUMBER
LANCASTR (1975)	2305.536	USC+GS MON FLUSH S END W HDWL CULV UNDER SPRR 35FT N C/L AVE B + 122FT E C/L SIERRA HWY MKD (N 487 1955)	CL 483
LANCASTR (1975)	2307.793	USC+GS MON FLUSH N END HDWL OF SPRR CULV 123FT E C/L SIERRA HWY + 213FT S/O C/L AVE A (KERN CO LINE) MKD(M 487-1955)	CL 484
LANCASTR (1975)	2333.736	RDBM TAG E CB 60FT S BCR @ SE COR DIVISION ST + AVE H-8 20FT E + 135FT S C/L INT	CL 485
LANCASTR (1975)	2331.916	CS MON (N EDGE) IN WELL 18IN DN @ C/L INT AVE H-8 + DIVILION ST MKD (CO SUR 1/4 SEC COR 10 11 T7N R12W 1927)	CL 487
LANCASTR (1975)	2332.968	CS MON 10IN DN @ C/L INT DIVISION ST + AVE H MKD (CO SUR 3 2 10 11 T7N R12W 1927) W EDGE	CL 488
LANCASTR (1975)	2327.387	L+T NW COR CONC WK BLDG NO 46350 205FT S + 45FT E C/L INT DIVISION ST + AVE G-8	CL 490
LANCASTR (1975)	2325.382	CS MON IN WELL 8IN DN @ C/L INT DIVISION ST + AVE G-8 MKD (1/4 COR 2 3 T7N R12W RE 5869)	CL 491
LANCASTR (1975)	2322.475	2IN IP CONC PLUG + NAIL 12IN UP @ SE COR AVE G + DIVISION ST 35FT S + 35FT E/O C/L INT USE E EDGE	CL 492
LANCASTR (1975)	2320.357	CS BR CAP MON IN WELL 18IN DN @ C/L INT DIVISION ST + AVE G MKD (CO SUR 34 35 3 2 T8N T7N R12W 1927)	CL 493
LANCASTR (1975)	2314.862	L+T @ NE COR CONC SLAB @ SIDE ENT N SIDE OF HSE NO 47159 DIVISION ST 100FT W C/L + 80FT S C/L AVE F-8	CL 494
LANCASTR (1975)	2306.126	CS MON IN WELL 17IN DN @ C/L INT AVE F + DIVISION ST MKD (CO SUR 26 27 34 35 T8N R12W RE 329)	CL 497
LANCASTR (1975)	2300.715	CS MON IN WELL 17IN DN @ C/L INT DIVISION ST + AVE E-8 MKD (CO SUR 1/4 COR 26 27 T8N R12W RE329)	CL 498
LANCASTR (1975)	2295.274	RD BM MON IN WELL 6IN DN @ SW COR DIVISION ST + AVE E 27FT W + 51FT S/O C/L INT 4FT WLY PP NO 1404026E MKD (1957)	CL 499
LANCASTR (1975)	2295.579	CS MON IN WELL 18IN DN @ C/L INT AVE E + 5TH ST W MKD (CO SUR 1/4 COR 22 27 T8N R12W RE 329) (N EDGE)	CL 501

