

**COUNTY OF LOS ANGELES
ROAD DEPARTMENT**

**PRECISE
BENCH MARK LIST**



**LANCASTER WEST
QUAD**

1981 ADJUSTMENT

NGVD 29

P R E F A C E
1981 Adjustment

The Road Department level net published in 1975 consisted of more than 1500 miles of levels supporting in excess of 18,000 bench marks. For reasons of economy, this 1981 adjustment is reduced to about 55% of the bench marks previously published. Reductions were made by increasing the spacing between level lines in unincorporated territory, and eliminating lines in non-contract cities and areas where the probability of future engineering projects appears slight. The 1981 adjustment is an update of the remainder of the 1975 bench marks, not including baselines. Data from previous adjustments is available without inferring any responsibility for the current reliability of the data or the actual existence of the bench marks. Elevations of bench marks with the same quad name, but different adjustment dates, are not normally compatible.

To facilitate the adjustment, indexing, and distribution of adjusted values of the net, the County territory is divided into 34 quads or areas. For identification purposes each quad is given a name, viz., "Rosemead," "La Mirada," "Santa Fe," etc. When bench marks and elevations in the Road Department net are used, the name of the quad in which the bench mark is located and the date of the elevation adjustment must be included in the bench mark description, e.g.,

CY 6901 - RDEM TAG S CB 11FT E BCR @ SE COR LA CIENEGA
BLVD & LENNOX BLVD 32FT S & 73FT E C/L INT
(HAWTHORNE - 1980) ELEV. 82.549

The precision of the net is reflected by an indicated field probable error of plus or minus 0.012 foot per mile of leveling as determined from over 300 conditions of closure. However, many years experience in vertical control in the greater Los Angeles basin and Antelope Valley indicate that because of varying degrees of subsidence and heaving, the true datum is recovered only by obtaining substantial agreement between a number of bench marks.

The users of this net are invited to assist in its maintenance by notifying this Department of cases of obliteration, apparent mistakes in descriptions or elevations, and proven disturbance of bench marks.

DATUM: U.S. Coast and Geodetic Survey Sea Level Datum
of 1929, through the medium of the Los Angeles
County Engineer Precise Level Net.

ABBREVIATIONS USED IN BENCH MARK LISTINGS

ABUT -----	Abutment	ECR -----	End of Curb Return
ALG -----	Along	EC -----	End of Curve
ANG PT -----	Angle Point	ENT -----	Entrance
B/W -----	Back of Walk	FL -----	Floor
BCR -----	Beginning of Curb Return	FTG -----	Footing
BC -----	Beginning of Curve	FRWY -----	Freeway
BLDG -----	Building	F/W -----	Front of Walk
BM -----	Bench Mark	GAR -----	Garage
BT SPK -----	Boat or Bolt Spike	HDWL -----	Headwall
BR CAP -----	Brass or Bronze Cap	HSE -----	House
C B -----	Catch Basin	HWY -----	Highway
CTR -----	Center	INT -----	Intersection
C/L -----	Center Line	IP -----	Iron Pipe
C/L INT -----	Center Line Intersection	LT -----	Left
C/L PROD -----	Center Line Produced	LACE -----	L.A. City Engineer
CONC -----	Concrete	LACS -----	L.A. Co. Engineer
COR -----	Corner	LAFC -----	L.A. Co. Flood Control
COE -----	Corps of Engineers	L&BN -----	Lead and Bench Nail
CULV -----	Culvert	L&BR -----	Lead and Brad
CYN -----	Canyon	L&N -----	Lead and Nail
CB -----	Curb	L&SPK -----	Lead and Spike
CS MON -----	Co. Eng. Monument	L&T -----	Lead and Tack
CT SPK -----	Cut Spike	MCR -----	Middle of Curb Return
DPW -----	Dept. of Public Works	MKD -----	Marked
DR -----	Drive or Driveway	MC -----	Middle of Curve
E/O -----	East of	MON -----	Monument

ABBREVIATIONS USED IN BENCH MARKS (CON'T)

N/O ----- North of
NR ----- Near
OPP ----- Opposite
PI ----- Point of Intersection
PK&W ----- PK Nail and Washer
P/L ----- Property Line
POST ----- Point of Semi-Tangent
PP ----- Power Pole
PVMT ----- Pavement
PROD ----- Produced
RD ----- Road
RDBM ----- Road Dept. Bench Mark
RDBM TAG ----- Road Dept. Bench Mark Tag
RR ----- Railroad
RT ----- Right
R/W ----- Right of Way
SDMH ----- Storm Drain Manhole
SMH ----- Sewer Manhole
SPK ----- Spike
ST&W ----- Spike Tin and Washer
S/O ----- South of
TP ----- Telephone Pole
USC&GS ----- U.S. Coast and Geodetic Survey
USGS ----- U.S. Geological Survey
WK ----- Walk
W/O ----- West of

K E R N C O U N T Y
A N G E L E S C O U N T Y

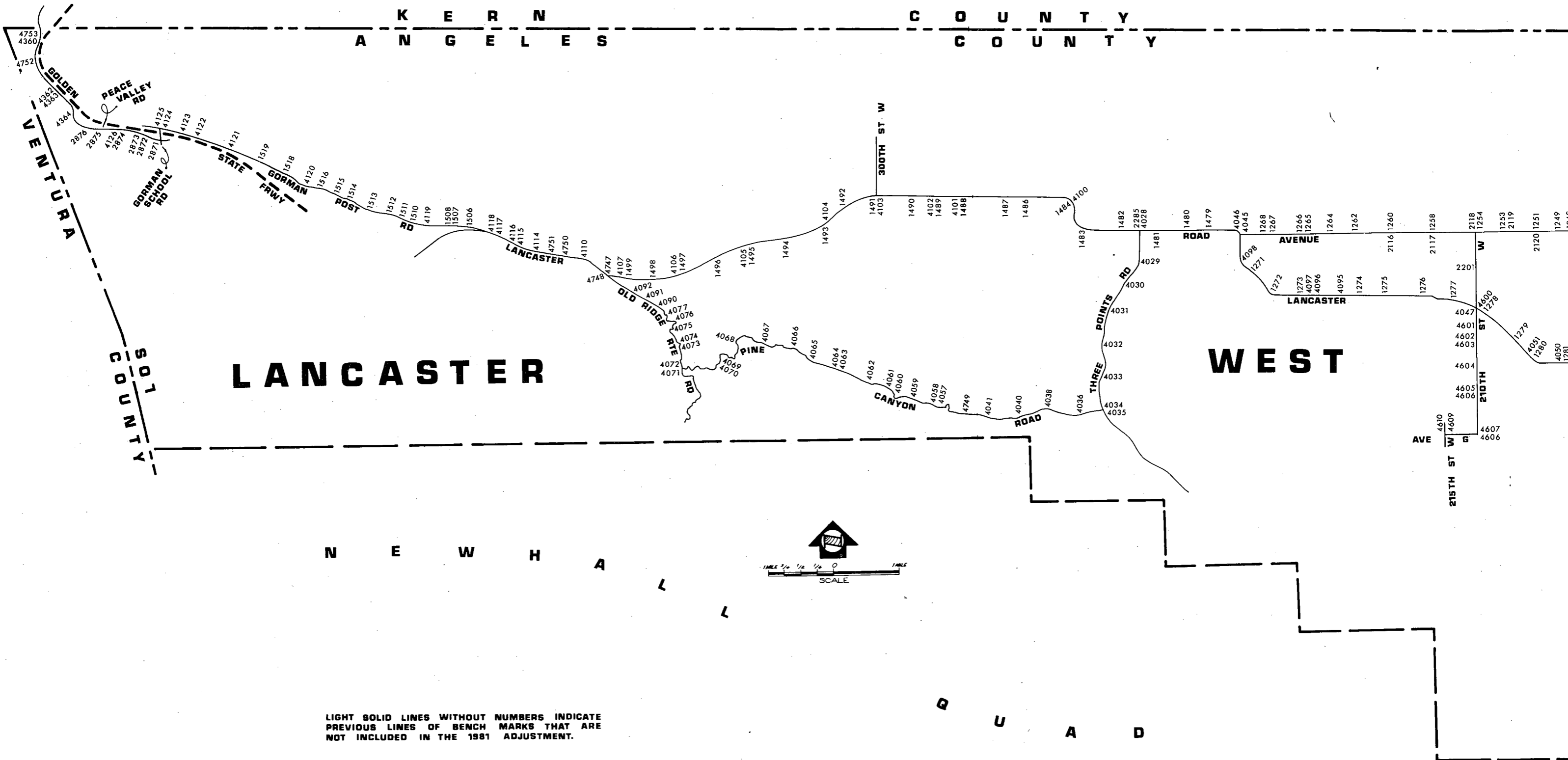

LIGHT SOLID LINES WITHOUT NUMBERS INDICATE PREVIOUS LINES OF BENCH MARKS THAT ARE NOT INCLUDED IN THE 1981 ADJUSTMENT.

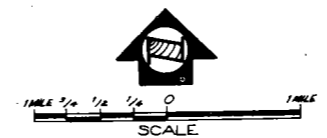

N E W H A L L Q U A R D

C O U N T Y
C O U N T Y

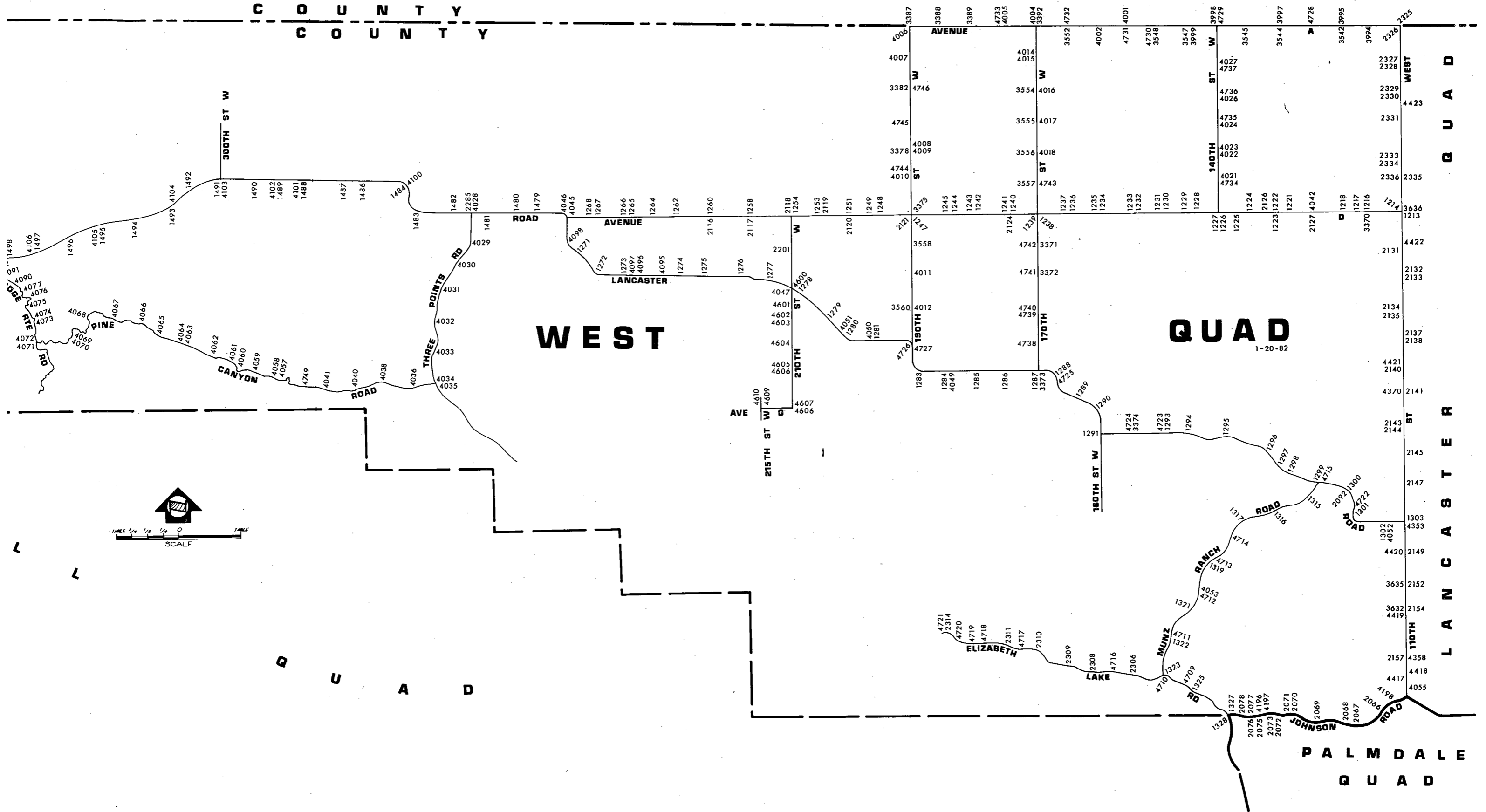

W E S T
L A N C A S T E R
Q U A D

W E S T
L A N C A S T E R
Q U A D

P A L M D A L E
Q U A D

Q U A D
1-20-82

QUAD-YEAR	ELEV	DESCRIPTION (INCLUDE QUAD AND YEAR IN DESCRIPTION)	BM NUMBER
LANCASTR (1975)	2485.353	CS MON (SW EDGE) IN WELL 14IN DN @ C/L INT AVE D & 110TH ST W MKD (CO SUR 13 14 23 24 T8N R14W)	CL 1213
LANCASTR (1975)	2487.965	RDBM MON 6FT E PP NO 1218851E 28FT N C/L AVE D & 235FT W C/L 110TH ST W 2IN IP WITNESS 3FT UP 2FT N MKD (1961)	CL 1214
LANCASTR (1981)	2501.710	RDBM MON 6FT E PP NO 1218863E 45FT N C/L AVE D & 195FT W C/L 115TH ST W (DIRT RD) 2IN IP WITNESS 3FT UP 2FT N MKD (1961)	CL 1216
LANCASTR (1981)	2513.490	RDBM TAG IN WEST LEG OF W&P HIGH TENSION LINE TOWER NO 212-4 140FT N C/L AVE D & 165FT E C/L 120TH ST W (PROP BUT UNIMPROVED)	CL 1217
LANCASTR (1981)	2511.770	CS MON 15IN DN @ C/L INT AVE D & 120TH ST W (PROP BUT UNIMPROVED) MKD (T8N R14W SEC CGR 14, 15,22,23) USE N EDGE	CL 1218
LANCASTR (1981)	2542.858	CS MON (N EDGE) IN WELL 20IN DN @ C/L INT AVE D & 130TH ST W MKD (CO.SUR.15 16 21 22 T8N R14W)	CL 1221
LANCASTR (1981)	2545.570	USC&GS MON IN CONC POST 8IN UP 37FT S C/L AVE D & 31FT W C/L 130TH ST W (PROP BUT UNIMPROVED) MKD (WIND 1952)	CL 1222
LANCASTR (1981)	2545.203	USC&GS MON IN CONC POST 6IN UP 63FT S C/L AVE D & 29FT W C/L 130TH ST W (PROP BUT UNIMPROVED) MKD (WIND NO 1 1952)	CL 1223
LANCASTR (1981)	2576.473	RDBM TAG IN CONC BASE OF NORTH LEG OF SO CALIF EDISON HIGH TENSION TOWER NO 51-4 200FT S C/L AVE D & 0.2 MI W 135TH ST W (PROP)	CL 1224
LANCASTR (1981)	2570.885	RDBM TAG IN CONC BASE OF SOUTH LEG OF SO CALIF EDISON HIGH TENSION TOWER NO E51-3-A 60FT N C/L AVE D & 0.2MI W/O 135TH ST W (PROPOSED)	CL 1225
LANCASTR (1981)	2575.381	CS MON IN WELL 18IN DN @ C/L INT AVE D & 140TH ST W MKD (SEC COR 16 17 20 21 T8N R14W) N EDGE	CL 1226
LANCASTR (1981)	2577.203	RDBM MON 6FT E PP NO 1218924E 45FT N C/L AVE D & 153FT W C/L 140TH ST W 2IN IP WITNESS 3FT UP 2FT N	CL 1227
LANCASTR (1981)	2592.988	CS MON (N EDGE) IN WELL 24IN DN @ C/L INT AVE D & 145TH ST W MKD (1/4 COR 17 20 T8N R14W)	CL 1228
LANCASTR (1981)	2595.125	RDBM MON 6FT E PP NO 1218936E 45FT N C/L AVE D & 185FT W C/L 145TH ST W MKD (1961) 2IN IP WITNESS 3FT UP 2FT N	CL 1229

01/18/82

LOS ANGELES COUNTY ROAD DEPARTMENT
SURVEY SECTION

PAGE

QUAD-YEAR	ELEV	DESCRIPTION (INCLUDE QUAD AND YEAR IN DESCRIPTION)	BM	NUMBER
LANCASTR (1981)	2611.196	RDBM MON 6FT E PP NO (NONE) 40FT N C/L AVE D & 1901 E C/L 150TH ST W MKD (1961) 2IN IP WITNESS 3FT UP 2FT N	CL	1230
LANCASTR (1981)	2613.068	CS MON IN WELL 8IN DN @ C/L INT AVE D & 150TH ST W MKD (17 18 19 20 T8N R14W RE 7078)	CL	1231
LANCASTR (1981)	2625.557	RDBM MON 6FT W PP NO (NONE) 40FT N C/L AVE D & 118FT E C/L 155TH ST W MKD (1961) 2IN IP WITNESS 3FT UP 2FT N	CL	1232
LANCASTR (1981)	2625.922	CS MON IN WELL 18IN DN @ C/L INT AVE D & 155TH ST W MKD (1/4 COR 18 19 T8N R14W) USE SW EDGE	CL	1233
LANCASTR (1981)	2645.262	CS MON IN WELL 16IN DN @ C/L INT AVE D & 160TH ST W (DIRT RD) MKD (CO SURV 13 18 1924 T8N R15W)	CL	1234
LANCASTR (1981)	2647.039	RDBM MON 6FT E PP NO (GONE) 28FT N C/L AVE D & 160FT W C/L 160TH ST W (DIRT RD) 2IN IP WITNESS 3FT UP 2FT N	CL	1235
LANCASTR (1981)	2665.167	CS MON IN WELL 8IN DN @ C/L INT AVE D & 165TH ST W MKD (1/4 COR 13 24 T8N R15W RE7078)	CL	1236
LANCASTR (1981)	2667.876	RDBM MON 6FT E PP NO (GONE) 28FT N C/L AVE D & 170FT W C/L 165TH ST W (PROP BUT UNIMPROVED) 2IN IP WITNESS 3FT UP 2FT N	CL	1237
LANCASTR (1981)	2687.535	RDBM MON 6FT E PP NO 1312399E 29FT N C/L AVE D & 75FT E C/L 170TH ST W 2IN IP WITNESS 3FT UP 2FT S	CL	1238
LANCASTR (1981)	2687.167	CS MON IN WELL 8IN DN @ C/L INT AVE D & 170TH W MKD (T8N R15W SEC COR 14 13 23 24 RE 7078) USE S EDGE	CL	1239
LANCASTR (1981)	2711.619	CS MON IN WELL 24IN DN @ C/L INT AVE D & 175TH ST W (PROP) MKD (T8N R15W 1/4 SEC COR 14 23 RE 2177) W EDGE	CL	1240
LANCASTR (1981)	2712.822	RDBM MON IN WELL 6FT E PP NO (NONE) 45FT N C/L AVE D & 170FT W C/L 175TH ST W (PROP) 2IN IP MKR 3FT UP 2FT N MKD (1961)	CL	1241
LANCASTR (1981)	2731.921	RDBM MON IN WELL 9FT E PP NO 1312375E 45FT N C/L AVE D & 48FT E C/L 180TH ST W (PROP) 2IN IP MKR 3FT UP 2FT N MKD (1961)	CL	1242
LANCASTR (1981)	2731.923	CS MON 20IN DN IN WELL @ C/L INT AVE D & 180TH ST W (PROP) MKD (15 14 22 23 RE 2177)	CL	1243

QUAD-YEAR	ELEV	DESCRIPTION (INCLUDE QUAD AND YEAR IN DESCRIPTION)	BM	NUMBE
LANCASTR (1981)	2752.213	RDBM MON IN WELL 8FT W PP NO (GONE) 45FT N C/L AVE D & 220FT E 185TH ST W (PROP) 80FT E HSE NO 18348 MKD (1961) 2IN IP MKR 3FT UP 2FT N	CL	1244
LANCASTR (1981)	2755.047	RDBM TAG @ N EDGE CONC ISL OF GAS PUMP 8FT E OF W END OF ISL 75FT S C/L AVE D & 100FT E C/L 185TH ST W (PROP)	CL	1245
LANCASTR (1981)	2773.405	RDBM IN WELL 8FT E PP NO (GONE) 45FT N C/L AVE D & 190FT W C/L 190TH ST W MKD (1961) 2IN IP MKR 3FT UP 2FT N	CL	1247
LANCASTR (1981)	2787.976	CS MON IN WELL 18IN DN @ C/L INT AVE D & 195TH ST W MKD (1/4 COR 16 21 T8N R15W) USE E EDGE	CL	1248
LANCASTR (1981)	2788.709	RDBM MON IN WELL MKD (1961) 6FT E PP NO 1312339E 45FT N C/L AVE D & 120FT W C/L 195TH ST W (PROP) 2IN IP MKR 3FT UP 2FT N	CL	1249
LANCASTR (1981)	2801.355	RDBM IN WELL MKD (1961) 45FT N C/L AVE D & 185FT W C/L 200TH ST W 6FT E PP NO (GONE) 2IN IP 3FT UP 2FT N	CL	1251
LANCASTR (1981)	2813.736	RDBM MON IN WELL 6FT E PP NO (GONE) 45FT N C/L AVE D & 145FT W C/L 205TH ST W (PROP) 2IN IP MKR 3FT UP 2FT N	CL	1253
LANCASTR (1981)	2817.842	RDBM TAG IN CONC FTG CHAIN LINK FENCE POST OF EDISON SUB-STA @ SW PROP COR 50FT N C/L AVE D & 50FT E C/L 210TH ST W (DIRT RD)	CL	1254
LANCASTR (1981)	2817.580	RDBM MON IN WELL MKD (1961) 7FT E PP NO (GONE) 27FT N C/L AVE D & 185FT W C/L 215TH ST W 2IN IP MKR 3FT UP 2FT N	CL	1258
LANCASTR (1981)	2811.137	RDBM MON IN WELL 14IN DN MKD (1961) 6FT NE PP NO (GONE) 33FT N C/L AVE D & 60FT W 220TH ST W (PROP) 2IN IP MKR 3FT UP 2FT N	CL	1260
LANCASTR (1981)	2824.440	RDBM MON IN WELL 12IN DN MKD (1961) 5FT NE PP NO (GONE) 28FT N C/L AVE D & 180FT W C/L 225TH ST W (PROP) 2IN IP MKR 3FT UP 2FT N	CL	1262
LANCASTR (1981)	2849.302	RDBM MON IN WELL MKD (1961) 30FT N C/L AVE D & 170FT W C/L 230TH ST W 5FT NE PP NO (GONE) 2IN IP MKR 3FT UP 2FT N	CL	1264
LANCASTR (1981)	2878.567	CS MON 22IN DN IN WELL @ C/L INT AVE D & 235TH ST W (TO NORTH) MKD (1/4 COR 14 23 T8N R16W RE 2177) S EDGE	CL	1265

QUAD-YEAR	ELEV	DESCRIPTION (INCLUDE QUAD AND YEAR IN DESCRIPTION)	BM	NUMBE
LANCASTR (1981)	2882.218	RDBM MON IN WELL MKD (1961) 5FT NE PP NO (GONE) 30FT N C/L AVE D & 180FT W C/L 235TH ST W 2IN IP 3FT UP 2FT N	CL	1266
LANCASTR (1981)	2918.933	CS MON 18IN DN @ C/L INT AVE D & 240TH ST W MKD (15 14 23 22 T8N R16W RE 2177) N EDGE	CL	1267
LANCASTR (1981)	2920.566	RDBM MON IN WELL 6FT E OF PP NO (GONE) 28FT N C/L AVE D & 160FT W C/L 240TH ST W 2IN IP 3FT UP 2FT N	CL	1268
LANCASTR (1981)	3014.948	USC&GS MON FLUSH 30FT SW C/L LANCASTER RD & 0.7MI SE AVE D 2FT SE OF WHITE POST MKD (V 305 1935) 2IN IP 3FT UP 0.5FT S	CL	1271
LANCASTR (1981)	3014.475	CSBM MON 6IN UP 50FT SW C/L AVE D-15 (LANCASTER RD) & 0.5MI W 235TH ST W @ CURVE TO NW 18FT S OF S EDGE PROD OF PVMT MKD (BM 102-56 1957)	CL	1272
LANCASTR (1981)	2972.353	CSBM MON 4IN UP 55FT S C/L LANCASTER RD & 575FT W C/L 235TH ST W 25FT E/O TP NO GT8034 MKD(BM 102-55 1957)	CL	1273
LANCASTR (1981)	2943.436	CSBM MON 6IN UP 30FT N C/L AVE D-15 (LANCASTER RD) & 0.25MI W 224TH ST W @ SE COR OLIVE GROVE MKD(BM 102-54 1957) 2IN IP 3FT UP 2FT N	CL	1274
LANCASTR (1981)	2884.641	USC&GS MON IN TOP OF 8IN CONC POST FLUSH 30FT N C/L LANCASTER RD & 0.25MI E/O 224TH ST W MKD(W 305 1935) 2IN IP 3FT UP 1FT S	CL	1275
LANCASTR (1981)	2880.522	CSBM MON 6IN UP 32FT N C/L AVE D-15 (LANCASTER RD & 0.8MI W/O 210TH ST W MKD(BM 102-52 1957) 2IN IP 3FT UP 1FT S	CL	1276
LANCASTR (1981)	2897.476	CSBM MON 6IN UP 49FT N C/L LANCASTER RD & 0.25MI W 210TH ST W MKD (BM 102-51 1957) 2IN IP 3FT UP 2FT S	CL	1277
LANCASTR (1981)	2930.547	CSBM MON 6IN UP 50FT S C/L LANCASTER RD & 1.0MI W/O AVE E-15 0.3MI E/O 210TH ST W MKD (BM 102-50 1957) 2IN IP 3FT UP 1FT N	CL	1278
LANCASTR (1981)	2953.045	USC&GS MON IN TOP OF 8IN CONC POST 14IN UP 30FT W CTR OF PVMT LANCASTER RD 0.45MI N AVE E-15 MKD (X-305 1935) 2IN IP 3FT UP 1FT E	CL	1279
LANCASTR (1981)	2953.406	CSBM MON FLUSH 11FT N C/L PROD LANCASTER D (FROM THE EAST) 67FT S C/L EXISTING PVMT & 0.5MI W/O 195TH ST W (PROP) 13FT W 2IN IP MKD (BM 102- 48 1957) 2IN IP 3FT UP 1FT N	CL	1280

QUAD-YEAR	ELEV	DESCRIPTION (INCLUDE QUAD AND YEAR IN DESCRIPTION)	BM NUMBER
LANCASTR (1981)	2900.732	CSBM MON IN WELL 8IN DN @ INT AVE E-15 (LANCASTER RD) & 195TH ST W 0.5MI W/O 190TH ST W & DN W LINE PROD OF LOT COR MKRS TO N MKD (BM 102-47 1957)	CL 1281
LANCASTR (1981)	2895.844	CSBM MON 6IN UP 55FT S C/L AVE F-8 (LANCASTER RD) & 81FT E C/L PROD 190TH ST W 27FT E PP 2163801E MKD (BM 102-45 1957) 2IN IP 3FT UP 2FT E	CL 1283
LANCASTR (1981)	2871.982	CSBM MON 4IN UP 51FT S C/L AVE F-8 (LANCASTER RD) & 0.5MI E 190TH ST W @ DIRT DRWY HSE 18350 3FT N PP 699381E MKD (BM 102-44 1957) 2IN IP 3FT UP 2FT N	CL 1284
LANCASTR (1981)	2831.571	CSBM MON 4IN UP 55FT S C/L AVE F-8 (LANCASTER RD) & 15FT W C/L 180TH ST W 3FT N PP 699364E MKD (BM 102-43 1957) SURVEY MKR 3FT UP 1FT N	CL 1285
LANCASTR (1981)	2807.973	CSBM MON 6IN UP 57FT S C/L AVE F-8 (LANCASTER RD) & 0.5MI W 170TH ST W 2FT W PP 699359E MKD (BM 102-42 1957) 2IN IP 3FT UP 2FT N	CL 1286
LANCASTR (1981)	2785.285	CSBM MON 4IN UP 36FT S C/L LANCASTER RD & 21FT E C/L PROD 170TH ST W MKD (BM 102-41 1957) SURVEY MKR 3FT UP 1FT N	CL 1287
LANCASTR (1981)	2784.285	USGS MON ON 3 1/2IN IP 43FT W C/L LANCASTER RD (167TH ST W) @ AVE F-8 2FT S FENCE COR MKD(2786)	CL 1288
LANCASTR (1981)	2790.748	CSBM MON FLUSH 2FT ABOVE RD GRADE 25FT N/O C/L LANCASTER RD & 0.5MI W/O 160TH ST W UNDER BARBED WIRE FENCE MKD (BM 102-39 1957)	CL 1289
LANCASTR (1981)	2782.762	CSBM MON 4IN UP 90FT NE C/L 160TH ST W & 0.4MI N LANCASTER RD @ CURVE TO W 29FT E PP NO 699344E MKD (BM 102-38 1957)	CL 1290
LANCASTR (1981)	2829.123	CSBM MON 12IN DN 34FT N C/L LANCASTER RD & 27FT W C/L 160TH ST W MKD (BM 102-37 1957)	CL 1291
LANCASTR (1981)	2748.912	USGS MON 4IN UP 42FT S C/L LANCASTER RD & 2.9MI W MUNZ RANCH RD 70FT E C/L PROD OF DIRT RD TO N 80FT E/O SEC LINE 5 6 T7N R14W MKD (R 39 1929)	CL 1293
LANCASTR (1981)	2679.857	CSBM MON 4IN UP 113FT S C/L LANCASTER RD & 2.4MI W MUNZ RANCH RD ON LEVEL AREA MIDWAY UP A RISE 307FT W OF FENCE COR & 1FT N FENCE MKD (BM 102-34 1957 RE 5869) 2IN IP 2FT N 3FT UP	CL 1294

QUAD-YEAR	ELEV	DESCRIPTION (INCLUDE QUAD AND YEAR IN DESCRIPTION)	BM NUMBER
LANCASTR (1981)	2623.124	CSBM MON 4IN UP 25FT N C/L LANCASTER RD & 1.8MI W MUNZ RANCH RD @ LINE BETWEEN SEC 4 5 T7N R14W UNDER FENCE 3FT W/O COR MKD (BM 102-33 1957 RE 5869) 51FT N PP NO 1559840E & 30FT SW GUY POLE 2014789E	CL 1295
LANCASTR (1981)	2604.402	CSBM MON 3IN UP 25FT N C/L LANCASTER RD & 1.1MI W MUNZ RANCH RD NR PI OF CURVE 3FT S FENCE MKD (BM 102-32 1957 RE 5869) 90FT W/O PRIVATE ST 2IN IP 1FT S 3FT UP	CL 1296
LANCASTR (1981)	2584.979	USC&GS MON FLUSH 4FT BELOW RD GRADE 42FT S C/L LANCASTER RD & 0.7MI W MUNZ RANCH RD 2FT N FENCE MKD (Z 305 1935) 2IN IP 1FT N 3FT UP	CL 1297
LANCASTR (1981)	2581.557	CSBM MON 4IN UP 46FT S C/L LANCASTER RD & 0.5MI W MUNZ RANCH RD 1FT NE FENCE MKD (BM 102-30 1957 RE 5869) 2IN IP 1FT N 3FT UP 55FT SE PP NO 1559802E	CL 1298
LANCASTR (1981)	2567.827	CSBM MON FLUSH 27FT N C/L LANCASTER RD & 30FT W C/L MUNZ RANCH RD 0.6FT N FENCE & 4FT E PP 402818E MKD (BM 102-29 1957 RE 5869)	CL 1299
LANCASTR (1981)	2535.336	CSBM MON 4IN DN 42FT N C/L LANCASTER RD 232FT W/O 120TH ST W MKD (102-28 1958 RE 5869) NO BUTTON 2IN IP 2FT S 3FT UP NR MILEAGE MKR 12.03	CL 1300
LANCASTR (1981)	2546.503	CSBM MON FLUSH 25FT N C/L PROD AVE I & 55FT E C/L PROD 120TH ST W 50FT SE PP NO 2109621E MKD (BM 102-27 1957 RE 5869) BUTTON GONE	CL 1301
LANCASTR (1981)	2519.723	CS MON IN WELL 10IN DN @ C/L INT AVE I & 115TH ST W MKD (1/4 COR 11 14 R14W T7N) USE N EDGE	CL 1302
LANCASTR (1975)	2497.273	CS MON IN WELL 18IN DN 5FT N C/L INT 110TH ST W & AVE I MKD(CO SUR 11 12 13 14 T7N R14W RE 2177)	CL 1303
LANCASTR (1981)	2586.073	CSBM MON 6IN UP 34FT NW C/L MUNZ RANCH RD & 0.4MI S LANCASTER RD 160FT S DIRT DRWY HSE 45715 1FT W INT 4FT BARBED WIRE FENCES MKD (BM 113-8 1960 RE 5869) 2IN IP 2FT SE 3FT UP	CL 1315
LANCASTR (1981)	2617.706	CSBM MON 4IN DN 2FT BELOW PVMT GRADE 26FT SE C/L MUNZ RANCH RD 0.8MI S LANCASTER RD MKD (BM 113-7 1960 RE 5869) 2IN IP 3FT UP 2FT W	CL 1316
LANCASTR (1981)	2676.842	CSBM MON 6IN UP 32FT N C/L MUNZ RANCH RD & 3.0MI N ELIZABETH LAKE RD 1100 FT NE POWER LINE CROSSING MKD (BM 113-6 1960 RE 5869) 2IN IP 3FT UP 2FT N	CL 1317

QUAD-YEAR	ELEV	DESCRIPTION (INCLUDE QUAD AND YEAR IN DESCRIPTION)	BM NUMBER
LANCASTR (1981)	2804.026	CSBM MON 2FT DN 4FT BELOW PVMT GRADE 30FT S C/L MUNZ RANCH RD & 2.1MI N ELIZABETH LAKE RD @ EAST END OF CULVERT @ MILEAGE MARKER 2.30 MKD (BM 113-4 1960 RE 5869)	CL 1319
LANCASTR (1981)	3069.256	CSBM MON 6IN UP 33FT N C/L MUNZ RANCH RD & 1.1MI N ELIZABETH LAKE RD 160FT NE TP 29139M & 120FT NW TP 29138M MKD (BM 113-2 1960)	CL 1321
LANCASTR (1981)	3233.509	CSBM MON 6IN DN 27FT E C/L MUNZ RANCH RD 0.55 MI N ELIZABETH LAKE RD 2FT E PP 307253E MKD (BM 113-1 1960 RE 5869) 2IN IP 3FT UP 2FT E	CL 1322
LANCASTR (1981)	3296.655	CSBM MON 6IN DN 44FT E/O C/L MUNZ RANCH RD 71FT N/O C/L ELIZABETH LAKE RD 3FT N/O PP 29176M MKD (BM 111-32 1960 RE 5869) 2IN IP 2FT ELY 2FT UP	CL 1323
LANCASTR (1981)	3286.620	L&BT SPK 1FT FROM N END W HDWL 79FT S & 35FT W C/L INT ELIZABETH LAKE RD & RANCH CLUB RD	CL 1325
BASELINE (1973)	3332.668	CS MON 2IN UP 27FT N & 38FT E C/L INT ELIZABETH LAKE RD & JOHNSON RD @ INT W C/L DR TO ELIZABETH MISSION CHATHOLIC CHURCH MKD (PC 21 RE 63)	CL 1327
BASELINE (1973)	3329.772	US FOREST RESERVE IP & MON 30FT S & 40FT E C/L INT JOHNSON RD & ELIZABETH LAKE RD @ NW COR 4FT BARBED WIRE FENCE 3FT W PP NO 107478E MKD (BOUNDARY POST NO 83 1905)	CL 1328
LANCASTR (1981)	2971.836	CSBM MON 6IN UP 61FT N C/L HWY 138 & 0.45MI W 245TH ST W ON W SIDE DIRT DR HSE 24715 & 10FT NW PP NO (GONE) MKD (BM 102-59 1957) 2IN IP 3FT UP 1FT S	CL 1479
LANCASTR (1981)	3017.785	CSBM MON 6IN UP 29FT N C/L HWY 138 & 0.9MI W 245TH ST W 6FT W PP NO (GONE) MKD (BM 102-60 1957 RE 5869) USC&GS MKR 2FT UP 1FT S	CL 1480
LANCASTR (1981)	3046.370	LAC DEPT WATER & POWER MON ON 3IN IP FLUSH 26FT S C/L LANCASTER RD & 17FT E/O CTR DIRT DR 0.2MI E/O THREE POINTS RD MKD (104A BENCH MARK) USC&GS MKR 0.5 N	CL 1481
LANCASTR (1981)	3052.362	CSBM MON 29FT N C/L LANCASTER RD & 0.35MI W/O THREE POINTS RD 6FT W/O PP NO (GONE) & 12FT SE 4FT IRRIGATION STANDPIPE MKD (BM 102-62 1957) 2IN IP MKR 3FT UP 2FT W	CL 1482
LANCASTR (1981)	3051.125	CSBM MON 6IN UP 70FT S C/L LANCASTER RD 89FT E/O BC OF CURVE TO N INTO 270TH ST W MKD (102-63 1957 RE 5869) 68FT W/O GUY POLE NO 1123728E USC&GS MKR 2FT UP 1FT N	CL 1483

QUAD-YEAR	ELEV	DESCRIPTION (INCLUDE QUAD AND YEAR IN DESCRIPTION)	BM NUMBER
LANCASTR (1981)	2992.102	USC&GS MON 2IN UP 60FT S C/L LANCASTER RD @ W END CURVE FROM 270TH ST W OPPOSITE HSE NO 27011 22FT SW PP NO (GONE) MKD (U305 1935) 2IN IP 3FT UP 2FT N	CL 1484
LANCASTR (1981)	3009.136	BT SPK 1FT N/O S END OF HDWL OF CULV 29FT S C/L LANCASTER RD & 0.4MI W/O 270TH ST W MKD(102-65A)	CL 1486
LANCASTR (1981)	3037.045	CSBM MON 3IN UP 49FT S C/L LANCASTER RD @ 280TH ST W 4FT W/O PP NO 1122597E MKD (BM 102-66 1957) USC&GS MKR 1FT N	CL 1487
LANCASTR (1981)	3043.249	CSBM MON 2IN UP 49FT S C/L LANCASTER RD & 190FT W C/L INT MARAGLO ST (DIRT) @ METTLER VALLEY HOME SITES 4FT W/O PP NO (GONE) MKD (BM 102-67 1957) USC&GS MKR 1FT N	CL 1488
LANCASTR (1981)	3020.538	USC&GS MON 10IN DN 49FT S C/L LANCASTER RD @ DIRT RD TO HSE NO 29300 1.0MI E/O 300TH ST W 19FT E/O FENCE COR 83FT E/O CULV 82FT E/O PP NO 1123700E MKD(T 305 1935) 2IN IP 3FT UP 1FT N	CL 1489
LANCASTR (1981)	3041.971	CSBM MON 6IN UP 49FT S C/L HWY 138 & 0.5MI E 300TH ST W 4FT W PP NO (GONE) & 39FT E/O FENCH LINE PROD MKD (BM 102-69 1957) USC&GS MKR 1FT N	CL 1490
LANCASTR (1981)	3044.053	CSBM MON 6IN UP 48FT S C/L HWY 138 & 215FT E C/L 300TH ST W OPP HSE 29853 4FT W PP 1123722E & 6FT E/O FENCE COR MKD (BM 102-70 1957) USC&GS MKR 1FT N	CL 1491
LANCASTR (1981)	3088.282	CSBM MON 4IN UP 50FT NW C/L HWY 138 & 0.6MI W 300TH ST W 87FT W OF W END HDWL CULV 211&43 10FT N PP NO (GONE) & 5FT SW FENCE COR MKD (BM 102-71 1957 RE 5869) USC&GS MKR 1FT S	CL 1492
LANCASTR (1981)	3123.361	CSBM MON 6IN UP 49FT S C/L HWY 138 & 3.4MI E OLD RIDGE RTE 16FT W CATTLE GATE MKD (BM 102-72 1957) USC&GS MKR 1FT N	CL 1493
LANCASTR (1981)	3143.859	CSBM MON 2IN UP 49FT S C/L HWY 138 & 2.8MI E/O OLD RIDGE RTE 20FT S/O S END HDWL CULV 156+09 MKD (BM 102-73 1957) USC&GS MKR 1FT N	CL 1494
LANCASTR (1981)	3169.329	CSBM MON 6IN UP 48FT S C/L HWY 138 & 2.4MI E OLD RIDGE RTE 18FT S OF S END CULV A133+60 MKD (BM 102-74 1957) USC&GS MKR 1FT N	CL 1495
LANCASTR (1981)	3209.929	CSBM MON 4IN UP 48FT S C/L LANCASTER RD (HWY 138 16FT S/O S END CONC HDWL & 1.8MI E/O OLD RIDGE RTE RD MKD (BM 102-75 1957) USC&GS MKR 1FT N	CL 1496

QUAD-YEAR	ELEV	DESCRIPTION (INCLUDE QUAD AND YEAR IN DESCRIPTION)	BM NUMBER
LANCASTR (1981)	3270.953	USC&GS MON FLUSH 50FT N C/L HWY 138 & 1.4MI E OLD RIDGE RTE 485FT E CULV 75+78 75FT E PP NO (GONE) MKD (R 305 1935) 2IN IP 3FT UP 1FT S	CL 1497
LANCASTR (1981)	3339.285	CSBM MON 6IN UP 49FT S C/L HWY 138 & 0.75MI E OLD RIDGE RTE 17FT S OF S END CONC HDWL CULV 51+ 15 MKD (BM 102-77 1957) USC&GS MKR 1FT N	CL 1498
LANCASTR (1981)	3395.615	CSBM MON 6IN UP 48FT S C/L HWY 138 & 0.4MI E OLD RIDGE RTE 10FT E FENCE COR MKD (BM 102-78 1957) 2IN IP 3FT UP 1FT N	CL 1499
LANCASTR (1981)	3335.325	USC&GS MON 5IN UP 37FT S C/L GORMAN POST RD @ INT W/DIRT RD TO S 25FT W/O SW COR OF CATTLE GUARD 6FT N/O PP NO 1699201E 0.1MI W/O INT OF LANCASTER RD MKD(Q 452 1953) MKR POST 1.7FT W	CL 1506
LANCASTR (1981)	3382.965	USC&GS MON 9IN UP 94FT SE C/L GORMAN POST RD (HWY 138) 0.4MI W/O LANCASTER RD ON SW SIDE OF SMALL HILL 9FT S/W OF PP NO 1707769E MKD (Z53 1926 RESET 1953) MKR POST 2FT W	CL 1507
LANCASTR (1981)	3398.972	USC&GS MON 4FT W/O E END N HDWL OF CULV NO 0.60 21FT N C/L GORMAN POST RD & 0.5MI W/O LANCASTER RD MKD(P 452 1953)	CL 1508
LANCASTR (1981)	3585.117	USC&GS MON 5IN UP 48FT NE C/L GORMAN POST RD & 1.1MI W/O LANCASTER RD 24FT S C/L DIRT RD TO E MKD(B 370 1953) MKR POST 1.8FT NW	CL 1510
LANCASTR (1981)	3562.646	USC&GS MON 6IN UP 82FT N C/L GORMAN POST RD & 1.2MI W/O LANCASTER RD @ W END OF CUT 25FT NW C/L DIRT RD TO NE MKD(M452 1953) MKR POST 1.4FT W	CL 1511
LANCASTR (1981)	3482.094	USC&GS MON 1FT W/O E END S HDWL OF CULV NO 1.80 28FT S C/L GORMAN POST RD 1.6MI W/O LANCASTER RD MKD(L 452 1953)	CL 1512
LANCASTR (1981)	3458.873	USC&GS MON 4IN UP 41FT S C/L GORMAN POST RD & 1.8MI W/O LANCASTER RD 30FT SW OF S END OF CULV NO 2.00 MKD(A 370 1953) MKR POST 1.5FT W	CL 1513
LANCASTR (1981)	3481.728	USC&GS MON 6IN UP 42FT S C/L GORMAN POST RD & 2.0MI W/O LANCASTER RD NR POWER LINE CROSSING 50FT W/O NW END S HDWL OF CULV NO 2.20 MKD(K 452 1953) MKR POST 1.5FT NW	CL 1514
LANCASTR (1981)	3485.442	USC&GS MON 5IN UP 31ST S C/L GORMAN POST RD & 2.3MI W/O LANCASTER RD 47FT W/O TP NO 25-41 MKD(J 452 1953) MKR POST 1.3FT W	CL 1515

QUAD-YEAR	ELEV	DESCRIPTION (INCLUDE QUAD AND YEAR IN DESCRIPTION)	BM NUMBER
LANCASTR (1981)	3512.914	USC&GS MON 5IN UP 36FT SW C/L GORMAN POST RD & 2.6MI W/O LANCASTER RD 68FT SE OF END OF S HDWL OF CULV NO 2.90 15FT W/O TP NO 15-41 MKD(A 54 1926) MKR POST 1.4FT E	CL 1516
LANCASTR (1981)	3558.441	USC&GS MON 5IN UP 39FT NE C/L GORMAN POST RD & 3.1MI W/O LANCASTER RD 79FT SE/O PP NO 1061807E MKD(G 452 1953) MKR POST 1.7FT SE	CL 1518
LANCASTR (1981)	3599.992	USC&GS MON 5IN UP 50FT N/O C/L GORMAN POST RD & 1.5MI E/O GORMAN SCHOOL RD 2FT W/O SE COR FENCE AROUND EDISON GORMAN SUB-STA 42FT NE/O PP NO (GONE) MKD (F 452 1953) MKR POST 1.7FT W	CL 1519
BASELINE (1973)	3057.730	USGS MON @ SE COR JOHNSON RD & DIRT RD TO FOOTHILL RANCH 105FT S APPROX C/L JOHNSON RD & 2.5MI E ELIZABETH LAKE RD MKD (R 43 1925)	CL 2066
BASELINE (1973)	3192.814	RDBM TAG CONC & ROCK HDWL 11.79 15FT N APPROX C/L JOHNSON RD & 2.1MI E ELIZABETH LAKE RD	CL 2067
BASELINE (1973)	3194.232	CSBM MON 6IN UP 28FT N APPROX C/L JOHNSON RD & 2.1MI E ELIZABETH LAKE RD 22FT NE CULV 11.79 MKD (BM 119-31 1961)	CL 2068
BASELINE (1973)	3347.390	CSBM MON 6IN UP 35FT N APPROX C/L JOHNSON RD & 1.6MI E ELIZABETH LAKE RD 31FT NE CULV 12.25 MKD (BM 119-32 1961)	CL 2069
BASELINE (1973)	3408.062	RDBM TAG CONC & ROCK HDWL 12.39 25FT N APPROX C/L JOHNSON RD & 1.5MI E ELIZABETH LAKE RD	CL 2070
BASELINE (1973)	3438.552	CS MON 6IN UP 200FT N APPROX C/L JOHNSON RD & 1.5MI E ELIZABETH LAKE RD MKD (1/4 COR 27 34 T7N R14W)	CL 2071
BASELINE (1973)	3522.765	CSBM MON 6IN UP 31FT S APPROX C/L JOHNSON RD & 1.25 MI E ELIZABETH LAKE RD @ SUBM MKD (BM 119-33 1961)	CL 2072
BASELINE (1973)	3455.350	CS MON 1IN DN 55FT S APPROX C/L JOHNSON RD & 1.0MI E ELIZABETH LAKE RD MKD (SEC COR 28 27 33 34 T7N R14W) USS N EDGE	CL 2073
BASELINE (1973)	3476.698	CSBM MON 6IN UP 38FT S APPROX C/L JOHNSON RD & 0.75MI E ELIZABETH LAKE RD NE E SIDE OF ENT LEONA VALLEY HUNTING CLUB MKD (BM 119-34 1961)	CL 2075
BASELINE (1973)	3415.085	CS MON FLUSH 100FT S APPROX C/L JOHNSON RD & 0.5MI E ELIZABETH LAKE RD MKD (1/4 COR 28 33 R14W T7N)	CL 2076

QUAD-YEAR	ELEV	DESCRIPTION (INCLUDE QUAD AND YEAR IN DESCRIPTION)	BM NUMBER
BASLINE (1973)	3408.120	L&DATE SPK SE CONC BASE TOWER 220/6 140FT N APPROX C/L JOHNSON RD & 0.4MI E ELIZABETH LAKE RD	CL 2077
BASLINE (1973)	3395.296	CSBM MON 6IN UP 28FT N APPROX C/L JOHNSON RD & 0.3MI E ELIZABETH LAKE RD MKD (BM 119-35 1961)	CL 2078
LANCASTR (1981)	2534.457	CS MON 14IN DN @ C/L INT 120TH ST W & FUT AVE H-8 MKD (1/4 COR 10 11 R14W T7N RE 2177) USE S EDGE 2IN IP MKR 3FT UP 2FT N	CL 2092
LANCASTR (1981)	2812.174	CS MON IN WELL 11IN DN @ C/L INT AVE D & FUT 220TH ST W MKD (T8N R15W SEC COR 13 18 19 24 RE2177) USE N EDGE	CL 2116
LANCASTR (1981)	2817.137	CS MON IN WELL 7IN DN @ C/L INT AVE D & 215TH ST W MKD (T8N R15W 1/4 SEC COR 18 19 RE 2177) USE N EDGE	CL 2117
LANCASTR (1981)	2817.299	CS MON IN WELL 8IN DN @ C/L INT AVE D & 210TH ST W MKD (T8N R15W SEC COR 18 17 20 19) SE EDGE	CL 2118
LANCASTR (1981)	2812.496	CS MON IN WELL 10IN DN @ C/L INT AVE D & 205TH ST W MKD (T8N R15W 1/4 SEC COR 17,20 RE 2177)	CL 2119
LANCASTR (1981)	2801.172	CS MON IN WELL 10IN DN @ C/L INT AVE D & FUT 200TH ST W MKD (T8N R15W SEC COR 17 16 21 20 RE 2177) USE S EDGE	CL 2120
LANCASTR (1981)	2772.322	CS MON IN WELL 24IN DN @ C/L INT AVE D & 190TH ST W MKD (T8N R15W SEC COR 16 15 21 22 RE 2177) USE S EDGE	CL 2121
LANCASTR (1981)	2713.865	CSBM MON (S SIDE) 15FT W & 30FT N C/L INT 175TH ST W & AVE D MKD (BM 117-39 1961 RE5869) 2IN IP MKR 3FT UP 2FT SE	CL 2124
LANCASTR (1981)	2563.273	CS MON IN WELL 7IN DN @ C/L INT 135TH ST W & AVE D MKD (1/R COR 16 21 T8N R14W RE5869)	CL 2126
LANCASTR (1981)	2527.901	USC&GS MON 6IN UP 45FT N & 8FT E C/L INT AVE D & 125TH ST W MKD (WIND 1952) 2IN IP 3FT UP 4FT E	CL 2127
LANCASTR (1975)	2488.977	CSBM MON 72FT S & 32FT E C/L INT AVE D-8 & 110TH ST W MKD (BM 119-42 1961)	CL 2131
LANCASTR (1975)	2481.324	CS MON (NE EDGE) IN WELL 18IN DN @ C/L INT 110TH ST W & AVE E MKD (CO SUR 23 24 25 26 R14W T8N)	CL 2132
LANCASTR (1975)	2485.274	CSBM MON 6IN UP 117FT S & 30FT W C/L INT 110TH ST W & FUT AVE E MKD (BM 119-43 1961)	CL 2133

QUAD-YEAR	ELEV	DESCRIPTION (INCLUDE QUAD AND YEAR IN DESCRIPTION)	BM NUMBER
LANCASTR (1975)	2494.262	CS MON IN WELL 13IN DN @ C/L INT 110TH ST W & AVE E-8 30FT E PP 1222609E MKD (CO SUR 1/4SEC COR 25 26 T8N R14W)	CL 2134
LANCASTR (1975)	2496.363	CSBM MON 6IN UP 110FT S & 30FT W C/L INT 110TH ST W & AVE E-8 110FT S PP 1222609E MKD (BM 119-44 1961)	CL 2135
LANCASTR (1975)	2516.189	CSBM MON 6IN UP 260FT S & 35FT W C/L INT 110TH ST W & FUT AVE F MKD (BM 119-45 1961)	CL 2137
LANCASTR (1975)	2514.869	CS TRI STA MON 8IN UP 493FT S & 38FT W C/L INT AVE F & 110TH ST W MKD (DEL SUR G-1 ECC 1 1964)	CL 2138
LANCASTR (1975)	2490.811	CSBM MON 6IN UP 240FT S & 30FT W C/L INT 110TH ST W & AVE F-8 92FT N PP 1222581E MKD (BM 119-46 1961)	CL 2140
LANCASTR (1975)	2493.009	CS MON (N EDGE) IN WELL 12IN DN @ C/L INT 110TH ST W & AVE G MKD (SEC COR 35 36 1 2 R14W T7N T8N)	CL 2141
LANCASTR (1975)	2494.373	CS MON (W EDGE) IN WELL 12IN DN @ C/L INT 110TH ST W & AVE G-8 MKD (1/4 COR 1 2 R14W T7N)	CL 2143
LANCASTR (1975)	2499.024	CSBM MON 35FT W C/L 110TH ST W & 365FT S AVE G-8 MKD (BM 119-21 1961)	CL 2144
LANCASTR (1975)	2494.618	CS MON (E EDGE) IN WELL 24IN DN @ C/L INT 110TH ST W & AVE H MKD (SEC COR 1 2 11 12 T7N R14W)	CL 2145
LANCASTR (1975)	2500.017	CS MON (E EDGE) IN WELL 12IN DN @ C/L INT 110TH ST W & AVE H-8 MKD (1/4 COR 11 12 T7N R14W)	CL 2147
LANCASTR (1975)	2504.622	CS MON IN WELL 8IN DN @ C/L INT 110TH ST W & AVE I-8 MKD (1/4 COR 13 14 T7N R14W RE 5869)	CL 2149
LANCASTR (1975)	2535.534	USC&GS TRI STA MON FLUSH ON SW COR AVE J & 110TH ST W 45FT W & 40FT S C/L INT MKD (SUR 1932)	CL 2152
LANCASTR (1975)	2581.323	CS MON IN WELL 17IN DN @ C/L INT 110TH ST W & AVE J-8 MKD (1/4 COR 23 24 T7N R14W RE 5869) USE N EDGE	CL 2154
LANCASTR (1975)	2681.629	CSBM MON 6IN UP ON SW COR AVE K & 110TH ST W 82FT S & 27FT W C/L INT MKD (BM 119-27 1961)	CL 2157
LANCASTR (1981)	2855.260	CS MON IN WELL 11IN DN @ C/L INT AVE D-8 & 210TH ST W MKD (1/4 COR 19 20 R15W T8N RE 2177)	CL 2201

