

**COUNTY OF LOS ANGELES**  
**ROAD DEPARTMENT**

**PRECISE**  
**BENCH MARK LIST**



**NORWALK QUAD**

**1975 ADJUSTMENT**

## P R E F A C E

The Road Department level net is composed of more than 1,500 miles of levels supporting in excess of 18,000 bench marks. In 1975, a major readjustment of the net was undertaken. To emphasize the complete break with previous elevations, the BY,BG & BL series bench marks have been relabeled CY,CG & CL, respectively.

To facilitate the adjustment, indexing, and distribution of adjusted values of the net, the County territory is divided into 34 quads or areas. For identification purposes each quad is given a name, viz., "Rosemead," "La Mirada," "Santa Fe," etc. When bench marks and elevations in the Road Department net are used, the name of the quad in which the bench mark is located and the date of the adjustment of the elevation must be included in the bench mark description, e.g.,

CG 6234 --L+BN IN CONC HDWL OF DRAIN PIPE UNDER DR 218 FT  
NE+18 FT SE C/L INT GRAND AVE + CAMERON AVE MKD (BM)  
(COVINA --1975) ELEV. 696.238

Experience indicates that this general adjustment will, for the most part, remain sound for the next 10 years. Updating constrained adjustments will be made in 5 years. It is expected that these updating adjustments will be in the nature of a few hundredths of a foot. When a quad is readjusted, new elevation lists will be published and the date of the readjustment will replace the "1975" at the end of the bench mark description. Two bench marks with different adjustment dates will not normally agree with each other.

The basic accuracy of the net is reflected by an indicated field probable error of plus or minus 0.012 foot per mile of leveling as determined from over 600 conditions of closure. However, many years experience in vertical control in the greater Los Angeles basin and Antelope Valley indicate that because of varying degrees of subsidence and heaving, the true datum is recovered only by obtaining substantial agreement of a number of bench marks.

The users of this net are invited to assist in its maintenance by notifying this Department of cases of obliteration, apparent mistakes in descriptions or elevations, and proven disturbance of bench marks.

---

DATUM: U. S. Coast and Geodetic Survey Sea Level Datum  
of 1929, through the medium of the Los Angeles  
County Engineer Precise Level Net.

ABBREVIATIONS USED IN BENCH MARK LISTINGS

ABUT - - - - -	Abutment	EC - - - - -	End of Curve
ALG - - - - -	Along	ENT - - - - -	Entrance
ANG PT - - - - -	Angle Point	FL - - - - -	Floor
B/W - - - - -	Back of Walk	FTG - - - - -	Footing
BCR - - - - -	Beginning of Curb Return	F/W - - - - -	Front of Walk
BC - - - - -	Beginning of Curve	GAR - - - - -	Garage
BLDG - - - - -	Building	HDWL - - - - -	Headwall
BM - - - - -	Bench Mark	HSE - - - - -	House
BT SPK - - - - -	Boat or Bolt Spike	INT - - - - -	Intersection
BR CAP - - - - -	Brass or Bronze Cap	IP - - - - -	Iron Pipe
C B - - - - -	Catch Basin	LT - - - - -	Left
CTR - - - - -	Center	LACE - - - - -	L. A. City Engineer
C/L - - - - -	Center Line	LACS - - - - -	L. A. County Engineer
C/L INT - - - - -	Center Line Intersection	L AFC - - - - -	L. A. Co. Flood Control
C/L PROD - - - - -	Center Line Produced	L+BN - - - - -	Lead and Bench Nail
CONC - - - - -	Concrete	L+BR - - - - -	Lead and Brad
COR - - - - -	Corner	L+N - - - - -	Lead and Nail
COE - - - - -	Corps of Engineers	L+RDEM TAG - - - - -	Lead and Road Dept. Bench Mark Tag
CULV - - - - -	Culvert	L+SPK - - - - -	Lead and Spike
CB - - - - -	Curb	L+T - - - - -	Lead and Tack
CS MON - - - - -	County Engineer Monument	MCR - - - - -	Middle of Curb Return
CS BR CAP - - - - -	County Engineer Brass Cap	MKD - - - - -	Marked
CT SPK - - - - -	Cut Spike	MC - - - - -	Middle of Curve
DR - - - - -	Drive or Driveway	MON - - - - -	Monument
E/O - - - - -	East of	N/O - - - - -	North of
ECR - - - - -	End of Curb Return	NR - - - - -	Near

ABBREVIATIONS USED IN BENCH MARK LISTINGS . . . CONTINUED

OPP - - - - - Opposite  
PI - - - - - Point of Intersection  
PK+W - - - - - PK Nail and Washer  
P/L - - - - - Property Line  
POST - - - - - Point on Semi-Tangent  
PP - - - - - Power Pole  
PVMT - - - - - Pavement  
PROD - - - - - Produced  
RD - - - - - Road  
RDBM - - - - - Road Dept. Bench Mark  
RR - - - - - Railroad  
RT - - - - - Right  
R/W - - - - - Right of Way  
SDMH - - - - - Storm Drain Manhole  
SMH - - - - - Sewer Manhole  
SPK - - - - - Spike  
ST+W - - - - - Spike Tin and Washer  
S/O - - - - - South of  
TP - - - - - Telephone Pole  
USC+GS - - - - - U. S. Coast and Geodetic Survey  
USGS - - - - - U. S. Geological Survey  
WK - - - - - Walk  
W/O - - - - - West of

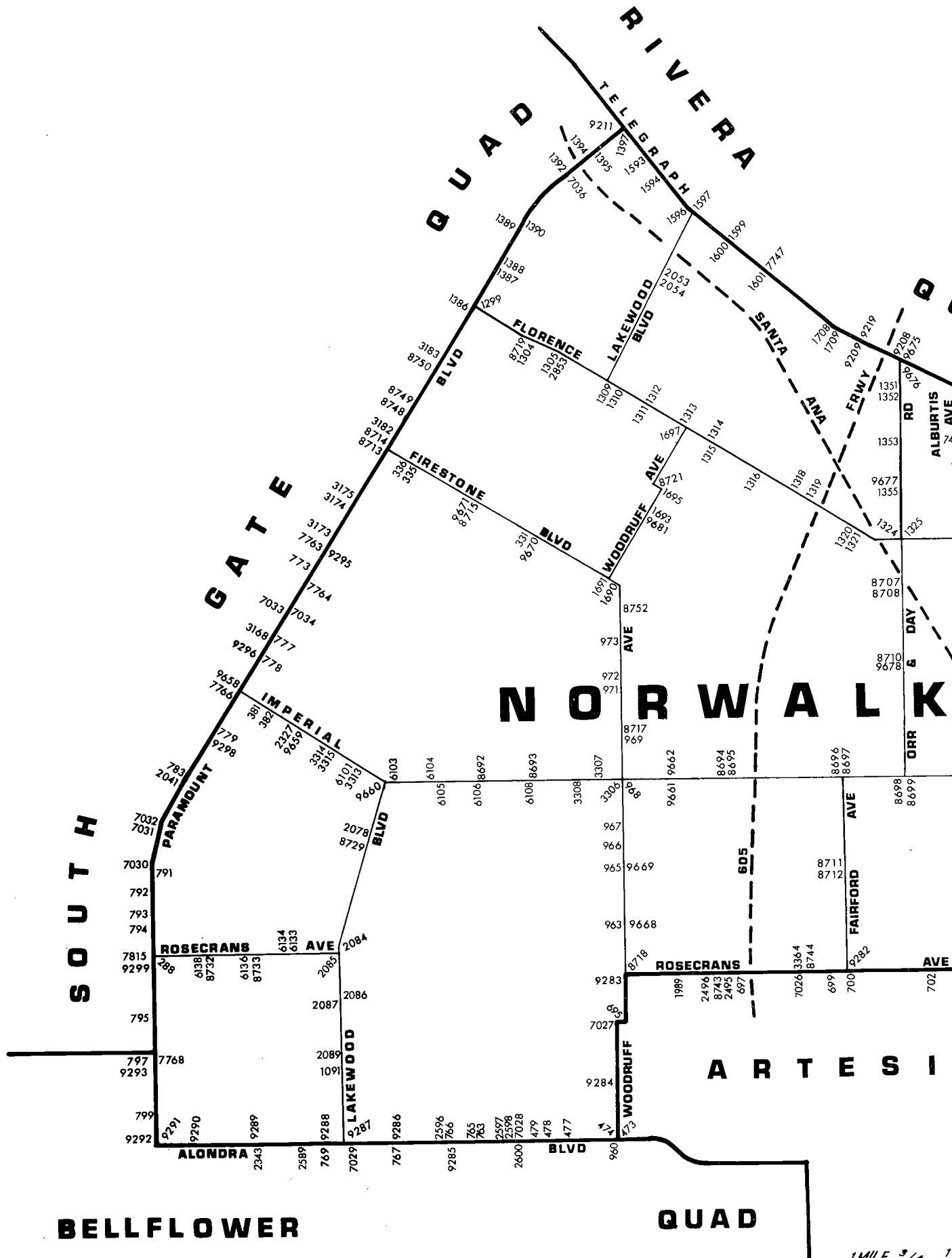

1 MILE 3/4 1

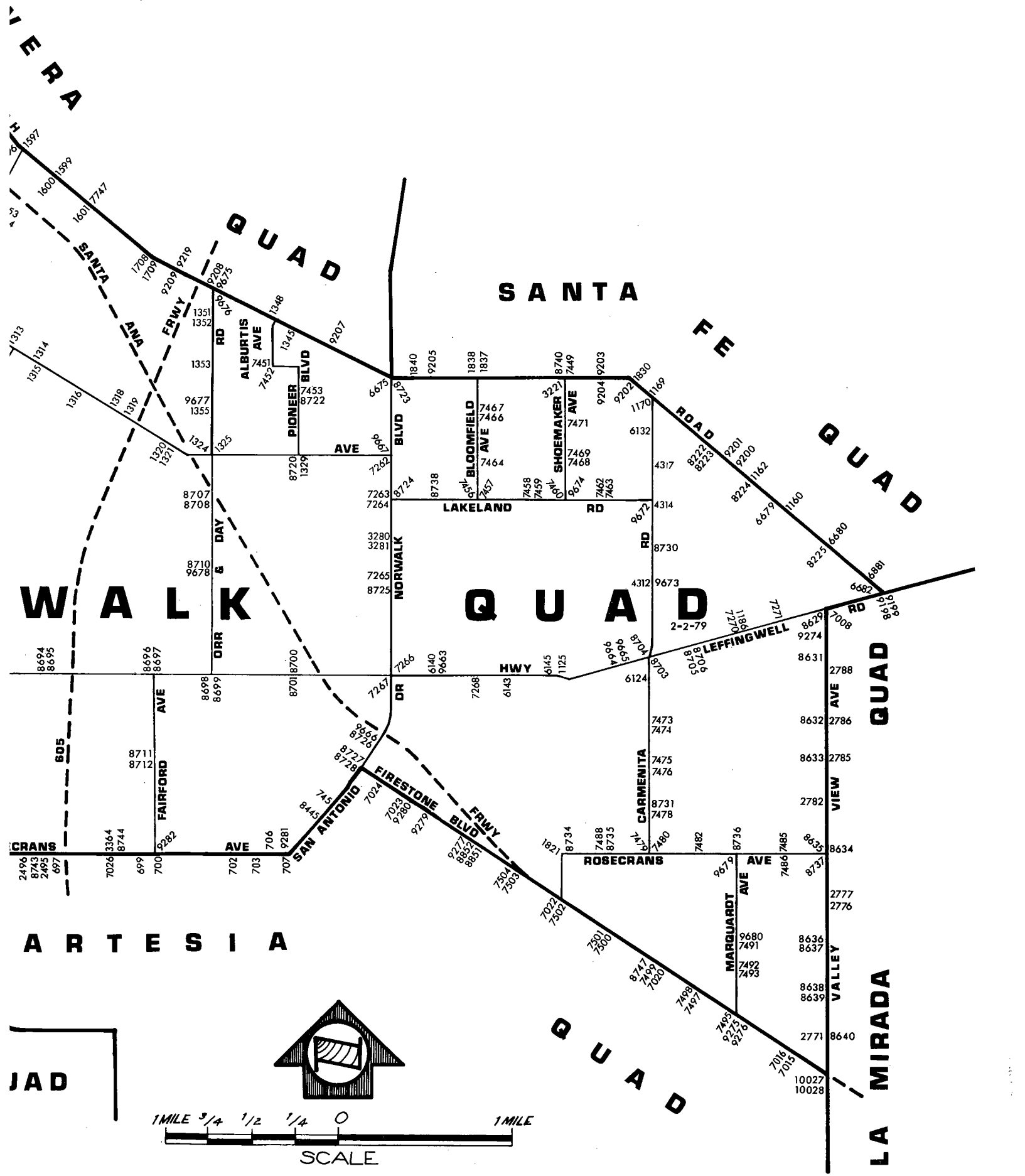

**WALK QUAD**

**SANTA FE QUAD**

**LA MIRADA QUAD**

**ARTESIA**

**JAD**

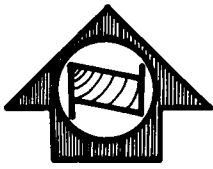

**SCALE**

QUAD-YEAR	ELEV	DESCRIPTION (INCLUDE QUAD AND YEAR IN DESCRIPTION)	BM NUMBER
BASELINE (1975)	73.432	4.5 IN IP WITH L&T 6IN BACK WK ON SE COR PARAMOUNT BLVD & ROSECRANS AVE 244FT S C/L 50FT E C/L INT MKD (LAC 32)	CY 288
NORWALK (1975)	111.563	L&T S CB FIRESTONE BLVD 1FT E CB RET @ NASH AVE 38FT S & 29FT E/O C/L INT	CY 331
NORWALK (1975)	113.245	L&T S CB FIRESTONE BLVD 1FT E CB RET @ SE COR LA RENA AVE 38FT S & 31FT E C/L INT	CY 335
NORWALK (1975)	112.486	L&T CB FIRESTONE BLVD 1 FT E CB RET @ SE COR MYRTLE ST 38FT S & 32FT E C/L INT	CY 336
NORWALK (1975)	96.158	L & BN 1FT E BCR @ SE COR IMPERIAL HWY & BROCK AVE 75FT S & 45FT E/O C/L INT MKD (BM ZA5)	CY 381
NORWALK (1975)	96.505	L & T SE COR IMPERIAL HWY & ORIZABA AVE 40FT E & 75FT S/O C/L INT MKD (BM)	CY 382
BASELINE (1975)	92.748	L&T 5FT E CB RET @ NE COR SYCAMORE ST & SAN ANTONIO DR 74FT E & 18FT N C/L INT	CY 445
BASELINE (1975)	73.117	CS REF MON IN WELL 14IN DN ON NE COR ALONDRA BLVD & WOODRUFF AVE 56FT N & 60FT E/O C/L INT MKD (CLEARWATER K 2A)	CY 473
BASELINE (1975)	73.744	CSBM MON FL ON NW COR ALONDRA BLVD & WOODRUFF AVE 39FT N & 180FT W C/L INT MKD (BM 6-6A1958)	CY 474
BASELINE (1975)	74.723	L&N 18FT E C/L ENCALYPTUS AVE & 80FT S C/L ALONDRA BL	CY 477
BASELINE (1975)	75.185	L & T 15FT E C/L LEAHY AVE & 80FT N C/L ALONDRA BL	CY 478
BASELINE (1975)	75.165	L & T 15FT W C/L LEAHY AVE & 80FT N C/L ALONDRA BL	CY 479
BASELINE (1975)	80.782	RD HD SPK&L W CB 28FT N BCR @ NW COR WOODRUFF AVE & WASHINGTON ST 70FT N & 40FT W C/L INT MKD ( MV 26)	CY 695
BASELINE (1975)	87.493	FC BRONZE DISC @ SW COR DAIRY PLATFORM 75FT N C/L ROSECRANS AVE 300FT E SAN GABRIEL RIVER BRIDGE ( BM 75-9C )	CY 697
BASELINE (1975)	84.396	L&N 1FT E BCR @ SE COR ROSECRANS AVE & CROSSDALE AVE 40FT S & 50FT E C/L INT	CY 699
BASELINE (1975)	84.684	L&N 1FT E BCR @ SE COR ROSECRANS AVE & ELMCROFT AVE 40FT S & 50FT E C/L INT	CY 700

QUAD-YEAR	ELEV	DESCRIPTION (INCLUDE QUAD AND YEAR IN DESCRIPTION)	BM NUMBER
BASELINE (1975)	85.053	L&N 1FT E BCR @ SE COR ROSECRANS AVE & GARD AVE 38FT S & 50FT E C/L INT	CY 702
BASELINE (1975)	86.646	L&N 1FT S BCR @ SE COR ROSECRANS AVE & JERSEY AVE 68FT S & 18FT E C/L INT	CY 703
BASELINE (1975)	86.391	CS MON IN WELL 13IN DN ON NW COR ROSECRANS AVE & PIIONEER BLVD 86FT N & 40FT W C/L INT MKD (WHITTIER C 124 1959)	CY 706
BASELINE (1975)	86.923	RDBM MON FLUSH IN CONC SQ POST ON SW COR ROSECRANS AVE & ARLEE AVE 83FT S & 20FT W C/L INT MKD (BM 184)	CY 707
BASELINE (1975)	71.783	L&T 2FT W CB RET NW COR RYON AVE & ALONDRA BLVD 38FT N & 32FT W C/L INT	CY 763
BASELINE (1975)	73.661	L&BN S CB ALONDRA BLVD 6IN E CB RET @ SE COR ALONDRA BLVD & PACIFIC AVE 70FT W PERR	CY 765
BASELINE (1975)	68.586	L & SPK 4FT E CB RET @ NE COR CLARK AVE & ALONDRA BLVD 38FT N & 59FT E C/L INT	CY 766
BASELINE (1975)	69.592	L&T C/L INT VIRGINIA DR & ALONDRA BLVD	CY 767
BASELINE (1975)	68.374	L&T C/L INT PITTS AVE & ALONDRA BLVD	CY 769
BASELINE (1975)	108.417	L&SPK IN WK 55FT N/O C/L COLE ST & 50FT W/O C/L PARAMOUNT BLVD MKD ( 0-31 )	CY 773
BASELINE (1975)	104.856	L&T 14FT E C/L PARAMOUNT BLVD 11FT N C/L SPRINGER ST PROD IN CONC PVMT	CY 777
BASELINE (1975)	103.961	L&T IN CONC 14FT E C/L PARAMOUNT BLVD 4FT N C/L QUILL DR PROD	CY 778
BASELINE (1975)	90.416	L & T 1FT N BCR @ NE COR PARAMOUNT BLVD & ADOREE AVE 58FT N & 38FT E C/L INT	CY 779
BASELINE (1975)	82.561	CS MON 16FT W & 5FT S INT PARAMOUNT BLVD & GARDENDALE ST	CY 783
BASELINE (1975)	77.754	L & T 10FT S BCR INTO CB RET @ NE COR PARAMOUNT BLVD & CENTURY BLVD 2FT N & 41FT E C/L INT	CY 791
BASELINE (1975)	76.271	BT SPK 1FT S BCR @ SW COR PARAMOUNT BLVD & PEARLE ST 32FT S & 38FT W C/L INT MKD (H-110)	CY 792
BASELINE (1975)	75.489	BT SPK BCR @ SW COR PARAMOUNT BLVD & HOWE ST 30FT S & 38FT W C/L INT	CY 793



QUAD-YEAR	ELEV	DESCRIPTION (INCLUDE QUAD AND YEAR IN DESCRIPTION)	BM NUMBER
BASELINE (1975)	76.316	BT SPK CTR CB RET @ NW COR PARAMOUNT BLVD & ROSE ST 18FT N & 40FT W C/L INT MKD (H 112)	CY 794
BASELINE (1975)	71.548	L & T IN CB 38FT W C/L PARAMOUNT BLVD ON THIRD ST C/L PROD	CY 795
BASELINE (1975)	72.315	CS MON 17FT W/O C/L PARAMOUNT BLVD ON C/L COMPTON BLVD MKD ( RE 2177 CLEARWATER )	CY 797
BASELINE (1975)	68.556	L&T W CB PARAMOUNT BLVD 2FT N CB RET @ NW COR MADISON ST & PARAMOUNT BLVD	CY 799
BASELINE (1975)	73.494	L&T IN S CB ALONDRA BLVD 1FT E INTO RET 68FT W C/L WOODRUFF AVE & 38FT S/O C/L ALONDRA BLVD	CY 960
NORWALK (1975)	87.907	RDBM TAG W CB WOODRUFF AVE 40FT W/O C/L 20FT S/O C/L PROD ARTHURDALE ST	CY 963
NORWALK (1975)	90.438	L&T N CB 1.5FT W BCR @ NW COR WOODRUFF AVE & FOSTER RD 36FT N/O & 100FT W/O C/L INT MKD (BM)	CY 965
NORWALK (1975)	91.003	L&T 1FT W ECR @ SW COR WOODRUFF AVE & BELCHER ST 18FT S & 91FT W C/L INT MKD ( BM )	CY 966
NORWALK (1975)	91.778	L&T 1FT S BCR @ SW COR RATLIFFE ST & WOODRUFF AVE SERVICE RD 47FT S & 72FT W C/L INT MKD (BM)	CY 967
NORWALK (1975)	95.392	RDBM TAG S CB 5FT W/O BCR @ SE COR IMPERIAL HWY & WOODRUFF AV 41FT S/O & 65FT E/O C/L INT	CY 968
NORWALK (1975)	98.369	LS TAG NO 2428 E CB WOODRUFF AVE ON OR NEAR C/L PROD EVEREST ST 55FT E/O C/L IN ENTRANCE TO SCHOOL BUS DRIVE	CY 969
NORWALK (1975)	100.650	RDBM TAG W CB 45FT S/O BCR @ SW COR WOODRUFF AVE & WASHBURN RD 90FT S/O & 40FT W/O C/L INT	CY 971
NORWALK (1975)	100.404	CS MON IN WELL 10 INCHES DN @ OR NEAR C/L INT WOODRUFF AVE & WASHBURN RD MKD (CO SUR MON RE329)	CY 972
NORWALK (1975)	103.777	RDBM TAG W CB 1FT S/O BCR @ SW COR WOODRUFF AVE & STEWART&GRAY RD 70FT S/O & 40FT W/O C/L INT	CY 973
NORWALK (1975)	77.264	RAILROAD SPK @ INT PERR (SANTA ANA LINE) & LAKEWOOD BLVD 0.1MI S/O C/L COMPTON BLVD	CY 1091
NORWALK (1975)	122.378	L&T WLY CB 1FT NLY BCR @ NWLY COR IMPERIAL HWY & SHOEMAKER AVE 80FT NLY & 32FT WLY APPROX C/L INT	CY 1125

QUAD-YEAR	ELEV	DESCRIPTION (INCLUDE QUAD AND YEAR IN DESCRIPTION)	BM NUMBER
BASELINE (1975)	175.276	L&SPK N BCR @ NE COR TELEGRAPH RD & CERES ST 61FT N & 20FT E C/L INT MKD (WZ 399)	CY 1160
BASELINE (1975)	134.408	L&T N CB 1FT W BCR @ NW COR TELEGRAPH RD & VICTORIA AVE 42FT N & 48FT W C/L INT	CY 1162
BASELINE (1975)	157.074	L&T N CB 3FT E OF BCR @ NE COR TELEGRAPH RD & CARMENITA RD 38FT N & 50FT E C/L INT	CY 1169
BASELINE (1975)	156.199	CS MON IN WELL 14IN DN 15FT S & 25FT E C/L INT TELEGRAPH RD & CARMENITA RD MKD (WHITTIER G8)	CY 1170
NORWALK (1975)	109.137	L&T ELY CB 7FT NLY BCR @ NELY COR LEFFINGWELL RD & MEYER RD 48FT NLY * 40FT ELY APPROX C/L INT	CY 1186
BASELINE (1975)	125.802	RDBM TAG N CB 1FT E BCR @ NE COR PARAMOUNT BLVD & FLORENCE AVE 40FT N & 68FT E C/L INT	CY 1299
NORWALK (1975)	126.744	L & BN 40FT E MAC DRWY TO HSE NO 8358 FLORENCE AVE 38FT S C/L & 700FT E DOWNEY AVE	CY 1304
NORWALK (1975)	129.437	L&T 5FT W/O BCR @ SW COR FLORENCE AVE & BROCKSHIRE AVE 40FT S & 62FT W/O C/L INT MKD (BM)	CY 1305
NORWALK (1975)	125.989	L&BN W CB 16FT S BCR @ SW COR FLORENCE AVE & LAKEWOOD BLVD 80FT S & 40FT W C/L INT MKD (BM)	CY 1309
NORWALK (1975)	125.336	L&BN E CB (DEPRESSED) 15FT S OF BCR @ SE COR FLORENCE AVE & LAKEWOOD BLVD 90FT S & 40FT E C/L INT MKD (BM)	CY 1310
NORWALK (1975)	125.155	L&T S CB 38FT S C/L OF FLORENCE AVE 48FT W C/L HALLEDON AVE (PRGD) MKD (BM)	CY 1311
NORWALK (1975)	125.434	L&T W CB 4FT N/O BCR @ NW COR HALLEDON AVE & FLORENCE AVE 78FT N & 20FT W C/L INT MKD (BM)	CY 1312
NORWALK (1975)	128.380	L&PK 38FT N C/L FLORENCE AVE 21FT W C/L PRGD OF WOODRUFF AVE	CY 1313
NORWALK (1975)	124.806	RDBM TAG N CB 1FT W OF BCR @ NW COR DOWNEY- SANFORD BRIDGE RD & FLORENCE AVE 38FT N & 55FT W C/L INT	CY 1314
NORWALK (1975)	124.358	L&T 38FT S C/L FLORENCE AVE ON OR NEAR C/L PRGD OF DOWNEY-SANFORD BRIDGE RD MKD (BM)	CY 1315
NORWALK (1975)	120.787	L&T IN S CB 4FT W OF BCR OF SW COR LESTERFORD AVE & FLORENCE AVE 38FT S & 58FT W C/L INT MKD (BM)	CY 1316

QUAD-YEAR	ELEV	DESCRIPTION (INCLUDE QUAD AND YEAR IN DESCRIPTION)	BM NUMBER
NORWALK (1975)	133.416	C OF ENG BR CAP N CB @ W END OF BRIDGE NO B933 ON FLORENCE AVE OVER SAN GABRIEL RIVER 25FT N/O C/L FLORENCE AVE MKD (1959)	CY 1318
NORWALK (1975)	131.008	C OF ENG BR CAP N CB @ E END BRIDGE NO B933 ON FLORENCE AVE OVER SAN GABRIEL RIVER 25FT N/O C/L FLORENCE AVE MKD (1959)	CY 1319
NORWALK (1975)	117.820	RDBM TAG S OF CB 1FT E/O BCR @ SW COR FLORENCE AVE & FAIRFORD AVE 38FT S & 18FT W/O C/L	CY 1320
NORWALK (1975)	119.215	LA CO RDBM TAG E CB 1FT S/O BCR @ SE COR FLORENCE AVE & FAIRFORD AVE 125FT S & 20FT E/O C/L INT	CY 1321
NORWALK (1975)	121.333	L&T N CB 1FT W/O BCR @ NW COR FLORENCE AVE & ORR & DAY RD 38FT N & 75 FT W/O C/L INT MKD (BM)	CY 1324
NORWALK (1975)	120.501	RDBM TAG N CB 1FT W/O BCR @ NE COR FLORENCE AVE & ORR & DAY RD 38FT N & 75FT E/O C/L INT	CY 1325
NORWALK (1975)	118.115	RDBM TAG S CB 5FT W/O BCR @ SE COR FLORENCE AVE & PIONEER BLVD 38FT S/O & 70FT E/O C/L INT	CY 1329
BASELINE (1975)	131.157	RDBM TAG IN S CB TELEGRAPH RD 2FT W/O SW CB RET @ MAIN DRWY TO SANTA FE SPRINGS FIRE STA BLDG NO 11736 40FT S/O C/L TELEGRAPH RD & 390FT W/O C/L PIONEER BLVD	CY 1345
BASELINE (1975)	131.516	CS MON IN WELL @ C/L INT TELEGRAPH RD & ALBURTIS AVE NLY MKD (LACS CON SYS TRA STA WHITTIER B-7 RE2177 1941)	CY 1348
NORWALK (1975)	130.014	L&T E CB W SERVICE RD 4FT S BCR 50FT W & 40FT S C/L INT ORR & DAY RD & DAVENRICH ST MKD (BM)	CY 1351
NORWALK (1975)	129.646	L&T W CB W SERVICE RD 15FT S BCR 78FT W & 60 FT S C/L INT ORR & DAY RD & DAVENRICH ST MKD (BM)	CY 1352
NORWALK (1975)	128.038	L&T IN E CB W SERVICE RD 12FT N BCR 50FT W & 46FT N C/L INT ORR & DAY RD & DUNNING ST MKD (BM)	CY 1353
NORWALK (1975)	123.264	RDBM TAG IN W CB ORR & DAY RD 1FT S BCR 40FT W 35FT S C/L INT CLARKMAN ST	CY 1355
BASELINE (1975)	124.480	CS BR CAP CONC MON IN WELL @ C/L INT PARAMOUNT BLVD & FLORENCE AVE	CY 1386

QUAD-YEAR	ELEV	DESCRIPTION (INCLUDE QUAD AND YEAR IN DESCRIPTION)	BM NUMBER
BASELINE (1975)	127.200	L & BRAD CTR CB RET SE COR LUBEC ST & PARAMOUNT BLVD 25FT S & 52FT E C/L INT	CY 1387
BASELINE (1975)	127.420	L & BRAD CTR CB RET NE COR LUBEC ST & PARAMOUNT BLVD 27FT N & 52FT E C/L INT	CY 1388
BASELINE (1975)	130.387	L&BN W CB PARAMOUNT BLVD @ NLY P L HSE NO 9603 33FT W/O C/L PARAMOUNT BLVD	CY 1389
BASELINE (1975)	131.832	L & T CONC CB @ BCR SE COR SUVA ST & PARAMOUNT BLVD 48FT S & 38FT E C/L INT MKD (8M)	CY 1390
BASELINE (1975)	134.278	L & T IN CONC CB @ BCR @ SW COR GALLATIN RD & PARAMOUNT BLVD 53FT S & 38FT W C/L INT	CY 1392
BASELINE (1975)	138.485	SQ HD SPK W CB OF SERVICE RD OF PARAMOUNT BLVD 12FT N C/L PROD BROOKGREEN RD	CY 1394
BASELINE (1975)	139.448	FD L&BRAD E CB 0.5FT S BCR @ SE COR PARAMOUNT BLVD & VISTA DEL ROSA SERVICE ISLAND 40FT E & 50FT S C/L INT	CY 1395
BASELINE (1975)	142.010	CS MON IN WELL 8IN DN ON C/L TELEGRAPH RD 20FT WLY C/L PARAMOUNT BLVD MKD (BELL K4 1941)	CY 1397
BASELINE (1975)	142.613	L&BN 4FT S BCR @ SW COR BIRCHBARK AVE & TELEGRAPH RD 80FT S & 18FT W/O C/L INT	CY 1593
BASELINE (1975)	144.974	L&BN 4FT S BCR @ SW COR STAMPS RD & TELEGRAPH RD 78FT S & 18FT W/O C/L INT	CY 1594
BASELINE (1975)	138.576	RAM SET CTR CB RET SE COR LAKEWOOD BLVD & TELEGRAPH RD 55FT S & 55FT E C/L INT	CY 1596
BASELINE (1975)	137.775	CS MON MKD (LACC SUR TRAVERSE STA BELL K-5A RE2177 1941) IN WELL W/COVER @ CL INT TELEGRAPH RD & LAKEWOOD BLVD	CY 1597
BASELINE (1975)	138.368	L&T S END W GAS ISLAND NE COR TELEGRAPH RD & SERAPIS AVE 67FT N & 61FT E/O C/L INT	CY 1599
BASELINE (1975)	137.134	L&T IN S CB TELEGRAPH RD 6FT W/O CB RET @ SE COR SERAPIS AVE 40FT S & 50FT E/O C/L INT	CY 1600
BASELINE (1975)	141.124	L&BN 1FT FROM BCR SERVICE RD N CB @ PASSONS BLVD & TELEGRAPH RD 50FT S C/L TELEGRAPH RD	CY 1601
NORWALK (1975)	108.370	CITY ENG TAG E CB 5FT S/O BCR @ SE COR WOODRUFF AVE & FIRESTONE BLVD 110FT S/O & 40FT E/O C/L INT	CY 1690

QUAD-YEAR	ELEV	DESCRIPTION (INCLUDE QUAD AND YEAR IN DESCRIPTION)	BM NUMBER
NORWALK (1975)	108.493	L&BN S CB FIRESTONE BLVD 50FT S/O C/L & 175FT E/O C/L PROD WOODRUFF AVE TO N	CY 1691
NORWALK (1975)	116.375	L&BN E CB 1FT N BCR @ NE COR WOODRUFF AVE & BUELL ST 20FT E & 50FT N C/L INT	CY 1693
NORWALK (1975)	119.525	RD MON IN WELL 8 INCHES DN @ DR NEAR C/L INT WOODRUFF AVE & GOTHAM ST MKD (LA CO RD DEPT 1954)	CY 1695
NORWALK (1975)	128.597	L&T C/L INT WOODRUFF AVE & FLORENCE AVE	CY 1697
BASELINE (1975)	138.138	L&B W ECR @ SW COR TRUE AVE & TELEGRAPH RD ( SERVICE RD) 47FT W & 15FT S/O C/L INT TRUE AVE & TELEGRAPH RD ( SERVICE RD )	CY 1708
BASELINE (1975)	137.232	CS BR CAP CONC MON IN CASING & COVER PI 6.82FT E C/L INT TRUE AVE & TELEGRAPH RD	CY 1709
NORWALK (1975)	81.998	L&BN S CB 2FT E BCR @ SE COR ROSECRANS AVE & SHOEMAKER AVE 38FT S & 60FT E C/L INT CB MKD (AT 74)	CY 1821
BASELINE (1975)	157.383	L&T W CB 18FT N/O BCR @ NW COR TELEGRAPH RD & LAUREL AVE 68FT N & 20FT W C/L INT	CY 1830
BASELINE (1975)	151.281	CS MON IN WELL 8IN DN @ DR NR C/L INT TELEGRAPH RD & BLOOMFIELD AVE MKD (WHITTIER E7-A)	CY 1837
BASELINE (1975)	153.136	L&T 1FT N SE COR 1ST CONC STEP 70FT N C/L TELEGRAPH RD & 67FT W C/L BLOOMFIELD AVE	CY 1838
BASELINE (1975)	143.396	L & BN NE COR CONC BASE OIL DERRICK SW COR WILLIS ST & TELEGRAPH RD 40FT S & 43FT W C/L INT	CY 1840
BASELINE (1975)	89.914	RDBM TAG S CB ROSECRANS AVE 40FT S C/L @ ANG PT OF CB TO BRIDGE OVER SAN GABRIEL RIV 500FT W BRIDGE	CY 1989
BASELINE (1975)	83.353	L & T 6FT W BCR @ SW COR PARAMOUNT BLVD & GARDENDALE ST 35FT S & 59FT W C/L INT	CY 2041
NORWALK (1975)	136.898	RDBM TAG IN W CB 0.5FT N BCR @ NW COR LAKEWOOD BLVD & GALLATIN RD 63FT N & 40FT W C/L INT	CY 2053
NORWALK (1975)	136.585	RDBM TAG 3.5FT S BCR @ SW COR LAKEWOOD BLVD & GALLATIN RD 40FT W & 66FT S C/L INT	CY 2054
NORWALK (1975)	91.448	L & BN 1FT N BCR @ NW COR PRISCILLA ST & LAKEWOOD BLVD 38FT W & 40FT N C/L INT	CY 2078

QUAD-YEAR	ELEV	DESCRIPTION (INCLUDE QUAD AND YEAR IN DESCRIPTION)	BM NUMBER
NORWALK (1975)	89.101	SQ/HD SPK W CB 44FT N BCR @ NW COR LAKEWOOD BLVD & ROSECRANS BLVD 113FT N & 38FT W C/L INT MKD (MVTI)	CY 2084
NORWALK (1975)	88.490	STATE OF CALIF DIV HWY BRASS CAP CTR RET SW COR LAKEWOOD BLVD & ROSECRANS BLVD 55FT S & 44FT W C/L INT MKD (BM 42-A-53)	CY 2085
NORWALK (1975)	85.752	REINFORCING STEEL ROD IN SW COR CONC APRON TO BLDG NO 14610 ON NE COR LAKEWOOD BLVD & JEFF ST 52FT E & 15FT N/O C/L INT	CY 2086
NORWALK (1975)	85.257	RDBM TAG W CB LAKEWOOD BLVD 45FT W/O C/L & 15FT S/O APPROX C/L PROD JEFF ST	CY 2087
NORWALK (1975)	79.391	CO ENG TAG W CB 25FT S/O BCR @ SW COR LAKEWOOD BLVD & COMPTON BLVD 95FT S & 38FT W C/L INT	CY 2089
NORWALK (1975)	100.112	L & T 3FT W BCR N CB PKWY 35FT S C/L IMPERIAL HWY & 40FT W C/L DOWNEY RD	CY 2327
BASELINE (1975)	66.220	L&T CTR CB RET @ SE COR ALONDRA BLVD & DOWNEY AVE 48FT S & 47FT E C/L INT	CY 2343
BASELINE (1975)	98.713	L&BN N CB ROSECRANS AVE NE COR BRIDGE OVER SAN GABRIEL RIV 1FT W OF E END OF BRIDGE 23FT N C/L ROSECRANS AVE	CY 2495
BASELINE (1975)	101.072	L&BN N CB ROSECRANS AVE @ NW COR BRIDGE OVER SAN GABRIEL RIV 1FT E OF W END OF BRIDGE 23FT N C/L ROSECRANS AVE	CY 2496
BASELINE (1975)	67.421	L&T NR W ED OF CONC WK AROUND HSE NO 8700 ALONDRA BLVD 57FT S & 25FT E C/L INT ALONDRA BLVD & HAYTER ST	CY 2589
BASELINE (1975)	67.392	LACS MON 30FT N & 70FT E C/L INT ALONDRA BLVD & CLARK AVE MKD ( BM 6-8 1951)	CY 2596
BASELINE (1975)	73.279	L&T N CB 4FT W CB RET @ NW COR ALONDRA BLVD & BLAINE AVE 38FT N & 35FT W C/L INT	CY 2597
BASELINE (1975)	73.411	L&T IN N CB 3FT E CB RET @ NE COR ALONDRA BLVD & BLAINE AVE 38FT N & 32FT E C/L INT	CY 2598
BASELINE (1975)	74.110	L&BN S CB 1FT W CB RET @ SW COR ALONDRA BLVD & BELLFLOWER BLVD 46FT W & 38FT S C/L INT	CY 2600
BASELINE (1975)	65.358	L&BN W CB 7FT N OF BCR @ SW COR ALONDRA BLVD & VALLEY VIEW AVE 68FT S & 40FT W C/L INT	CY 2771

QUAD-YEAR	ELEV	DESCRIPTION (INCLUDE QUAD AND YEAR IN DESCRIPTION)	BM NUMBER
BASELINE (1975)	94.678	L&SPK N CB 4FT E BCR @ NE COR VALLEY VIEW AVE & STAGE RD 30FT N & 60FT E C/L INT CB MKD (RBM 1)	CY 2776
BASELINE (1975)	94.712	USC&GS MON FLUSH ON NE COR VALLEY VIEW AVE & STAGE RD 31.5FT N & 87FT E C/L INT 1.5FT N CB MKD (K 778-1945)	CY 2777
BASELINE (1975)	94.210	L&BN NR CTR OF BRIDGE NO 1273 40FT E/O C/L VALLEY VIEW AVE 800FT S FOSTER RD 137FT N C/L MAZSA DR	CY 2782
BASELINE (1975)	94.655	CS MON IN WELL 10IN DN ON NE COR VALLEY VIEW AVE & FOSTER RD 62FT N & 41FT E C/L INT 1FT BACK CB MKD (BM 1#6A 1961)	CY 2785
BASELINE (1975)	105.922	L&BN E CB 1FT N BCR @ NE COR VALLEY VIEW AVE & ADOREE ST TO THE E 57FT N & 38FT E/O C/L INT	CY 2786
BASELINE (1975)	115.829	L&BN E CB 1FT S BCR @ SE COR VALLEY VIEW AVE & IMPERIAL HWY 76FT S & 38FT E C/L INT	CY 2788
NORWALK (1975)	129.391	L & T 13FT W BCR @ NW COR FLORENCE AVE & BROOKSHIRE AVE 40FT N & 67FT W C/L INT	CY 2853
BASELINE (1975)	104.350	L & T 18FT S C/L SPRINGER ST & 70FT W C/L PARAMOUNT BLVD 8FT W BCR @ SW COR IN CB	CY 3168
BASELINE (1975)	110.277	L & B 1FT W BCR @ SW COR DE PALMA ST & PARAMOUNT BLVD 18FT S & 74FT W C/L INT	CY 3173
BASELINE (1975)	111.336	L & BRAD 1FT W BCR @ NW COR CLETA ST & PARAMOUNT BLVD 18FT N & 75FT W C/L INT	CY 3174
BASELINE (1975)	112.152	L&T 2FT W/O BCR @ SW COR BROOKMILL RD & PARAMOUNT BLVD 18FT S & 77FT W/O C/L INT	CY 3175
BASELINE (1975)	115.822	LACS MON IN WELL @ C/L INT 2ND ST & PARAMOUNT BLVD ( USE S EDGE )	CY 3182
BASELINE (1975)	123.950	L & T 2FT S BCR @ SW COR PARAMOUNT BLVD & FARM ST 55FT S & 38FT W C/L INT	CY 3183
NORWALK (1975)	121.056	L&T W CB NORWALK BLVD 1FT N CB RET @ NW COR ORACLE ST & NORWALK BLVD 45FT N & 38FT W C/L INT	CY 3280
NORWALK (1975)	119.717	L&SPK N CB SHY ST 3FT W CB RET @ NW COR SHY ST & NORWALK BLVD 16FT N & 69FT W C/L INT	CY 3281
NORWALK (1975)	95.045	L & BN 2FT W BCR @ SW COR IMPERIAL HWY & WOODRUFF AVE 38FT S & 76FT W C/L INT	CY 3306

QUAD-YEAR	ELEV	DESCRIPTION (INCLUDE QUAD AND YEAR IN DESCRIPTION)	BM NUMBER
NORWALK (1975)	94.371	L & T 38FT S C/L IMPERIAL HWY ON C/L PROD CORNUTA AVE FROM S	CY 3307
NORWALK (1975)	93.478	L & T CTR CB RET @ W END OF PKWY 30FT E C/L DUNROBIN AVE & 46FT S C/L IMPERIAL HWY	CY 3308
NORWALK (1975)	97.094	L & T N CB SERVICE RD 1FT E BCR @ SE COR IMPERIAL HWY & VERDURA AVE 52FT S & 38FT E C/L INT	CY 3313
NORWALK (1975)	97.151	L & T S CB IMPERIAL HWY 3FT E BCR @ SE COR BROOKSHIRE AVE 38FT S & 73FT E/O C/L INT	CY 3314
NORWALK (1975)	98.579	L&BN S CB SERVICE RD IMPERIAL HWY 2FT E DRWY HSE NO 8402 80FT S/O C/L IMPERIAL HWY ON OR NR C/L PRCD DOLAN AVE	CY 3315
BASELINE (1975)	83.725	L&T 1FT N BCR @ NW COR STUDEBAKER RD & ROSECRANS AVE 81FT N & 52FT W C/L INT	CY 3364
NORWALK (1975)	158.759	L&SPK NR SE COR CONC WK 66FT W CARMENITA RD & 81FT N C/L BEATY AVE NR SE COR OF BLDG	CY 4312
NORWALK (1975)	166.689	L&BR IN S CB LAKELAND RD 1FT W/O BCR 32FT S & 75FT W C/L INT LAKELAND AV & CARMENITA RD	CY 4314
NORWALK (1975)	168.684	L&T NR S EDGE OF CONC DRWY HSE NO 10762 CARMENITA RD 127FT N COL FLORENCE AVE & 57FT E C/L CARMENITA RD	CY 4317
NORWALK (1975)	97.065	L&BRAD N CB SERVICE RD 1FT W BCR @ SW COR IMPERIAL HWY & VERDURA AVE 52FT S/O & 40FT W/O C/L INT	CY 6101
NORWALK (1975)	94.942	L&T 1FT S/O BCR @ NW COR IMPERIAL HWY & LAKEWOOD BLVD 49FT N/O & 40FT W/O C/L INT	CY 6103
NORWALK (1975)	94.195	L&T IN RET 10FT E/O BCR @ NW COR IMPERIAL HWY & CLARK AVE 43FT N & 45FT W/O C/L INT	CY 6104
NORWALK (1975)	94.011	RDBM TAG S CB 5FT W/O BCR @ SE COR IMPERIAL HWY & CLARK AVE 40FT S/O & 55FT E/O C/L INT	CY 6105
NORWALK (1975)	92.111	L&T S CB 5FT E/O BCR @ SW COR IMPERIAL HWY & ARDIS AVE 40FT S/O & 40FT W/O C/L INT	CY 6106
NORWALK (1975)	93.591	L&BN S CB 3FT W/O BCR @ SW COR IMPERIAL HWY & BELLFLOWER BLVD 40FT S/O & 62FT W/O CL INT	CY 6108
NORWALK (1975)	96.789	RDBM TAG N CB 38FT E BCR @ NE COR CARMENITA RD & IMPERIAL HWY 42FT N & 113FT E C/L INT	CY 6124



QUAD-YEAR	ELEV	DESCRIPTION (INCLUDE QUAD AND YEAR IN DESCRIPTION)	BM NUMBER
NORWALK (1975)	163.352	RDBM TAG 40FT W C/L CARMENITA RD ON S P/L HSE NO 10615 400FT S BARRETT ST	CY 6132
NORWALK (1975)	85.822	L&T N CB ROSECRANS AVE 40FT N C/L @ CR NEAR C/L PROD CASTANA AVE TO THE S	CY 6133
NORWALK (1975)	85.357	L&T N CB ROSECRANS AVE 42FT N C/L & 34FT W C/L CASTANA AVE TO THE NORTH	CY 6134
NORWALK (1975)	78.136	RD HD SPK W CB 5FT S BCR @ SW COR ROSECRANS AVE & DOWNEY AVE 87FT S & 30FT W C/L INT MKD(XM98)	CY 6136
NORWALK (1975)	74.672	RD MON IN WELL 8IN DN @ CR NEAR C/L INT ROSECRANS AVE & ANDERSON ST MKD (LA CO RD DEPT 1953)	CY 6138
NORWALK (1975)	103.349	L & BN 1FT E BCR @ NE COR IMPERIAL HWY & VOLUNTEER AVE 40 N & 60FT E C/L INT	CY 6140
NORWALK (1975)	115.285	L&BN IN CONC BASE OF SWITCH SIGNAL STAND 65FT N/O C/L IMPERIAL HWY & 0.2MI E/O BLOOMFIELD AVE 15FT W/O W TRACK MKD (BM)	CY 6143
NORWALK (1975)	125.696	L&T W EDGE CONC WK TO BLDG NO 12935 IMPERIAL HWY 55FT N C/L & 320FT W C/L SHOEMAKER AVE	CY 6145
BASELINE (1975)	141.166	L&BN S CB 35FT W BCR @ SW COR TELEGRAPH RD & NORWALK BLVD 35FT S & 77FT W/O C/L INT MKD (BM)	CY 6675
BASELINE (1975)	167.341	L&T CTR CB RET @ ENT TO CANDLEWOOD CC 45FT S C/L TELEGRAPH RD @ BRAMBLEBUSH AVE	CY 6679
BASELINE (1975)	196.262	RDBM TAG 18FT E BCR @ NE COR 42FT N & 70FT E C/L INT VALLEY VIEW AVE & TELEGRAPH RD	CY 6680
BASELINE (1975)	187.285	L&T 5FT E BCR @ SW COR 54FT W & 43FT S C/L INT TELEGRAPH RD & COLIMA RD MKD (BM)	CY 6681
BASELINE (1975)	188.330	RDBM TAG 5FT W BCR @ SE COR 53FT E & 43FT S C/L INT TELEGRAPH RD & COLIMA RD	CY 6682
BASELINE (1975)	162.399	L&BRAD ELY CB 12FT S BCR @ NELY COR VALLEY VIEW AVE & LEFFINGWELL RD 88FT N & 42FT E C/L INT	CY 7008
BASELINE (1975)	65.222	RR SPK IN CONC IN NE ABUT TO RR BR 9/40 300FT SLY SERVICE RD OF SANTA ANA FRWY & 1500FT WLY VALLEY VIEW AVE	CY 7015
BASELINE (1975)	65.973	COE BR CAP FL IN SE COR BR ON SERVICE RD OF SANTA ANA FRWY ABT 1500FT WLY VALLEY VIEW AVE MKD (CC37 BM 2-1B)	CY 7016

QUAD-YEAR	ELEV	DESCRIPTION (INCLUDE QUAD AND YEAR IN DESCRIPTION)	BM NUMBER
BASELINE (1975)	78.703	RDBM TAG ELY HDWL ON NELY COR CARMENITA RD & FIRESTONE BLVD 100FT NLY & 30FT ELY APPROX C/L INT	CY 7020
BASELINE (1975)	76.200	USC&GS MON IN S HDWL CULV 500 B ON SPRR ABT 355FT NW C/L SHOEMAKER AVE & 420FT S/O C/L FIRESTONE BLVD (S-97 1932)	CY 7022
BASELINE (1975)	94.142	CAL STATE BM MON IN CB FL WITH WK ON SW COR FIRESTONE BLVD & NORWALK BLVD 83FT S & 23FT W C/L INT	CY 7023
BASELINE (1975)	98.349	USC&GS DISK VERT IN WALL OF FORMER BANK OF NORWALK BLDG ON NWLY COR FRONT ST & CLARKDALE AVE ( V98 1932 )	CY 7024
BASELINE (1975)	82.286	CS MON 10IN DN NW COR ROSECRANS AVE & STUDEBAKER RD 49FT N & 90 FT W C/L INT MKD ( BM6-2 1951)	CY 7026
BASELINE (1975)	80.445	L&T W CB 6FT S BCR @ SW COR WOODRUFF AVE & WASHINGTON ST 50FT S & 40FT W C/L INT	CY 7027
BASELINE (1975)	72.729	CS MON 10IN DN @ NW COR ALONDRA BLVD & BELLFLOWER BLVD 33FT N & 73FT W C/L INT MKD (BM 6-7 1951)	CY 7028
BASELINE (1975)	69.057	CS MON FL @ SE COR ALONDRA BLVD & LAKEWOOD BLVD 42FT S & 187FT E C/L INT MKD (BM 6-9A 1958)	CY 7029
BASELINE (1975)	77.869	CS MON FL IN C B @ NW COR PARAMOUNT BLVD & CENTURY BLVD 90FT N & 39FT W C/L INT MKD (BM 7-2A 1961)	CY 7030
BASELINE (1975)	80.548	CS MON FL IN C B ON NW COR PARAMOUNT BLVD & HARDING AVE 40FT N & 41FT W C/L INT MKD (BM 7-3A 1961)	CY 7031
BASELINE (1975)	79.846	CS MON 10IN DN ON NW COR HARDING AVE & PARAMOUNT BLVD 95FT N & 44FT W C/L INT MKD (BELL E 11A 1960)	CY 7032
BASELINE (1975)	105.609	CS REF MON IN WELL 40FT W/O C/L PARAMOUNT BLVD & 42FT S C/L PROD ALAMEDA ST MKD ( BELL G 9 RM-1)	CY 7033
BASELINE (1975)	105.640	CS REF MON IN WELL 40FT W/O C/L PARAMOUNT BLVD & 38FT N/O C/L PROD ALAMEDA ST MKD ( BELL G 9 RM2)	CY 7034
BASELINE (1975)	133.388	CS MON 10IN DN SE COR GALLATIN RD & PARAMOUNT BLVD 59FT E & 25FT S C/L INT MKD (BM 7-12 1951)	CY 7036

QUAD-YEAR	ELEV	DESCRIPTION (INCLUDE QUAD AND YEAR IN DESCRIPTION)	BM NUMBER
NORWALK (1975)	133.006	L&BN W CB NORWALK BLVD 2FT S BCR @ SW COR NORWALK BLVD & FLORENCE AVE 82FT S & 40FT W C/L INT	CY 7262
NORWALK (1975)	127.259	L&BN W CB NORWALK BLVD 1FT N BCR @ NW COR NOR- WALK BLVD & LAKE LAND RD 50FT N & 34FT W C/L INT MKD (BM)	CY 7263
NORWALK (1975)	126.574	L&BN W CB NORWALK BLVD 2FT S BCR @ SW COR NOR- WALK BLVD & LAKE LAND RD 52FT S & 34FT W C/L INT MKD (BM)	CY 7264
NORWALK (1975)	113.599	CS BR CAP MON 12IN DN 45FT E C/L NORWALK BLVD & 148FT S/O C/L ENT TO HOSPITAL 40FT S/O C/L TINA ST MKD (BM 2-9A RE 5869 1961)	CY 7265
NORWALK (1975)	105.158	L&BN 6IN E BCR IN N CB IMPERIAL HWY @ NE COR IMPERIAL HWY & NORWALK BLVD 40FT N & 75FT E C/L INT	CY 7266
NORWALK (1975)	104.780	L&BN 2FT N BCR IN W CB NORWALK BLVD @ SW COR NORWALK BLVD & IMPERIAL HWY 40FT W & 67FT S C/L INT	CY 7267
NORWALK (1975)	110.622	CS TAG S CB 18IN E BCR @ SW COR IMPERIAL HWY & BLOOMFIELD AVE 42FT W & 75FT S C/L INT	CY 7268
NORWALK (1975)	109.465	L&T N CB LEFFINGWELL RD 12FT E BCR @ NE COR LEFFINGWELL RD & MEYER RD 40FT N & 50FT E C/L INT	CY 7270
NORWALK (1975)	112.116	L&BN W CB 2FT N CB @ NW COR LOMA DR & LEFFINGWELL RD 55FT N & 20FT W C/L INT	CY 7271
BASELINE (1975)	159.123	L&BN W CB 4FT N BCR @ NW COR TELEGRAPH RD & GREENLEAF AVE 80FT N & 32FT W C/L INT MKD (BM)	CY 7449
NORWALK (1975)	126.252	L&BN W CB 7FT N BCR @ NW COR ALBURTIS AVE & DUNNING ST 48FT N & 18FT W C/L INT MKD (BM)	CY 7451
NORWALK (1975)	125.794	L&BN N CB 2FT E BCR @ NE COR ALBURTIS AVE & DUNNING ST 15FT N & 46FT E C/L INT MKD (BM)	CY 7452
NORWALK (1975)	122.432	L&BRAD W CB 16FT S BCR @ SW COR PIONEER BLVD SERVICE RD & PARKMEAD ST 58FT S & 80FT W C/L INT	CY 7453
NORWALK (1975)	139.172	CS MON IN WELL 12IN DN @ C/L INT LAKE LAND RD & BLOOMFIELD AVE	CY 7456
NORWALK (1975)	142.031	L&BN CONC FOOTING OF GATE ON NE COR LAKE LAND RD & BLOOMFIELD AVE 30FT N & 106FT E/O C/L INT MKD (BM)	CY 7457

QUAD-YEAR	ELEV	DESCRIPTION (INCLUDE QUAD AND YEAR IN DESCRIPTION)	BM NUMBER
NORWALK (1975)	145.663	L&BN S CB 1FT W BCR @ SW COR LAKELAND RD & GREENSTONE AVE 32FT S & 69FT W C/L INT MKD (BM)	CY 7458
NORWALK (1975)	148.508	L&BN E CB 1FT S BCR @ SE COR LAKELAND RD & GREENSTONE AVE 70FT S & 32FT E C/L INT MKD (BM)	CY 7459
NORWALK (1975)	151.795	L&BN W CB 4FT N BCR @ NW COR LAKELAND RD & SHOEMAKER AVE 70FT N & 40FT W C/L INT MKD (BM)	CY 7460
NORWALK (1975)	154.625	L&BN S CB LAKELAND RD 32FT S C/L & 9FT W C/L PROD PAINTER AVE MKD (BM)	CY 7462
NORWALK (1975)	155.219	L&BN N CB 2FT E BCR @ NE COR LAKELAND RD & PAINTER AVE 32FT N & 64FT E C/L INT MKD (BM)	CY 7463
NORWALK (1975)	139.860	CS MON IN WELL 18IN DN @ C/L INT FLORENCE AVE & BLOOMFIELD AVE	CY 7464
NORWALK (1975)	147.736	L&BN CONC COLLAR OF SEWER VENT ON SW COR BLOOMFIELD AVE & CLARK AVE 22FT S & 56FT W C/L INT MKD (BM)	CY 7466
NORWALK (1975)	146.488	CS MON IN WELL 14IN DN @ C/L INT BLOOMFIELD AVE & CLARK AVE	CY 7467
NORWALK (1975)	155.325	CS MON IN WELL 8IN DN @ C/L INT SHOEMAKER AVE & FUT FLORENCE AVE	CY 7468
NORWALK (1975)	156.544	L&BN SE COR CONC SLAB ON NE COR SHOEMAKER AVE & FUT FLORENCE AVE 40FT N & 40FT E C/L INT MKD (BM)	CY 7469
NORWALK (1975)	158.841	PK IN CTR CONC PLUG OF 8IN IP 24IN UP ON SW COR SHOEMAKER AVE & AT&SF RR 8FT S & 30FT W C/L INT 0.3MI S/O C/L TELEGRAPH RD	CY 7471
NORWALK (1975)	92.739	L&BN CONC FTG OF OLD GATE POST 1FT N & 1FT W/O NEW GATE POST NO 33 33FT E/O C/L CARMENITA RD & 0.25MI N/O FOSTER RD MKD (BM)	CY 7473
NORWALK (1975)	93.115	L&BN CONC FTG OF OLD GATE POST 2FT S/O NEW GATE POST NO 20 47FT W/O C/L CARMENITA RD & 0.25MI N/O FOSTER RD MKD (BM)	CY 7474
NORWALK (1975)	91.426	L&BN CONC FTG OF SLY GATE POST ON NW COR CARMENITA RD & FOSTER RD 47FT W & 110FT N/O C/L INT MKD (BM)	CY 7475
NORWALK (1975)	90.116	L&BN CONC WALL OF DRAINAGE DITCH ON SE COR CARMENITA RD & FOSTER RD 25FT S & 142FT E C/L INT MKD (BM)	CY 7476

