

FIELD COPY

COUNTY OF LOS ANGELES

ROAD DEPARTMENT

BENCH MARKS



OTTERBEIN QUAD

1955

PREFACE

The Road Department level net is composed of some 1,000 miles of levels supporting more than 10,000 bench marks. In 1955, a major re-adjustment of the net was undertaken resulting in revised bench mark elevations of which the accompanying list is a part.

To facilitate the adjustment, indexing, and distribution of adjusted values of the net, the county territory was divided into 30 quads or areas. For identification purposes each quad was given a name, viz., "Rosemead", "La Mirada", "Santa Fe", etc. When bench marks and elevations in the Road Dept. net are used, the name of the quad in which the bench mark is located and the date of the adjustment of the elevation must be included in the bench mark description, e.g.,

SG 908 - L & T in E. cb. Mascatel Ave. on G/L prod.
Scott St. (Rosemead - 1955) Elev. 333.517

It is expected that this general adjustment will, for the most part, remain sound for the next 15 or 20 years. As new circuits are completed, however, re-adjustment of individual quads may become advisable. It is expected that these subsequent adjustments will be in the nature of a few hundredths of a foot. When a quad is re-adjusted, new elevation lists will be published and the date of the re-adjustment will replace the "1955" at the end of the bench mark description. Two bench marks in the same quad with different adjustment dates will not normally join each other. Since all adjustments taper out to nothing at the periphery of the quad, any bench mark in one quad will join any bench mark in another quad regardless of their respective adjustment dates.

The basic accuracy of the net is reflected by an indicated field probable error of ± 0.12 foot per mile of leveling as determined from 298 conditions of closure. However, many years experience in vertical control in the greater Los Angeles basin & Antelope Valley indicate that because of varying degrees of subsidence and heaving, the true datum is recovered only by obtaining substantial agreement of a number of bench marks.

The users of this net are invited to assist in its maintenance by notifying this Department of cases of obliteration, apparent mistakes in descriptions or elevations, and proven disturbance of bench marks.

Datum: U.S. Coast and Geodetic Survey Sea Level Datum of
1929, through the medium of the Los Angeles County
Engineer Precise Level Net, 1952 Adjustment.

11--Iron Pipe

1212--Los Angeles City Engineer

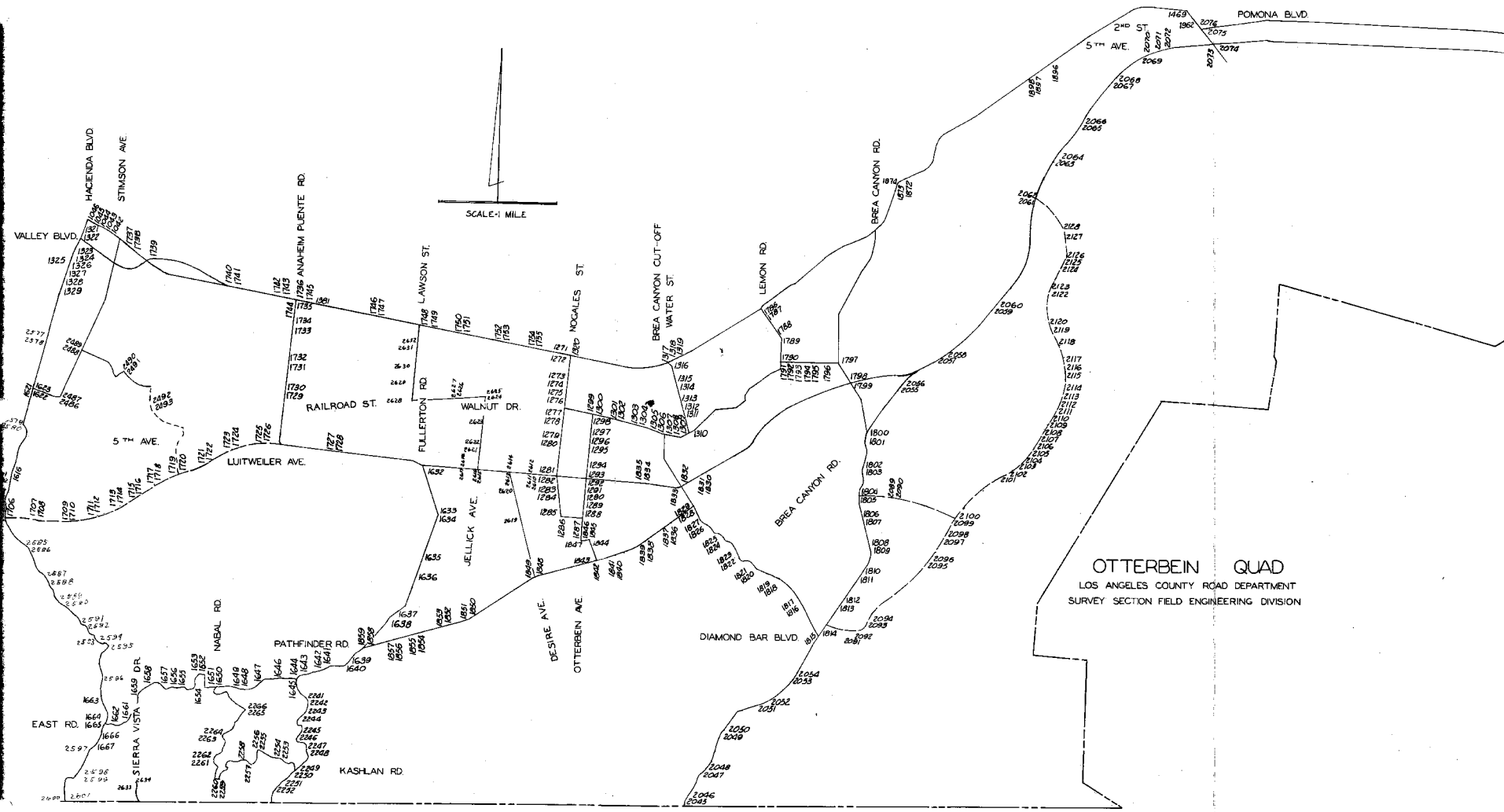

OTTERBEIN QUAD
 LOS ANGELES COUNTY ROAD DEPARTMENT
 SURVEY SECTION FIELD ENGINEERING DIVISION

JUL 1964

LOS ANGELES COUNTY ROAD DEPARTMENT
SURVEY SECTION FIELD ENGINEERING DIVISION

PAGE 1

QUAD-YEAR	ELEV	DESCRIPTION (INCLUDE QUAD AND YEAR IN DESCRIPTION)	BM NUMBER
BASELINE (1955)	328.649	L+SPK @ CTR CB RET @ NW COR OLD VALLEY BLVD + GLENDORA AVE MKD (PS 6	SG 1042A
BASELINE (1955)	328.714	3IN IP + USGS CAP 8IN UP @ PUENTE STA OF SPRR 35FT S C/L OLD VALLEY BLVD + 160FT W C/L GLENDORA	SG 1043A
BASELINE (1955)	324.434	L+T CONC WK 4FT S OF SW COR OF BLDG NO 15703 30F E C/L RIDGEWAY ST + 30FT N C/L OLD VALLEY BLVD	SG 1044A
BASELINE (1955)	322.356	RD MON IN WELL 8IN DN @ C/L INT OLD VALLEY BLVD + HACIENDA BLVD	SG 1045B
BASELINE (1955)	323.914	CS MON FLUSH 1FT E OF E CB 41FT E C/L HACIENDA BLVD + 10FT S OF S RAIL SPRR MKD (BM 11-114A)	SG 1046B
BASELINE (1955)	456.328	R D MON IN WELL 10 IN DN @ C/L INT VALLEY BLVD + NOGALES ST	SG 1271A
BASELINE (1955)	457.095	L+BN NE COR CONC BASE OF RR X SIGNAL 6FT S OF SPRR 15FT E C/L NOGALES ST	SG 1272
OTTRBEIN (1955)	440.315	L+BN NR N EDGE CONC DR TO HSE NO 854 20FT E C/L NOGALES ST @ NE COR SAN JOSE AVE	SG 1273
OTTRBEIN (1955)	440.739	L+BN SE COR CONC BASE OF WATER PUMP 65FT W C/L NOGALES ST + 75FT N C/L SAN JOSE AVE	SG 1274
OTTRBEIN (1955)	450.153	L+BN N SIDE OF CONC BASE OF RR X SIGNAL 13FT N OF UPRR 18FT W C/L NOGALES ST	SG 1275
OTTRBEIN (1955)	446.826	L+BN CTR OF CONC HDWL OF DRAIN 15FT S OF UPRR + 32FT E C/L NOGALES ST	SG 1276
OTTRBEIN (1955)	456.786	L+BN N EDGE OF OIL TANK 25FT E C/L NOGALES ST 325FT N OF HSE NO 1310 + OPP PP NO 268081E	SG 1277
OTTRBEIN (1955)	463.601	L+BN NW EDGE OIL TANK 22FT E C/L NOGALES ST + 170FT S OF HSE NO 1310	SG 1278
OTTRBEIN (1955)	466.836	L+T S EDGE OF 12 IN STANDPIPE 25FT E C/L NOGALES ST N OF DR TO HSE NO 1434 ONE MI S VALLEY BLVD	SG 1279
OTTRBEIN (1955)	472.424	L+BN CONC RET WALL 40FT E C/L NOGALES ST + 330FT S OF DR TO HSE NO 1434	SG 1280
OTTRBEIN (1955)	488.383	L+BN N WING OF HDWL 50FT S C/L 5TH AVE + 22FT E C/L NOGALES ST	SG 1281
OTTRBEIN (1955)	501.436	L+BN N EDGE CONC DR TO HSE NO 1860 40FT E C/L NOGALES ST	SG 1284
OTTRBEIN (1955)	511.020	L+BN N END OF HDWL W SIDE OF DR TO HSE NO 19007 @ NE COR KILLIAN AVE 25FT N C/L NOGALES ST	SG 1285
OTTRBEIN (1955)	517.215	L+BN CTR W HDWL OF DR TO HSE NO 19039 20FT N C/L KILLIAN AVE	SG 1286
OTTRBEIN (1955)	527.094	L+BN TOP 24IN STANDPIPE @ NW COR KILLIAN AVE + OTTERBEIN AVE	SG 1287
OTTRBEIN (1955)	526.211	L+BN TOP 24IN STANDPIPE 25FT W C/L OTTERBEIN AVE + 100FT S OF DR TO HSE NO 1847	SG 1288
OTTRBEIN (1955)	514.868	L+T E EDGE 12IN STANDPIPE 30FT W C/L OTTERBEIN AVE 80FT N C/L PROD VALENCIA ST + 10FT N OF DR TO HSE NO 1755	SG 1291
OTTRBEIN (1955)	510.798	L+BN IN N WING OF HDWL 50FT S + 20FT E C/L INT 5TH AVE + OTTERBEIN AVE	SG 1292

QUAD-YEAR	ELEV	DESCRIPTION (INCLUDE QUAD AND YEAR IN DESCRIPTION)	BM NUMBER
OTTRBEIN (1955)	512.970	L+BN W END OF 1ST STEP TO PORCH OF HSE NO 19208 5TH AVE 55FT S C/L + 116 OUT /L OTTERBEIN AVE	SG 1293
OTTRBEIN (1955)	499.459	L+T SE COR CONC PORCH FRONT OF HSE NO 1523 OTTERBEIN AVE 45FT W C/L	SG 1294
OTTRBEIN (1955)	485.806	L+BN W CB OTTERBEIN AVE 10FT W C/L + 10FT N C/L PROD TRANBARGER ST	SG 1295
OTTRBEIN (1955)	488.004	L+BN CONC RET WALL 2FT N OF END 20FT E + 20FT N C/L INT OTTERBEIN AVE + TRANBARGER ST	SG 1296
OTTRBEIN (1955)	472.923	L+BN E EDGE OF OIL TANK 7FT S OF DR TO HSE NO 1301 + 50FT W C/L OTTERBEIN AVE	SG 1297
OTTRBEIN (1955)	462.524	L+T CTR OF 2ND STEP NE COR OF CHURCH BLDG @ SW COR WALNUT DR + OTTERBEIN AVE	SG 1298
OTTRBEIN (1955)	462.622	L+T S END OF 1ST CONC STEP TO PORCH OF STORE @ NE COR WALNUT DR + OTTERBEIN ST	SG 1299
OTTRBEIN (1955)	467.317	L+BN CTR OF HDWL OF DRAIN W SIDE OF DR TO HSE NO 15254 WALNUT DR 20FT S C/L	SG 1300
OTTRBEIN (1955)	470.630	L+BN NR E END HDWL OF CONC BRIDGE NO 361 10FT W OF DR TO HSE NO 19335 WALNUT DR 20FT N C/L	SG 1301
OTTRBEIN (1955)	471.257	L+BN E END HDWL OF CONC BRIDGE NO 361 20FT S C/L WALNUT DR OPP DR TO HSE NO 19335	SG 1302
OTTRBEIN (1955)	481.632	L+BN CTR OF HDWL OF DRAIN W SIDE OF DR TO HSE NO 19448 WALNUT DR 15FT S C/L	SG 1303
OTTRBEIN (1955)	487.636	L+BN E EDGE OF CONC WK TO HOSPITAL CASA ALEGRE NO 19506 WALNUT DR 21FT S C/L	SG 1304
OTTRBEIN (1955)	491.710	L+T S EDGE OF CONC WK TO HSE NO 19565 WALNUT DR 3FT S OF STEP + 60FT N C/L	SG 1305
OTTRBEIN (1955)	498.444	L+BN E END OF CONC WINGWALL 25FT S C/L WALNUT DR + 35FT E C/L BREA CANYON CUTOFF RD	SG 1306
OTTRBEIN (1955)	502.453	L+T 6FT E OF W END CONC RET WALL 70FT W PP NO 47129E + 23FT N C/L WALNUT DR	SG 1307
OTTRBEIN (1955)	503.678	L+T CONC RET WALL 10FT W OF END 50FT W OF ENT TO HSE NO 19734 WALNUT DR 23FT N C/L + 10FT W PP NO 507758E	SG 1308
OTTRBEIN (1955)	508.571	L+T W END CONC HDWL 18FT S C/L WALNUT DR + 25FT E C/L PROD WATER ST	SG 1309
OTTRBEIN (1955)	492.772	L+BN W END CONC HDWL OF DRAIN 15FT E C/L WATER ST + 450FT N C/L WALNUT DR	SG 1310
OTTRBEIN (1955)	484.842	L+T E EDGE CONC WK 15FT N OF STEPS TO HSE NO 1111 WATER ST 45FT W C/L	SG 1311
OTTRBEIN (1955)	486.435	L+BN CTR N END OF CONC CULV 55FT N OF WK TO HSE NO 1111 WATER ST 20FT E C/L	SG 1312
OTTRBEIN (1955)	488.717	L+BN NW SIDE OF CONC BASE OF RR X SIGNAL 12FT S OF S RAIL UPRR + 15FT E C/L WATER ST MKD (NO 3-23,4)	SG 1313
OTTRBEIN (1955)	487.238	L+BN SE COR OF CONC BASE OF METAL SIGNAL BOX NO 318 12FT S OF S RAIL UPRR + 40FT W C/L WATER ST	SG 1314

QUAD-YEAR	ELEV	DESCRIPTION (INCLUDE QUAD AND YEAR IN DESCRIPTION)	BM NUMBER
OTTRBEIN (1955)	482.931	L+T WK TO HSE NO 817 25FT W C/L WATER ST + 200FT S C/L HOWELL RD	SG 1315
BASELINE (1955)	487.594	L+BN S SIDE OF CONC BASE OF RR X SIGNAL 12FT S OF S RAIL SPRR + 25FT E C/L WATER ST	SG 1316
BASELINE (1955)	487.223	L+BN IN CONC BASE OF RR X SIGNAL 15FT N OF N RAIL SPRR + 20FT W C/L WATER ST + 60FT S C/L VALLEY BLVD MKD (50-57A)	SG 1317
BASELINE (1955)	453.829	CS MON OF C/L VALLEY BLVD + 40FT W C/L NOGALES ST FROM THE N	SG 1320
BASELINE (1955)	319.768	L+SPK CTR CONC HDWL 20FT E C/L HACIENDA BLVD + 200FT S C/L VALLEY BLVD	SG 1323
BASELINE (1955)	319.753	L+T CTR CONC HDWL 20FT W C/L HACIENDA BLVD + 200FT S C/L VALLEY BLVD	SG 1324A
BASELINE (1955)	318.946	L+BN SE COR CONC BASE COR POST 25FT W C/L HACIENDA BLVD + 1300FT S OLD VALLEY BLVD	SG 1325
BASELINE (1955)	324.017	L+T CONC CATCH BASIN 30FT W C/L HACIENDA BLVD + 105FT S OF S RAIL UPRR MKD (BM)	SG 1326A
BASELINE (1955)	325.324	L+T S END OF BRIDGE ABUT UPRR 24FT E C/L HACIENDA BLVD + 15FT S OF S RAIL	SG 1327A
BASELINE (1955)	332.727	L+T NR CTR CB RET @ SW COR GALE AVE + HACIENDA BLVD 47FT S + 47FT W C/L INT MKD (BM P)	SG 1328A
BASELINE (1955)	332.111	RDBM TAG N CB 9FT E BCR @ NW COR HACIENDA BLVD + GALE AVE 36FT N + 70FT W C/L INT	SG 1329A
BASELINE (1955)	785.630	BRONZE DISK IN CTR OF CONC ABUT OF SPRR CULV 8FT N OF TRACKS 250FT W INT VERNON AVE + BELLEVUE AVE	SG 1469
BASELINE (1955)	497.840	CS BRASS MON FLUSH IN CB ON SE COR HACIENDA BLVD + LOS ALTOS DR 53FT S + 80FT E C/L INT MKD (BM 38-9A 1963)	SG 1616A
BASELINE (1955)	406.127	RDBM TAG S CB + 1FT W BCR @ SE COR HACIENDA BLVD + HALLIBURTON RD + 40FT S C/L + 84FT E C/L INT	SG 1622A
BASELINE (1955)	405.237	RDBM TAG N CB 1FT E BCR @ NE COR HACIENDA BLVD + HALLIBURTON RD 40FT N + 72FT E C/L INT	SG 1623A
OTTRBEIN (1955)	483.600	CS MON IN WELL 10IN DN 13FT E + 1FT S C/L INT 5TH AVE + FULLERTON RD MKD (BM 44-12)	SG 1632
OTTRBEIN (1955)	499.342	RDBM TAG S END CONC HDWL 40FT N OF DR TO ROWLAND SCHOOL 20FT E C/L FULLERTON RD + 0.5 MI S 5TH AVE	SG 1633
OTTRBEIN (1955)	502.452	CS MON IN WELL 12IN DN @ PI OF CURVE @ S ENT TO ROWLAND SCHOOL 12FT E C/L FULLERTON RD + 0.5 MI S 5TH AVE	SG 1634
OTTRBEIN (1955)	534.905	RDBM TAG NR W EDGE OF CIRC CONC STORAGE TANK 2FT UP ON NE COR FULLERTON RD + MESCAL ST 50FT N + 30FT E C/L INT	SG 1635
OTTRBEIN (1955)	550.794	RDBM TAG 2FT E BCR @ SE COR FULLERTON RD + SENTENO ST 18FT S + 35FT E C/L INT	SG 1636
OTTRBEIN (1955)	588.767	CS TAG + BRAD IN SW END CONC HDWL 50FT S OF DR TO HSE NO 2804 FULLERTON RD 28FT N C/L + 1.5 MI S 5TH AVE	SG 1637

DISTURBED

JUL 1964

LOS ANGELES COUNTY ROAD DEPARTMENT
SURVEY SECTION FIELD ENGINEERING DIVISION

PAGE 4

QUAD-YEAR	ELEV	DESCRIPTION (INCLUDE QUAD AND YEAR IN DESCRIPTION)	BM NUMBER
OTTRBEIN (1955)	589.456	CS MON IN WELL 8IN DN @ PI OF CURVE 65FT FROM CONC HDWL 105FT S OF DR TO HSE NO 2804 FULLERTON RD 9FT N C/L + 1.5 MI S 5TH AVE	SG 1638
OTTRBEIN (1955)	653.369	RDBM TAG IN S END CONC HDWL 30FT SE C/L 18FT S PP NO 875077E + 2.0 MI S 5TH AVE	SG 1640
OTTRBEIN (1955)	870.497	RD MON IN WELL 8IN DN 60FT N C/L PROD EAST RD 35FT NW C/L FULLERTON RD + 15FT E C/L SKYLINE DR	SG 1643
OTTRBEIN (1955)	871.190	CHIS X ON W END POST OF STEEL GUARD RAIL 22FT S C/L EAST RD + 35FT W C/L FULLERTON RD	SG 1644A
OTTRBEIN (1955)	829.932	L+T CONC DR TO HSE NO 1505 EAST RD 27FT N C/L + 0.2 MI W FULLERTON RD	SG 1645
OTTRBEIN (1955)	817.844	CHIS X ON FIRE HYD 4FT UP 25FT N C/L EAST RD 9FT W OF DR TO HSE NO 1485 + 0.25 MI W FULLERTON RD	SG 1646
OTTRBEIN (1955)	779.074	L+T CONC FOUNDATION OF W BRICK GATE POST @ HSE NO 1409 EAST RD 20FT N C/L 70FT E C/L COBAN RD + 0.4 MI W FULLERTON RD	SG 1647
OTTRBEIN (1955)	746.766	RDBM TAG N WINGWALL CONC HDWL 13FT E OF ENT TO HSE NO 1276 EAST RD 15FT S C/L + 0.6 MI W FULLERTON RD	SG 1648
OTTRBEIN (1955)	478.255	L+T E SIDE BOT STEP TO HSE NO 1276 EAST RD 30FT S C/L + 0.6 MI W FULLERTON RD	SG 1649
OTTRBEIN (1955)	720.235	RDBM TAG CTR CONC HDWL @ NE COR EAST RD + VALLE DR 21FT N + 12FT E C/L INT	SG 1650
OTTRBEIN (1955)	720.077	L+T CONC DR TO HSE NO 1141 EAST RD @ NW COR VALLE DR 70FT N + 15FT W C/L INT	SG 1651
OTTRBEIN (1955)	731.889	L+T S CB OF DR TO HSE NO 1001 PAPAYA DR 20FT E C/L + 27FT N C/L PROD EAST RD	SG 1652
OTTRBEIN (1955)	716.798	RDBM TAG CTR CONC HDWL OF DROP INLET 21FT N C/L EAST RD + 300FT W C/L PAPAYA DR	SG 1653
OTTRBEIN (1955)	708.140	RDBM TAG IN CTR CONC HDWL 15FT N C/L EAST RD E PP NO 1124854E + 1.2 MI W FULLERTON RD	SG 1654
OTTRBEIN (1955)	714.645	RDBM TAG IN NE COR CONC FOOTING FOR GAS METER W SIDE HACIENDA COUNTRY CLUB 80FT S C/L EAST RD + 1.4 MI W FULLERTON RD	SG 1655
OTTRBEIN (1955)	728.072	CHIS X IN W POST STEEL GUARD RAIL 17FT S C/L EAST RD 100FT E OF DR TO HSE NO 640 + 1.5 MI W FULLERTON RD	SG 1656
OTTRBEIN (1955)	727.037	L+T ON E SIDE CONC DR TO HSE NO 640 EAST RD 15FT S C/L + 1.5MI W FULLERTON RD	SG 1657
OTTRBEIN (1955)	734.330	CHIS X ON TOP FIRE HYD BET HSE NO 500 + NO 502 EAST RD 25FT S C/L + 30FT E C/L CHURCHILL RD MKD (BM)	SG 1658
OTTRBEIN (1955)	650.138	CHIS X S POST OF STEEL GUARD RAIL 15FT W C/L EAST RD + 1.9 MI W FULLERTON RD	SG 1659
OTTRBEIN (1955)	606.023	L+T NW CB EAST RD 15FT NW C/L 45FT N TP NO W1678Y + 2.0 MI W FULLERTON RD	SG 1660
OTTRBEIN (1955)	547.541	RDBM TAG CTR CONC HDWL 16FT N C/L EAST RD 50FT NW TP NO W1671Y + 1000FT W HACIENDA BLVD	SG 1661

QUAD-YEAR	ELEV	DESCRIPTION (INCLUDE QUAD AND YEAR IN DESCRIPTION)	BM NUMBER
BASELINE (1955)	605.220	CS MON IN WELL 8IN DN ON C/L ENCANADA DR 47FT W C/L HACIENDA BLVD MKD (BM 38-4 1954)	SG 1662
BASELINE (1955)	605.440	CS MON FLUSH @ SW COR HACIENDA BLVD + ENCANADA DR 23FT W + 20FT S C/L INT	SG 1663A
BASELINE (1955)	551.826	RDBM TAG INCTR OF S SIDE CONC VALVE BOX 12FT N + 24FT W C/L INT HACIENDA BLVD + EAST RD	SG 1664
BASELINE (1955)	555.283	L+T IN W END CONC STEP TO OFFICE @ SE COR HACIENDA BLVD + EAST RD 50FT E + 40FT S C/L INT MKD (BM)	SG 1665A
BASELINE (1955)	512.792	L+BRAD 2FT S OF N END CONC HDWL OPP HSE NO 1703 HACIENDA BLVD 21FT E C/L MKD (BM)	SG 1666
BASELINE (1955)	494.182	CS MON IN WELL 12IN DN @ C/L PI 63FT NE C/L INT HACIENDA BLVD + WEST RD	SG 1667
BASELINE (1955)	553.580	L+T 0.9FT N OF N CB FACE 11FT E BCR @ NE COR HACIENDA BLVD + COLIMA RD 42FT N + 84FT E C/L INT	SG 1705A
BASELINE (1955)	552.145	L+T S CB 22FT W BCR @ SW COR HACIENDA BLVD + COLIMA RD 42FT S + 97FT W C/L INT	SG 1706A
OTTRBEIN (1955)	635.512	3/4IN IP 12IN DN 100FT S C/L GRAZIDE RD + 5700FT E HACIENDA BLVD	SG 1717
OTTRBEIN (1955)	595.809	RDBM TAG IN NW CONC FOOTING TO EDISON TOWER NO 1/3 182FT S C/L GRAZIDE RD + 4985FT W ANAHEIM- PUENTE RD	SG 1719
OTTRBEIN (1955)	562.589	RD MON IN WELL 6 IN DN 152FT NE C/L GRAZIDE RD + 4985FT W ANAHEIM-PUENTE RD 2FT S OF 2IN X 3FT GUARD PIPE	SG 1720
OTTRBEIN (1955)	502.299	RD MON IN WELL 6IN DN 152FT NE C/L GRAZIDE RD + 3492FT W ANAHEIM-PUENTE RD 2FT N OF 2IN X 3FT GUARD PIPE	SG 1721
OTTRBEIN (1955)	496.950	2IN IP WITH CS TAG 16IN DN ON C/L GRAZIDE RD @ PI + 3492FT W ANAHEIM-PUENTE RD	SG 1722
OTTRBEIN (1955)	464.143	RD MON IN WELL 150FT SW C/L GRAZIDE RD + 1765FT W ANAHEIM-PUENTE RD 2FT N OF 2IN X 3FT GUARD PIPE	SG 1723
OTTRBEIN (1955)	457.147	RD MON IN WELL 6IN DN 110FT NE C/L GRAZIDE RD + 1765FT W ANAHEIM-PUENTE RD 2FT S OF 2IN X 3FT GUARD PIPE	SG 1724
OTTRBEIN (1955)	462.019	2IN IP IN CONC SLAB FLUSH 24FT S OF FIFTH AVE + 390FT E C/L ANAHEIM-PUENTE RD 35FT E OF 916551E MKD (CSBM 44-14 1955 RE 63)	SG 1725
OTTRBEIN (1955)	460.937	RDBM TAG SW COR CONC PUMP BASE 12IN UP 65FT N C/L FIFTH AVE + 415FT E C/L ANAHEIM-PUENTE RD	SG 1726
OTTRBEIN (1955)	453.486	RDBM TAG CTR HDWL 50FT S C/L FIFTH AVE @ MI POST 0.51 0.5 MI E ANAHEIM-PUENTE RD	SG 1727
OTTRBEIN (1955)	453.326	CS MON 3FT W CULV HDWL 50FT S C/L FIFTH AVE @ MI POST 0.51 0.5 MI E ANAHEIM-PUENTE RD MKD (BM 49-13 1955 RD 63)	SG 1728
OTTRBEIN (1955)	421.056	RDBM TAG N SIDE CONC DR TO HSE NO 1356 ANAHEIM- PUENTE RD 50FT E C/L + 115FT N C/L BONITA VISTA	SG 1729

JUL 1964

LOS ANGELES COUNTY ROAD DEPARTMENT
SURVEY SECTION FIELD ENGINEERING DIVISION

PAGE 6

QUAD-YEAR	ELEV	DESCRIPTION (INCLUDE QUAD AND YEAR IN DESCRIPTION)	BM NUMBER
OTTRBEIN (1955)	418.485	L+T ON N SIDE OF CONC WK TO HSE NO 1344 ANAHEIM-PUENTE RD 50FT E C/L + 240FT N C/L BONITA VISTA LANE MKD (BM)	SG 1730
OTTRBEIN (1955)	390.792	CS MON IN WELL 10IN DN ON C/L ANAHEIM-PUENTE RD 295FT S UPRR TRACK MKD (PUENTE I-12)	SG 1731
OTTRBEIN (1955)	389.669	RDBM TAG IN S HDWL 18FT E C/L ANAHEIM-PUENTE RD + 10FT S C/L UPRR TRACK	SG 1732
OTTRBEIN (1955)	378.492	RDBM TAG 1FT N OF OUT EDGE DR TO FREEMAN READY MIX PLANT 60FT C/L ANAHEIM-PUENTE RD + 950FT N OF UPRR TRACKS	SG 1733
OTTRBEIN (1955)	376.313	L+T CONC RIM WATER VALVE BOX 45FT W C/L ANAHEIM-PUENTE RD + 1250FT N UPRR TRACKS 200FT S OFFICE DAY + NIGHT MFG CO MKD (BM)	SG 1734
BASELINE (1955)	374.516	CHIS SQUARE CTR OF N CULV 70FT S C/L VALLEY BLVD + 30FT W C/L ANAHEIM-PUENTE RD	SG 1735A
BASELINE (1955)	374.528	CT SPK W END CULV HDWL N SIDE SPRR 70FT S C/L VALLEY BLVD + 30FT W C/L ANAHEIM-PUENTE RD MKD (15)	SG 1736A
BASELINE (1955)	335.675	L+T CONC FOUNDATION OF GAS STA 33FT E C/L ALBERT ST + 50FT S C/L OLD VALLEY BLVD MKD (BM)	SG 1738B
BASELINE (1955)	343.504	RDBM TAG N CB 4FT E BCR 20FT N C/L OLD VALLEY BLVD + 28FT E C/L BAJA AVE	SG 1739A
BASELINE (1955)	355.602	RDBM TAG CTR HDWL 45FT N C/L VALLEY BLVD + 350FT W C/L FERRERO LANE	SG 1740A
BASELINE (1955)	357.412	L+BN E END CONC HDWL 80FT S C/L VALLEY BLVD + 350FT W C/L FERRERO LANE	SG 1741A
BASELINE (1955)	370.330	L+BN N CONC HDWL 75FT S C/L VALLEY BLVD + 150FT W C/L WICKFORD AVE	SG 1742A
BASELINE (1955)	373.090	L+T IN END OF ISL 4FT N C/L VALLEY BLVD + 60FT W C/L WICKFORD AVE	SG 1743A
BASELINE (1955)	374.891	CT SPK CTR HDWL 27FT E C/L ANAHEIM-PUENTE RD + 65FT S C/L VALLEY BLVD MKD (BM 16)	SG 1744A
BASELINE (1955)	379.335	RD MON IN WELL 7IN DN @ C/L INT VALLEY BLVD + PASS + COVINA RD	SG 1745A
BASELINE (1955)	390.083	RD MON IN WELL 8IN DN ON C/L INT VALLEY BLVD + HAMBLEDON AVE	SG 1746
BASELINE (1955)	398.358	L+T CTR CONC HDWL 40FT S C/L VALLEY BLVD + 20FT E C/L GIANO AVE	SG 1748
BASELINE (1955)	398.416	L+T N CB 6FT E BCR 40FT N C/L VALLEY BLVD + 46FT E C/L GIANO AVE	SG 1749
BASELINE (1955)	412.390	L+BN IN RR SIGNAL BASE 75FT S C/L VALLEY BLVD + 35FT W C/L YORBITA RD	SG 1750
BASELINE (1955)	410.069	RDBM TAG CTR CONC HDWL 43FT N C/L VALLEY BLVD + 25FT E C/L YORBITA RD	SG 1751
BASELINE (1955)	419.923	RDBM TAG W CB 11FT N BCR 81FT N C/L VALLEY BLVD + 20FT W C/L LA SEDA RD	SG 1752
BASELINE (1955)	419.895	L+T E CB 12FT N BCR 82FT N C/L VALLEY BLVD + 20FT E C/L LA SEDA RD	SG 1753

JUL 1964

LOS ANGELES COUNTY ROAD DEPARTMENT
SURVEY SECTION FIELD ENGINEERING DIVISION

PAGE 7

QUAD-YEAR	ELEV	DESCRIPTION (INCLUDE QUAD AND YEAR IN DESCRIPTION)	BM NUMBER
BASELINE (1955)	429.656	L+BN E END CONC HDWL 70FT S C/L VALLEY BLVD + 0.2MI E LA SEDA RD MKD (BM 12)	SG 1754
BASELINE (1955)	432.940	RDBM TAG N CB 1FT W CATCH BASIN 40FT N VALLEY BLVD + 0.2 MI E LA SEDA RD	SG 1755
OTTRBEIN (1955)	520.800	RDBM TAG IN E CB LEMON AVE 30FT E C/L + 0.2 MI N CURRIER RD NR DRAINAGE BOX FROM WALNUT SCHOOL	SG 1786
OTTRBEIN (1955)	521.197	RDBM TAG IN S END CONC WALL OF BUS LOADING YARD @ WALNUT SCHOOL 40FT E C/L LEMON AVE + 0.2 MI N CURRIER RD	SG 1787
OTTRBEIN (1955)	525.377	EDISON CO BR MON FLUSH 26FT N C/L CURRIER RD + 34FT E C/L LEMON AVE (USE NW EDGE)	SG 1788
OTTRBEIN (1955)	527.373	RDBM TAG W END CONC HDWL 17FT S C/L CURRIER RD + 46FT E C/L LEMON RD	SG 1789
OTTRBEIN (1955)	529.111	L+T NR CTR OF CURVED CONC HDWL 24FT N C/L LYCOMING ST + 26FT E C/L LEMON RD	SG 1790
OTTRBEIN (1955)	528.901	L+T NR CTR OF CURVED CONC HDWL 28FT S C/L LYCOMING ST + 26FT E C/L LEMON RD	SG 1791
OTTRBEIN (1955)	535.502	L+BN S END CONC HDWL 23FT N C/L LYCOMING ST + 42FT W C/L BANNING WAY MKD (BM)	SG 1792
OTTRBEIN (1955)	538.730	L+BN W END OF CONC HDWL 18FT E C/L BANNING WAY + 18FT S C/L LYCOMING ST	SG 1793
OTTRBEIN (1955)	548.727	L+BN NR CTR OF W CONC HDWL 18FT S C/L LYCOMING ST 0.2 MI W OLD BREA CANYON RD MKD (BM)	SG 1794
OTTRBEIN (1955)	549.033	L+BN NR CTR OF E CONC HDWL 18FT S C/L LYCOMING ST + 0.2 MI W OLD BREA CANYON RD MKD (BM)	SG 1795
OTTRBEIN (1955)	558.329	L+B IN NE COR CONC BRIDGE NO B7 12FT E C/L OLD BREA CANYON RD + 232FT N LYCOMING ST	SG 1796
OTTRBEIN (1955)	558.623	CS MON IN WELL 8IN DN @ NW COR OLD BREA CANYON RD + LYCOMING ST 12FT W + 10FT N C/L INT MKD (BM44-3)	SG 1797
OTTRBEIN (1955)	579.903	RDBM TAG IN CONC HDWL @ NE COR FIFTH AVE + OLD BREA CANYON RD 26FT N + 26FT E C/L INT	SG 1798
OTTRBEIN (1955)	578.650	CS MON IN WELL @ NW COR OLD BREA CANYON RD + FIFTH AVE 11FT N + 11FT W C/L INT	SG 1799
OTTRBEIN (1955)	641.953	USC+GS TRI STA MON FLUSH 27FT W C/L OLD BREA CANYON RD @ INT BREA CANYON RD MKD (STOP 1938)	SG 1800
OTTRBEIN (1955)	717.377	USC+GS MON 6IN UP 50FT E C/L BREA CANYON RD + 0.3 MI S OLD BREA CANYON RD MKD (M 346)	SG 1802
OTTRBEIN (1955)	741.766	USC+GS BR MON FLUSH 50FT E C/L BREA CANYON RD + 0.4 MI S OLD BREA CANYON RD NR HDWL NO B 191 + 25 MKD (N 346)	SG 1803
OTTRBEIN (1955)	801.688	USC+GS MON FLUSH 48FT E C/L BREA CANYON RD + 0.7 MI S OLD BREA CANYON RD 65FT N HDWL NO B 173+89 MKD (S 346)	SG 1804
OTTRBEIN (1955)	793.864	RDBM TAG NR N END HDWL NO B 173+89 20FT E C/L BREA CANYON RD + 0.7 MI S OLD BREA CANYON RD	SG 1805
OTTRBEIN (1955)	772.602	RDBM TAG IN CONC CATTLE UNDER PASS NO B 158+59 32FT W C/L BREA CANYON RD + 1.0 MI N BREA CANYON CUTOFF RD	SG 1806

JUL 1964

LOS ANGELES COUNTY ROAD DEPARTMENT
SURVEY SECTION FIELD ENGINEERING DIVISION

PAGE 8

QUAD-YEAR	ELEV	DESCRIPTION (INCLUDE QUAD AND YEAR IN DESCRIPTION)	BM NUMBER
OTTRBEIN (1955)	771.437	RDBM TAG IN S END CONC CATTLE UNDERPASS NO B 158+50 24FT E C/L BREA CANYON RD + 1.0 MI N BREA CANYON CUTOFF RD	SG 1807
OTTRBEIN (1955)	731.026	USC+GS BR MON FLUSH 50FT E C/L BREA CANYON RD + 0.7 MI N BREA CANYON CUTOFF RD MKD (X 346)	SG 1808
OTTRBEIN (1955)	727.345	RDBM TAG NR S END CONC HDWL NO 140+93 20FT W C/L BREA CANYON RD + 0.65 MI N BREA CANYON CUTOFF RD	SG 1809
OTTRBEIN (1955)	708.913	RDBM TAG NR S END CONC HDWL NO 127+79 20FT W C/L BREA CANYON RD + 0.4 MI N BREA CANYON CUTOFF RD	SG 1810
OTTRBEIN (1955)	708.143	USC+GS BR MON FLUSH NR HDWL NO 127+79 20FT W C/L BREA CANYON RD + 0.4 MI N BREA CANYON CUTOFF RD MKD (C 347)	SG 1811
OTTRBEIN (1955)	692.623	USC+GS BR MON FLUSH 26FT E C/L BREA CANYON RD + 0.2 MI N BREA CANYON CUTOFF RD MKD (F 347)	SG 1812
OTTRBEIN (1955)	692.859	RDBM TAG IN CONC HDWL NO B 118+54 20FT W C/L BREA CANYON RD + 0.2 MI N BREA CUTOFF RD	SG 1813
OTTRBEIN (1955)	678.372	USC+GS BR MON FLUSH 25FT E C/L BREA CANYON RD + 210FT S C/L BREA CANYON CUTOFF RD MKD (H 347)	SG 1814
OTTRBEIN (1955)	681.867	USC+GS BR WITNESS COR FLUSH 4FT S + 25FT W C/L INT BREA CANYON CUTOFF RD + BREA CANYON RD MKD (SPADRA NO 1)	SG 1815
OTTRBEIN (1955)	762.513	RDBM TAG NR CTR CONC HDWL 18FT N C/L BREA CANYON CUTOFF RD + 0.3 MI N BREA CANYON RD	SG 1816
OTTRBEIN (1955)	765.953	CS BR MON 2IN UP NR 2IN WHITE WITNESS PIPE 110FT N C/L BREA CANYON CUTOFF RD + 0.3 MI N BREA CANYON RD MKD (BM 12)	SG 1817
OTTRBEIN (1955)	809.222	CS BR MON 2IN UP NR 2IN WHITE WITNESS PIPE 50FT E OF E END OF BRIDGE NO B 761 75FT N C/L BREA CANYON CUTOFF RD + 0.5 MI N BREA CANYON RD MKD (BM 11)	SG 1818
OTTRBEIN (1955)	821.605	RDBM TAG IN CONC HDWL 15FT N C/L BREA CANYON CUTOFF RD + 0.55 MI N BREA CANYON RD	SG 1819
OTTRBEIN (1955)	872.247	BT SPK IN CONC HDWL 15FT N C/L BREA CANYON CUTOFF RD + 0.75 MI N BREA CANYON RD 550FT FROM SUMMIT MKD (BM 9)	SG 1820
OTTRBEIN (1955)	874.153	2IN IP 2IN UP 50FT S C/L BREA CANYON CUTOFF RD + 0.75 MI N BREA CANYON RD 500FT FROM SUMMIT MKD (LS 2311)	SG 1821
OTTRBEIN (1955)	894.530	BT HD SPK IN CONC HDWL 21FT W C/L BREA CANYON CUTOFF RD + 0.9 N BREA CANYON RD MKD (BM 7)	SG 1822
OTTRBEIN (1955)	872.072	BT SPK IN CONC DROP INLET 15FT W C/L BREA CANYON CUTOFF RD + 1.0 MI N BREA CANYON RD MKD (BM6)	SG 1823
OTTRBEIN (1955)	772.369	BT SPK IN CONC HDWL OF CATTLE UNDERPASS 16FT SW C/L BREA CANYON CUTOFF RD + 0.75 MI S FIFTH AVE MKD (BM 3)	SG 1824
OTTRBEIN (1955)	770.139	RDBM TAG IN CONC HDWL TO CATTLE UNDERPASS 10FT NE C/L BREA CANYON CUTOFF RD + 0.75 MI S FIFTH AVE	SG 1825
OTTRBEIN (1955)	725.117	L+BN IN CONC HDWL OF DIRT RD TO WATER TANK 10FT N C/L 66FT W C/L BREA CANYON CUTOFF RD + 0.6 MI S FIFTH AVE MKD (BM)	SG 1826

