

Attachment O

The Medical Examiner is expected to vacate the site in April-May 2026. The start of all construction work affecting Medical Examiner's operations must be coordinated to begin after this date. Medical Examiner must be kept in operation. The project is anticipated to be awarded in January 2026. Any work not affecting Medical Examiner's operations can begin, ie. tree cutting, landscaping, abatement, trash removal, demo not affecting Medical Examiner, etc. The maps in page 2 and 3 show the areas the Medical Examiner is utilizing. They are occupying the building south of the Former Hospital and is currently utilizing three rooms within the main hospital (shown on page 3).



PROJECT DATA	DATE	DATE
ARCHITECT	06	
CHECKED BY	DB	
DRAWN BY	BN	
SCALE	AS SHOWN	
SHEET TITLE	EXISTING SITE PLAN	

GENERAL NOTES
A. SEE OTHER DRAWINGS FOR ALL SCOPE OF WORK.

RELATED PERMITS

NO.	DATE	DESCRIPTION
1	10/15/2021	PERMITS
2	10/15/2021	PERMITS
3	10/15/2021	PERMITS
4	10/15/2021	PERMITS
5	10/15/2021	PERMITS
6	10/15/2021	PERMITS
7	10/15/2021	PERMITS
8	10/15/2021	PERMITS
9	10/15/2021	PERMITS
10	10/15/2021	PERMITS
11	10/15/2021	PERMITS
12	10/15/2021	PERMITS
13	10/15/2021	PERMITS
14	10/15/2021	PERMITS
15	10/15/2021	PERMITS
16	10/15/2021	PERMITS
17	10/15/2021	PERMITS
18	10/15/2021	PERMITS
19	10/15/2021	PERMITS
20	10/15/2021	PERMITS
21	10/15/2021	PERMITS
22	10/15/2021	PERMITS
23	10/15/2021	PERMITS
24	10/15/2021	PERMITS
25	10/15/2021	PERMITS
26	10/15/2021	PERMITS
27	10/15/2021	PERMITS
28	10/15/2021	PERMITS
29	10/15/2021	PERMITS
30	10/15/2021	PERMITS
31	10/15/2021	PERMITS
32	10/15/2021	PERMITS
33	10/15/2021	PERMITS
34	10/15/2021	PERMITS
35	10/15/2021	PERMITS
36	10/15/2021	PERMITS
37	10/15/2021	PERMITS
38	10/15/2021	PERMITS
39	10/15/2021	PERMITS
40	10/15/2021	PERMITS
41	10/15/2021	PERMITS
42	10/15/2021	PERMITS
43	10/15/2021	PERMITS
44	10/15/2021	PERMITS
45	10/15/2021	PERMITS
46	10/15/2021	PERMITS
47	10/15/2021	PERMITS
48	10/15/2021	PERMITS
49	10/15/2021	PERMITS
50	10/15/2021	PERMITS
51	10/15/2021	PERMITS
52	10/15/2021	PERMITS
53	10/15/2021	PERMITS
54	10/15/2021	PERMITS
55	10/15/2021	PERMITS
56	10/15/2021	PERMITS
57	10/15/2021	PERMITS
58	10/15/2021	PERMITS
59	10/15/2021	PERMITS
60	10/15/2021	PERMITS
61	10/15/2021	PERMITS
62	10/15/2021	PERMITS
63	10/15/2021	PERMITS
64	10/15/2021	PERMITS
65	10/15/2021	PERMITS
66	10/15/2021	PERMITS
67	10/15/2021	PERMITS
68	10/15/2021	PERMITS
69	10/15/2021	PERMITS
70	10/15/2021	PERMITS
71	10/15/2021	PERMITS
72	10/15/2021	PERMITS
73	10/15/2021	PERMITS
74	10/15/2021	PERMITS
75	10/15/2021	PERMITS
76	10/15/2021	PERMITS
77	10/15/2021	PERMITS
78	10/15/2021	PERMITS
79	10/15/2021	PERMITS
80	10/15/2021	PERMITS
81	10/15/2021	PERMITS
82	10/15/2021	PERMITS
83	10/15/2021	PERMITS
84	10/15/2021	PERMITS
85	10/15/2021	PERMITS
86	10/15/2021	PERMITS
87	10/15/2021	PERMITS
88	10/15/2021	PERMITS
89	10/15/2021	PERMITS
90	10/15/2021	PERMITS
91	10/15/2021	PERMITS
92	10/15/2021	PERMITS
93	10/15/2021	PERMITS
94	10/15/2021	PERMITS
95	10/15/2021	PERMITS
96	10/15/2021	PERMITS
97	10/15/2021	PERMITS
98	10/15/2021	PERMITS
99	10/15/2021	PERMITS
100	10/15/2021	PERMITS

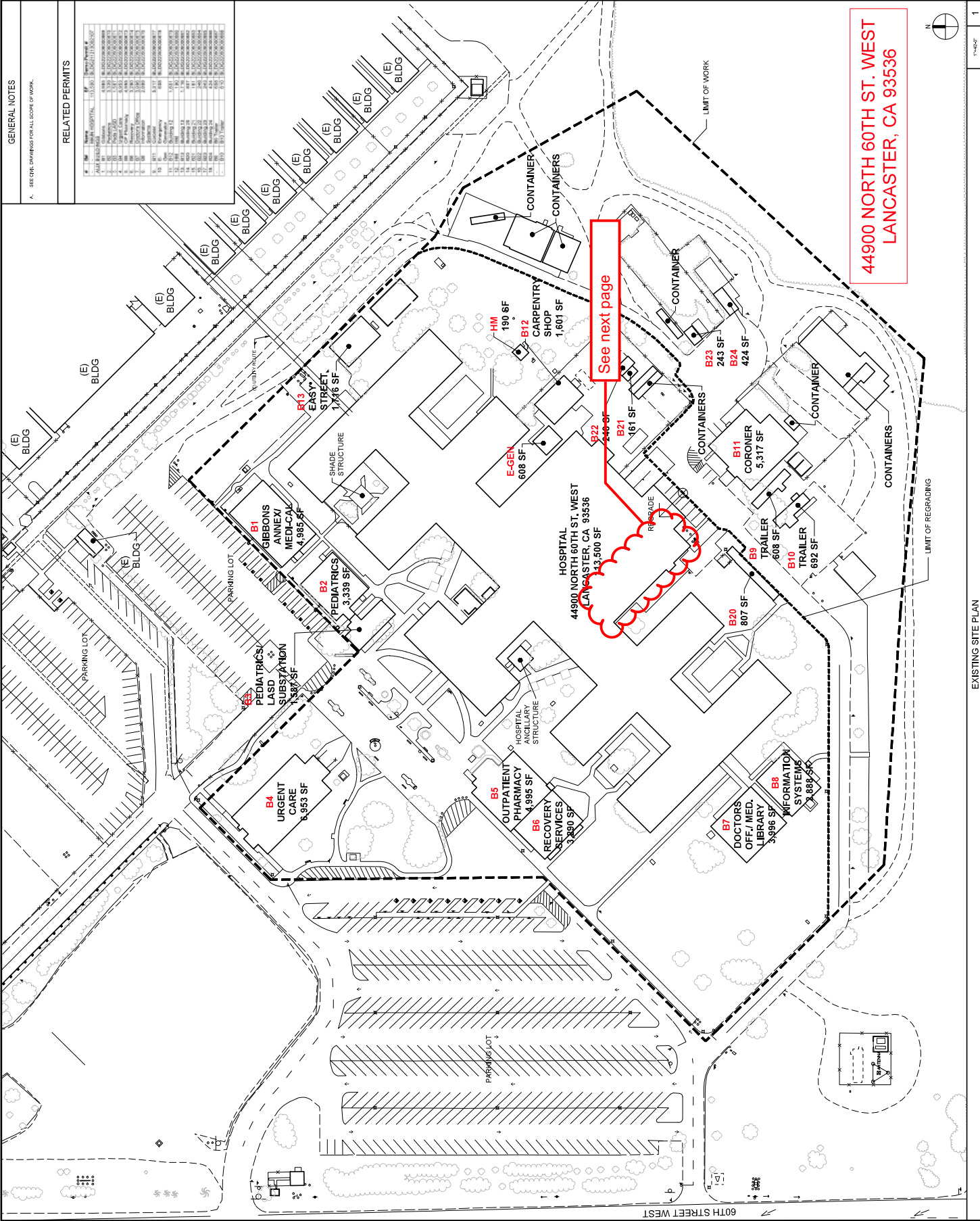

44900 NORTH 60TH ST. WEST
LANCASTER, CA 93536

LOS ANGELES COUNTY - EXISTING DOCUMENT DRAWINGS

HIGH DESERT HOSPITAL

PROJECT	22701-016-004
BUILDING	MAIN HOSPITAL
FLOOR	1ST FLOOR
SPECIFICATION	ARCHITECTURAL
DESCRIPTION	FLOOR PLAN
SCALE	NOT TO SCALE
DATE	APR. 1, 2002

A0100

Medical examiner is using these rooms. These will need to be kept operational until April-May 2026.

