

AMENDMENT TO CITY OF SIGNAL HILL' NONDISPOSAL FACILITY ELEMENT 2009

November 19, 2009

Presented by: Wu Tan

OVERVIEW

- The Waste Board approved the City of Signal Hill' NDFE in 1996.
- The City is proposing to amend its NDFE to include a new facility.
- The facility would be utilized by the City of Signal Hill and surrounding jurisdictions.

OVERVIEW

- The new facility would be called “EDCO Recycling and Transfer” facility and will be operated and owned by EDCO.
- The owner/operator of the facility is in the process of obtaining Solid Waste Facility Permit (SWFP).

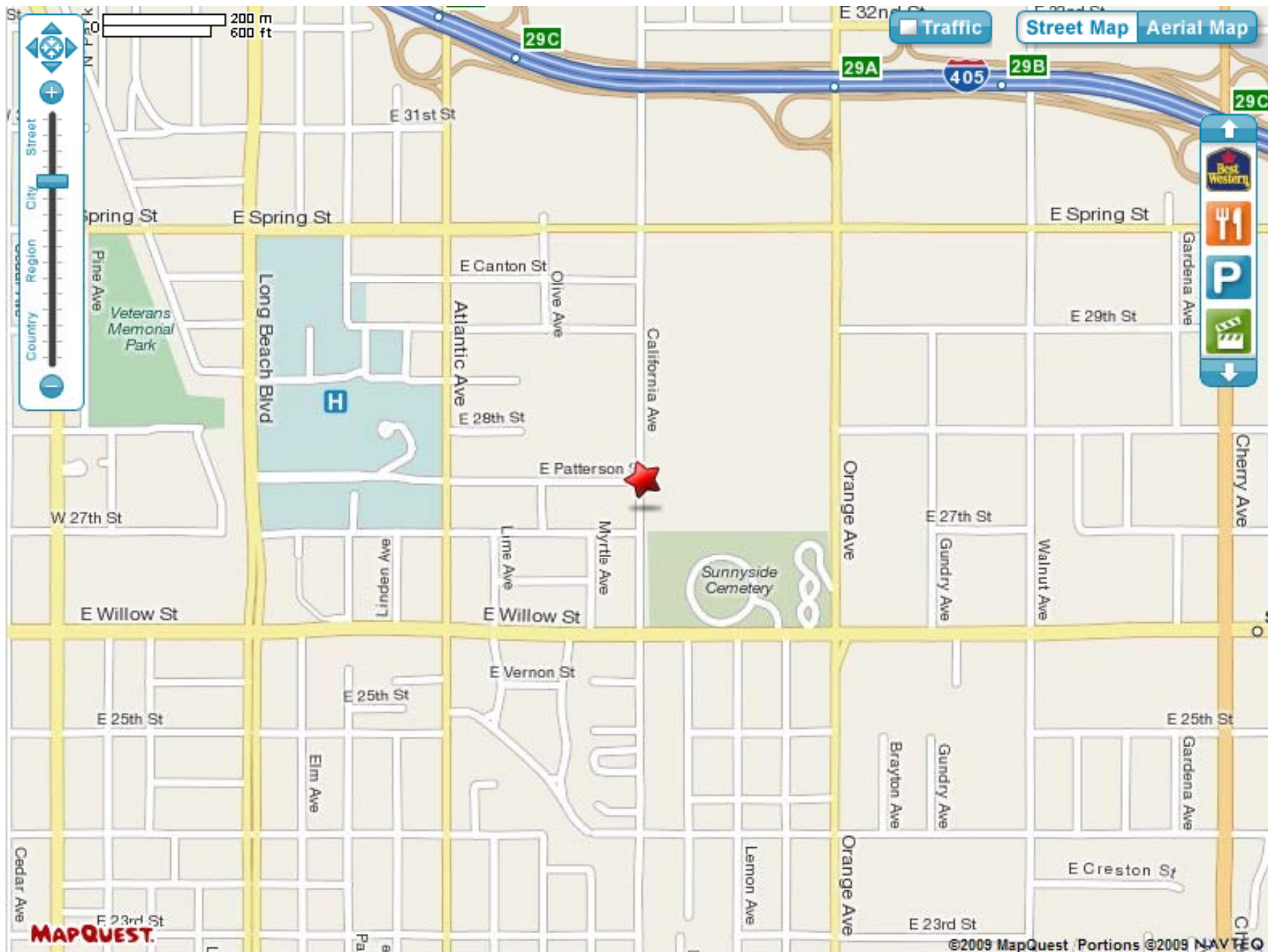

EDCO Recycling and Transfer



2755 California Avenue, Signal Hill







View from Patterson St. and California Ave. facing northwest



View from California Ave. and 28th St. facing southwest



View from Patterson St. and Olive Ave. facing northeast



View from Patterson St. facing north



View from Patterson St. facing northwest



View from California Ave. facing west



View from 28th St. and Olive Ave. facing southeast



Overhead view of the proposed facility

SITE ANALYSIS

SITE AREA	150,000 S.F.
USEFUL BUILDING AREA	2,000 S.F.
TOTAL	152,000 S.F.
	(5.74 ACRES)

BUILDING AREA ANALYSIS

TRANSFER STATION	35,855 S.F.
MATERIAL RECOVERY FACILITY	27,200 S.F.
OFFICE/EMPLOYEE FACILITY	3,200 S.F.
MAINTENANCE SHOP	3,200 S.F.
PAVING	1,800 S.F.
SHOP	3,200 S.F.
SCALE HOUSE	800 S.F.
TOTAL	80,055 S.F.

PARKING PROVIDED

STANDARD STALL	38
TRUCK STALL	38
TOTAL	76

TRUCK STALLS	5
--------------	---

CIRCULATION LEGEND

TRANSFER TRUCKS	→
COLLECTOR TRUCKS	→
RECYCLABLE LOADS	→
EMPLOYEE	→
C&D	→
HAUL	→

LEGEND

PUMP	PLUGGED AND ABANDONED - DRY HOLE (SHOWING YOUR DRILLED AND TOTAL DEPTH)
CU	COMPLETED - OIL WELL (ACTIVE OIL PUMP)
PWA	PLUGGED AND ABANDONED - OIL WELL
W	WROUGHT IRON

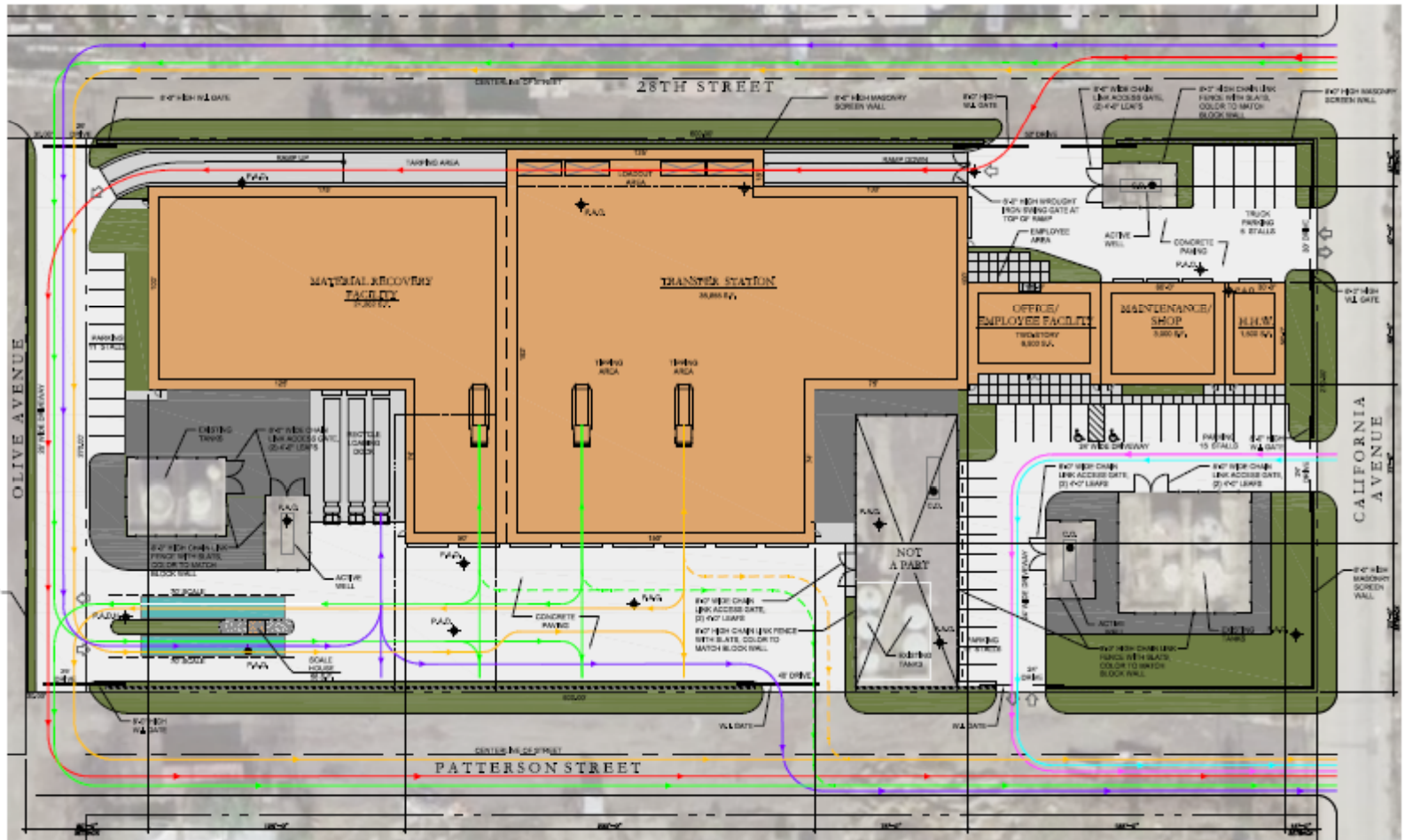

EDCO RECYCLING & TRANSFER

CALIFORNIA AVENUE
SIGNAL HILL, CALIFORNIA

SITE PLAN

3/15/2010

2/1/10 201

3-Dimensional Tour of EDCO Recycling and Transfer Facility



STAFF FINDINGS

The proposed NDFE Amendment:

1. Conforms with Countywide Integrated Waste Management Plan
 - Incorporating the recommended facility will not impair solid waste management activities in Los Angeles County

STAFF FINDINGS

The proposed NDFE Amendment :

2. Complies with Environmental Regulations
 - Amending the NDFE is not subject to environmental review. Therefore, no environmental document was prepared.

STAFF FINDINGS

The proposed NDFE Amendment:

3. Complies with State Law and Regulations
 - The NDFE Amendment complies with the facility description requirements in State regulations (Section 18752 et seq, Title 14 of the California Code of Regulations)

STAFF RECOMMENDATION

- Concur with the subject amendment to the City of Signal Hill's NDFE.
- Request the facilities owner/operator to submit monthly reports on a quarterly basis to the Los Angeles County Department of Public Works via on-line (www.solidwastedrs.org)

Questions?