

October 9, 2025

TO: Members of the Facility and Plan Review Subcommittee
Los Angeles County Solid Waste Management Committee/
Integrated Waste Management Task Force

FROM: Alexander Fitchmun, Staff *AF*

STAFF REPORT
SECOND QUARTER 2025 VEGETATION PROJECT STATUS REPORT
AT SUNSHINE CANYON CITY/COUNTY LANDFILL

Republic Services, Inc. (Republic) submitted the Second Quarter 2025 Vegetation Project Status Report for the Sunshine Canyon City/County Landfill, received on July 31, 2025. The Status Report is a requirement of Conditional Use Permit Condition 44A, and Los Angeles City Condition [Q] C8 of Ordinance Number 172933, and Condition 18B of the Finding of Conformance granted to the landfill by the Task Force on December 18, 2008. This report presents the progress of the site's landscaping and revegetation activities for the second quarter of 2025.

City Side South Sage Pilot Project Area - Deck C / Lower Deck

- Since the Saddle Ridge fire, Deck C appears to have fully recovered and indicates that a sustainable shrubland vegetation community has been established; the most prevalent native species as of the second quarter of 2025 include the California Sunflower and Saltbush.
- Native grass species, such as the beardless wild rye, have shown recovery from the previous weeding activities performed in fall of 2024 and exotic annual plant species have begun seeding in the second quarter of 2025.
- Many non-native forb species have decreased in cover as they are outcompeted by newly germinated native shrubs. In general, non-native plant cover has decreased from the first quarter to the second quarter due to water availability and annual species life span and is expected to continue to decrease through summer 2025.
- Many of the non-native plant cover observed in the second quarter of 2025 include, short-podded mustard, redstem filaree, and centaurea melitenensis. Eucalyptus trees are recommended to be removed to prevent possible overturn and cap damage during high wind events.

City Side South - Deck B Area / Middle Deck

- Invasive Slenderleaf Iceplant continues to spread slowly across the deck in the exposed areas where no vegetation cover exists.

- Revegetation efforts have been successful in the establishment of the Venturan Coastal Sage Scrub with diversification of other larger species spreading northward of the deck, closing off the canopy in several areas.
- Native vegetation on the Middle Deck are in vegetative or flowering state, with abundant woody shrubs like Brittlebush, Coastal Goldenbush, California Sagebrush, and Deerweed. Species diversity is greater here than on the lower and upper decks.
- Non-native species such as red brome, short-podded mustard, and iceplant were observed in their seeding and senesced state are expected to decrease in the later months of 2025 as water availability decreases. The small-flowered iceplant has also decreased in cover between 2024 and 2025.
- California Pepper Trees and Tamarix have been identified in the area and have been recommended for removal to prevent possible overturn and cap damage during high wind events.

City Side Sage Mitigation Area – Deck A / Upper Deck

- The southern center of vegetation coverage is higher than in other areas of Deck A with native California Buckwheat currently flowering and non-native herbaceous plant species including Wild Oats, Russian Thistle, and Short Podded Mustard.
- Mitigation efforts for deck A began in the second quarter of 2025 with additional low-lying areas of deck A being identified and are planned to be filled in August 2025. Additional mitigation efforts will include weed abatement, which is anticipated to start this summer, and seeding, which is projected to start in Q4 2025.
- The replacement of the booster pump and power for irrigation to Deck A, will start with a site walk to determine the replacement strategy and will begin in late 2026.

County Sage Mitigation Areas

- No revegetation activities were conducted at the County Sage Mitigation Areas in the second quarter and have remained unchanged since the first quarter of 2025.
- The southeastern area shows moderate cover of mostly native California buckwheat, observed to be in its vegetative or flowering state, along with some exotic species and small patches in the north-central area.
- The non-native plant cover primarily consists of brome grasses, wild oats, and mustards and are either in their flowering or seeding state. Non-native plant cover is anticipated to decrease in the late summer months of 2025 as a result of decreased water availability.

Big Cone Douglas Fir Tree Mitigation

- Plans to replenish Douglas Fir Tree mitigation bank include:
 - Seed collection will continue in quarter one of 2025 or quarter two of 2025.
 - Seeds will be potted in Spring or Summer 2025 and will germinate for one year at a nursery.
 - After saplings are viable, they will be transplanted at the mitigation site through Fall 2026.
- In April 2025, Sunshine Canyon Landfill gave away 33 Live and Coastal Scrub Oak to the City of Los Angeles to be planted at local parks.

July 31, 2025

Mr. David Nguyen
County of Los Angeles, Department of Public Works
900 South Fremont Avenue
Alhambra, CA 91803-1331

Subject: Sunshine Canyon Landfill, Quarterly Vegetation Report
Second Quarter 2025 Vegetation Report

Mr. Nguyen,

This report has been prepared in accordance with the following:

- Condition 18B of the Finding of Conformance
- Condition 44A of the Condition Use Permit (CUP)
- Los Angeles City Condition [Q] C.8 of the Ordinance No. 172,933

This report presents the progress of the site's landscaping and revegetation activities for the second quarter of 2025. The intent of these reports is to provide detailed information regarding the site's efforts related to vegetation including vegetation of interim and permanent slopes and activities conducted for the on-site sage mitigation areas.

Architerra Design Group continues to assist site personnel in evaluating current site conditions relating to vegetation and provide recommendations for future efforts. This report includes their assessment of the pilot sage vegetation area as well as recommendations for this area. Architerra's evaluation is in addition to the required quarterly monitoring performed by our consulting biologist.

1.0 Interim Slopes

For the purposes of this report, interim slopes are those defined as slope areas where no activities have taken place for 180 days or longer. CUP Condition 44A requires "a temporary hydroseed vegetation cover on any slope or landfill area that is projected to be inactive for a period of greater than 180 days".

1.1 Hydroseeding Activities

Based on the results of the trial project completed in August 2017, a 57-acre vegetative cover project using the approved seed mix was completed in mid-December 2017. Additionally, the site completed hydroseeding approximately 155 acres; application of the approved seed mix was completed during 2019. The increase in hydroseeding application is a result of our normal winterization efforts along with slope revegetation as a result of the Saddle Ridge Fire that impacted Sylmar, CA on October 2019. These areas continue to have successful vegetation growth.

2.0 Permanent Slopes

Permanent slopes are defined as those where no landfilling activities will be conducted in the future.

As part of our Saddle Ridge Fire recovery efforts both the City and County permanent slopes of the landfill had hydroseed applied as necessary. This application of hydroseed was completed for soil stabilization purposes.

3.0 Non-Permanent Cut Slopes

Prior quarterly vegetation reports have illustrated one area above the front terminal sedimentation basin and one area near the temporary bypass road as “non-permanent cut slopes”. An evaluation of these areas has been conducted and it has been determined that these areas are “permanent slopes” because no landfilling activities will be conducted against these slopes in the future.

4.0 Activities Conducted in Sage Mitigation Areas – 2Q2025

During the second quarter of 2025, the following activities were conducted in the sage mitigation areas at the landfill.

4.1 City South Sage Pilot Project Area – Deck C

The lower Deck C mitigation project area was impacted by the Saddle Ridge fire in October 2019. As noted in Rincon’s (formerly JMA) City-Side Sage Mitigation Area Lower Deck report a substantial amount of the lower deck was burned or scorched. However, in previous reports they note that because this was an established site, they expect natural re-establishment of the native vegetation within the first two to three years. Rincon has noted a substantial amount of regrowth has occurred following the fire and included the most prevalent natives such as California Sunflower, Saltbush, Horsetweed, and pockets of Wild Ryegrass. Rincon also noted non-native plant cover has decreased between first and second quarter monitoring.

As reported previously, Architerra Design Group indicates that there has been an abundance of Venturan CSS species germinating and crown-sprouting since the fire. The species following the rebound include Purple Sage, Coast Sunflower,

White Sage, Creeping Wild Rye, Deerweed, Black Sage, and Mexican Elderberry. Surprisingly there are also new species from the original seed mix are now sprouting up in decent numbers and included in the list below:

- Purple Sage (*Salvia leucophylla*)
- Coast Sunflower (*Encelia californica*)
- White Sage (*Salvia apiana*)
- Creeping Wild Rye (*Leymus triticoides*)
- Deerweed (*Lotus scoparius*)
- Black Sage (*Salvia mellifera*)
- Mexican Elderberry (*Sambucus mexicana*)
- Scarlet Bugler (*Penstemon centranthifolia*)
- Telegraph Weed (*Heterotheca grandiflora*)
- Monkey Flower (*Mimulus aurantiacus*)
- Smooth-Leaf Yerba Santa (*Eriodictyon trichocalyx*)
- Thicketleaf Yerba Santa (*Eriodictyon crassifolium*)
- Sunflower (*Helianthus annuus*)
- California Bush Sunflower (*Encelia californica*)
- California Sagebrush (*Artemisia californica*)
- California Buckwheat (*Eriogonum fasciculatum*)
- Quail Bush (*Atriplex lentiformis*)
- Four-Wing Saltbush (*Atriplex canescens*)
- Cattle Spinach (*Atriplex polycarpa*)
- Spinescale (*Atriplex spinifera*)
- Toyon (*Heteromeles arbutifolia*)
- Foothill Needlegrass (*Nassella lepida*)
- Coyote Bush (*Baccharis pilularis*)
- Showy Penstemon (*Penstemon spectabilis*)
- Wright's Cudweed (*Pseudognaphalium microcephalum*)
- White Horehound (*Marrubium vulgare*) Non-Native
- Australian Saltbush (*Atriplex semibaccata*) Non-Native

As reported from Architerra, the abundance of historic level rains last two winters and the summer 2023 storm Hillary has assisted in the emergence of many of the Ventruan CSS Species. These Ventruan CSS Species have been viewed to be in various stages of growth, along with several Saltbush species which have begun to flower. Overall these species have benefited from average to above-average rainfall over the past few years. Recent weed growth on Deck C has been minimal given the dry climate and lack of precipitation over the past few months. The weed growth that has been viewed includes: Shortpod Mustard (*Hirschfeldia incana*), Russian Thistle (*Salsola* ssp.), Yellow Star Thistle (*Centaurea solstitialis*), Tree Tobacco (*Nicotiana glauca*), Italian Thistle (*Carduus pycnocephalus*), and Stinkwort (*Dittrichia graveolens*). Weeds such as California Bush Sunflower (*Encelia californica*), California Sagebrush (*Artemisia californica*), and Deerweed (*Acmispon glaber*) have entered into their summer dormancy period and have begun to defoliate.

A year-round weed control program has been recommended to be implemented in the late winter to early spring (February-April) so that non-native plants don't set seed, using both chemical and mechanical control practices. A qualified biologist should identify and flag native species to avoid unintentional damage. Dead plant material with potential seed will need to be cleared and removed off-site before seed drop. These areas will then need to be reseeded with native species such as Beardless wild rye (*Elymus triticoides*) and Yarrow (*Anchillea millefolium*). Continuous monitoring and maintenance should proceed, ensuring weed control efforts are effective and native vegetation is successfully reestablished.

4.2 City South Deck B

The Deck B sage mitigation project began on April 9, 2018 and planting was completed by the end of the fourth quarter 2018. Soil samples indicated low pH and high salinity, as a result Deck B underwent a leaching schedule. Additional soil amendments and resampling were completed before planting began, which took place during the fourth quarter 2018. Pacific Restoration Group, Inc (PRG) has been working with Architerra for the completion of project. A summary of the progress is included in Attachment 3. The northwest portion of the Middle Deck burned during the Saddle Ridge Fire in October 2019. Architerra Design Group (ADG) indicated previously Deck B was doing quite well and there was minimal weed growth occurring with the exception of Shortpod Mustard and Slenderleaf Iceplant. These species have been observed to be in their vegetative state. Non-native plants have seen minimal growth due to the lack of precipitation over the past few months.

During Ricon's observation of Deck B, dominant native cover included brittlebush (*Encelia farinosa*), coast prickly pear (*Opuntia littoralis*), big saltbush (*Atriplex lentiformis*), deerweed (*Acmispon glaber*), California buckwheat (*Eriogonum fasciculatum*), California sagebrush (*Artemisia californica*), white sage (*Salvia apiana*), coyote brush (*Baccharis pilularis*), and herbaceous species such as beardless wild rye.

Revegetation efforts have been successful in the establishment of the Venturan Coastal Sage Scrub habitat and evidence of species and age diversity and resprouting of larger species. Architerra also noted Deck B site is similar to those found on Deck C in the growth of the VCSS. The VCSS continues to grow and close off the canopy in several areas. Deck B is also dominated by California Buckwheat (*Eriogonum fasciculatum*). However, the downslopes are primarily covered with little to no native species and should be addressed to remove the invasive weeds as soon as possible. It was also noted the native Creeping Rye Grass was also scalped in this area. Maintenance crews have been educated to distinguish natives versus non-native species. Invasive Slenderleaf Iceplant (*Mesembryanthemum nodiflorum*) has been growing in the revegetation area and has gradually spread northward where no vegetation cover exists. Maintenance of the ice plant has been

minimal and continues to spread. The northern part of Deck B has been completely filled in and is well established with shading to prevent weed growth.

Overall, there is a good species diversity on this deck and planting is responding well with vigorous growth. It was also noted several California Pepper Trees (*Schinus molle*) and Saltcedar (*Tamarisk sp.*) should be removed.

4.3 City South Deck A

In December 2022, Conversations with Architerro were started to discuss a plan to address the potential mitigation plans for Deck A. An onsite meeting occurred during May 2023 for an initial assessment of Deck A and determine what will need to be done. We anticipate a tentative schedule to be established in the coming months.

Prior to any mitigation efforts, soil was placed in a large area affected by subsidence and graded for proper drainage. This occurred in June and July 2023 and has began in quarter two 2025, mitigation plans will commence to address the area. Additional low lying areas have been identified and will be filled in August 2025.

The Deck A sage mitigation has recommenced this summer beginning with weed abatement throughout Deck A. This will then be followed by filling in low lying areas which have been identified in order to prepare the deck for seedling. The soils which will be placed in these low-lying areas will be tested to ensure that they do not have toxic properties, such as high salinity or boron. Further seeding may take place in Q4 of 2025 depending on site priorities and infrastructure needs.

4.4 County Sage Mitigation Area

The County sage mitigation area is located on the western side of the County portion of Sunshine Canyon Landfill (Drawing 1). As noted in the first quarter Rincon County-Side Sage Mitigation Area report the upper half of the mitigation site was burned in the Saddle Ridge fire in October of 2019. No revegetation activities were conducted in this area during the second quarter of 2025, and as noted in multiple Rincon progress reports, the conditions in this mitigation area have remained unchanged for some time. Rincon noted in their attached 2025 second quarter vegetation report that this area remains problematic for establishment of vegetation due to barren soils. However, the southeastern portion of the plot is moderately covered with native and non-native vegetation and some small patches of vegetation have begun to establish a presence in the northern-central area. Soil samples from this location indicate low pH, high salinity, and Boron present in native soils.

5.0 Assessments of Sage Mitigation Areas

Assessments of the site's sage mitigation areas are conducted by a qualified biologist on a quarterly basis. The following sections present a summary of the recommendations for the sage mitigation areas from Rincon (City and County sage mitigation areas) and Architerra (City South Sage Pilot Project Area (Deck C) and Middle Deck (Deck B) and the proposed actions in response to the recommendations.

5.1 Rincon Recommendations for City Sage Mitigation Areas

Rincon's progress reports for the City Sage Mitigation Areas for the second quarter of 2025 are provided in Attachment 1. These reports include recommendations based on the assessments. Table 1 presents a summary of these recommendations and the proposed actions.

- The booster pump and power that was destroyed in the Saddleridge Fire will need to be replaced for irrigation to deck A. Architerra's initial recommendation is to get a team on site to walk the deck and determine best strategy moving forwards to tackle the approximately 25 acres. This has been delayed to late 2026.

Table 1 – Rincon Recommendations and Proposed Actions – City Sage Mitigation Areas, Second Quarter 2025

AREA		RECOMMENDATION	PROPOSED ACTION
Lower, Middle, and Upper Decks (Decks C, B, and A)	1	Weed Control – Implement a year-round weed control program to control non-native species.	A weed control program is already in place on Deck C and B as part of the pilot project and will continue. A weed control program on A will be implemented along with the mitigation plans for these areas.
Lower, Middle Decks (Decks C, B)	2	Irrigation – Reinstall irrigation system if drought conditions continue to the areas to alleviate stress on regrowth	Even with above average rainfall this winter, supplemental irrigation systems may be reinstalled to promote germination and growth of native plants if signs of desiccation appear. We will continue to evaluate and proceed as warranted.
Lower, Middle, and Upper Decks (Decks C, B, and A)	3	Prohibit Access – Continue to prohibit vehicle access to mitigation areas.	Repairs to the T-post fencing will be made as needed.
Upper Deck (Deck A)	3	Improve root zone and soil conditions	This will be addressed when the plans for Deck A is developed. Actions were taken to address improving the root zone in Decks B & C; it is expected that similar actions will be incorporated into the plans for Deck A.

Upper Deck (Deck A)	4	Plant natives in areas dominated with non-natives	This will be addressed when the plans for Deck A are developed. Various planting methods were used for the construction of the pilot project on Decks B & C; it is expected that similar actions will be incorporated into the plans for Deck A.
Upper Deck (Deck A)	5	Reseeding – apply native seeds during the rainy season after soil mounds have been established	Deck A will be regraded in August to fill in any remaining ponding locations. Reseeding might continue into Q4 2025 between December and March.

Rincon also recommended that a monitoring biologist should be present during weed control activities or the native plants should be flagged to ensure only non-native species are removed. A monitoring biologist will be consulted prior to any weed control activities to ensure native plants are protected.

Architerra and Rincon continue to provide support to the Oakridge maintenance personnel to assist in removal of the invasive weeds on both Deck B and C. Architerra has pointed out some of the more aggressive weeds that have flourished since the Saddle Ridge Fire. Architerra provided them with images of the invasive weeds to help identify and target these invasive species. Oakridge Landscape have been diligently removing Russian Thistle, Wild Oat, Shortpod Mustard, Red Brome Grass, False Barley, Tree Tobacco, and Yellow Star Thistle that took hold in the burned barren areas. During May 2023, An Architerra biologist was present during weeding activities to ensure native species are properly identified within the heavily non-native vegetation.

5.2 Rincon Recommendations for County Sage Mitigation Area

Table 2 presents a summary of the recommendations proposed by Rincon based on the assessment of the County Sage Mitigation Area and the proposed actions. Please refer to the full recommendations in the Rincon reports in Attachment 2.

Table 2 – Rincon Recommendations and Proposed Actions – County Sage Mitigation Area, Second Quarter 2025

AREA	RECOMMENDATION	PROPOSED ACTION
------	----------------	-----------------

County Sage Mitigation Area	1	Create benches to control soil erosion and improve soil conditions to improve plant establishment and seed dispersal	Rincon and ADG continue to evaluate recommendations from the County Task Force and UltraSystems.
County Sage Mitigation Area	2	Reseed and plant container plants	A trail test pilot plan will be discussed with California Native shrubs.
County Sage Mitigation Area	3	Use soil amendments	A trial test plot would need to be developed. This recommendation will be considered at a later date.
County Sage Mitigation Area	5	Signage – Install signage indicating revegetation efforts.	Due to the slopes, stormwater channel and overall difficulty to access this area, personnel are limited to access this area.
County Sage Mitigation Area	6	Weed Control – Continue weeding as needed on a quarterly basis.	Personnel continues to evaluate the current status.
County Sage Mitigation Area	7	Prohibit Access – continue to prohibit vehicle access to mitigation deck.	Upper entrance has a locked gate, no further action is required.

5.3 Architerra Inspection for City South Sage Mitigation Pilot Project Area – Second Quarter 2025

The inspection report is included in Attachment 3 along with photos of the area taken at the photo stations.

5.4 Quarterly Assessment of City South Sage Pilot Project Area

The methodology for assessment of the City South Sage Pilot Project Area developed by Rincon (formerly JMA) was included in the first quarter 2015 Vegetation Report. The evaluation report for the second quarter of 2025 based on this methodology is included in Attachment 4 and Attachment 5 for Deck C and Deck B, respectively. Concerns for the county-side stability for soil erosion will be addressed in the coming months. Current plans require the filling in of low lying areas in Deck C and infrastructure repairs from the current and previous rainy seasons.

6.0 Status of Other Vegetated Areas

Big Cone Douglas Fir Tree Mitigation

As reported in the vegetation report for the first quarter of 2015, 200 Big Cone Douglas fir tree saplings were planted the third week of March 2015. These big cone Douglas fir pine trees continue to be monitored and maintenance activities were conducted in this mitigation area for 2022 and into the future.

A meeting with Rincon biologist was conducted on November 18, 2022 at the Big Cone Mitigation area. We will begin to work with local nurseries to help replace and replant some of the existing dead big cone pine and canyon oak. We are also evaluating a new location for planting more big cone pines and canyon oak in this area, and finally to establish healthy big cone pine and canyon oak in a timely established schedule. Plans to replenish the mitigation bank will continue from seed collection in quarter two 2025 and quarter three 2025. Seeds have been collected and stratified, they are currently in the process of being potted. The seeds will be germinate at a nursery for a year. Once saplings are viable, they will be brought to site to be planted in the mitigation area on site. This planting is anticipated the fall of 2026.

PM10 Berm

Republic Services hosted an Adopt-A-Tree event for employees and their family members. On Saturday, November 14th, 2020, at 2:00 pm, Fourteen (14) Coast Live Oak trees were planted in critical areas of the PM10 Berm that was damaged during the Saddleridge Fire. Architerra and JMA (i.e. Rincon) assisted in the planting efforts with their expertise and knowledge of tree growth and ideal planting locations.



Front Entrance Toe Berm

The proposed project involves the development of a landfill termination berm and construction of a roadway. There were 20 coast live oak trees surveyed within the project footprint by Rincon and project leads. One of the oak trees was dead, and all of them would be removed by the project activities. There are currently 48 coast live oak trees in the landfill's mitigation bank. As noted, the 20 coast live oak trees would be removed by the proposed project, therefore at a mitigation ratio of 2:1, a total of 40 coast live oak trees will be deducted from the landfill's oak tree mitigation bank, leaving 4 oak trees remaining in the bank for future removals at the landfill, if needed. A report detailing the survey is located in Attachment 6.

Donation to Local Community

As part of community outreach, a rancher in the area asked if he could plant some oak trees on his ranch nearby, and Sunshine Canyon agreed it would be a great idea. Thereafter on September 9th 2021, twenty-two (22) coast live oaks and two sycamores were donated from the Sunshine Canyon nursery and given to the rancher. The rancher mentioned the oak trees shall provide shade for his livestock and beautify the surrounding private property and was very pleased with the trees.



Please do not hesitate to contact me at (818) 923-4816 if you have any questions.

Regards,

Andrew Asaro

Andrew Asaro

Environmental Specialist

Sunshine Canyon Landfill

Cc: Ms. Dorcas Dee Hanson-Lugo, SCL LEA

Mr. David Thompson, SCL LEA

Ms. Tiffany Butler, City of Los Angeles, Department of City Planning

Ms. Devon Zatorski, City of Los Angeles Department of City Planning

Ms. Ly Lam, City of Los Angeles, Department of City Planning

Mr. Nicholas Hendricks, City of Los Angeles, Department of City Planning

Enrique Casas, Los Angeles Regional Water Quality Control Board

Ms. Maria Masis, County of Los Angeles, Department of Regional Planning

Mr. Wayde Hunter, SCL CAC

Mr. Jim Aidukus, UltraSystems

County DPW Landfill Unit

Attachments

Attachment 1	Rincon Progress Report, 2Q2025 City-Side Sage Mitigation Area
Attachment 2	Rincon Progress Report, 2Q2025 County-Side Sage Mitigation Area
Attachment 3	Architerra Design Group, Field Observation Report, South City Sage Mitigation Pilot Project – 2Q2025 with Photo Log
Attachment 4	Rincon Quarterly Monitoring Report - Coastal Sage Scrub Deck C Pilot Study, 2Q2025
Attachment 5	Rincon Quarterly Monitoring Report - Coastal Sage Scrub Deck B Pilot Study, 2Q2025
Attachment 6	Rincon Sunshine Canyon Landfill Ultimate Entry Improvement Project, Oak Tree Survey Report

Drawing

Drawing 1	Site Vegetation Status and Activity
-----------	-------------------------------------

ATTACHMENT 1



July 16, 2025
Project No: 21-11086

Andrew Asaro
Environmental Specialist
Republic Services
14747 San Fernando Road
Sylmar, California 91342
Via email: AAsaro@republicservices.com

**Subject: Qualitative Monitoring Report for the City-Side Sage Mitigation Area – 2nd Quarter
2025 Sunshine Canyon Landfill, Sylmar, California**

Dear Mr. Asaro,

On June 23, 2025, Rincon Consultants performed the second quarter qualitative monitoring of 2025 for the Republic Services City-Side Sage Mitigation Area. This report qualitatively documents the current conditions of the City-Side Sage Mitigation Area with regards to the Landfill's coastal sage scrub restoration efforts. The City-Side Sage Mitigation Area consists of the Lower Deck, Middle Deck, and Upper Deck (including slope between middle and upper decks), which are discussed in detail below.

General Conditions

Lower Deck

In 2014, the Landfill initiated a pilot study at the Lower Deck (Deck C) to assess three different seeding applications of native species that included hand broadcasting, imprinting, and hydroseeding. Some container plants were also planted at the Lower Deck, but in low quantities. Germination, establishment, and natural recruitment of native plants ensued; however, the Lower Deck and surrounding area burned during the Saddleridge Fire in October 2019. The fire burned a substantial amount of the Lower Deck, scorching some of the vegetation entirely and partially burning some of the vegetation. The fire also burned the irrigation system, and the vegetation has been without supplemental water ever since.

A substantial amount of regrowth has occurred following the fire, including germination from the seed bank in the soil and resprouting of below- and above-ground plant parts. The Lower Deck appears to have fully recovered from the fire. The most prevalent native plant species observed within the Lower Deck in the second quarter of 2025 was California sunflower (*Encelia californica*), followed by big saltbush (*Atriplex lentiformis*), allscale saltbush (*Atriplex polycarpa*), and beardless wild rye (*Elymus triticoides*). Immediately following the Saddleridge Fire, areas that were previously dominated with saltbush species were largely replaced by mats of non-native grasses such as red brome (*Bromus rubens*), ripgut brome (*Bromus diandrus*), foxtail barley (*Hordeum murinum*), and non-native forbs such as redstem filaree (*Erodium cicutarium*). Native shrub species have resprouted and are fully re-established, and have shown signs of continuous growth since the fire. Seedlings of native shrub species have germinated from native seed in the seed bank, indicating that a sustainable shrubland vegetation community has established in the Lower Deck. Due to this increased shrub establishment, non-native forbs have decreased in cover as they have been outcompeted.



Between the first and second quarter of 2025, non-native annual plant species have decreased in abundance as a result of natural annual species lifespan and decreased water availability during the dry, summer season.. Beardless wild rye, a native grass species, has shown recovery from previous weeding activities (i.e., weed whipping) performed by landfill staff in fall 2024. This species is intermixed with non-native forbs and grasses, and is easy to misidentify as a non-native grass species. Exotic annual plant species have already begun seeding in the second quarter of 2025. Non-native plant species cover is anticipated to decrease as summer 2025 continues as a result of natural seasonal progression. The majority of non-native vegetation observed at the Lower Deck in the second quarter of 2025 consisted of non-native annual grasses, short podded sorhde pmustard is sdfk mustard (*Hirschfeldia incana*), red brome, and tocalote (*Centaurea melitensis*).

Middle Deck

In 2019, the Landfill initiated a pilot study at the Middle Deck (Deck B) to assess germination and establishment rates (e.g., percent cover) of soil imprinting and broadcast seeding methods. Some container plants were also planted at the Middle Deck, but in low quantities. Germination and establishment of native plants ensued; however, there was not much evidence of natural recruitment due to the short timeframe from when the deck was seeded to when it burned during the Saddleridge Fire, which also decimated the irrigation system.

Native vegetation observed at the Middle Deck during the second quarter of 2025 consists of woody species such as brittlebush (*Encelia farinosa*), California sunflower (*Encelia californica*), deerweed (*Acmispon glaber*), California buckwheat (*Eriogonum fasciculatum*), California sagebrush (*Artemisia californica*), coastal goldenbush (*Isocoma menziesii*), white sage (*Salvia apiana*), coyote brush (*Baccharis pilularis*), and herbaceous species such as beardless wild rye. Native shrub species diversity in the Middle Deck is generally greater than that observed in the Lower and Upper Decks. Of all the observed native species, brittlebush, coastal goldenbush, California sagebrush, and deerweed (*Acmispon glaber*) are in the greatest abundance. The native shrub species were either in their flowering or vegetative state.

Non-native plants are in moderate abundance throughout the Middle Deck. Dominant not-native plants observed include exotic grasses such as red brome, and forbs such as short podded mustard, tocalote, and small flowered iceplant (*Mesembryanthemum nodiflorum*). These species were observed in their seeding and senesced state during the second quarter of 2025. In general, non-native weed cover is moderate. Small flowered iceplant has decreased in cover between 2024 and 2025. Non-native plants are anticipated to decrease in the late summer months of 2025 as a result of reduced water availability.

Upper Deck

Overall, the Upper Deck (Deck A) continues to be sparsely covered with native vegetation due to compacted and poor soil conditions. However, in the southern-center of the Upper Deck, vegetation cover is higher than in other areas and includes native species such as California buckwheat, as well as non-native species such as red brome, short podded mustard, and Australian saltbush (*Atriplex semibaccata*). The presence of vegetation in the southern-center portion of the Upper Deck generally demonstrates that the soils in this area are suitable for supporting vegetation, both native and exotic. However, the soils elsewhere on the Upper Deck appear to be heavily compacted and gravelly, and vegetation coverage in these areas is sparse. Evidence of previous seeding is no longer discernible within the portions of the Upper Deck where plant establishment is visibly poor.

Non-native herbaceous species that dominate the southern-central portion of the Upper Deck currently include small flowered iceplant, red brome, short podded mustard, and tocalote. California buckwheat



is the most dominant native perennial woody plant species on the Upper Deck, and is currently flowering. However, as described in previous monitoring reports, overall natural recruitment of native plant species within the Upper Deck is low due to poor and dry soil conditions.

Table 1 Summary of Observations in the Lower, Middle, and Upper Decks in Quarter 2, 2025

Location	Native Plant Vegetation				Exotic Plant Vegetation	
	Native Plant Cover	Plant Health Issues	Height of Native Species	Native Species Richness	Exotic Plant Cover	Phenological State
Lower Deck	Moderate-High	Competition from non-native forb species	12-48 inches	Shrubs: Moderate Herbs: Low	Low	Seeding and senesced
Middle Deck	Moderate	Competition from non-native forb species	12-48 inches	Shrubs: Moderate Herbs: Low	Low	Seeding and senesced
Upper Deck	Minimal	Poor soils	12-36 inches	Shrubs: Low Herbs: Low	Low	Seeding and senesced

Recommendations

Lower and Middle Decks

Weed Control

- Implement a year-round weed control program to control non-native species. The weed control program should incorporate both chemical and mechanical control practices and should be initiated in the late winter to early spring prior to seed set, which typically occurs between the months of February and April. This will prevent further dispersal of exotic plants.
- Following weed control, any dead material harboring seeds should be removed to an off-site location to the extent feasible. Dense areas covered with red brome, ripgut brome, foxtail barley, and short podded mustard should be controlled by removing flowers and immature seeds heads before they drop. These areas should be reseeded with native herbaceous species that are known to grow well in the Lower and Middle decks, such as beardless wild rye and yarrow (*Achillea millefolium*).
- A qualified biologist should be present during weed control activities or flag the native plants that should remain prior to weed control activities to ensure only non-native species are removed and to minimize damage to native plant species to the greatest extent feasible. If a contractor is responsible for weed control, the contractor should verify with the Landfill that all personnel are experienced in native and non-native plant identification.
- Weeding is best performed just before, or at the onset of flowering, but before seed set. If seeds are already present, additional care should be taken to remove the plants with the seeds attached, or the seeds should be removed from the plants prior to the plant removal. A consistent weed abatement schedule will reduce the potential for non-natives to set seed. Soil disturbance should be limited by hand weeding, wherever possible, and weeds should be disposed of off-site to avoid any reinfestation through reseeding or from plant propagules. If hand weeding is not possible, the monitoring biologist should be consulted regarding the appropriate method of weed removal. For



example, using mechanical equipment to remove flowers and immature seed heads may be appropriate where dense mats of non-native grasses have established. If there continues to be high incidence of weed infestation, weed control may need to be increased to every four to six weeks. Otherwise, weeds should continue to be monitored and controlled on a quarterly basis.

Irrigation

- The Lower and Middle Decks burned during the Saddleridge Fire in October 2019. The fire burned the irrigation system that was installed prior to the fire, and the vegetation has been without supplemental water ever since. While southern California received above-average rainfall in the winter of 2023 and spring of 2024, it received below average rainfall in the winter of 2024 and spring of 2025. Supplemental irrigation may be necessary if native plants show signs of desiccation stress. If indicators of drought stress are observed, it is recommended that the irrigation system within the Lower and Middle decks are re-installed to promote germination and growth of native plant species.

Prohibit Access

- Continue to prohibit vehicle access to mitigation areas.

Upper Deck

Improve Root Zone and Soil Conditions

- Continue to investigate ways to improve the soil layer to increase the root penetration and saturation zone to enable plant growth in heavily compacted areas. Consider applying soil in random undulations or uneven mounds to improve soil porosity and filtration and to control soluble salts from leaching from existing layer.
- Prior to seeding (broadcast, hydroseeding, or imprinting) of native species, incorporate a soil amendment or mulch with high organic content by tilling it into the top 12 inches of the existing compacted soils to improve soil texture, drainage, porosity, and aerobic conditions. If an organic mulch or soil amendment is not feasible or available, incorporate available soil from borrow sites within the landfill that have the appropriate soil properties, so long as these borrowed soils have been determined to not have toxic conditions, such as boron or high salinity, and lack a non-native seed bank.

Plant Natives in Areas Dominated with Non-Natives

- The vegetated areas on the Upper Deck that are currently dominated with non-native annual species have decent soil-texture conditions. These areas are less compacted than adjacent areas that are gravelly and mostly devoid of vegetation. In general, the soil texture within the vegetated areas with non-native vegetation is friable down to approximately 8-12 inches in depth. Various planting methods (i.e., planting container plants and hydroseeding) may be used to re-establish native plants on the Upper Deck where non-natives currently dominate.

Reseeding

- Following the application of soil mounds as previously described, apply native seed (by means of broadcast seeding, hydroseeding or drilling) during the rainy season, between December and March, or prior to a forecasted rain event.



Weed Control

- Implement a year-round weed control program to control non-native species. The weed control program should incorporate both chemical and mechanical control practices. Following weed control, any dead material harboring seeds should be removed to an off-site location to the extent feasible.



- A qualified biologist should be present during weed control activities or flag the native plants that should remain prior to weed control activities to ensure only non-native species are removed and to minimize damage to native plant species to the greatest extent feasible. A biologist should verify that the weed removal methodology does not encourage re-colonizing of non-native plant species.
- Weeding is best performed just before, or at the onset of flowering, but before seed set. If seeds are already present, additional care should be taken to remove the plants with the seeds attached, or the seeds should be removed from the plants prior to the plant removal. A consistent weed abatement schedule will reduce the potential for non-natives to set seed. Soil disturbance should be limited by hand weeding, wherever possible, and weeds should be disposed of off-site to avoid any reinfestation through reseeding or from plant propagules. If hand weeding is not possible, the monitoring biologist should be consulted regarding the appropriate method of weed removal. For example, using mechanical equipment to remove flowers and immature seed heads may be appropriate where dense mats of non-native grasses have established. If there continues to be high incidence of weed infestation, weed control frequency may need to be increased. Otherwise, weeds should continue to be monitored and controlled on a quarterly basis.

Prohibit Access

- Continue to prohibit vehicle access to mitigation areas.

Thank you for the opportunity to work with you on this important project. Please contact Kyle Gern if you have questions concerning the contents of this report. He may be reached by telephone at 805-844-1492, or by email at kgern@rinconconsultants.com.

Sincerely,
Rincon Consultants, Inc.

A handwritten signature in black ink that reads "Kyle Gern". The signature is stylized, with the first letters of the first and last names being capitalized and prominent.

Kyle Gern
Biologist

Attachments

- | | |
|--------------|-------------------------------|
| Attachment 1 | Figure 1 Photograph Locations |
| Attachment 2 | Site Photographs |

Attachment 1

Figure 1 Photograph Locations

This aerial map displays the Gentili Ranch area in Santa Clarita, California. Seven photo locations are marked with white circles and labeled: Photo 1, Photo 2, Photo 3, Photo 4, Photo 5, Photo 6, and Photo 7. The map shows the winding path of Gentili Ranch Rd and its intersection with San Fernando Rd. Topographic features include rolling hills and valleys. An inset map in the bottom right corner provides a regional context, showing the area's location relative to Los Angeles and Santa Clarita, with major roads like I-5 and SR-14 indicated. A scale bar (0 to 500 feet) and a north arrow are located in the bottom left corner.

Attachment 2

Site Photographs



Photograph 1. Facing west at Lower Deck. View of eastern limits dominated by *Atriplex* spp. and California sunflower (June 23, 2025).



Photograph 2. Lower Deck from western boundary (June 23, 2025).



Photograph 3. Facing east at the Middle Deck from western boundary (June 23, 2025).



Photograph 4. Facing west at the easterly-facing slope located between the Middle and Upper decks. The vegetation on the slopes between the Middle and Upper Deck is dominated by California buckwheat (currently flowering) and non-native annual grasses (June 23, 2025).



Photograph 5. Facing northeast at the Upper Deck. This area is compacted and gravelly and continues to be problematic for supporting vegetation. Non-native annual grasses and forbs, and California buckwheat shrubs are evident in the background (June 23, 2025).



Photograph 6. Facing southwest at the Upper Deck. This area is primarily dominated by California buckwheat, wild oats, brome grasses, and short podded mustard (June 23, 2025).



Photograph 7. Facing southeast at the western portion of the Upper Deck. This area is dominated by short podded mustard, Australian saltbush, and California buckwheat (June 23, 2025).

ATTACHMENT 2



July 16, 2025
Project No: 21-11086

Andrew Asaro
Environmental Specialist
Republic Services
14747 San Fernando Road
Sylmar, California 91342
Via email: AAsaro@republicservices.com

Subject: Qualitative Monitoring Report for the County-Side Sage Mitigation Area – 2nd Quarter 2025 Sunshine Canyon Landfill, Sylmar, California

Dear Mr. Asaro,

On June 23, 2025, Rincon Consultants conducted the second quarter qualitative monitoring of 2025 for the County-Side Sage Mitigation Area (mitigation area). This report documents the current conditions of the mitigation area.

General Conditions

Hydroseeded Areas

Germination and plant growth from hydroseeding that occurred several years ago is not discernible in some portions of the mitigation area. Conditions in the mitigation area have remained relatively unchanged since the first quarter of 2025. Areas that are moderately covered with native and non-native vegetation are concentrated in the southeastern portion of the mitigation area. The northern and upper portions of the mitigation area continue to be bare and problematic for establishment of vegetation, primarily because of highly eroded soils, steep slopes, and boron-toxic soils (see *Recommendations* section). However, there are some small patches of vegetation that have established in the northern-central portion of the mitigation area and include shrubs such as California buckwheat (*Eriogonum fasciculatum*), deerweed (*Acmispon glaber*), and California sagebrush (*Artemisia californica*).

Native plant coverage is similar to the previous quarterly monitoring reports. The southern half of the mitigation area has relatively good coverage of native species, mostly California buckwheat and California sunflower (*Encelia californica*), which were either in their vegetative state or flowering during the second quarter of 2025. Established laurel sumac (*Malosma laurina*) individuals are present as well. The native vegetation coverage is assumed to be a direct result of seeding; however, some natural recruitment of native plant species is apparent based on the various sizes of shrubs and the presence of shrub seedlings in the understory. Due to rocky (hydrophobic) soil conditions, soil erosion and boron-toxic soils on the northern-half and upper portions of the mitigation area, minimal plant growth is present. Due to the lack of plant establishment in these areas, erosional features have become prominent, especially following above-average rainfall events in 2023 and 2024.

Annual non-native grasses and forbs currently dominate the understory and serve as ground cover in most of the vegetated areas. Brome grasses (*Bromus* spp.), wild oats (*Avena fatua*), short podded mustard (*Hirschfeldia incana*), Russian thistle (*Salsola tragus*), and tocalote (*Centaurea melitensis*) are the most dominant non-native species present and comprise approximately 25 to 35 percent of the total cover. California buckwheat dominates the native vegetation coverage with California sagebrush and California sunflower present as co-dominants. Native species comprise approximately



75 to 80 percent of the native vegetation cover in areas where vegetation is present. Other less dominant native species observed include golden bush (*Ericameria linearifolia*), coyote brush (*Baccharis pilularis*), black sage (*Salvia mellifera*), deerweed, and laurel sumac.

Seed Mix Areas

Like the hydroseeded areas, germination and plant growth from the seed mix areas that occurred several years ago is not discernible. As described in previous monitoring reports, a substantial portion of the mitigation area continues to be bare and problematic, which has inhibited the establishment and growth of vegetation. However, in areas where vegetation is present, there is a moderate coverage of native species (e.g., California buckwheat and California sunflower).

As described in the *Hydroseeded Areas* discussion above, a moderate cover of native plants exists within vegetated areas in the southeastern portion of the mitigation area, and annual non-native grasses and forbs currently dominate the understory.

Native Plant Conditions

The plant cover rating indicated below in Table 1 applies where vegetation is dominant in the southeastern portion of the mitigation area. Vegetation cover is moderate in the southeastern portion of the mitigation area and sparse along the upper slopes where rocky and eroded soil conditions occur, and in the northern portion of the mitigation area due to problematic soil conditions. As a result, most of the northern and upper portions of the mitigation area continue to have minimal coverage. Native vegetation coverage is good in vegetated areas and non-native plant cover is relatively low. Bare areas and non-native annual grasses are intermixed; however, as noted the northern and upper areas continue to be mostly bare where erosion and rocks are apparent.

California buckwheat is dominant and California sunflower is sub-dominant. Establishment of vegetation is problematic due to rocky soils with poor soil structure, and boron toxicity has made plant growth (i.e., seed germination and recruitment) difficult. The species richness is low to medium within vegetated areas; however, species richness is considerably low when considering the entire mitigation area.

Exotic Plant Conditions

Annual non-native weed species consist primarily of brome grasses, wild oats, and mustards, which are either flowering or seeding, which aligns with their natural growth. Russian thistle, a mid-season plant species, is currently germinating. Non-native plant cover is anticipated to decrease in the late summer months of 2025 as a result of decreased water availability. Other established weeds that were observed include redstem filaree (*Erodium cicutarium*) and telegraph weed (*Heterotheca grandiflora*; a weedy native plant species).

Table 1 Summary of Native and Exotic Plant Cover in the County-Side Sage Mitigation Area in Quarter 2, 2025

Location	Native Plant Vegetation				Exotic Plant Vegetation	
	Native Plant Cover	Plant Health Issues	Height of Native Species	Native Species Richness	Exotic Plant Cover	Phenological State
County-Side Sage Mitigation Area	Moderate	Poor soils, erosion	12-36 inches	Medium	Moderate	Vegetative and flowering



Recommendations

The following recommendations within the mitigation area are suggested based upon the field survey performed in the second quarter of 2025.

- **Create Benches.** Consider creation of several benches throughout the mitigation area to control soil erosion and to improve soil conditions to improve plant establishment and seed dispersal. This technique has been widely used on steep slopes and in areas where soil erosion is problematic. This technique also allows for opportunities to introduce a high-quality soil layer above the poor soils that exist.
- **Reseed and Plant Container Plants with Irrigation.** If creation of benches is feasible, planting methods should include hydroseeding, broadcast seeding, and/or imprinting no more than 10 days prior to a forecasted rain event, unless an irrigation system is installed. Planting with container plants with supplemental irrigation should also be considered.
- **Use Soil Amendments.** Incorporate a soil amendment or mulch with high organic content in select areas as determined by a restoration specialist.
- **Signage.** Install signs indicating that the area is undergoing revegetation.
- **Weed Control.** Continue weed control program on a quarterly basis.
- **Prohibit Access.** Prohibit equipment access to mitigation area.

Thank you for the opportunity to work with you on this important project. Please contact Kyle Gern if you have questions concerning the contents of this report. He may be reached by telephone at (805) 844-1492, or by email at kgern@rinconconsultants.com.

Sincerely,
Rincon Consultants, Inc.

A handwritten signature in black ink that reads 'Kyle Gern'.

Kyle Gern
Biologist

Attachments

- Attachment 1 Figure 1 Photograph Locations
Attachment 2 Site Photographs

Attachment 1

Figure 1 Photograph Locations

Figure 1 Photograph Locations

Attachment 2

Site Photographs



Photograph 1. Facing southwest at the County-Side Sage Mitigation Area (June 23, 2025).



Photograph 2. Facing northwest at the northern portion of the County-Side Sage Mitigation Area where plant growth has been problematic due to poor soil conditions (June 23, 2025).

ATTACHMENT 3





ARCHITERRA DESIGN GROUP

FIELD OBSERVATION REPORT

DATE OF VISIT:	07/09/25
PROJECT:	Sunshine Canyon Mitigation Sites
PROJECT NUMBER:	1214
PROJECT MANAGER:	Gregg Denson
SITE INSPECTION #:	
PURPOSE OF VISIT:	Review site conditions/Photo Catalog
TIME OF SITE VISIT:	10:00am
WEATHER/TEMPERATURE:	Sunny 85°
ESTIMATED % COMPLETED:	100%
CONFORMANCE WITH SCHEDULE (+, -)	

WORK IN PROGRESS:	Weed abatement / Monitoring Period /Construction Observation
PRESENT ON SITE:	Gregg Denson

A site visit walk and evaluation has been completed to review the Venturan CSS vegetation establishment on the Trial Site (Deck C), Deck B, and Deck A. Additional items noted during the site visit are as follows:

City-Side Sage Mitigation (Trial Site Deck C):

- Weed growth on the deck is minimal with the following species seen throughout: Shortpod Mustard (*Hirschfeldia incana*), Russian Thistle (*Salsola* ssp.), Yellow Star Thistle (*Centaurea solstitialis*), Tree Tobacco (*Nicotiana glauca*), Italian Thistle (*Carduus pycnocephalus*), and Stinkwort (*Dittrichia graveolens*). It has been several months since the last precipitation. California Bush Sunflower (*Encelia californica*), California Sagebrush (*Artemisia californica*), and Deerweed (*Acmispon glaber*) are now beginning to defoliate as part of their summer dormancy response.
- The Venturan CSS species are in all stages of development, from seedlings to established mature shrubs and sub-shrubs. Several of the Saltbush species are flowering and have responded well over the last few years with average to above-average rainfall on the deck.
- Creeping Wild Rye (*Leymus triticoides*) has begun to reestablish where it was previously scalped on the southwest corner of the deck. However, there was evidence of scalping once again on the portion of Creeping Wild Rye on the north side near the access road and gas well. Horse Weed (*Conyza canadensis*) is still actively growing within the scalped area and should be removed before flowering.

- It has been noted and documented over the last few years that Eucalyptus trees have been germinating on the deck. There are at least two well established Eucalyptus that need to be removed to prevent the possibility of overturn and cap damage during high wind events.
- In some sections of the deck, Native VCSS vegetation is growing within the clearance zone of the existing gas wells on site. Republic Services should review to see if vegetation needs to be pruned back in these locations.
- Coast Live Oak Trees (*Quercus agrifolia*) along the PM10 Berm appear healthy. Those lost to the Saddleridge Fire have completely died. Most of these trees were at the southwest end of Deck C.



Sinkwort actively growing on Deck C



Invasive Eucalyptus Tree (*Eucalyptus* sp.) on southeast side of deck approx. 20' tall



Invasive Tree Tobacco (*Nicotiana glauca*)



Scalped Creeping Rye Grass (improper maintenance practice)



Reestablished Creeping Rye Grass left to naturalize (proper maintenance practice)



Mosaic of actively growing Venturan CSS and those going through summer dormancy





Eucalyptus species (to be removed), approximately 15' in height



Close up of ant holes within open areas on Deck C

City-Side Sage Mitigation (Trial Site Deck B):

- Weed growth on Deck B is similar to Deck C: invasive Slenderleaf Iceplant (*Mesembryanthemum nodiflorum*) continues to spread from the south to the north slowly across the deck in the exposed areas where no vegetation cover exists. There are a few locations where Shortpod Mustard (*Hirschfeldia incana*) and Yellow Star Thistle (*Centaurea solstitialis*) are blooming and taking root.
- Large Tamarix and California Pepper Trees have been noted and documented for removal from Deck B but still exist. These trees need to be removed to prevent the possibility of overturn and cap damage during high wind events.
- Deck B is flourishing with a wide range of established shrubs, sub-shrubs and seedlings that are hardening off. Shrub canopies are beginning to close in some areas.



Invasive Shortpod Mustard (*Hirschfeldia incana*) and Yellow Star Thistle (*Centaurea solstitialis*) actively growing near California Buckwheat (*Eriogonum fasciculatum*)



New Venturan CSS species growing within previous barren area on Deck B



Healthy stand of Venturan CSS species growing on Deck B

ARCHITERRA DESIGN GROUP
10221-A TRADEMARK STREET, RANCHO CUCAMONGA, CA 91730
Phone (909) 484-2800, Fax (909) 484-2802



Invasive California Pepper Tree (*Schinus molle*) near helicopter pads that needs to be removed



Menzies Goldenbush (*Isocoma menziesii*) starting its summer blooming period



Deck A graded fill site, predominately covered with invasive weeds



Deck A Venturan CSS intermixed with weeds on south side of the Deck

Signed: Gregg Denson

Date: 7/16/25

DISTRIBUTION

Republic Services



Contractor



Project Manager (Gregg Denson)



Other _____





Photo Station #1 - June 2024 (North)



Photo Station #1 - July 2025 (North)



Photo Station #1 - June 2024 (East)



Photo Station #1 - July 2025 (East)



Photo Station #1 - June 2024 (West)



Photo Station #1 - July 2025 (West)



Photo Station #2 - June 2024 (North)



Photo Station #2 - July 2025 (North)



Photo Station #2 - June 2024 (East)



Photo Station #2 - July 2025 (East)



Photo Station #2 - June 2024 (West)



Photo Station #2 - July 2025 (West)



Photo Station #3 - June 2024 (North)



Photo Station #3 - July 2025 (North)



Photo Station #3 - June 2024 (East)



Photo Station #3 - July 2025 (East)



Photo Station #3 - June 2024 (South)



Photo Station #3 - July 2025 (South)



Photo Station #4 - June 2024 (North)



Photo Station #4 - July 2025 (North)



Photo Station #4 - June 2024 (East)



Photo Station #4 - July 2025 (East)



Photo Station #4 - June 2024 (West)



Photo Station #4 - July 2025 (West)



Photo Station #5 - June 2024 (North)



Photo Station #5 - July 2025 (North)



Photo Station #5 - June 2024 (East)



Photo Station #5 - July 2025 (East)



Photo Station #5 - June 2024 (West)



Photo Station #5 - July 2025 (West)



Photo Station #6 - June 2024 (North)



Photo Station #6 - July 2025 (North)



Photo Station #6 - June 2024 (East)



Photo Station #6 - July 2025 (East)



Photo Station #6 - June 2024 (West)



Photo Station #6 - July 2025 (West)



Photo Station #7 - June 2024 (North)



Photo Station #7 - July 2025 (North)



Photo Station #7 - June 2024 (East)



Photo Station #7 - July 2025 (East)



Photo Station #7 - June 2024 (West)



Photo Station #7 - July 2025 (West)



Photo Station #8 - June 2024 (North)



Photo Station #8 - July 2025 (North)



Photo Station #8 - June 2024 (East)



Photo Station #8 - July 2025 (East)



Photo Station #8 - June 2024 (West)



Photo Station #8 - July 2025 (West)



Photo Station #1 - June 2024 (East)



Photo Station #1 - July 2025 (East)



Photo Station #1 - June 2024 (North)



Photo Station #1 - July 2025 (North)



Photo Station #2 - June 2024 (East)



Photo Station #2 - July 2025 (East)



Photo Station #2 - June 2024 (North)



Photo Station #2 - July 2025 (North)



Photo Station #2 - June 2024 (South)



Photo Station #2 - July 2025 (South)



Photo Station #3 - June 2024 (East)



Photo Station #3 - July 2025 (East)



Photo Station #3 - June 2024 (North)



Photo Station #3 - July 2025 (North)



Photo Station #3 - June 2024 (West)



Photo Station #3 - July 2025 (West)



Photo Station #4 - June 2024 (South)



Photo Station #4 - July 2025 (South)



Photo Station #4 - June 2024 (East)



Photo Station #4 - July 2025 (East)



Photo Station #4 - June 2024 (West)



Photo Station #4 - July 2025 (West)



Photo Station #5 - June 2024 (East)



Photo Station #5 - July 2025 (East)



Photo Station #5 - June 2024 (North)



Photo Station #5 - July 2025 (East)



Photo Station #5 - June 2024 (West)



Photo Station #5 - July 2025 (West)



Photo Station #6 - June 2024 (East)



Photo Station #6 - July 2025 (East)



Photo Station #6 - June 2024 (North)



Photo Station #6 - July 2025 (North)



Photo Station #6 - June 2024 (West)



Photo Station #6 - July 2025 (West)



Photo Station #7 - June 2024 (East)



Photo Station #7 - July 2025 (East)



Photo Station #7 - June 2024 (West)



Photo Station #7 - July 2025 (West)



Photo Station #7 - June 2024 (North)



Photo Station #7 - July 2025 (North)



Photo Station #8 - June 2024 (East)



Photo Station #8 - July 2025 (East)



Photo Station #8 - June 2024 (North)



Photo Station #8 - July 2025 (North)



Photo Station #8 - June 2024 (West)



Photo Station #8 - July 2025 (West)



Photo Station #9 - June 2024 (East)



Photo Station #9 - July 2025 (East)



Photo Station #9 - June 2024 (North)



Photo Station #9 - July 2025 (North)



Photo Station #9 - June 2024 (West)



Photo Station #9 - July 2025 (West)

ATTACHMENT 4



July 16, 2025
Project No: 21-11086

Andrew Asaro
Environmental Specialist
Republic Services
14747 San Fernando Road
Sylmar, California 91342
Via email: AAsaro@republicservices.com

**Subject: Coastal Sage Scrub City South C Trial Plot 2nd Quarter 2025 Monitoring Report,
Sunshine Canyon Landfill**

Dear Mr. Asaro,

This monitoring report has been prepared by Rincon Consultants (Rincon) to inform Republic Services on the status of coastal sage scrub restoration at the Sunshine Canyon Landfill located at 14747 San Fernando Road, Sylmar, California 91342. Specifically, this report serves to document the abundance of vegetation at the Coastal Sage Scrub City South C Trial Plot in the second quarter of 2025.

Methods

On June 23, 2025, Rincon monitored the Coastal Sage Scrub City South C Trial Plot (trial plot) at the Sunshine Canyon Landfill, which constitutes the second quarter of monitoring for 2025. The sample methodology generally followed the *Methodology for Monitoring Percent Cover and Species Richness within Each Seeded Application Method on the Coastal Sage Scrub Pilot Project at the Sunshine Canyon Landfill* (JMA, April 23, 2014). Quadrat sampling of the Coastal Sage Scrub City South C Trial Plot consists of four 50-meter squared quadrats that are randomly sampled within each of the following three seeded areas: hydroseed, imprint, and hand broadcast. The 12 quadrats sampled were randomly selected prior to the first initial monitoring event from a grid that was placed over the entire trial plot, and each quadrat was given a letter (A-L) and delineated in the field with wooden stakes (Attachment 1).

As shown in Attachment 1, three different seeding methods were used as follows:

- Hydroseed (Quadrats A, B, C, and D)
- Imprint (Quadrats E, F, G, and H)
- Hand broadcast (Quadrats I, J, K, and L)

Absolute Cover

The following qualitative data was collected in each quadrat to determine the absolute cover of native and non-native herbaceous and woody species:

- **Percent basal cover (shrubs).** Visual estimate of the amount of basal cover within each quadrat for all shrub species.
- **Percent basal cover (herbs).** Visual estimate of the amount of basal cover within each quadrat for all herb species.



- **Percent bare ground.** Visual estimate of the amount of available bare ground with no vegetation, but suitable for plant growth.
- **Percent rock or other.** Visual estimate of the amount of unavailable ground for supporting plant growth. Inhibitors generally included rocks and boulders, irrigation lines and valve boxes, and mulch.
- **Percent canopy.** Visual estimate of the percent canopy of each shrub and herbaceous species.
- **Photographs.** A photograph was taken from the southwest corner (facing northeast) of each quadrat.

Percent Cover

The following quantitative data was collected in each quadrat to determine the percent cover of native and non-native species.

- **Point intercept method.** Sampling began at the southwest corner of each quadrat and continued around the quadrat in a clockwise direction. The species located precisely at every meter point was tallied, including areas of bare ground, rock and other.

Field Results

Below are the average data collected for each planting method.

Absolute Cover (Qualitative)

Hydroseed – Quadrats A, B, C, and D (average)

- Percent basal cover (shrubs) – 19%
- Percent basal cover (herbs) – 9%
- Percent bare ground – 20%
- Percent rock or other – 1%
- Percent canopy (shrubs) – 67%
- Percent canopy (herbs) – 12%

Imprint – Quadrats E, F, G, and H (average)

- Percent basal cover (shrubs) – 21%
- Percent basal cover (herbs) – 1%
- Percent bare ground – 20%
- Percent rock or other – 0%
- Percent canopy (shrubs) – 78%
- Percent canopy (herbs) – 2%

Hand broadcast – Quadrats I, J, K, and L (average)

- Percent basal cover (shrubs) – 13%
- Percent basal cover (herbs) – 15%



- Percent bare ground – 27%
- Percent rock or other – 0%
- Percent canopy (shrubs) – 48%
- Percent canopy (herbs) – 25%

Percent Cover (Quantitative)

The representation of each species within a quadrat was estimated by broad cover classes (<1%, 1-5%, 5-25%, 25-50%, 50-75%, and >75%). The percent cover of each species based upon the point intercept method is presented in Table 1 through Table 3.



Table 1 Hydroseed – Quadrats A, B, C, and D (Average)

Species	Plot A		Plot B		Plot C		Plot D	
	Number of Hits	Percent Cover	Number of Hits	Percent Cover	Number of Hits	Percent Cover	Number of Hits	Percent Cover
Native Shrubs								
<i>Acmispon glaber</i>								
<i>Artemisia californica</i>					1	2%		
<i>Atriplex canescens</i>	4	8%	8	16%	7	14%		
<i>Atriplex lentiformis</i>	9	18%	7	14%	11	22%	17	34%
<i>Atriplex polycarpa</i>			6	12%	2	4%		
<i>Atriplex spinosa</i>								
<i>Diplacus aurantiacus</i>								
<i>Encelia californica</i>	21	42%	18	36%	18	36%	24	48%
<i>Salvia apiana</i>								
<i>Salvia mellifera</i>			2	4%				
Native Herbs								
<i>Achillea millefolium</i>								
<i>Cryptantha intermedia</i>								
<i>Helianthus annuus</i>							3	6%
<i>Elymus triticoides</i>								
<i>Trichostema lanceolatum</i>			3	6%				
Non-Native Herbs								
<i>Carduus pycnocephalus</i>								
<i>Centaurea melitensis</i>			2	4%	6	12%		
<i>Dittrichia graveolens</i>								
<i>Elymus hispidus</i>			7	14%				
<i>Hirschfeldia incana</i>	3	6%	4	8%	1	2%	3	6%
<i>Pseudognaphalium luteoalbum</i>								
<i>Sonchus oleraceus</i>								
<i>Salsola tragus</i>								
Bare ground	13	26%	1	2%	4	8%	3	6%
		Plot A		Plot B		Plot C		Plot D
Percent Cover Native Shrub		68%		66%		78%		82%
Percent Cover Native Herb		0%		6%		0%		6%
Percent Cover Non-Native Shrub		0%		0%		0%		0%
Percent Cover Non-Native Herb		6%		26%		14%		6%
Percent Bare Ground		26%		2%		8%		6%
								A,B,C,D Percent Cover
								74%
								3%
								0%
								13%
								11%



Table 2 Imprint – Quadrats E, F, G, and H (Average)

Species	Plot E		Plot F		Plot G		Plot H	
	Number of Hits	Percent Cover	Number of Hits	Percent Cover	Number of Hits	Percent Cover	Number of Hits	Percent Cover
Native Shrubs								
<i>Acmispon glaber</i>								
<i>Artemisia californica</i>	2	4%					2	4%
<i>Atriplex canescens</i>	2	4%	4	8%	2	4%	6	12%
<i>Atriplex lentiformis</i>			11	22%	9	18%		
<i>Atriplex polycarpa</i>			4	8%			4	8%
<i>Atriplex spinosa</i>								
<i>Baccharis pilularis</i>								
<i>Diplacus aurantiacus</i>								
<i>Encelia californica</i>	39	78%	18	36%	28	56%	30	60%
<i>Salvia leucophylla</i>								
<i>Salvia mellifera</i>							1	2%
Native Herbs								
<i>Achillea millefolium</i>								
<i>Cryptantha intermedia</i>								
<i>Helianthus annuus</i>								
<i>Elymus triticoides</i>								
<i>Nasella pulchra</i>								
<i>Sisyrinchium bellum</i>								
<i>Vulpia microstachys</i>								
Non-Native Herbs								
<i>Bromus rubens</i>								
<i>Centaurea melitensis</i>								
<i>Echinochloa crus-galli</i>								
<i>Erigeron canadensis</i>								
<i>Erodium cicutarium</i>								
<i>Hirschfeldia incana</i>	1	6%	4	8%	1	2%		
<i>Hordeum murinum</i>								
<i>Salsola tragus</i>								
Bare ground	6	12%	9	18%	10	20%	7	14%
	Plot E		Plot F		Plot G		Plot H	
Percent Cover Native Shrub	86%		74%		78%		86%	
Percent Cover Native Herb	0%		0%		0%		0%	
Percent Cover Non-Native Shrub	0%		0%		0%		0%	
Percent Cover Non-Native Herb	2%		8%		2%		0%	
Percent Bare Ground	12%		18%		20%		14%	



Table 3 Hand Broadcast – Quadrats I, J, K, and L (Average)

Species	Plot I		Plot J		Plot K		Plot L	
	Number of Hits	Percent Cover	Number of Hits	Percent Cover	Number of Hits	Percent Cover	Number of Hits	Percent Cover
Native Shrubs								
<i>Acmispon glaber</i>								
<i>Artemisia californica</i>			4	8%				
<i>Atriplex canescens</i>							10	20%
<i>Atriplex lentiformis</i>	4	8%	12	24%				
<i>Atriplex polycarpa</i>								
<i>Atriplex spinosa</i>								
<i>Baccharis pilularis</i>							4	8%
<i>Diplacus aurantiacus</i>								
<i>Encelia californica</i>	37	74%	17	34%	1	2%	18	36%
Non-Native Shrubs								
<i>Atriplex semibaccata</i>								
Native Herbs								
<i>Achillia millefoluim</i>								
<i>Cryptantha intermedia</i>								
<i>Helianthus annuus</i>								
<i>Elymus triticoides</i>					24	48%	3	6%
<i>Nasella pulchra</i>								
<i>Sisyrinchium bellum</i>								
<i>Trichostema lanceolatum</i>			3	6%				
Non-Native Herbs								
<i>Avena barbata</i>								
<i>Carduus pycnocephalus</i>								
<i>Centaurea melitensis</i>					2	4%	2	4%
<i>Dittrichia graveolens</i>								
<i>Erodium cicutarium</i>								
<i>Hirschfeldia incana</i>	1	2%	12	24%	9	18%	3	6%
<i>Hordeum murinum</i>								
<i>Sonchus oleraceus</i>								
Bare ground	8	16%	2	4%	14	28%	10	20%
	Plot I		Plot J		Plot K		Plot L	
Percent Cover Native Shrub	82%		66%		2%		64%	
Percent Cover Native Herb	0%		6%		48%		6%	
Percent Cover Non-Native Shrub	0%		0%		0%		0%	
Percent Cover Non-Native Herb	2%		24%		22%		10%	
Percent Bare Ground	16%		4%		28%		20%	

Discussion

Table 4 provides a summary of the vegetation cover of shrubs and herbs, including areas of bare ground. The percent cover of native and non-native species is summarized in Tables 1-3.

Table 4 Summary of Vegetation Cover for Each Planting Method at the Coastal Sage Scrub City South C Trial Plot

	Hydroseed (Quadrats A, B, C, and D)		Imprint (Quadrats E, F, G, and H)		Hand Broadcast (Quadrats I, J, K, and L)	
	Qualitative	Quantitative	Qualitative	Quantitative	Qualitative	Quantitative
Percent Cover Shrub	67%	74%	78%	81%	48%	54%
Percent Cover Herb	12%	8%	2%	3%	25%	15%
Percent Bare Ground	20%	11%	20%	16%	27%	17%

Native shrub species account for a majority of the vegetative cover in Trial Plot C. Shrub species observed in Trial Plot C include fourwing saltbush (*Atriplex canescens*), allscale saltbush (*Atriplex polycarpa*), big saltbush (*Atriplex lentiformis*), coyote brush (*Baccharis pilularis*), California sunflower (*Encelia californica*), California sagebrush (*Artemisia californica*), and black sage (*Salvia mellifera*). California sunflower was the most dominant shrub species across all treatment areas.

The quantitative percent cover of native shrub species currently has an average of 74 percent within the hydroseed quadrats, 81 percent within the imprint quadrats, and 54 percent within the hand broadcast quadrats (Tables 1-3). Native shrub quantitative percent cover has not substantially changed within the hand broadcast treatment type and has slightly increased across all other treatment types between the first and second quarter of 2025. Most shrub species within the trial plot were dormant or vegetative during the second quarter of 2025. Beardless wild rye (*Elymus triticoides*), a native grass species that was trimmed during weed management efforts in 2024, continues to be re-growing and has increased in percent cover since the management effort.

Non-native plant cover has decreased within the trial plot between the first and second quarter of 2025. The most prominent non-native plant species observed in the second quarter of 2025 was short podded mustard (*Hirschfeldia incana*). The majority of the mid- to late- season non-native plant species have not yet germinated. Early-season non-native plant species cover is expected to continue to decrease throughout the summer of 2025 as a result of decreased water availability as the dry season continues. Total non-native herbaceous cover currently has an average of 13 percent within the hydroseed quadrats (down from 19 percent in the first quarter of 2025), 3 percent within the imprint quadrats (down from 11 percent in the first quarter of 2025), and 15 percent (down from 25 percent in the first quarter of 2025) within the hand broadcast quadrats (Tables 1-3).

Recommendations

Successional Growth and Weed Control

Wildfires in Southern California have become more common in recent years and have impacted the native landscape, including established restoration sites. Non-native weed control is essential in establishing post-fire restoration sites and is recommended by such organizations as the California Department of Fish and Wildlife Service and the California Society of Ecological Restoration. Successional regrowth of herbaceous non-native species is to be expected within the first two to three years following a wildfire, which is currently being observed at the trial plot. Native shrubs are expected



to recover over a longer period through germination of existing seed within the topsoil and basal growth from charred plants. Native shrubs have shown notable growth following the fire and appear to be well established in the trial plot.

Successional growth of herbaceous species is also important, as native herbaceous species provide natural erosion of topsoil. To control the spread non-native herbaceous species such as tocalote, red brome, and short podded mustard, and minimize competition with native herbaceous and woody species for water, nutrients, and sunlight, weed maintenance should occur no less than every four months, and special attention should be afforded to minimizing impacts to native grasses that may appear to be non-native (i.e., beardless wild rye), native seedlings, and native shrub resprouts. Weed maintenance should be scheduled to maximize removal of non-native species prior to seed set, which typically occurs in spring between the months of February and April, but may also occur throughout the growing season based upon precipitation events.

Supplemental Irrigation

While Southern California received above-average rainfall in the winter of 2023 and spring of 2024, it received below average rainfall in the winter of 2024 and spring of 2025. Supplemental irrigation is a valuable restoration technique to promote re-establishment of native vegetation, particularly during the dry months of the year (i.e., summer and fall). If native herbaceous vegetation continues to be sparse throughout the trial plot, and/or if native shrubs senesce or show indicators of drought stress, the irrigation system within the trial plot should be re-installed to increase water availability and promote seed germination and re-establishment of native vegetation.

Thank you for the opportunity to work with you on this important project. Please contact Kyle Gern if you have questions concerning the contents of this report. He may be reached by telephone at (805) 844-1492, or by email at kgern@rinconconsultants.com.

Sincerely,

Rincon Consultants, Inc.

A handwritten signature in black ink that reads "Kyle Gern". The signature is stylized with a large "K" and a cursive "Gern".

Kyle Gern
Biologist

Attachments

- Attachment 1 Deck C Revegetation Area Quadrat Layout and Planting Plan
- Attachment 2 Representative Site Photographs



References

John Minch and Associates, Inc. (JMA). 2014. Methodology for Monitoring Percent Cover and Species Richness within Each Seeded Application Method on the Coastal Sage Scrub Pilot Project at the Sunshine Canyon Landfill.

Attachment 1

Deck C Revegetation Area Quadrat Layout and Planting Plan

Deck C Revegetation Area Quadrat Layout and Planting Plan

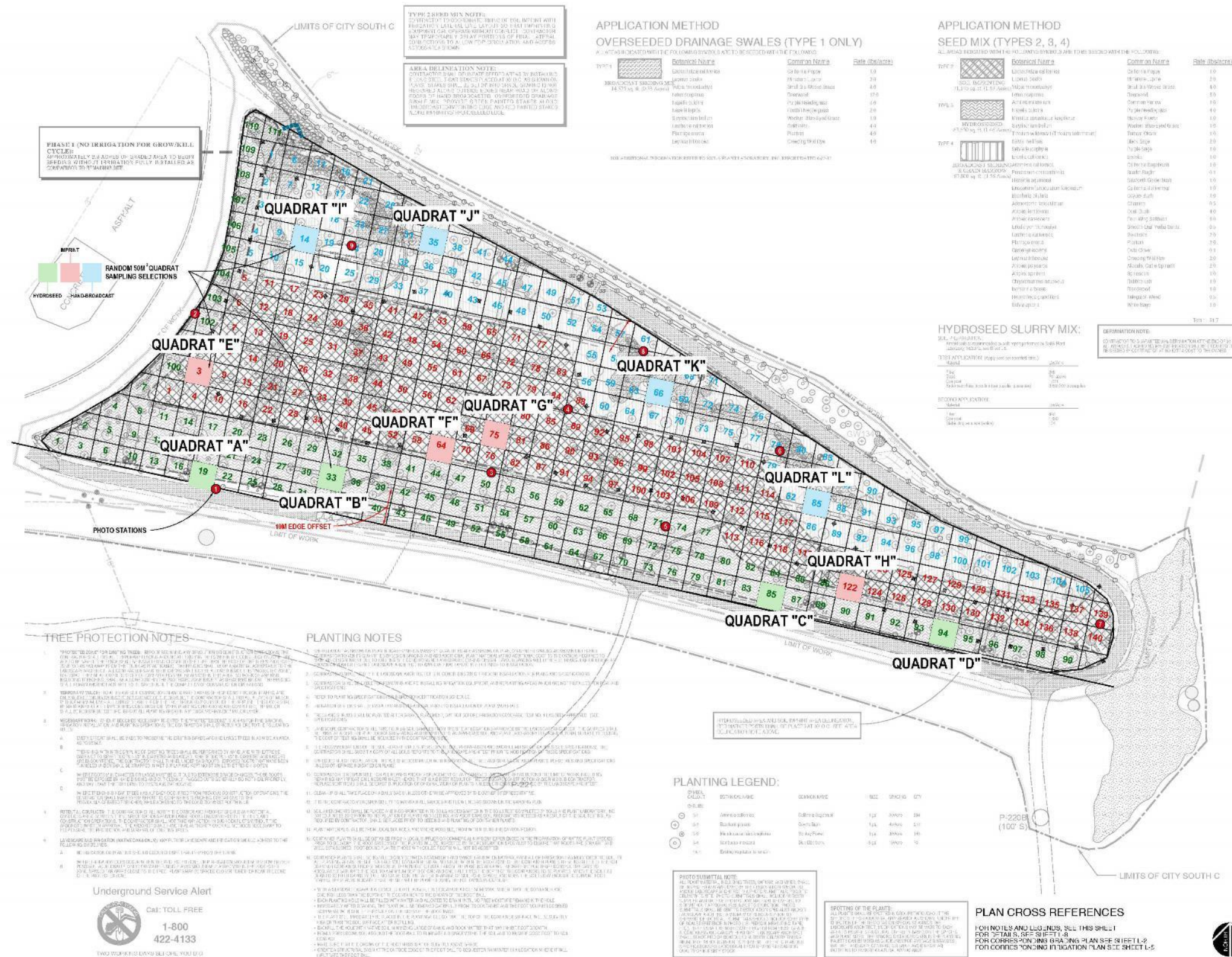

ARCHTERRA
DESIGN GROUP

LANDSCAPE
ARCHITECTURE
SITE PLANNING

10381-A Trademark Street
Irvine, CA 92714
(949) 454-8300
Fax: (949) 454-8028

 **SEATTLE**
LANDSCAPE ARCHITECT
LICENSED PROFESSIONAL

L.A. SEAL

 **SEATTLE**
LANDSCAPE ARCHITECT
LICENSED PROFESSIONAL

PROJECT / CLIENT

CITY SOUTH CTRIAL PLOT
SUNSHINE CANYON LANDFILL
14747 SAN FERNANDO ROAD
SYLMAR, CA 91342

SHEET TITLE

PLANTING PLAN

REVISIONS
△
△
△
△
△
△

DRAWN BY
GIP SUGG

CHECKED BY
JHC

DATE 3/29/12

SCALE

1" = 32'

JOB NUMBER

SHEET NUMBER

L-7
7 月 8 日 14

Attachment 2

Photographs of Sample Plots



Photograph 1. Quadrat A facing northeast from southwest corner (June 23, 2025).



Photograph 2. Quadrat B facing northeast from southwest corner (June 23, 2025).



Photograph 3. Quadrat C facing northeast from southwest corner (June 23, 2025).



Photograph 4. Quadrat D facing northeast from southwest corner (June 23, 2025).



Photograph 5. Quadrat E facing northeast from southwest corner (June 23, 2025).



Photograph 6. Quadrat F facing northeast from southwest corner (June 23, 2025).



Photograph 7. Quadrat G facing northeast from southwest corner (June 23, 2025).



Photograph 8. Quadrat H facing northeast from southwest corner (June 23, 2025).



Photograph 9. Quadrat I facing northeast from southwest corner (June 23, 2025).



Photograph 10. Quadrat J facing northeast from southwest corner (June 23, 2025).



Photograph 11. Quadrat K facing northeast from southwest corner (June 23, 2025).



Photograph 12. Quadrat L facing northeast from southwest corner (June 23, 2025).

ATTACHMENT 5



July 16, 2025
Project No: 21-11086

Andrew Asaro
Environmental Specialist
Republic Services
14747 San Fernando Road
Sylmar, California 91342
Via email: AAasaro@republicservices.com

**Subject: Coastal Sage Scrub City South B Trial Plot 2nd Quarter 2025 Monitoring Report,
Sunshine Canyon Landfill**

Dear Mr. Asaro,

This monitoring report has been prepared by Rincon Consultants (Rincon) to inform Republic Services on the status of coastal sage scrub restoration at the Sunshine Canyon Landfill located at 14747 San Fernando Road, Sylmar, California 91342. Specifically, this letter report serves to document the abundance of vegetation at the Coastal Sage Scrub City South B Trial Plot in the second quarter of 2025.

Methods

On June 23, 2025, Rincon monitored the Coastal Sage Scrub City South B Trial Plot (trial plot) at the Sunshine Canyon Landfill, which constitutes the second quarter of monitoring for 2025. The sample methodology generally followed the *Methodology for Monitoring Percent Cover and Species Richness within Each Seeded Application Method on the Coastal Sage Scrub Pilot Project at the Sunshine Canyon Landfill* (JMA, April 23, 2014). Quadrat sampling of the revegetation area consists of nine 50-meter square quadrats that are randomly located throughout the revegetation area. The quadrats were randomly selected prior to the first initial monitoring event from a grid that was placed over the entire trial plot, and each quadrat was given a letter (A-I) and delineated in the field with wooden stakes. As shown in Attachment 1, five different planting methods were used as follows:

- Soil imprinting with hand broadcast overseeded drainage swales (Quadrats A and G)
- Soil imprinting (Quadrats B, F, and H)
- Broadcast seeding (Quadrat C)
- Broadcast seeding with soil imprinting (Quadrats D and I)
- Soil imprinting and hand broadcast (Quadrat E)

Absolute Cover

The following qualitative data was collected in each quadrat to determine the absolute cover of native and non-native herbaceous and woody species:

- **Percent basal cover (shrubs).** Visual estimate of the amount of basal cover within each quadrat for all shrub species.
- **Percent basal cover (herbs).** Visual estimate of the amount of basal cover within each quadrat for all herbaceous species.



- **Percent bare ground.** Visual estimate of the amount of available bare ground with no vegetation.
- **Percent rock or other.** Visual estimate of the amount of unavailable ground for supporting plant growth. Inhibitors generally included rocks and boulders, irrigation lines and valve boxes, and mulch.
- **Percent canopy.** Visual estimate of the percent canopy of each shrub and herbaceous species.
- **Photographs.** A photograph was taken from the southwest corner (facing northeast) of each quadrat.

Percent Cover

The following quantitative data was collected in each quadrat to determine the percent cover of native and non-native species.

- **Point intercept method.** Sampling began at the southwest corner of each quadrat and continued around the quadrat in a clockwise direction. The species located precisely at every meter point was tallied, including areas of bare ground, rock and other.

Field Results

Below are the average data collected for each planting method.

Absolute Cover (Qualitative)

Soil imprinting with hand broadcast overseeded drainage swales – Quadrats A and G (average)

- Percent basal cover (shrubs) – 4%
- Percent basal cover (herbs) – 10%
- Percent bare ground – 46%
- Percent rock or other – 0%
- Percent canopy (shrubs) – 22%
- Percent canopy (herbs) – 33%

Soil imprinting – Quadrats B, F, and H (average)

- Percent basal cover (shrubs) – 13%
- Percent basal cover (herbs) – 4%
- Percent bare ground – 43%
- Percent rock or other – 0%
- Percent canopy (shrubs) – 43%
- Percent canopy (herbs) – 14%

Broadcast seeding – Quadrat C

- Percent basal cover (shrubs) – 4%
- Percent basal cover (herbs) – 5%



- Percent bare ground – 75%
- Percent rock or other – 0%
- Percent canopy (shrubs) – 12%
- Percent canopy (herbs) – 13%

Broadcast seeding with soil imprinting – Quadrats D and I (average)

- Percent basal cover (shrubs) – 4%
- Percent basal cover (herbs) – 4%
- Percent bare ground – 57%
- Percent rock or other – 0%
- Percent canopy (shrubs) – 29%
- Percent canopy (herbs) – 14%

Soil Imprinting and hand broadcast – Quadrat E

- Percent basal cover (shrubs) – 7%
- Percent basal cover (herbs) – 1%
- Percent bare ground – 54%
- Percent rock or other – 0%
- Percent canopy (shrubs) – 42%
- Percent canopy (herbs) – 4%

Percent Cover (Quantitative)

The representation of each species within each quadrat was estimated by broad cover classes (<1%, 1-5%, 5-25%, 25-50%, 50-75%, and >75%). The percent cover of each species based upon the point intercept method is presented in Table 1 through Table 5 below.



Table 1 Soil Imprinting with Hand Broadcast Overseeded Drainage Swales – Quadrats A and G (Average)

Species	Quadrat A		Quadrat G	
	Number of Hits	Percent Cover	Number of Hits	Percent Cover
Native Shrubs				
<i>Acmispon glaber</i>				
<i>Artemisia californica</i>				
<i>Atriplex canescens</i>			9	18%
<i>Atriplex lentiformis</i>			14	28%
<i>Atriplex polycarpa</i>			2	4%
<i>Atriplex spinosa</i>				
<i>Baccharis pilularis</i>				
<i>Baccharis salicifolia</i>				
<i>Eriodictyon trichocalyx</i>				
<i>Salvia apiana</i>				
<i>Salvia mellifera</i>				
Non-Native Shrubs				
<i>Atriplex semibaccata</i>				
Native Herbs				
<i>Achillea millefolium</i>				
<i>Eschscholzia californica</i>				
<i>Elymus triticoides</i>				
<i>Nasella pulchra</i>				
<i>Sisyrinchium bellum</i>				
Non-Native Herbs				
<i>Centaurea melitensis</i>	14	28%	1	2%
<i>Erodium cicutarium</i>				
<i>Hirschfeldia incana</i>	8	16%	8	16%
<i>Hordeum murinum</i>				
<i>Salsola tragus</i>				
Bare ground	28	56%	13	26%
	Quadrat A		Quadrat G	
Percent Cover Native Shrub	0%		50%	
Percent Cover Native Herb	0%		6%	
Percent Cover Non-Native Shrub	0%		0%	
Percent Cover Non-Native Herb	44%		18%	
Percent Bare Ground	56%		26%	
			A and G (% Cover)	
			25%	
			3%	
			0%	
			31%	
			41%	

Table 2 Soil Imprinting – Quadrats B, F, and H (Average)

Species	Quadrat B		Quadrat F		Quadrat H	
	Number of Hits	Percent Cover	Number of Hits	Percent Cover	Number of Hits	Percent Cover
Native Shrubs						
<i>Acmispon glaber</i>						
<i>Artemisia californica</i>	1	2%			1	2%
<i>Atriplex canescens</i>					2	4%
<i>Atriplex lentiformis</i>			6	12%	4	8%
<i>Atriplex polycarpa</i>						
<i>Baccharis salicifolia</i>	2	4%				
<i>Baccharis sarothroides</i>	11	22%				
<i>Baccharis pularis</i>	8	16%	1	2%		
<i>Encelia californica</i>						
<i>Encelia farinosa</i>	2	4%				
<i>Ericameria parishii</i>	5	10%				
<i>Eriogonum fasciculatum</i>	5	10%	9	18%	6	12%
<i>Hesperoyucca whipplei</i>						
<i>Isocoma menziesii</i>	1	2%			1	2%
<i>Opuntia littoralis</i>						
<i>Salvia leucophylla</i>	2	4%				
<i>Salvia mellifera</i>	2	4%				
<i>Sambucus mexicana</i>						
Non-Native Shrubs						
<i>Atriplex semibaccata</i>						
Native Herbs						
<i>Elymus triticoides</i>						
Non-Native Herbs						
<i>Bromus diandrus</i>						
<i>Bromus rubens</i>			13	26%	2	4%
<i>Centaurea melitensis</i>	1	2%	2	4%	1	2%
<i>Festuca myuros</i>						
<i>Hirschfeldia incana</i>					2	4%
<i>Mesembryanthemum nodiflorum</i>			8	16%		
Bare ground	10	20%	11	22%	31	62%
	Quadrat B		Quadrat F		Quadrat H	
Percent Cover Native Shrub	78%		32%		28%	
Percent Cover Native Herb	0%		0%		0%	
Percent Cover Non-Native Shrub	0%		0%		0%	
Percent Cover Non-Native Herb	2%		46%		10%	
Percent Bare Ground	20%		22%		62%	
					B, F, H (% cover)	
Percent Cover Native Shrub	78%		32%		28%	
Percent Cover Native Herb	0%		0%		0%	
Percent Cover Non-Native Shrub	0%		0%		0%	
Percent Cover Non-Native Herb	2%		46%		10%	
Percent Bare Ground	20%		22%		62%	



Table 3 Broadcast Seeding – Quadrat C

Species	Quadrat C	
	Number of Hits	Percent Cover
Native Shrubs		
<i>Acmispon glaber</i>		
<i>Artemisia californica</i>		
<i>Atriplex lentiformis</i>	8	16%
<i>Atriplex polycarpa</i>		
<i>Atriplex spinosa</i>		
<i>Baccharis pilularis</i>		
<i>Encelia californica</i>		
<i>Encelia farinosa</i>	1	2%
<i>Eriogonum fasciculatum</i>		
<i>Lepidospartum squamatum</i>		
<i>Salvia apiana</i>		
Native Herbs		
<i>Achillea millefolium</i>		
<i>Eschscholzia californica</i>		
<i>Elymus triticoides</i>		
<i>Nasella pulchra</i>		
<i>Sisyrinchium bellum</i>		
<i>Vulpia microstachys</i>		
Non-Native Herbs		
<i>Bromus rubens</i>		
<i>Centaurea melitensis</i>		
<i>Centaurea solstitialis</i>		
<i>Festuca myuros</i>		
<i>Hirschfeldia incana</i>		
<i>Hordeum vulgare</i>		
<i>Mesembryanthemum nodiflorum</i>	7	14%
Bare ground	34	68%
Quadrat C (% cover)		
Percent Cover Native Shrub	18%	
Percent Cover Native Herb	0%	
Percent Cover Non-Native Shrub	0%	
Percent Cover Non-Native Herb	14%	
Percent Bare Ground	68%	



Table 4 Broadcast Seeding with Soil Imprinting – Quadrats D and I (Average)

Species	Quadrat D		Quadrat I	
	Number of Hits	Percent Cover	Number of Hits	Percent Cover
Native Shrubs				
<i>Acmispon glaber</i>				
<i>Artemisia californica</i>				
<i>Atriplex canescens</i>			8	16%
<i>Atriplex lentiformis</i>			2	4%
<i>Atriplex polycarpa</i>				
<i>Encelia farinosa</i>	2	4%		
<i>Eriogonum fasciculatum</i>	12	24%	3	6%
<i>Isocoma menziesii</i>			2	4%
Non-Native Shrubs				
<i>Atriplex semibaccata</i>				
Native Herbs				
<i>Achillea millefolium</i>				
<i>Descurainia pinnata</i>				
<i>Elymus triticoides</i>			2	4%
<i>Nasella pulchra</i>				
<i>Sisyrinchium bellum</i>				
<i>Vulpia microstachys</i>				
Non-Native Herbs				
<i>Avena barbata</i>				
<i>Bromus diandrus</i>				
<i>Bromus rubens</i>			1	2%
<i>Centaurea melitensis</i>			9	18%
<i>Centaurea solstitialis</i>				
<i>Festuca myuros</i>				
<i>Hirschfeldia incana</i>	4	8%	2	4%
<i>Hordeum murinum</i>				
<i>Mesembryanthemum nodiflorum</i>			1	2%
<i>Polygonum aviculare</i>				
<i>Salsola tragus</i>				
Bare ground	32	64%	20	40%
	Quadrat D		Quadrat I	D and I (% cover)
Percent Cover Native Shrub	28%		14%	21%
Percent Cover Native Herb	0%		4%	2%
Percent Cover Non-Native Shrub	0%		16%	8%
Percent Cover Non-Native Herb	8%		26%	17%
Percent Bare Ground	64%		40%	52%



Table 5 Soil Imprinting and Hand Broadcast – Quadrat E

Species	Quadrat E	
	Number of Hits	Percent Cover
Native Shrubs		
<i>Acmispon glaber</i>		
<i>Artemisia californica</i>	1	2%
<i>Atriplex canescens</i>	5	10%
<i>Atriplex lentiformis</i>	7	14%
<i>Atriplex polycarpa</i>		
<i>Atriplex spinosa</i>		
<i>Encelia californica</i>		
<i>Encelia farinosa</i>		
<i>Eriodictyon trichocalyx</i>	8	16%
<i>Eriogonum fasciculatum</i>	4	8%
<i>Isocoma menziesii</i>	4	8%
<i>Opuntia littoralis</i>		
<i>Salvia apiana</i>		
<i>Salvia mellifera</i>		
Native Herbs		
<i>Achillia mellifolium</i>		
<i>Eschscholzia californica</i>		
<i>Elymus triticoides</i>		
<i>Nasella pulchra</i>		
<i>Sisyrinchium bellum</i>		
<i>Vulpia microstachys</i>		
Non-Native Herbs		
<i>Centaurea melitensis</i>	1	2%
<i>Centaurea solstitialis</i>		
<i>Hirschfeldia incana</i>	2	4%
<i>Hordeum vulgare</i>		
<i>Mesembryanthemum nodiflorum</i>		
Schismus arabicus		
Bare ground	18	36%
Quadrat E (% cover)		
Percent Cover Native Shrub	58%	
Percent Cover Native Herb	0%	
Percent Cover Non-Native Shrub	0%	
Percent Cover Non-Native Herb	6%	
Percent Bare Ground	36%	



Discussion

Table 6 provides a summary of the percent cover of native and non-native shrubs and herbs, including areas of bare ground within the Coastal Sage Scrub City South B Trial Plot.

Table 6 Summary of Percent Cover for Each Planting Method Using the Point Intercept Method

	Soil Imprinting with Hand Broadcast Overseeded Drainage Swales (Quadrats A and G)	Soil Imprinting (Quadrats B, F, and H)	Broadcast Seeding (Quadrat C)	Broadcast Seeding with Soil Imprinting (Quadrats D and I)	Soil Imprinting and Hand Broadcast (Quadrat E)
Percent Cover Native Shrub	25%	46%	18%	21%	58%
Percent Cover Native Herb	3%	0%	0%	2%	0%
Percent Cover Non-Native Shrub	0%	0%	0%	8%	0%
Percent Cover Non-Native Herb	31%	19%	14%	17%	6%
Percent Bare Ground	41%	35%	68%	52%	36%

Dominant native shrub species include fourwing saltbush (*Atriplex canescens*), brittlebush (*Encelia farinosa*), big saltbush (*Atriplex lentiformis*), broom baccharis (*Baccharis sarothroides*), California buckwheat (*Eriogonum fasciculatum*), California sagebrush (*Artemisia californica*), coastal goldenbush (*Isocoma menziesii*), and hairy yerba santa (*Eriodictyon trichocalyx*). Dominant herbaceous species include non-native red brome (*Bromus rubens*), tocalote (*Centaurea melitensis*), and short podded mustard (*Hirschfeldia incana*).

Non-native plant cover increased in the hand broadcast treatment type, and decreased in all other treatment types between the first and second quarter of 2025. The decrease in non-native plant cover likely occurred as a result of decreased water availability as the dry season continues. Non-native plant species cover is expected to decrease in late summer of 2025 as a result of decreased water availability as the dry season continues. Native shrub quantitative percent cover has not substantially changed across all treatment types between the first and second quarter of 2025. Soil imprinting and hand broadcast (Quadrat E; 58 percent) and soil imprinting quadrats (Quadrats B, F, and H; 46 percent) had the highest percent cover of native shrubs using the point intercept method, followed by the soil imprinting with hand broadcast overseeding (Quadrats A and G; 25 percent). The quantitative percent cover of native herbaceous plant species was highest in soil imprinting with hand broadcast overseeding (Quadrat A and G; 3%), and was zero in all other planting methods in the second quarter of 2025.

Recommendations

Successional Growth and Weed Control

Wildfires in Southern California have become more common in recent years and have impacted the native landscape. Non-native weed control is essential in establishing post-fire restoration sites and is recommended by organizations such as the California Department of Fish and Wildlife Service and the California Society of Ecological Restoration. Successional regrowth of herbaceous non-native species is to be expected within the first two to three years following a wildfire, which is currently occurring at the trial plot. Native shrubs are expected to recover over a longer period through germination of



existing seed within the topsoil and basal growth from charred plants. Native shrubs have shown notable growth in the past three years, and now appear to be well established in the trial plot.

Successional growth of herbaceous species is also important, as native herbaceous species provide natural erosion of topsoil. To promote establishment and growth of native herbaceous species, controlling the spread of non-native herbaceous species such as tocalote, red brome, and short podded mustard is essential. Reducing non-native herbaceous species growth minimizes negative competitive effects on native herbaceous and woody species for water, nutrients, and sunlight. Weed maintenance should occur no less than every four months, and special attention should be afforded to minimizing impacts to native grasses that may appear to be non-native (i.e., beardless wild rye), native seedlings, and native shrub resprouts. Weed maintenance should be scheduled to maximize removal of non-native species prior to seed set, which typically occurs in spring between the months of February and April but may also occur throughout the growing season based upon water availability.

Supplemental Irrigation

While Southern California received above-average rainfall in the winter of 2023 and spring of 2024, it received below average rainfall in the winter of 2024 and spring of 2025. Supplemental irrigation is a valuable restoration technique to promote re-establishment of native vegetation, particularly during the dry months of the year (i.e., summer and fall). As described above, native herbaceous vegetation has continued to be notably low throughout all planting methods. If native herbaceous vegetation continues to be sparse throughout the trial plot, and/or if native shrubs prematurely senesce or show indicators of drought stress, the irrigation system within the trial plot should be re-installed to increase water availability and promote seed germination and re-establishment of native vegetation.

Thank you for the opportunity to work with you on this important Project. Please contact Kyle Gern if you have questions concerning the contents of this report. He may be reached by telephone at 805-844-1492, or by email at kgern@rinconconsultants.com.

Sincerely,

Rincon Consultants, Inc.

A handwritten signature in black ink that reads 'Kyle Gern'.

Kyle Gern
Biologist

Attachments

- Attachment 1 Deck B Revegetation Area Quadrat Layout
- Attachment 2 Representative Site Photographs



References

John Minch and Associates, Inc. (JMA). 2014. Methodology for Monitoring Percent Cover and Species Richness within Each Seeded Application Method on the Coastal Sage Scrub Pilot Project at the Sunshine Canyon Landfill.

Attachment 1

Deck B Revegetation Area Quadrat Layout

1800

RANDOM 50M QUADRAT SAMPLING SELECTIONS

PHOTO STATIONS

1760m

QUADRAT "A" 41

QUADRAT "B" 45

QUADRAT "C" 76

QUADRAT "D" 86

QUADRAT "E" 13

QUADRAT "F" 44

QUADRAT "G" 55

QUADRAT "H" 65

QUADRAT "I" 90

QUADRAT "J" 91

1 2 3 4 5 6 7 8 9 10 11 12 13 14 15 16 17 18 19

20 21 22 23 24 25 26 27 28 29

30 31 32 33 34 35 36 37 38

39 40 41 42 43 44 45 46

47 48 49 50 51 52 53 54 55 56 57 58 59 60 61 62 63 64 65 66 67 68 69 70 71 72 73 74 75 76 77 78 79 80 81 82 83 84 85 86 87 88 89 90 91 92 93 94

95 96 97 98 99 100

101 102 103 104 105 106 107 108 109 110 111 112 113 114 115 116 117 118 119 120

121 122 123 124 125 126 127 128 129 130

131 132 133 134 135 136 137 138 139 140

141 142 143 144 145 146 147 148 149 150

151 152 153 154 155 156 157 158 159 160

161 162 163 164 165 166 167 168 169 170

171 172 173 174 175 176 177 178 179 180

181 182 183 184 185 186 187 188 189 190

191 192 193 194 195 196 197 198 199 200

201 202 203 204 205 206 207 208 209 210

211 212 213 214 215 216 217 218 219 220

221 222 223 224 225 226 227 228 229 230

231 232 233 234 235 236 237 238 239 240

241 242 243 244 245 246 247 248 249 250

251 252 253 254 255 256 257 258 259 260

261 262 263 264 265 266 267 268 269 270

271 272 273 274 275 276 277 278 279 280

281 282 283 284 285 286 287 288 289 290

291 292 293 294 295 296 297 298 299 300

301 302 303 304 305 306 307 308 309 310

311 312 313 314 315 316 317 318 319 320

321 322 323 324 325 326 327 328 329 330

331 332 333 334 335 336 337 338 339 340

341 342 343 344 345 346 347 348 349 350

351 352 353 354 355 356 357 358 359 360

361 362 363 364 365 366 367 368 369 370

371 372 373 374 375 376 377 378 379 380

381 382 383 384 385 386 387 388 389 390

391 392 393 394 395 396 397 398 399 400

401 402 403 404 405 406 407 408 409 410

411 412 413 414 415 416 417 418 419 420

421 422 423 424 425 426 427 428 429 430

431 432 433 434 435 436 437 438 439 440

441 442 443 444 445 446 447 448 449 450

451 452 453 454 455 456 457 458 459 460

461 462 463 464 465 466 467 468 469 470

471 472 473 474 475 476 477 478 479 480

481 482 483 484 485 486 487 488 489 490

491 492 493 494 495 496 497 498 499 500

501 502 503 504 505 506 507 508 509 510

511 512 513 514 515 516 517 518 519 520

521 522 523 524 525 526 527 528 529 530

531 532 533 534 535 536 537 538 539 540

541 542 543 544 545 546 547 548 549 550

551 552 553 554 555 556 557 558 559 560

561 562 563 564 565 566 567 568 569 570

571 572 573 574 575 576 577 578 579 580

581 582 583 584 585 586 587 588 589 590

591 592 593 594 595 596 597 598 599 600

601 602 603 604 605 606 607 608 609 610

611 612 613 614 615 616 617 618 619 620

621 622 623 624 625 626 627 628 629 630

631 632 633 634 635 636 637 638 639 640

641 642 643 644 645 646 647 648 649 650

651 652 653 654 655 656 657 658 659 660

661 662 663 664 665 666 667 668 669 670

671 672 673 674 675 676 677 678 679 680

681 682 683 684 685 686 687 688 689 690

691 692 693 694 695 696 697 698 699 700

701 702 703 704 705 706 707 708 709 710

711 712 713 714 715 716 717 718 719 720

721 722 723 724 725 726 727 728 729 730

731 732 733 734 735 736 737 738 739 740

741 742 743 744 745 746 747 748 749 750

751 752 753 754 755 756 757 758 759 760

761 762 763 764 765 766 767 768 769 770

771 772 773 774 775 776 777 778 779 780

781 782 783 784 785 786 787 788 789 790

791 792 793 794 795 796 797 798 799 800

801 802 803 804 805 806 807 808 809 810

811 812 813 814 815 816 817 818 819 820

821 822 823 824 825 826 827 828 829 830

831 832 833 834 835 836 837 838 839 840

841 842 843 844 845 846 847 848 849 850

851 852 853 854 855 856 857 858 859 860

861 862 863 864 865 866 867 868 869 870

Attachment 2

Photographs of Sample Plots



Photograph 1. Quadrat A facing northeast from southwest corner (June 23, 2025).



Photograph 2. Quadrat B facing northeast from southwest corner (June 23, 2025).



Photograph 3. Quadrat C facing northeast from southwest corner (June 23, 2025).



Photograph 4. Quadrat D facing northeast from southwest corner (June 23, 2025).



Photograph 5. Quadrat E facing northeast from southwest corner (June 23, 2025).



Photograph 6. Quadrat F facing northeast from southwest corner (June 23, 2025).



Photograph 7. Quadrat G facing northeast from southwest corner (June 23, 2025).



Photograph 8. Quadrat H facing northeast from southwest corner (June 23, 2025).



Photograph 9. Quadrat I facing northeast from southwest corner (June 23, 2025).

ATTACHMENT 6



Rincon Consultants, Inc.

180 North Ashwood Avenue
Ventura, California 93003

805 644 4455 OFFICE AND FAX

info@rinconconsultants.com
www.rinconconsultants.com

March 22, 2021
Project No: 21-11086

Tuong-phu Ngo
Republic Services
14747 San Fernando Road
Sylmar, California 91342
Via email: [email address](#)

**Subject: Sunshine Canyon Landfill Ultimate Entry Improvement Project, Oak Tree Survey
14747 San Fernando Road, Sylmar, California, 91342**

Dear Mr. Ngo:

Rincon Consultants, Inc. (Rincon) prepared this report for the Ultimate Entry Improvement Project (project) located at the Sunshine Canyon Landfill (landfill) in Sylmar, Los Angeles County, California. This report, prepared by ISA certified arborist Greg Ainsworth, documents the results of an oak tree survey and assessment of impacts to protected oak trees from the project and provides a current tally on the remaining oak trees in the landfills' s oak tree mitigation bank.

Introduction

This oak tree report was prepared to disclose information on native oak (*Quercus sp.*) trees that would be removed by the proposed project.

Pursuant to the Los Angeles County Oak Tree Ordinance, any tree of the oak genus that is 25 inches in circumference (8 inches in diameter) or has a combined trunk circumference of any two trunks of at least 38 inches (12 inches in diameter), as measured 4.5 feet above the mean natural grade (i.e., diameter at breast height [DBH]), is considered a "protected tree" (Ordinance 88-0157 1, 82-0168 2, Section 22.56.2050, 1988). An oak tree that has a trunk DBH equal to or greater than 36 inches is considered a heritage tree, as defined in the Los Angeles County Oak Tree Ordinance. In accordance with the Ordinance, no damage shall occur within the protective zone (the area within the dripline of an oak tree and extending to a point at least 5 feet outside the dripline, or 15 feet from the trunk[s] of the tree, whichever distance is greater) of a protected oak tree. Damage is defined as any act causing or tending to cause injury to the root system or other parts of an oak tree, including, but not limited to, burning, application of toxic substances, operation of equipment or machinery, paving, changing of natural grade, and trenching or excavating.

Sunshine Canyon Landfill Oak Tree Mitigation Bank

In accordance with landfill's Conditional Use Permit (CUP) and Oak Tree Permit (OTP) #86312-(5) (dated February 19, 1991) for the Sunshine Canyon Landfill Extension Project, all native oak trees that will be removed for any project-related impact shall be mitigated at a ratio of 2:1, and heritage-size oak trees (36-inch DBH or greater) shall be mitigated at a ratio of 10:1. All mitigation oaks shall be monitored for 7 years after the tree reaches 0.5 inches in diameter.



A surplus of coast live oak trees was previously planted in the landfill's mitigation areas, which now serves as a mitigation bank for the landfill to draw from for future removals of coast live oak trees. There are currently 48 coast live oaks remaining in the mitigation bank (JMA, Sunshine Canyon Landfill Oak Tree and Bigcone Douglas Fir Monitoring Report No. 28, March 8, 2021).

Project Description

The proposed project involves the development of a landfill termination berm and cut/fill graded entrance roadway that will provide a down-slope buttress and access for a proposed landfill expansion. The nearly 190-foot-high proposed roadway and berm embankment across the mouth of the main canyon of Sunshine Canyon Landfill is designed to buttress the expanded landfill refuse prism that will be situated to the west. This new road embankment includes the associated cut and fill grading, three retaining walls, and a sedimentation basin with stormwater controls.

Methods

All oak trees located within and immediately adjacent to the project footprint that could be impacted by the proposed project were surveyed by certified arborist Greg Ainsworth (I.S.A. Cert# WE-7473A). The tree survey was conducted on March 4, 2021. Using a forester's diameter-equivalent tape, the diameter of all native oak trees having a trunk diameter of 8 inches or greater (or combined trunk diameter of 12 inches or greater) were measured at 4.5 feet above the mean natural grade to obtain the DBH. The location of each tree was recorded from the base of the tree using a Global Positioning System (GPS) with sub-meter accuracy. The following parameters were assessed from the base of each tree (or from the nearest vantage point):

Tree Characteristics

- Trunk diameter (DBH)
- Height
- Crown radius in all directions (north, south, east, and west).
- Balance or symmetry of the tree based on the crown radius measurements and whether the tree leans or is unstable.

Physical Condition

- Identification of damage caused by pathogens or insect pests, by natural causes such as lightning, or by human activity.
- Evaluation of vigor based on such parameters as amount of new growth, leaf color, abnormal bark, dead wood, evidence of wilt, excessive necrosis or leaf chlorosis, thinning of crown, etc.
- Assessment of the overall health of the tree based on the evaluation of vigor, presence of damage, and comparison to the typical archetype tree of the same species.



Health Grade

A subjective alphabetical ranking was assigned for overall health (vigor, aesthetic value, and balance) for each native oak and big cone fir tree based on the criteria described below:

- “A” = Excellent: A healthy and vigorous tree characteristic of its species and reasonably free of any visible signs of stress, disease, or pest infestation.
- “B” = Good: A healthy and vigorous tree with minor visible signs of stress, disease, and/or pest infestation. Some maintenance measures may need to be implemented, such as pruning of dead wood or broken branches.
- “C” = Fair: Although healthy in overall appearance, there is abnormal amount of stress or disease/insect infestation, and a substantial amount of maintenance may be needed.
- “D” = Poor: A tree that may be exhibiting a substantial amount of stress, disease, or insect damage than what the amount that is expected for the species. The tree may be in a state of rapid decline, and may show various signs of dieback, necrosis, or other symptoms caused by pathogens or insect pests.
- “F” = Dead: This tree has no foliage and exhibits no sign of life or vigor.

Results

There are 20 coast live oak trees located within the project footprint, one of which is dead, and all of which would be removed by the proposed project. No other oak trees would be encroached or otherwise impacted by the proposed project. Data on these 20 oak trees is presented in Table 1 below.

Table 1 Oak Tree Survey Data

Tree #	Species	DBH	Canopy Spread				Health	Physical Condition	Impact Status	Reason for Impact
			North	West	South	East				
1	Coast live oak	13	14	3	8	21	Fair		Removal	Grading
2	Coast live oak	--	--	--	--	--	Dead		Removal	Grading
3	Coast live oak	16	3	8	25	35	Poor	fire scar	Removal	Grading
4	Coast live oak	12	12	7	18	15	Good	fire scar	Removal	Grading
5	Coast live oak	18	11	15	30	7	Good	fire scar	Removal	Grading
6	Coast live oak	9	4	8	18	2	Fair	fire scar	Removal	Grading
7	Coast live oak	15	7	16	15	8	Fair	fire scar	Removal	Grading
8	Coast live oak	9	7	3	18	8	Good	fire scar	Removal	Grading
9	Coast live oak	18	30	15	22	10	Good	fire scar	Removal	Grading
10	Coast live oak	16	8	17	15	6	Fair	fire scar	Removal	Grading
11	Coast live oak	10	15	14	1	2	Fair	fire scar	Removal	Grading
12	Coast live oak	10	20	6	4	2	Fair	fire scar	Removal	Grading
13	Coast live oak	22	18	21	16	10	Fair	fire scar	Removal	Grading
14	Coast live oak	10	19	1	1	1	Fair	fire scar	Removal	Grading
15	Coast live oak	21	10	7	18	22	Fair	fire scar	Removal	Grading



Tree #	Species	DBH	Canopy Spread				Health	Physical Condition	Impact Status	Reason for Impact
			North	West	South	East				
16	Coast live oak	18	1	22	19	8	Fair	fire scar, split trunk	Removal	Grading
17	Coast live oak	19	15	11	15	10	Fair	fire scar	Removal	Grading
18	Coast live oak	12	15	7	15	7	Fair	fire scar	Removal	Grading
19	Coast live oak	12	17	10	4	8	Good		Removal	Grading
20	Coast live oak	8	4	12	6	1	Fair		Removal	Grading

Mitigation

There are currently 48 coast live oak trees in the landfill's mitigation bank. As noted in Table 1, 20 coast live oak trees would be removed by the proposed project. Therefore, at a mitigation ratio of 2:1, 40 coast live oak trees will be deducted from the landfill's oak tree mitigation bank, leaving 4 oak trees remaining in the bank for future removals at the landfill.

Please contact Greg Ainsworth at (818) 564-5544 or email at gainsworth@rinconconsultants.com if you have any question or comments regarding the information provided in this report.

Sincerely,
Rincon Consultants, Inc.

Greg Ainsworth, I.S.A. Cert # WE-7473A
Director of Urban Forestry

Attachments

Oak Tree Map

DRAWING 1



P:\SITES\SUNSHINE CANYON\ULTIMATE ENTRANCE ROAD CONST PHASE 1-2\EXHIBITS\S021.1039-SCL-VHBT-OAK TREES LOCATIONS-FIG 1-(2021-03-24).DWG March 26, 2021 - 10:30 AM BY: GJA-USER

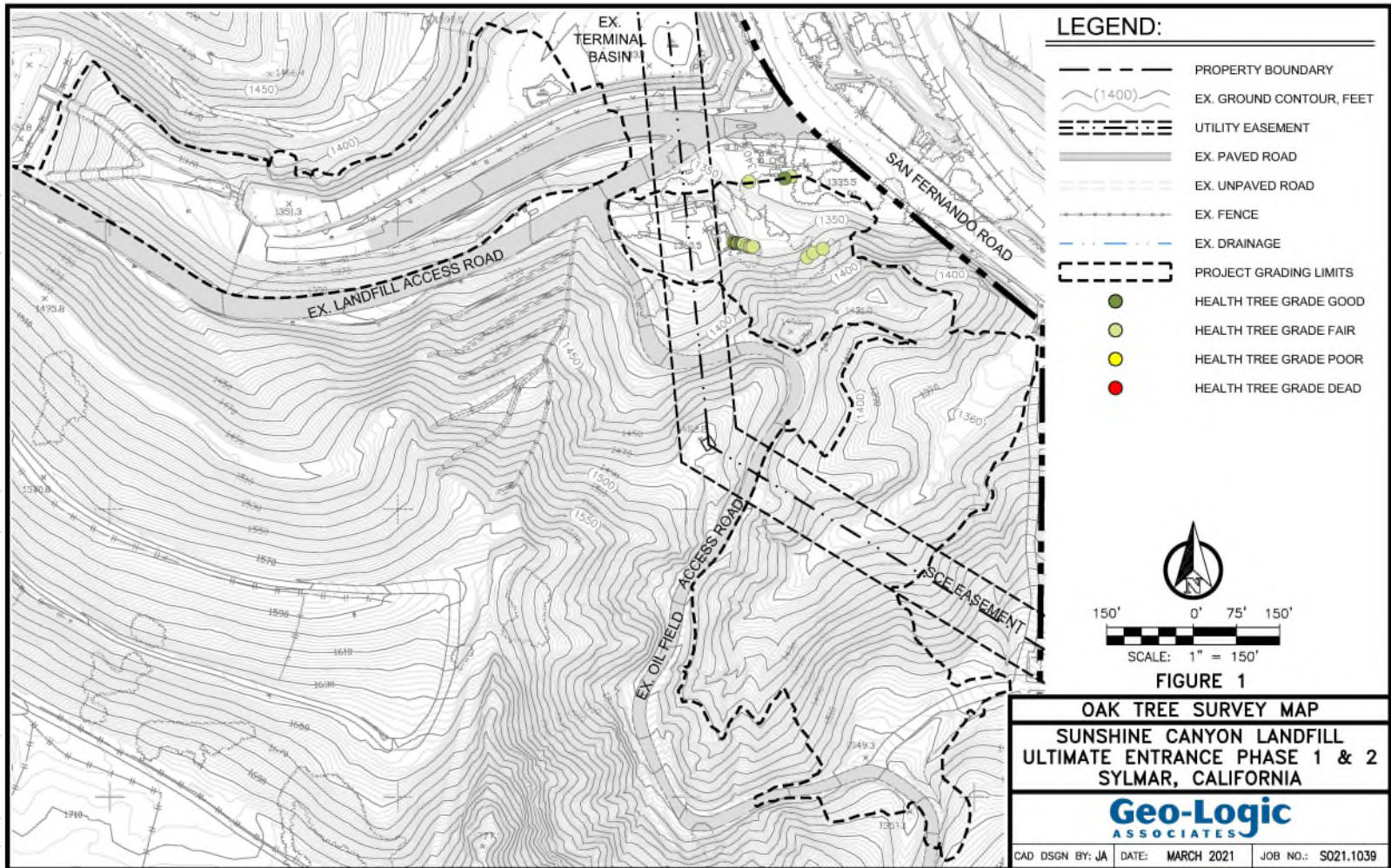

1. This drawing is the property of Geo-Logic Associates, Inc. and shall not be reproduced or transmitted in any form or by any means, electronic, mechanical, photocopying, recording, or by any information storage and retrieval system, without the prior written permission of Geo-Logic Associates, Inc.

